

could not locate the old  
7.12.

# PERMIT

## SEWAGE DISPOSAL SYSTEM

### DEPARTMENT OF HEALTH AND MENTAL HYGIENE

P 56469 A

AREPAIR

DISTRICT

DATE 3-5-96

DATE SYSTEM APPROVED 3/5/96

INSPECTOR M. Riffkin

#### HOWARD COUNTY HEALTH DEPARTMENT

BUREAU OF ENVIRONMENTAL HEALTH

313-2640

INDEXED

Jack Fyock Septic Service

IS PERMITTED TO INSTALL ALTER X

ADDRESS 13775 Triadelphia Road, Glenelg, Maryland 21735 PHONE 988-9270

SUBDIVISION LOT ROAD 2535 Sand Hill Road

PROPERTY OWNER Bullock

ADDRESS

SEPTIC TANK CAPACITY 1000 GALLONS

NUMBER OF BEDROOMS 2

SQUARE FEET PER BEDROOM

LINEAR FEET OF TRENCH REQUIRED

REPAIR - PURPOSE - REPLACE COLLAPSED SEPTIC TANK.

Call for inspection when ground is opened so sanitarian can recommend re

PLANS APPROVED BY DATE

COVER NO WORK UNTIL INSPECTED AND APPROVED

NEITHER THE HOWARD COUNTY COUNCIL NOR THE HEALTH DEPARTMENT IS RESPONSIBLE FOR THE SUCCESSFUL OPERATION OF ANY SYSTEM

NOTE: CLEANOUT REQUIRED EVERY 70 FEET OF SEWER LINE AND/OR AT 90° SWEEPS IN LINES FROM HOUSE TO DRAIN FIELDS, 90° ELBOWS NOT ACCEPTABLE.

NOTE: ALL PARTS OF SEPTIC SYSTEMS (I.E. TANK, DISTRIBUTION BOX TRENCHES) TO BE 100 FEET FROM WELL (UNLESS OTHERWISE SPECIFICALLY AUTHORIZED)

NOTE: IF DEEP TRENCH(ES) ARE USED CALL FOR INSPECTION BEFORE AND AFTER PLACING GRAVEL IN TRENCH(ES)

NOTE: NO DRY WELL SHALL EXCEED 15 FOOT IN DIAMETER NO ABSORPTION TRENCH TO EXCEED 100 FEET IN LENGTH

NOTE: ALL PIPE FROM HOUSE TO SEPTIC TANK MUST BE CAST IRON OR SCHEDULE 35/40 PVC OR ABS

PERMIT VOID AFTER TWO YEARS

NOTE: INSTALL STAND PIPE ON SEPTIC TANK AND DRY WELL STAND PIPES MUST BE 6 INCHES IN DIAMETER CAST IRON. CONCRETE OR TERRA COTTA OR PVA OR ABS ACCEPTED. IF TOP OF SEPTIC TANK IS DEEPER THAN 3 FEET. MANHOLE TO GRADE REQUIRED.

NOTE: DISTRIBUTION BOXES MUST HAVE BAFFLES

vr/

\*INSTALLER IS RESPONSIBLE FOR OBTAINING FINAL APPROVAL ON THIS PERMIT

HD-260(6-90)

\*CALL 461-9933 FOR INSPECTION OF SEPTIC SYSTEM.

P56469A

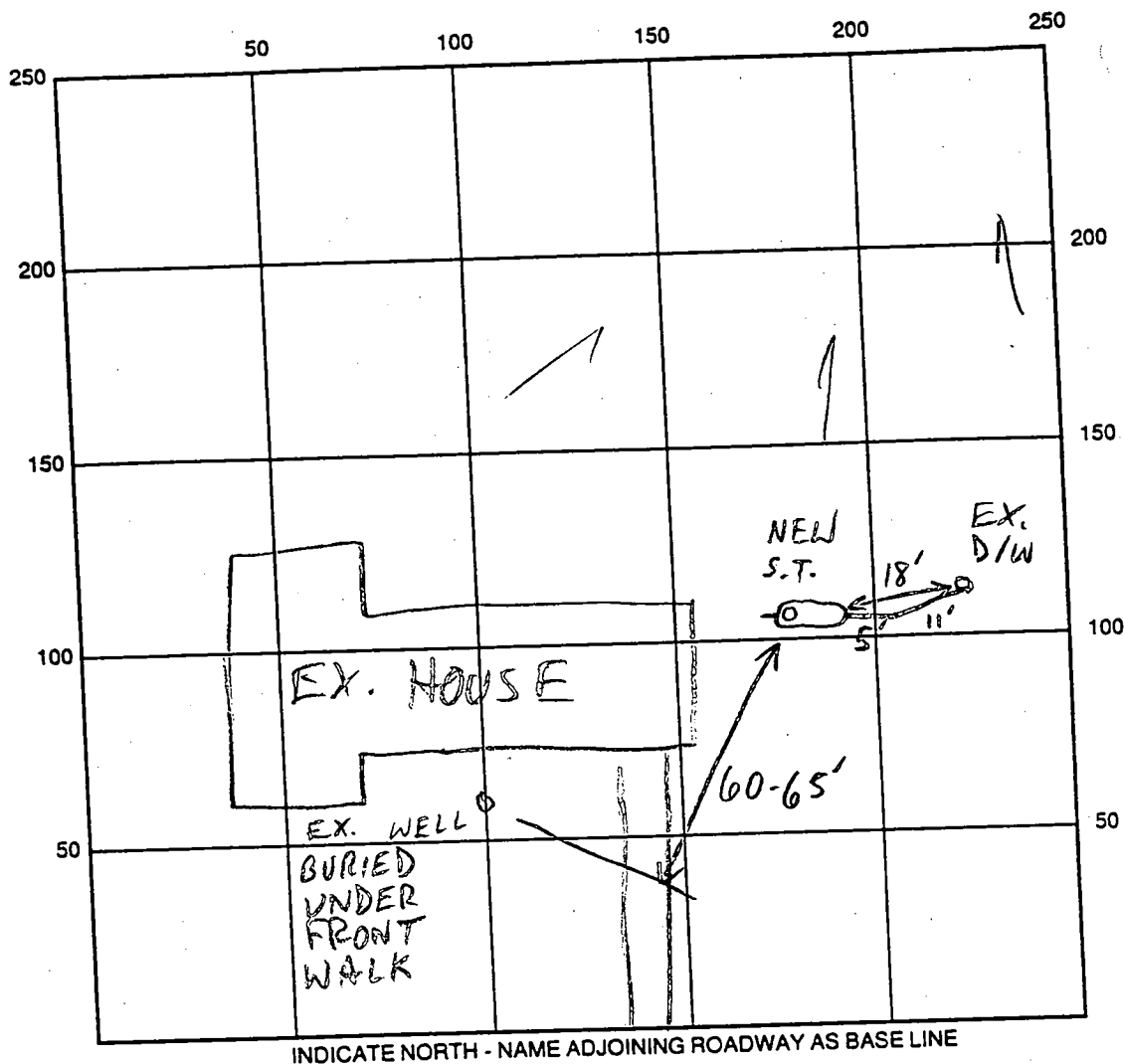

SEPTIC TANK LEVEL 1000 GAL PLASTIC

CLEANOUTS MANHOLE - OK

DISTRIBUTION BOX LEVEL       

DRAIN FIELD/TITLE DEPTH        FT.

TRENCH WIDTH        FT.

INLET DEPTH        FT.

EFFECTIVE GRAVEL DEPTH        FT.

TOTAL LENGTH        FT.

NUMBER OF TRENCHES       

ONE SIDEWALL/BOTTOM AREA        SQ. FT.

DRYWALL INSIDE DIAMETER        FT.

EFFECTIVE DEPTH BELOW INLET        FT.

ABSORBENT AREA        SQ. FT.

REMARKS: 3/5/96 SEWER HOUSE CONN LOC. UNKNOWN; S.T. OK; LINE  
TO D/W ALSO REPLACED; ALL OK TO COVER MR

PREV. LANHAM, APPLER  
OWNERS

DATE SYSTEM APPROVED 3/5/96

INSPECTOR M. Ripkin

5/25/72

PERMIT

SEWAGE DISPOSAL SYSTEM

MARYLAND STATE DEPARTMENT OF HEALTH

HOWARD COUNTY

ELLICOTT CITY

DISTRICT 3

DATE 5/10/72

INDEXED

Robert L. Appler (Donald Parlette - installer) IS PERMITTED TO INSTALL ALTER X

ADDRESS Sand Hill Road, Ellicott City, Md. PHONE

A SEWAGE DISPOSAL SYSTEM LOCATED AT

SUBDIVISION 2535 ROAD Sand Hill Road LOT

PROPERTY OWNER Robert L. Appler & wife

ADDRESS

SPECIFICATIONS

DRAIN FIELD DEPTH FEET, BOTTOM AREA SQ. FT.

SEEPAGE PITS ABSORBENT SIDE-WALL AREA SQ. FT.

SEPTIC TANK CAPACITY GALLONS

FOR GARBAGE GRINDER, INCREASE DISPOSAL AREA 22% & TANK CAPACITY 50%.

OTHER REPAIR - 40 ft. trench - approx. 10 ft. deep - max. 6 ft. stone

PLANS APPROVED BY F. F. Frommelt DATE 5/8/72

FILL SEPTIC TANK AND DISTRIBUTION BOX WITH WATER BEFORE CALLING FOR AN INSPECTION. COVER NO WORK UNTIL INSPECTED AND APPROVED.

NEITHER THE HOWARD COUNTY COMMISSIONERS NOR THE HEALTH DEPARTMENT IS RESPONSIBLE FOR THE SUCCESSFUL OPERATION OF ANY SYSTEM.

BLDG. PERMIT SIGNED  
AND RETURNED 11/23/81

Serial # 48361  
garage

17009

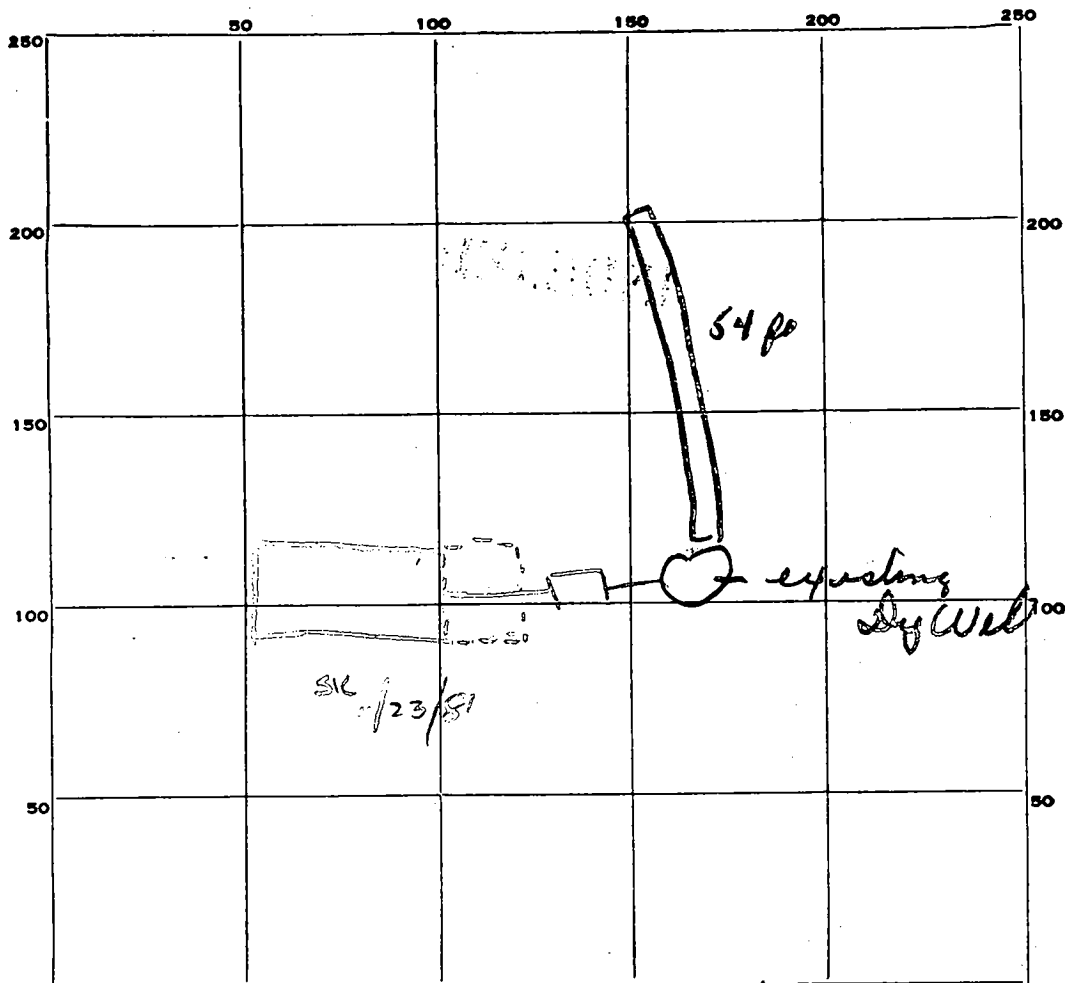

INDICATE NORTH. - NAME ADJOINING ROADWAY AS BASE LINE.

*Sand Hill Rd*

PERMIT CARD not posted

SEPTIC TANK, LEVEL \_\_\_\_\_

CLEANOUTS \_\_\_\_\_

DISTRIBUTION BOX, LEVEL \_\_\_\_\_

TILE FIELD, DEPTH \_\_\_\_\_ FT. TRENCH WIDTH 2 1/2 FT.

GRAVEL DEPTH \_\_\_\_\_ IN. TOTAL LENGTH 54 FT.

NUMBER OF TRENCHES \_\_\_\_\_ TOTAL BOTTOM AREA \_\_\_\_\_

SEEPAGE PITS, INSIDE DIAMETER \_\_\_\_\_ FT. DEPTH BELOW INLET \_\_\_\_\_ FT.

ABSORBENT AREA \_\_\_\_\_ SQ. FT.

REMARKS 5/26/72 - gravel to 2 1/2 ft gravel high end  
" " 2 " " low end.

no overflow seen. - Should have 1 more section of pipe  
then cover pipe with 2" gravel - then installed bucketing paper  
left note in mail box to do above & then back-filled  
6.9.72 - trench covered - appears to be working good.

DATE SYSTEM APPROVED 6.9.72 INSPECTOR Dir Monaghan

