

10/28/96
10-30-11:00
~~10-30-11:00~~
10/30/96 11:00

PERMIT

SEWAGE DISPOSAL SYSTEM

DEPARTMENT OF HEALTH AND MENTAL HYGIENE

HOWARD COUNTY HEALTH DEPARTMENT

BUREAU OF ENVIRONMENTAL HEALTH

~~XXXXXX~~

313-2640

INDEXED

P 573 64A

A REPAIR

DISTRICT _____

DATE 10-28-96

DATE SYSTEM APPROVED 10/30/96

INSPECTOR M. R. R. R.

TAB 10-05-341264

C. C. Cissel

IS PERMITTED TO INSTALL _____ ALTER ☒

ADDRESS 14079 Brighton Dam Road, Clarksville, Maryland 21029 PHONE 854-2006

SUBDIVISION _____ LOT _____ ROAD 5790 Ten Oaks Road

PROPERTY OWNER Andrew Adams
5790 Ten Oaks Road

ADDRESS _____

SEPTIC TANK CAPACITY 1000 GALLONS

NUMBER OF BEDROOMS 2 (3)

180± SQUARE FEET PER BEDROOM

LINEAR FEET OF TRENCH REQUIRED _____

REPAIR - PURPOSE - ~~REAL ESTATE TRANSACTION~~ VOLUNTARY UPGRADE (HOUSE TO BE SOLD)
Call for inspection when ground is opened so sanitarian can recommend repair.

DRYWELL 14' SQUARE, 9' STONE MR 10/28/96

PLANS APPROVED BY _____ DATE _____

COVER NO WORK UNTIL INSPECTED AND APPROVED

NEITHER THE HOWARD COUNTY COUNCIL NOR THE HEALTH DEPARTMENT IS RESPONSIBLE FOR THE SUCCESSFUL OPERATION OF ANY SYSTEM

NOTE: CLEANOUT REQUIRED EVERY 70 FEET OF SEWER LINE AND/OR AT 90° SWEEPS IN LINES FROM HOUSE TO DRAIN FIELDS, 90° ELBOWS NOT ACCEPTABLE.

NOTE: ALL PARTS OF SEPTIC SYSTEMS (I.E. TANK, DISTRIBUTION BOX TRENCHES) TO BE 100 FEET FROM WELL (UNLESS OTHERWISE SPECIFICALLY AUTHORIZED)

NOTE: IF DEEP TRENCH(ES) ARE USED CALL FOR INSPECTION BEFORE AND AFTER PLACING GRAVEL IN TRENCH(ES)

NOTE: NO DRY WELL SHALL EXCEED 15 FOOT IN DIAMETER NO ABSORPTION TRENCH TO EXCEED 100 FEET IN LENGTH

NOTE: ALL PIPE FROM HOUSE TO SEPTIC TANK MUST BE CAST IRON OR SCHEDULE 35/40 PVC OR ABS

PERMIT VOID AFTER TWO YEARS

NOTE: INSTALL STAND PIPE ON SEPTIC TANK AND DRY WELL STAND PIPES MUST BE 6 INCHES IN DIAMETER CAST IRON. CONCRETE OR TERRA COTTA OR PVA OR ABS ACCEPTED. IF TOP OF SEPTIC TANK IS DEEPER THAN 3 FEET. MANHOLE TO GRADE REQUIRED.

NOTE: DISTRIBUTION BOXES MUST HAVE BAFFLES

*INSTALLER IS RESPONSIBLE FOR OBTAINING FINAL APPROVAL ON THIS PERMIT

57364A

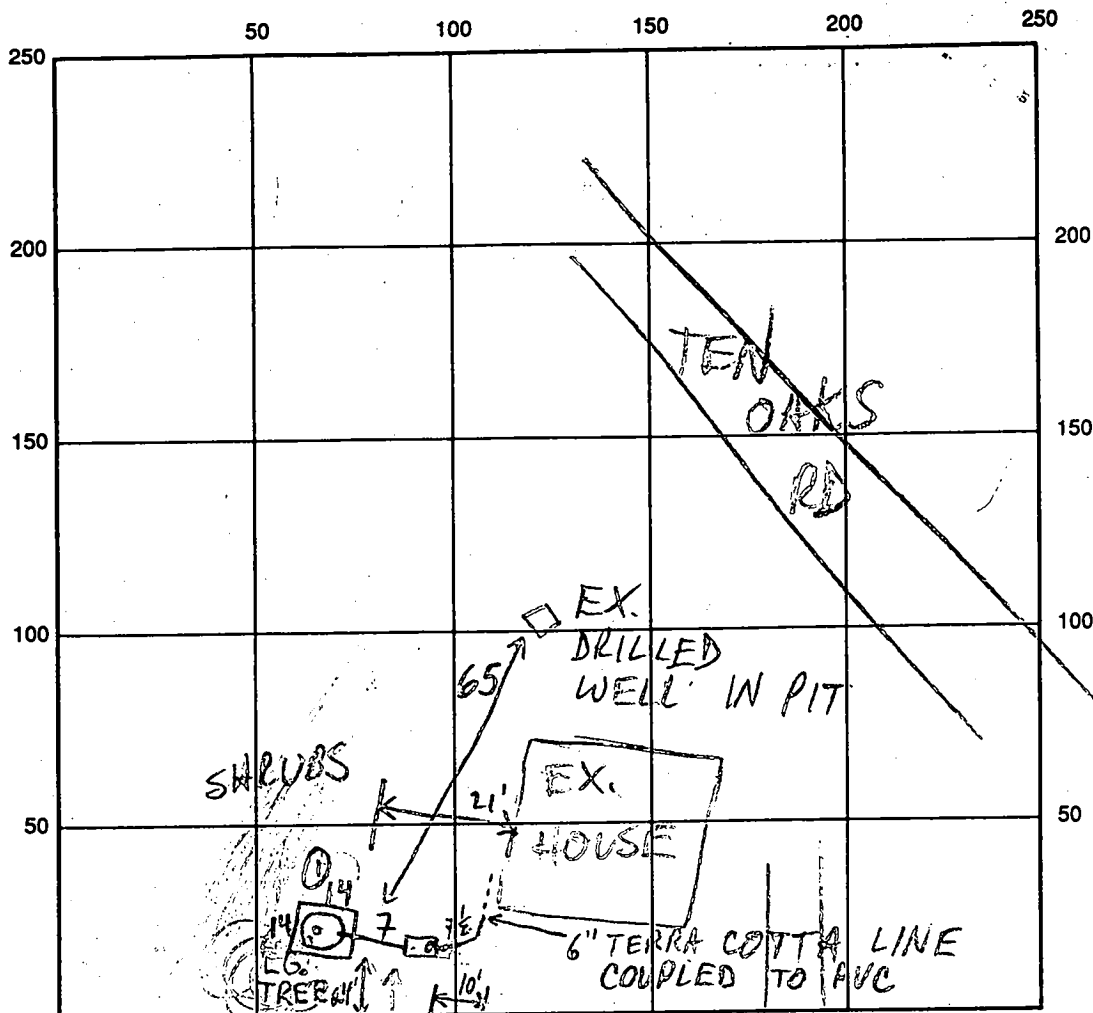

INDICATE NORTH - NAME ADJOINING ROADWAY AS BASE LINE

TRIA MILL RD 200'± TO WELL ACROSS RD

SEPTIC TANK LEVEL 1000 GAL - OK

CLEANOUTS 8" ON S.T. AND D/W

DISTRIBUTION BOX LEVEL

DRAIN FIELD/TITLE DEPTH 12 FT.

TRENCH WIDTH

INLET DEPTH 3 FT.

EFFECTIVE GRAVEL DEPTH

TOTAL LENGTH

NUMBER OF TRENCHES

ONE SIDEWALL/BOTTOM AREA

DRYWALL INSIDE DIAMETER 14 x 14 FT.

EFFECTIVE DEPTH BELOW INLET 9 FT.

ABSORBENT AREA 504 SQ. FT.

REMARKS: 10/28/96 OK TO START; EX SYSTEM REPORTEDLY ACROSS

TRIA MILL RD (CESSPOOL) MR

10/30/96 OK TO FINISH & COVER MR

DATE SYSTEM APPROVED

10/30/96

INSPECTOR

M. Rittin

10/16/96
3:30

SITE INSPECTION SHEET

OWNER: Andrew Adams

DATE REQUESTED: _____

PHONE #: _____

CONTRACTOR: _____

SITE ADDRESS: 5790 Ten Oaks Rd

WELL TAG #: _____

COUNTY #: _____

PROPOSAL: Site insp requested before septic system repair (for real estate transaction)

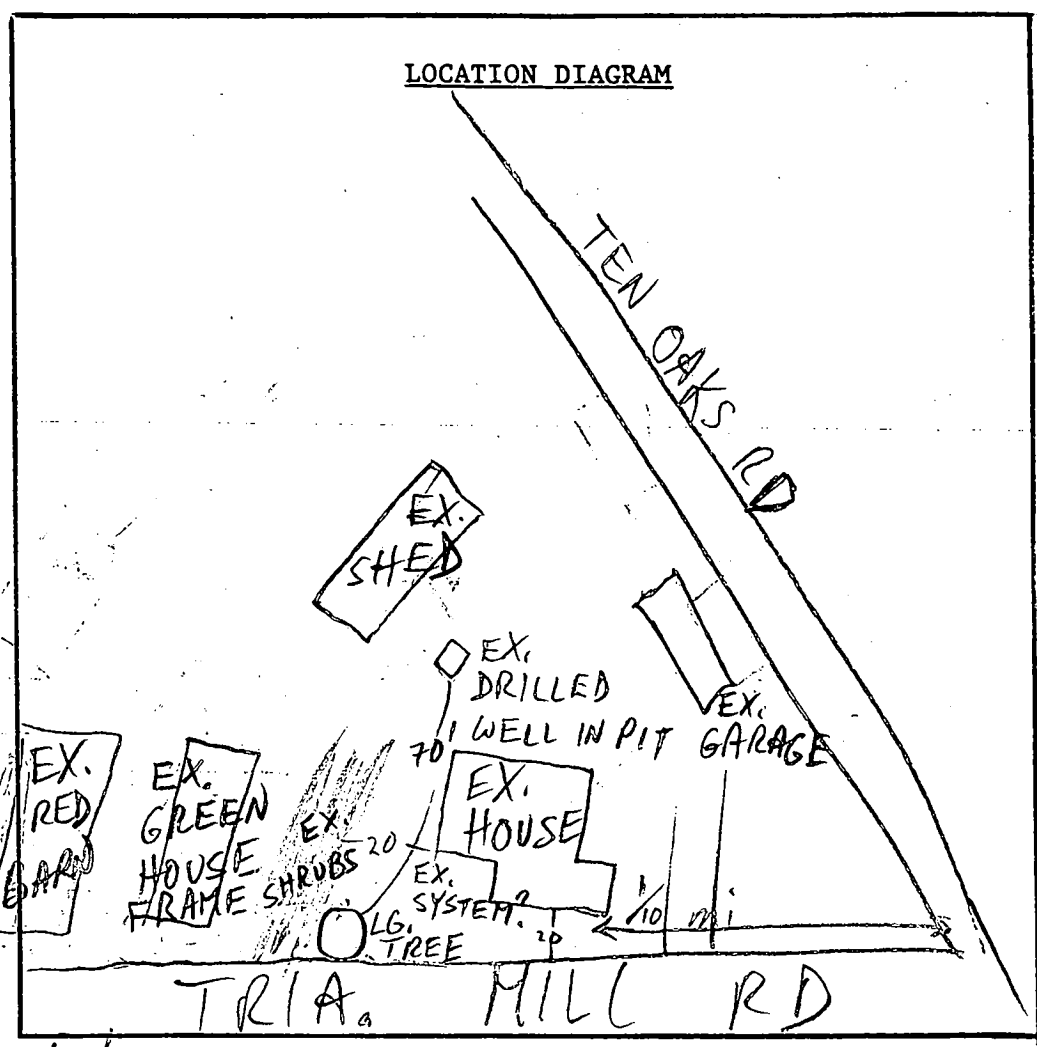

COMMENTS: 10/16/96 MET C. CISSEL: BEST OPTION IS D/W IN FRONT LEFT PORTION OF PROPERTY (NEAR TREE/SHRUBS), BUT NEED PROP. BOUNDARIES & INFO RE: ADJ. WELLS BEFORE INSTALLATION, OK TO PREPARE PERMIT MR

DATE: _____ INSPECTOR: _____