

PERMIT

SEWAGE DISPOSAL SYSTEM

DEPARTMENT OF HEALTH AND MENTAL HYGIENE

HOWARD COUNTY HEALTH DEPARTMENT

BUREAU OF ENVIRONMENTAL HEALTH

~~X 461-9933~~ 313-2640

P 58007C

A REPAIR

DISTRICT _____

DATE 03/06/97

DATE SYSTEM APPROVED 3/21/97

INSPECTOR *SP*

280020

INDEXED

Jack Fyock Septic Service IS PERMITTED TO INSTALL _____ ALTER X

ADDRESS 13775 Triadelphia Road, Glenelg, Maryland 21737 PHONE 988-9270

SUBDIVISION _____ LOT _____ ROAD 1630 Woodstock Road

PROPERTY OWNER Tiller

ADDRESS 1630 Woodstock Road
Woodstock, Maryland 21163

SEPTIC TANK CAPACITY 1000 GALLONS

NUMBER OF BEDROOMS 3

125 SQUARE FEET PER BEDROOM

LINEAR FEET OF TRENCH REQUIRED 93

TRENCHES - SEPTIC SYSTEM HAS FAILED.

Call for inspection when ground is opened so sanitarian can recommend repair.
03/06/97

INLET 3' MAX BOTTOM DEPTH 7'

4' STONE BELOW DRY PIPE

INSTALL 2 46' TRENCHES - AVOIDING SWALES

PLANS APPROVED BY G. SAVAGE DATE 3/26/97

COVER NO WORK UNTIL INSPECTED AND APPROVED

NEITHER THE HOWARD COUNTY COUNCIL NOR THE HEALTH DEPARTMENT IS RESPONSIBLE FOR THE SUCCESSFUL OPERATION OF ANY SYSTEM

NOTE: CLEANOUT REQUIRED EVERY 70 FEET OF SEWER LINE AND/OR AT 90° SWEEPS IN LINES FROM HOUSE TO DRAIN FIELDS, 90° ELBOWS NOT ACCEPTABLE.

NOTE: ALL PARTS OF SEPTIC SYSTEMS (I.E. TANK, DISTRIBUTION BOX TRENCHES) TO BE 100 FEET FROM WELL (UNLESS OTHERWISE SPECIFICALLY AUTHORIZED)

NOTE: IF DEEP TRENCH(ES) ARE USED CALL FOR INSPECTION BEFORE AND AFTER PLACING GRAVEL IN TRENCH(ES)

NOTE: NO DRY WELL SHALL EXCEED 15 FOOT IN DIAMETER NO ABSORPTION TRENCH TO EXCEED 100 FEET IN LENGTH

NOTE: ALL PIPE FROM HOUSE TO SEPTIC TANK MUST BE CAST IRON OR SCHEDULE 35/40 PVC OR ABS

PERMIT VOID AFTER TWO YEARS

NOTE: INSTALL STAND PIPE ON SEPTIC TANK AND DRY WELL STAND PIPES MUST BE 6 INCHES IN DIAMETER CAST IRON, CONCRETE OR TERRA COTTA OR PVA OR ABS ACCEPTED. IF TOP OF SEPTIC TANK IS DEEPER THAN 3 FEET, MANHOLE TO GRADE REQUIRED.

NOTE: DISTRIBUTION BOXES MUST HAVE BAFFLES

*INSTALLER IS RESPONSIBLE FOR OBTAINING FINAL APPROVAL ON THIS PERMIT

58007C

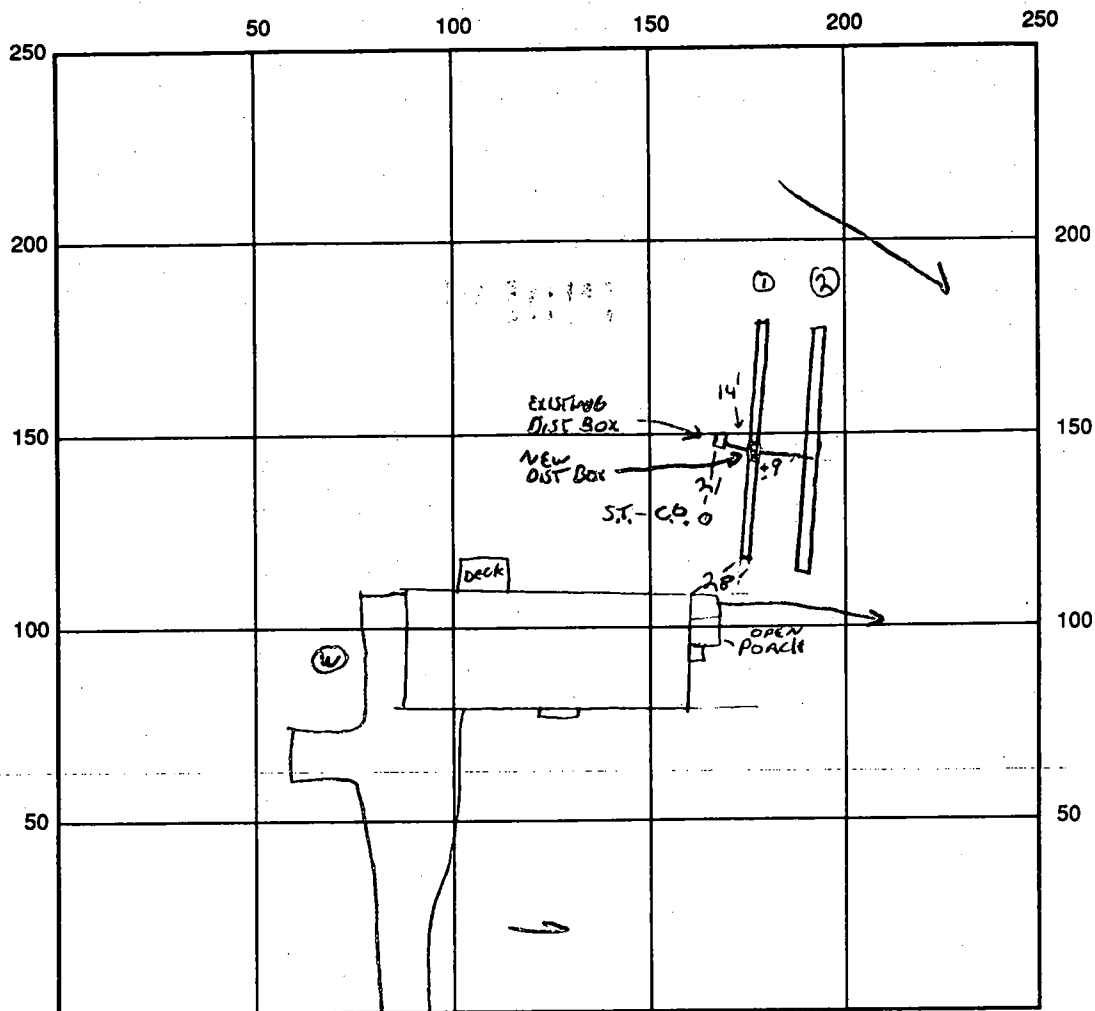

INDICATE NORTH - NAME ADJOINING ROADWAY AS BASE LINE
WOODSTOCK ROAD

N

SEPTIC TANK LEVEL NA CLEANOUTS EXISTING, ON ST.

DISTRIBUTION BOX LEVEL OK

DRAIN FIELD/TITLE DEPTH 7 FT. TRENCH WIDTH 2 FT. INLET DEPTH 3 FT.

EFFECTIVE GRAVEL DEPTH 4 FT. TOTAL LENGTH 98/55 FT.

NUMBER OF TRENCHES 2 ONE SIDEWALL/BOTTOM AREA 412 SQ. FT.

DRYWALL INSIDE DIAMETER — FT. EFFECTIVE DEPTH BELOW INLET — FT.

ABSORBENT AREA — SQ. FT.

REMARKS: 3/26/97 PERC TEST, DESIGN + LAYOUT OK TO PROCEED. 3/27/97 1ST TRENCH
OK TO FINISH + COVER 2ND TRENCH OK TO STONE. 3/27/97

DATE SYSTEM APPROVED 3/27/97 INSPECTOR [Signature]

SOIL PROFILE

0'

SOIL PROFILE

0

TOPSOIL

DB ROWN
LOAMY SANDY
CLAY

BROWN/WHITE
ORANGE MIXED
SANDY SILT CLAY
30% MICA CLAY
FLAKES
STRUCTURE DERIVED
FROM PARENT
MATERIAL

WATER

11.5

INDICATE NORTH - NAME ADJOINING ROADWAY AS BASE LINE
WOODSTOCK ROAD N

WOODSTOCK ROAD

LINE. 2

[illegible]

REMARKS: WATER LEVEL IN ST. 4', SOIL PROFILE CONSISTENT

TYPE OF SOIL

TESTED BY G. SAVAGE

ALSO PRESENT K. MAISTE, Fyuck's CREW

TRENCH DESIGN DATA: AVERAGE PERCOLATION TIME

TRENCH WIDTH

INLET DEPTH

MAXIMUM BOTTOM DEPTH

SQ. FT./BEDROOM

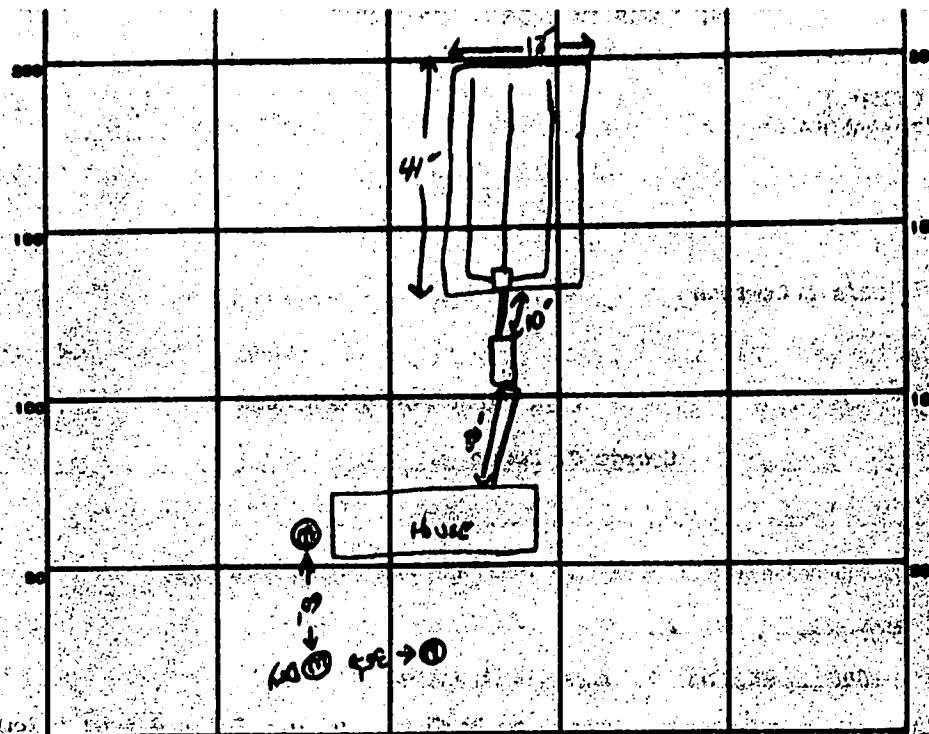

INDICATE NORTH. - NAME ADJOINING ROADWAY AS BASE LINE.
WOODSTOCK Rd

PERMIT CARD ☒

SEPTIC TANK, LEVEL ☒

CLEANOUTS ☒

DISTRIBUTION BOX, LEVEL ☒

TILE FIELD, DEPTH

6.5

LEAKING BED

FT.

TRENCH WIDTH

13

FT.

GRAVEL DEPTH

18"

IN.

TOTAL LENGTH

41'

FT.

NUMBER OF TRENCHES

1

TOTAL BOTTOM AREA

533

SEEPAGE PITS, INSIDE DIAMETER

FT.

DEPTH BELOW INLET

FT.

ABSORBENT AREA

533

SQ. FT.

REMARKS

6-25-83 OK TO ADD STONE TO BEDS; SAME

6/65 total in area of L.B. 8min at 5ft., 10 & 24 min. at 10 ft. same

6-25-83

SAME

OWNER BEAHM GEORGE
 STREET OR RFD 1630 WOODSTOCK RD TOWN WOODSTOCK
 SUBDIVISION _____ SECTION _____ LOT C3

WELL LOG
 Not required for driven wells

STATE THE KIND OF FORMATIONS PENETRATED, THEIR COLOR, DEPTH, THICKNESS AND IF WATER BEARING

DESCRIPTION (Use additional sheets if needed)	FEET		Check if water bearing
	FROM	TO	
OVERBURDEN	0	60	
GRANITE	60	300	X

Well #1 - 200' DRY
 Well #2 - 200' DRY
 (BACKFILLED)

5gpm / 4hr. Pump
 60' case
 40' open
 24' hydrant

ABOUTING RECORD
 WELL HAS BEEN GROUTED (Circle appropriate box) ☒ Y ☐ N
 TYPE OF GROUTING MATERIAL
 CEMENT ☒ BENTONITE CLAY ☐ BC
 NO. OF BAGS 4 NO. OF POUNDS 255
 GALLONS OF WATER
 DEPTH OF GROUT SEAL (to nearest foot)
 from 0 ft. to 49 ft.
 (enter 0 if from surface)

CASING RECORD
 casing types: ☒ ST STEEL ☒ CO CONCRETE
☐ PL PLASTIC ☐ OT OTHER
 MAIN CASING TYPE ☒ ST Nominal diameter top (main) casing (nearest inch) 6 Total depth of main casing (nearest foot) 49
 OTHER CASING (if used) diameter (nearest inch) _____ depth (nearest foot) from _____ to _____

SCREEN RECORD
 screen type or open hole: ☒ ST STEEL ☒ BR BRASS ☒ HO OPEN HOLE
☐ PL PLASTIC ☐ OT OTHER
 DEPTH (nearest ft.)
 1' HO 2' 60 3' 39 4' 9 5' 9 6' 9 7' 9 8' 9 9' 9 10' 9 11' 9 12' 9 13' 9 14' 9 15' 9 16' 9 17' 9 18' 9 19' 9 20' 9 21' 9 22' 9 23' 9 24' 9 25' 9 26' 9 27' 9 28' 9 29' 9 30' 9 31' 9 32' 9 33' 9 34' 9 35' 9 36' 9 37' 9 38' 9 39' 9 40' 9 41' 9 42' 9 43' 9 44' 9 45' 9 46' 9 47' 9 48' 9 49' 9 50' 9 51' 9

SLOT SIZE 1 _____ 2 _____ 3 _____
 DIAMETER OF SCREEN _____ (NEAREST INCH)

PUMPING TEST
 HOURS PUMPED (nearest hour) 2
 PUMPING RATE (gal. per min. to nearest gal.) 45
 METHOD USED TO MEASURE PUMPING RATE SUMMERS/CLE
 WATER LEVEL (distance from land surface) BEFORE PUMPING 97
 WHEN PUMPING 97
 TYPE OF PUMP USED (for test) ☒ A air ☐ P piston ☐ T turbine
☒ C centrifugal ☐ R rotary ☐ O other (describe below)

PUMP INSTALLED
 DRILLER WILL INSTALL PUMP YES ☒ NO ☐
 (CIRCLE YES or NO)
 IF DRILLER INSTALLS PUMP, THIS SECTION MUST BE COMPLETED FOR ALL WELLS EXCEPT HOME USE
 TYPE OF PUMP INSTALLED ☐
 PLACE (A.C.J.P.R.S.T.O) IN BOX - SEE ABOVE: ☐
 CAPACITY: GALLONS PER MINUTE (to nearest gallon) _____
 PUMP HORSE POWER _____
 PUMP COLUMN LENGTH (nearest ft.) _____
 CASING HEIGHT (circle appropriate box and enter casing height)
☒ + above ☐ - below
 LAND SURFACE _____ (nearest foot)

CIRCLE APPROPRIATE LETTER
 A A WELL WAS ABANDONED AND SEALED WHEN THIS WELL WAS COMPLETED
 E ELECTRIC LOG OBTAINED
 P TEST WELL CONVERTED TO PRODUCTION WELL

I HEREBY CERTIFY THAT THIS WELL HAS BEEN CONSTRUCTED IN ACCORDANCE WITH COMAR 10.17.13 "WELL CONSTRUCTION" AND IN CONFORMANCE WITH ALL CONDITIONS STATED IN THE ABOVE CAPTIONED PERMIT, AND THAT THE INFORMATION PRESENTED HEREIN IS ACCURATE AND COMPLETE TO THE BEST OF MY KNOWLEDGE

DRILLERS IDENT. NO. 120
 DRILLERS SIGNATURE _____
 (MUST MATCH SIGNATURE ON APPLICATION)

SITE SUPERVISOR (sign. of driller or journeyman responsible for sitework if different from permittee)

GRAVEL PACK
 IF WELL DRILLED WAS FLOWING WELL INSERT F IN BOX 68 ☐

OEP USE ONLY (NOT TO BE FILLED IN BY DRILLER)
 T _____ (E.R.O.S.)
 73 ☐ 77 ☐ 74 75 76
 TELESCOPE CASING LOG INDICATOR OTHER DATA

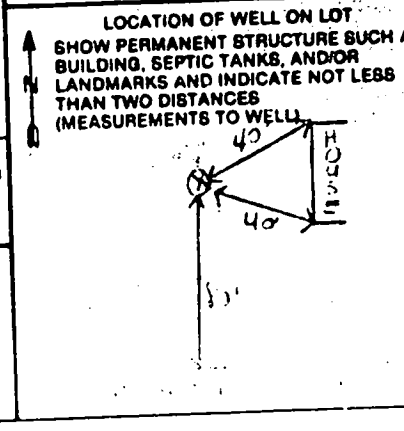

SEWAGE DISPOSAL SYSTEM
MARYLAND STATE DEPARTMENT OF HEALTH

HOWARD COUNTY
BUREAU OF ENVIRONMENTAL HEALTH
992-2330

ELLICOTT CITY
DISTRICT 3rd

DATE 6/24/85

INDEXED

Otis Ketterman

IS PERMITTED TO INSTALL X ALTER

ADDRESS _____ PHONE 992-0062

SUBDIVISION _____ ROAD 1630 Woodstock Road LOT _____

PROPERTY OWNER George C. Beahn

ADDRESS _____

IF GARBAGE GRINDER IS USED INCREASE SEPTIC TANK CAPACITY BY 50% AND ABSORPTION AREA BY 22%

GARBAGE GRINDER? YES _____ NO X

SEPTIC TANK CAPACITY 1000 GALLONS NUMBER OF BEDROOMS 3

TRENCHES - 158 sq. ft. per bedroom. Trench to be 2 feet wide. Inlet 4 feet below original grade. Bottom maximum depth 8 feet below original grade. Effective area begins at 4 feet below original grade, 4 feet of stone below distribution pipe. LOCATION: Start first trench approx. 180 feet from the front lot line and 80 feet from the left lot line as seen when facing the property from Woodstock Road. Run trench(s) along level ground toward left rear of lot.
NOTE: No trench to exceed 100 feet in length. If more than one trench used, a distribution box is required. Call for inspection of trench(s) before and after gravel is installed. Provide 6"-8" diameter cleanout and cap to grade or above on septic tank.

INSTALLATION AREA LIMITED - OK TO INSTALL LEACHING BED 12' X 40'. CLK

PLANS APPROVED BY C. Williams DATE 6/19/85

COVER NO WORK UNTIL INSPECTED AND APPROVED

NEITHER THE HOWARD COUNTY COUNCIL NOR THE HEALTH DEPARTMENT IS RESPONSIBLE FOR THE SUCCESSFUL OPERATION OF ANY SYSTEM.

NOTE: IF TRENCH IS USED CALL FOR INSPECTION BEFORE AND AFTER PLACING GRAVEL IN TRENCH.

NOTE: NO DRY WELL SHALL EXCEED 15 FOOT IN DIAMETER. NO ABSORPTION TRENCH TO EXCEED 100 FEET IN LENGTH.

NOTE: ALL PIPE FROM HOUSE TO SEPTIC TANK MUST BE CAST IRON OR SCHEDULE 40 PVC OR ABS.

PERMIT VOID AFTER THREE YEARS.

NOTE: INSTALL STAND PIPE ON SEPTIC TANK AND DRY WELL. STAND PIPES MUST BE 6 INCHES IN DIAMETER. CAST IRON, CONCRETE OR TERRA COTTA, OR PVC OR ABS ACCEPTED IF TOP OF SEPTIC TANK IS DEEPER THAN 3 FEET MANHOLE TO GRADE REQUIRED.

*INSTALLER IS RESPONSIBLE FOR OBTAINING FINAL APPROVAL ON THIS PERMIT

*CALL 992-2330 FOR INSPECTION OF SEPTIC SYSTEMS.

EH - 2-1082

A 10561