

5/8/97  
Repair AM

# PERMIT

## SEWAGE DISPOSAL SYSTEM

### DEPARTMENT OF HEALTH AND MENTAL HYGIENE

NO record found

#### HOWARD COUNTY HEALTH DEPARTMENT

BUREAU OF ENVIRONMENTAL HEALTH

~~XXXX-XXXX~~ 313-2640

5-2-97  
PAID BY CHECK, #244  
\$25.00

P 58127

A REPAIR

DISTRICT \_\_\_\_\_

DATE 5/5/97

DATE SYSTEM APPROVED 5/8/97

INSPECTOR *ll*

INDEXED

Herman Sirk

IS PERMITTED TO INSTALL \_\_\_\_\_ ALTER ☒

ADDRESS 2555 Jennings Chapel Road, woodbine, Maryland PHONE 489-4724

SUBDIVISION \_\_\_\_\_ LOT \_\_\_\_\_ ROAD \_\_\_\_\_ Route 97

PROPERTY OWNER C. Oliver Goldsmith

ADDRESS Longwood Farms  
Route 97 MAIN HOUSE

SEPTIC TANK CAPACITY ? GALLONS

NUMBER OF BEDROOMS 4 ADD NEW DIST. BOX

180 SQUARE FEET PER BEDROOM WITH DISCONNECTION OF EXISTING TRENCHES

LINEAR FEET OF TRENCH REQUIRED 240 2-90' TRENCHES 4' WIDE

REPAIR - PURPOSE - SEPTIC SYSTEM HAS FAILED.

Call for inspection when ground is opened so sanitarian can recommend repair.  
05/01/97

1. TRENCH 4' WIDE, WITH 2 BOXES 4' OK TO REUSE STONE

TO 1.5' MAXIMUM BOXES DEPTH 4.5' TO ALLOW FOR CONTOUR

VARIATIONS IF NEEDED

SEPARATION BETWEEN TRENCHES MAY BE REDUCED TO 6" IF NEEDED  
DUE TO ROCK

PLANS APPROVED BY *ll* DATE 5/2/97

COVER NO WORK UNTIL INSPECTED AND APPROVED

NEITHER THE HOWARD COUNTY COUNCIL NOR THE HEALTH DEPARTMENT IS RESPONSIBLE FOR THE SUCCESSFUL OPERATION OF ANY SYSTEM

NOTE: CLEANOUT REQUIRED EVERY 70 FEET OF SEWER LINE AND/OR AT 90° SWEEPS IN LINES FROM HOUSE TO DRAIN FIELDS, 90° ELBOWS NOT ACCEPTABLE.

NOTE: ALL PARTS OF SEPTIC SYSTEMS (I.E. TANK, DISTRIBUTION BOX TRENCHES) TO BE 100 FEET FROM WELL (UNLESS OTHERWISE SPECIFICALLY AUTHORIZED)

NOTE: IF DEEP TRENCH(ES) ARE USED CALL FOR INSPECTION BEFORE AND AFTER PLACING GRAVEL IN TRENCH(ES)

NOTE: NO DRY WELL SHALL EXCEED 15 FOOT IN DIAMETER NO ABSORPTION TRENCH TO EXCEED 100 FEET IN LENGTH

NOTE: ALL PIPE FROM HOUSE TO SEPTIC TANK MUST BE CAST IRON OR SCHEDULE 35/40 PVC OR ABS

PERMIT VOID AFTER TWO YEARS

NOTE: INSTALL STAND PIPE ON SEPTIC TANK AND DRY WELL STAND PIPES MUST BE 6 INCHES IN DIAMETER CAST IRON. CONCRETE OR TERRA COTTA OR PVA OR ABS ACCEPTED. IF TOP OF SEPTIC TANK IS DEEPER THAN 3 FEET. MANHOLE TO GRADE REQUIRED.

NOTE: DISTRIBUTION BOXES MUST HAVE BAFFLES

\*INSTALLER IS RESPONSIBLE FOR OBTAINING FINAL APPROVAL ON THIS PERMIT

P 58127

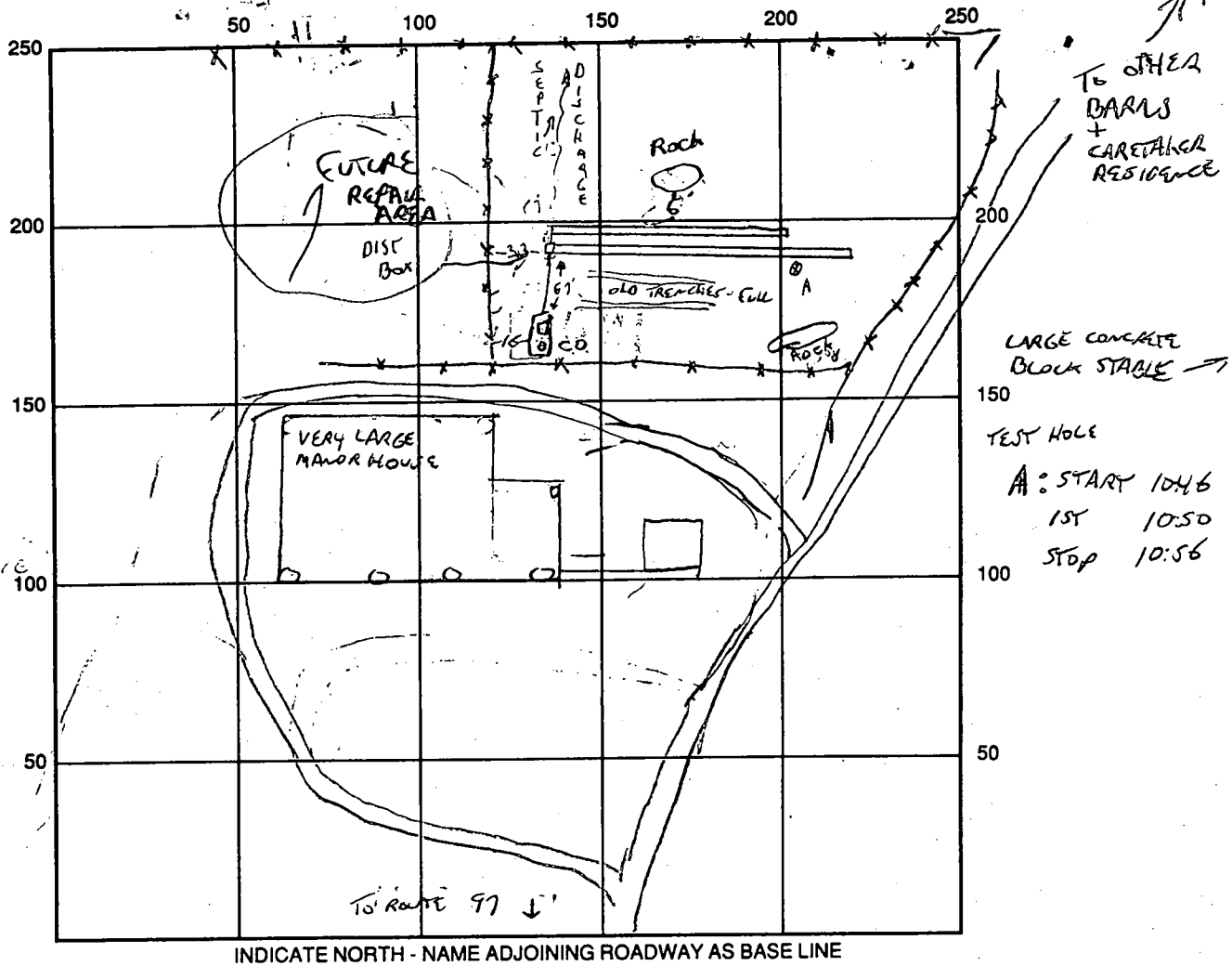

SEPTIC TANK LEVEL NA CLEANOUTS NA

DISTRIBUTION BOX LEVEL OK BAFEE IN

DRAIN FIELD/TITLE DEPTH 4 FT. TRENCH WIDTH 4 FT. INLET DEPTH 2 FT.

EFFECTIVE GRAVEL DEPTH 2 FT. TOTAL LENGTH 88/91 FT. = 179

NUMBER OF TRENCHES 2 ONE SIDEWALL/BOTTOM AREA        SQ. FT.

DRYWALL INSIDE DIAMETER        FT. EFFECTIVE DEPTH BELOW INLET        FT.

ABSORBENT AREA        SQ. FT.

REMARKS: 5/8/97 TRENCHES OK TO COVER, OLD DIST BOX  
REMOVED, OLD TRENCHES CUT OFF.

DATE SYSTEM APPROVED 5/8/97 INSPECTOR [Signature]

6/5/89  
(PM - after lunch)  
will proceed with the  
field

# PERMIT

SEWAGE DISPOSAL SYSTEM

MARYLAND STATE DEPARTMENT OF HEALTH DISTRICT \_\_\_\_\_

HOWARD COUNTY

BUREAU OF ENVIRONMENTAL HEALTH

461-9933

P 44466

A REPAIR

DATE 6/5/89

DATE SYSTEM APPROVED 6-9-89

INSPECTOR SAH

## INDEXED

Herman Sirk

IS PERMITTED TO INSTALL \_\_\_\_\_ ALTER X

ADDRESS 2555 Jennings Chapel Road, Woodbine, Maryland PHONE 489-4724

SUBDIVISION \_\_\_\_\_ ROAD Route 97 LOT \_\_\_\_\_

PROPERTY OWNER C. Oliver Goldsmith

ADDRESS Longwood Farms  
Route 97 TRAILER LOCATED IN REAR OF FARM

IF GARBAGE GRINDER IS USED INCREASE SEPTIC TANK CAPACITY BY 50% AND ABSORPTION AREA BY 22%.

GARBAGE GRINDER? YES \_\_\_\_\_ NO \_\_\_\_\_

SEPTIC TANK CAPACITY \_\_\_\_\_ GALLONS NUMBER OF BEDROOMS \_\_\_\_\_

REPAIR - CALL FOR INSPECTION WHEN GROUND IS OPENED UP SO SANITARIAN CAN RECOMMEND REPAIR.

INLET 3' BOTTOM 8' 5" STONE - 100 FEET OF TRENCH.

OK TO STONE TRENCH AS DUG.

PLANS APPROVED BY C. Williams DATE 6/02/89

COVER NO WORK UNTIL INSPECTED AND APPROVED

NEITHER THE HOWARD COUNTY COUNCIL NOR THE HEALTH DEPARTMENT IS RESPONSIBLE FOR THE SUCCESSFUL OPERATION OF ANY SYSTEM

NOTE: CLEANOUT REQUIRED EVERY 70 FEET OF SEWER LINE AND/OR AT 90° SWEEPS IN LINES FROM HOUSE TO DRAIN FIELDS

NOTE: ALL PARTS OF SEPTIC SYSTEMS (I.E. TANK DISTRIBUTION BOX TRENCHES) TO BE 100 FEET FROM WELL (UNLESS OTHERWISE SPECIFICALLY AUTHORIZED)

NOTE: IF DEEP TRENCHES ARE USED CALL FOR INSPECTION BEFORE AND AFTER PLACING GRAVEL IN TRENCHES

NOTE: NO DRY WELL SHALL EXCEED 15 FOOT IN DIAMETER NO ABSORPTION TRENCH TO EXCEED 100 FEET IN LENGTH

NOTE: ALL PIPE FROM HOUSE TO SEPTIC TANK MUST BE CAST IRON OR SCHEDULE 40 PVC OR ABS

PERMIT VOID AFTER TWO YEARS

NOTE: INSTALL STAND PIPE ON SEPTIC TANK AND DRY WELL STAND PIPES MUST BE 6 INCHES IN DIAMETER CAST IRON, CONCRETE OR TERRA COTTA OR PVC OR ABS ACCEPTED. IF TOP OF SEPTIC TANK IS DEEPER THAN 3 FEET, MANHOLE TO GRADE REQUIRED

NOTE: DISTRIBUTION BOXES MUST HAVE BAFFLES

\*INSTALLER IS RESPONSIBLE FOR OBTAINING FINAL APPROVAL ON THIS PERMIT

\*CALL 461-9933 FOR INSPECTION OF SEPTIC SYSTEMS.

44466

11.5" Hole

Silt Comm w/  
25-40% FROD  
from 3+ /

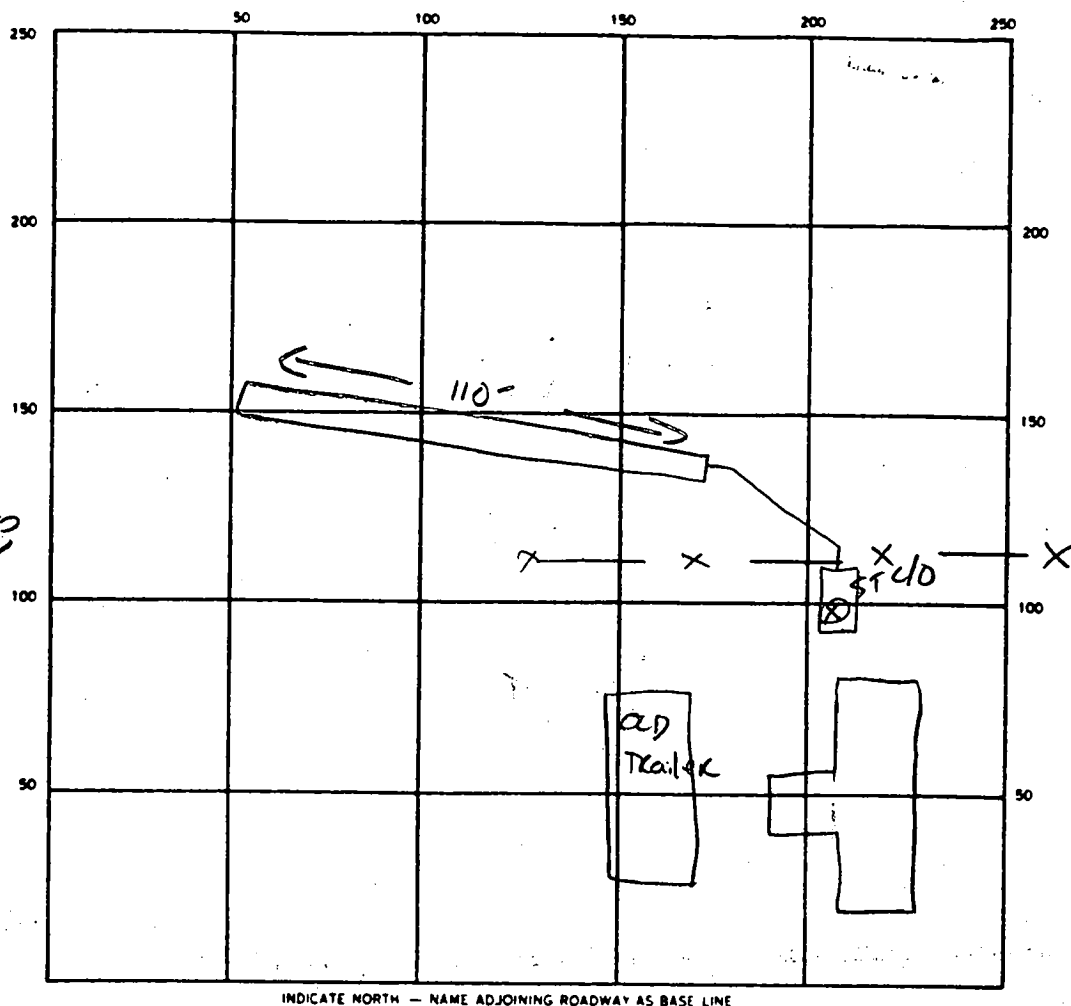

SEPTIC TANK LEVEL EXISTING CLEANOUTS EXISTING ST

DISTRIBUTION BOX LEVEL N/A

DRAIN FIELD/TILE FIELD DEPTH 8 FT TRENCH WIDTH 2 FT INLET DEPTH 3 FT

EFFECTIVE GRAVEL DEPTH 5 FT TOTAL LENGTH 110 FT

NUMBER OF TRENCHES 1 ONE SIDEWALL/BOTTOM AREA 550 SQ FT

DRYWELL INSIDE DIAMETER — FT EFFECTIVE DEPTH BELOW INLET — FT

ABSORBENT AREA 550 SQ FT

REMARKS 6/5/89 - EXISTING TRENCH SYST INTERCEPTED. WAS N 3' below grade w/ only  
STONE AND old ORANGE/CAST IRON PIPE; Replace w/ 100' of TRENCH w/ 5'  
STONE. Soils GOOD. Sabel

DATE SYSTEM APPROVED 6-9-89 INSPECTOR S. Abel

RC-DEO

RR-DEO

TRIADELPHIA ROAD  
(HOWARD COUNTY  
MINOR COLLECTOR)  
80' ULTIMATE R/W

-DEO

SHARP ROAD  
(HOWARD COUNTY  
LOCAL ROAD)  
60' R/W

RR-DEO

LOT 33

RR-DEO

LOT 15

LOT 72

RR-DEO

SURVEYED LOCATION  
OF EXISTING WELL

SURVEYED LOCATION OF  
EX. SPRING HOUSE

SURVEYED LOCATION  
OF EXISTING WELL

SURVEYED LOCATION  
OF EXISTING WELL

NAD'27

