

LAYOUT _____ INSP 4 _____

INSP 2 _____ INSP 5 _____

INSP 3 _____ INSP 6 _____

ISSUE DATE: _____

APPROVAL DATE: _____

PERMIT INDEXED

04-831451

P _____

A 508997

ON-SITE SEWAGE DISPOSAL SYSTEM HOWARD COUNTY HEALTH DEPARTMENT BUREAU OF ENVIRONMENTAL HEALTH

_____ IS PERMITTED TO INSTALL ☐ ALTER ☐

ADDRESS: _____ PHONE NUMBER: _____

SUBDIVISION: Burntwoods LOT NUMBER: 1, Bl B, S 3

ADDRESS: 3301 Sharp Road PROPERTY OWNER: Steve Feld

SEPTIC TANK CAPACITY (GALLONS): _____ OUTLET BAFFLE FILTER REQUIRED ☐

PUMP CHAMBER CAPACITY (GALLONS): _____ COMPARTMENTED TANK REQUIRED ☐

NUMBER OF BEDROOMS: _____

SQUARE FEET PER BEDROOM: _____

LINEAR FEET OF TRENCH REQUIRED: _____

TRENCHES:	Trench to be _____ feet wide. Inlet _____ feet below original grade. Bottom maximum depth _____ feet below original grade. Effective area begins at _____ feet below original grade. _____ feet of stone below distribution pipe.
LOCATION:	BUILDING PERMIT SIGNED AND RETURNED
NOTES:	6/3/2004 B00148657 Front porch and foyer

PLANS APPROVED: _____ DATE: _____

NOTE: PERMIT VOID AFTER 2 YEARS

NOTE: CONTRACTOR RESPONSIBLE FOR SCHEDULING A PRE-CONSTRUCTION INSPECTION FOR ALL INSTALLATIONS

NOTE: WATERTIGHT SEPTIC TANKS REQUIRED

NOTE: ALL PARTS OF SEPTIC SYSTEM SHALL BE 100 FEET FROM ANY WATER WELL

NOTE: MANHOLE RISERS REQUIRED ON ALL SEPTIC TANKS AND PUMP CHAMBERS UNLESS SPECIFICALLY AUTHORIZED

**NEITHER THE HOWARD COUNTY COUNCIL NOR THE HEALTH DEPARTMENT IS
RESPONSIBLE FOR THE SUCCESSFUL OPERATION OF ANY SYSTEM
PERMITTEE RESPONSIBLE FOR OBTAINING FINAL APPROVAL ON THIS PERMIT
CALL 410-313-2640 FOR INSPECTION OF SEPTIC SYSTEM**

A 508997

11/12/67
After 17 noon

11-5-67
11-5-67

PERMIT

SEWAGE DISPOSAL SYSTEM

MARYLAND STATE DEPARTMENT OF HEALTH

HOWARD COUNTY

INDEXED

ELLICOTT CITY

DISTRICT 3

DATE 11/6/67

P 15.2.29

A 03997

Jack Fyock

IS PERMITTED TO INSTALL X ALTER

ADDRESS Ten Oaks Rd., Dayton, Maryland PHONE

A SEWAGE DISPOSAL SYSTEM LOCATED AT

SUBDIVISION Burnt Wood ROAD 3301 Sharp Rd. LOT 1, Blk. B,

Sec. 3 Part 2

PROPERTY OWNER Burnt Woods Development Co., Inc.

ADDRESS

SPECIFICATIONS - 4 bedrooms

Carl
Linsart
(new owner)

DRAIN FIELD DEPTH FEET, BOTTOM AREA SQ. FT.

SEEPAGE PITS ABSORBENT SIDE-WALL AREA SQ. FT.

SEPTIC TANK CAPACITY 1,000 GALLONS

FOR GARBAGE GRINDER, INCREASE DISPOSAL AREA 22% & TANK CAPACITY 50%.

OTHER Dry well - 112 sq. ft. sidewall area below the inlet pipe per bedroom.

Inlet pipe to be 4 ft. below grade.

Place dry well about 65 ft. from front lot line and about 15 ft. from right side

as seen when facing lot from Sharp Rd.

MAXIMUM DEPTH PERMITTED 14' below original grade. PERMIT VOID AFTER THREE YEARS?

PLANS APPROVED BY D. W. Monaghan DATE 9/23/64

FILL SEPTIC TANK AND DISTRIBUTION BOX WITH WATER BEFORE CALLING FOR AN INSPECTION. COVER NO WORK UNTIL INSPECTED AND APPROVED.

NEITHER THE HOWARD COUNTY COMMISSIONERS NOR THE HEALTH DEPARTMENT IS RESPONSIBLE FOR THE SUCCESSFUL OPERATION OF ANY SYSTEM.

NOTIFY THE HEALTH DEPARTMENT 48 HOURS
BEFORE EXCAVATIONS ARE TO BE BACK FILLED.

03997

WR-W-4
4-66

State Office Building
ANNAPOLIS, MARYLAND 21401

STATE OF MARYLAND

DEPARTMENT OF
WATER RESOURCES

THIS REPORT
MUST BE SUBMITTED
WITHIN 30 DAYS
AFTER COMPLETION
OF THE WELL

WELL COMPLETION REPORT

A 08997

WELL DESCRIPTION

Lot 1B Sec 3

WELL LOG

State the kind of formations penetrated, their color, their depth, their thickness, and if water-bearing

CASING AND SCREEN RECORD

State the kind and size and position of casing, liner, shoe, screen, and other accessories (if no casing used, give diameter of well).

Permit Number 2068W97
Owner Carl Zwart
Address Blundell Rd
Subdivision Burialwood
Section 3 Lot 1

PUMPING TEST

Hours Pumped 1
Type of Pump Used Bayern
Pumping Rate _____
Gallons per Minute 7

WATER LEVEL

(Distance from land surface to water)

Before Pumping 50 Ft.
When Pumping 65 Ft.

APPEARANCE OF WATER

Clear Partly Cloudy _____
Taste None
Odor None

Height of Casing Above Land

Surface 2 Ft.

PUMP INSTALLED

Type _____
Capacity _____
Gallons per Minute _____
Gallons per Hour _____
Pump Column Length _____ Ft.

LOCATION OF WELL ON LOT

Show permanent structures such as building(s), septic tank, and/or other landmarks and indicate not less than 2 distances (measurements) to well.

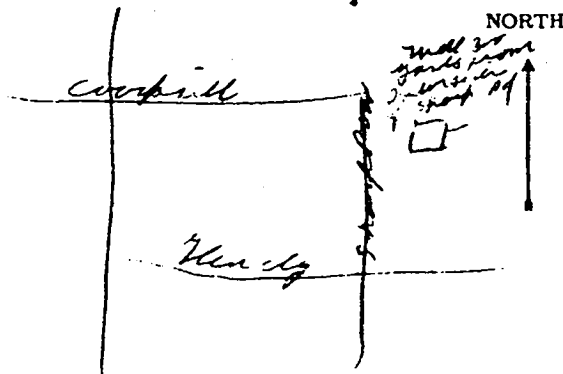

DATE
WELL WAS
COMPLETED

I hereby affirm that this report contains no willful misrepresentation or falsifications and that information given in this report is true, accurate and complete to the best of my knowledge and belief.

Dwight Brown, Well Driller

Well Driller License No.: 113

Nov 30 1967

HEALTH

A# 08997

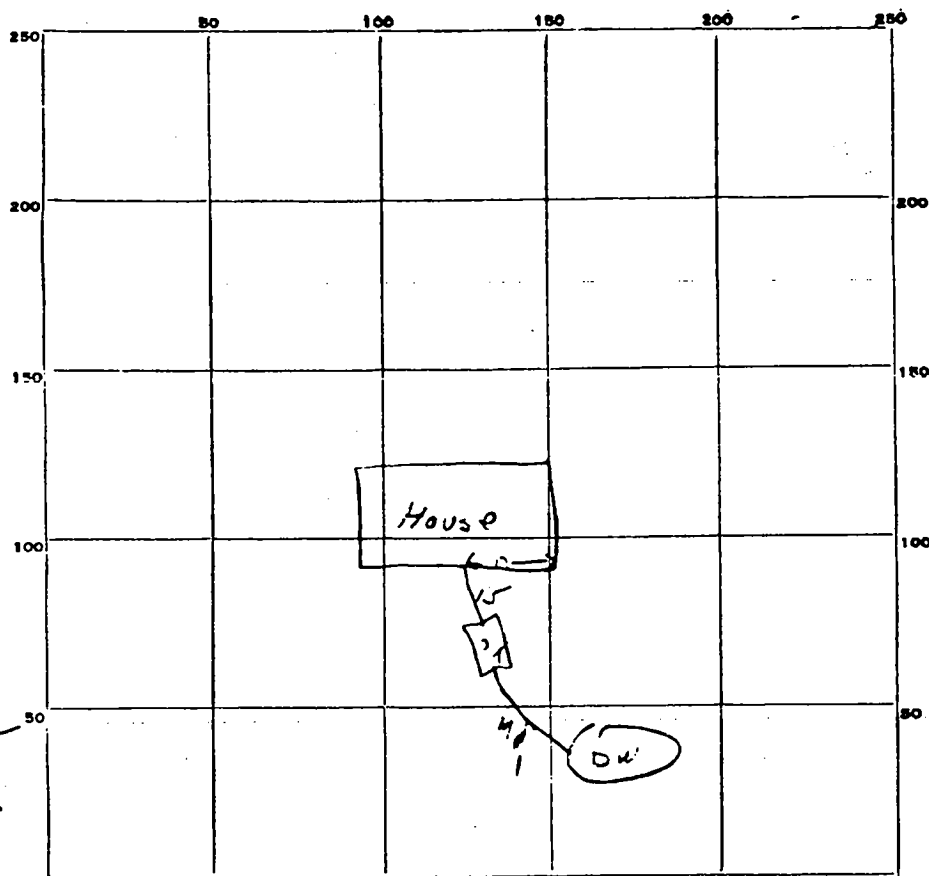

INDICATE NORTH. - NAME ADJOINING ROADWAY AS BASE LINE.

Sharp Road

PERMIT CARD OKSEPTIC TANK, LEVEL OKCLEANOUTS OK

DISTRIBUTION BOX, LEVEL _____

TILE FIELD, DEPTH _____ FT. TRENCH WIDTH _____ FT.

GRAVEL DEPTH _____ IN. TOTAL LENGTH _____ FT.

NUMBER OF TRENCHES _____ TOTAL BOTTOM AREA _____

SEEPAGE PITS, ^{outside} ~~inside~~ DIAMETER 17 FT. DEPTH BELOW INLET 9 1/2 ^{effective} ~~1~~ FT.ABSORBENT AREA 507.11 SQ. FT.REMARKS 11/15/67 - per from house to tank cut in. split 3' x 6' hole instead of 4' x 4' - drill below unit set - effective depth 9 1/2 ft. less

A# 08997

9/15/64 drill test 142 11 in at 5 1/2', 8 in at 10 1/2' ft.
384 13 in at 5 1/2', 11 in at 10 1/2' ft.D.W. Spaced on East hole 142, 384 were
to center of pit & close to road.per
also L. BurtDATE SYSTEM APPROVED 11/15/67INSPECTOR Lee Monaghan

FBLD

SCALE: 1" = 40'

N 07° 05' 56" E
89.76'

10' DRAINAGE EASEMENT

LOT 1 - BLOCK B - SEC. 3, PART 2
"BURNTHOOD"
10/21

APPROVED

WALK-THRU BUILDING PERMIT

BP# 00148657 A# 008997

APP. SAN KJB DATE: 6/3/04

DESC. OF WORK: Deck

5' UTILITY EASEMENT

N 79° 44' 00" E
268.95'

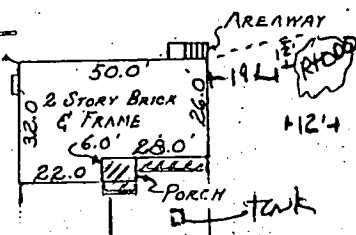

75' BUILDING

RESTRICTION LINE
D.W.

96'

100' ±

124.00'

N 10° 16' 00" W

SHARP ROAD

134.02 TO P.C.
@ Castle Gate Dr.

This is to certify that I have surveyed the property known as LOT 1 - BLOCK B - SECTION 3
"BURNTHOOD" 3RD ELECTION DISTRICT HOWARD CO., MARYLAND

for the purpose of locating the improvements thereon, and the improvements are located as shown.

Signed this 15th day of November 19 04

William J. Purdum
Engineer and Land Surveyor

PURDUM AND JESCHKE
ENGINEERS AND LAND SURVEYORS
24 PARK AVE.
ELLCOTT CITY, MARYLAND 21042

This plat is not intended for use in
the establishment of property lines.

A-08997