

5/30/2000
10:30

PERMIT
SEWAGE DISPOSAL SYSTEM
HOWARD COUNTY HEALTH DEPARTMENT
BUREAU OF ENVIRONMENTAL HEALTH
410-313-2640

P 513584-C

A REPAIR

INDEXED

ISSUE DATE 5-9-2000

APPROVAL DATE 6/5/00

04-323947

Arnolds Backhoe & Septic Service

IS PERMITTED TO INSTALL ALTER ☒

ADDRESS P.O. Box 15, Woodbine, MD 21797

PHONE 410-795-7873

SUBDIVISION LOT NUMBER ADDRESS 700 Ridge Road

PROPERTY OWNER Steve Hannon

PROPERTY OWNER'S ADDRESS Same

SEPTIC TANK CAPACITY GALLONS

PUMP CHAMBER CAPACITY GALLONS

NUMBER OF BEDROOMS

SQUARE FEET PER BEDROOM

LINEAR FEET OF TRENCH REQUIRED

TRENCHES: Trenches to be feet wide. Inlet feet below original grade. Bottom maximum depth
feet below original grade. feet of stone below distribution box.

LOCATION:

REPAIR - PURPOSE- Existing septic system has failed.

Call for inspection when ground is opened so sanitarian can recommend repair 5-9-

PLANS APPROVED DATE

PERMIT VOID AFTER 2 YEARS

NOTE: CONTRACTOR RESPONSIBLE FOR SCHEDULING A PRE-CONSTRUCTION INSPECTION FOR ALL INSTALLATIONS

NOTE: TOP OF SEPTIC TANKS ARE TO BE NO DEEPER THAN 3.0 FEET BELOW FINISH GRADE

NOTE: WATERTIGHT SEPTIC TANKS REQUIRED

NOTE: CLEANOUT REQUIRED EVERY 70 FEET OF SEWER LINE AND/OR AT 90° SWEEPS IN LINES FROM HOUSE TO DRAIN FIELDS, 90° ELBOWS ARE NOT ACCEPTABLE

NOTE: ALL PARTS OF SEPTIC SYSTEMS (I.E. TANK, DISTRIBUTION BOX, DRAINFIELDS) TO BE 100 FEET FROM ANY WATER WELL UNLESS OTHERWISE SPECIFICALLY AUTHORIZED

NOTE: NO ABSORPTION TRENCH TO EXCEED 100 FEET IN LENGTH UNLESS SPECIFICALLY AUTHORIZED

NOTE: ALL PIPE FROM HOUSE TO SEPTIC TANK MUST BE CAST IRON OR SCHEDULE 35/40 PVC OR ABS

NOTE: MANHOLE RISERS REQUIRED ON ALL SEPTIC TANKS AND PUMP CHAMBERS

NOTE: DISTRIBUTION BOXES MUST HAVE BAFFLES

NOTE: IF PUMPED SEPTIC SYSTEM REQUIRED, (1) SEPTIC PUMP DETAIL TO BE PROVIDED BY INSTALLER PRIOR TO ISSUANCE OF SEPTIC PERMIT (2) PUMP PERFORMANCE TEST IS NECESSARY PRIOR TO HEALTH DEPARTMENT APPROVAL OF SEPTIC PERMIT

NEITHER THE HOWARD COUNTY COUNCIL NOR THE HEALTH DEPARTMENT IS RESPONSIBLE FOR THE
SUCCESSFUL OPERATION OF ANY SYSTEM
PERMITTEE RESPONSIBLE FOR OBTAINING FINAL APPROVAL ON THIS PERMIT
CALL 410-313-2640 FOR INSPECTION OF SEPTIC SYSTEM

513584-C

NOT TO SCALE

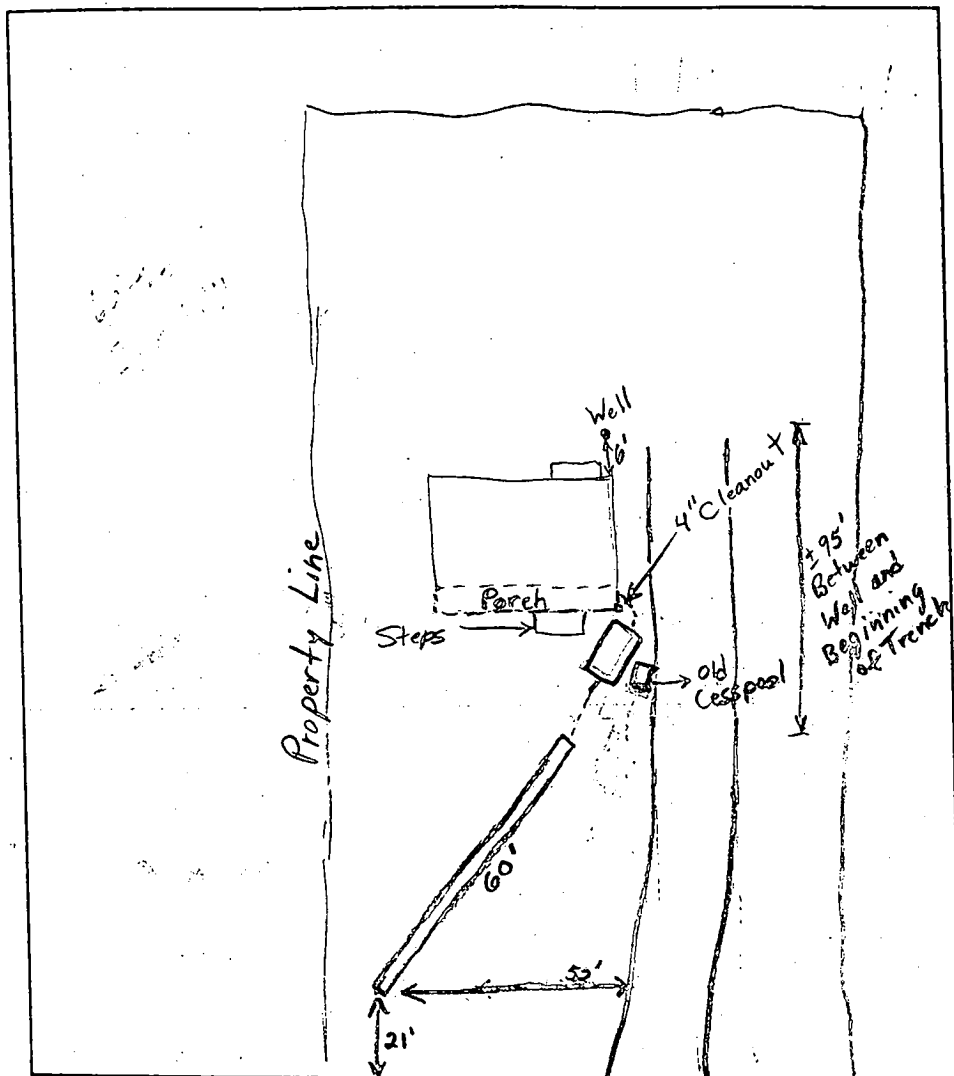

Existing
TRENCH DATA

TRENCH WIDTH 2.0'
TRENCH INLET DEPTH 4.0'
TRENCH BOTTOM DEPTH _____
DEPTH OF STONE _____
NUMBER OF TRENCHES 1
TOTAL TRENCH LENGTH 60'
ABSORBENT AREA _____
DISTRIBUTION BOX LEVEL _____
BAFFLE IN DISTRIBUTION BOX _____

SEPTIC TANK DATA

SEPTIC TANK 1500 (2-compartment) GALLONS

MANHOLE RISER _____

6 INCH INSPECTION PORT _____

PUMP CHAMBER DATA N/A

PUMP CHAMBER GALLONS _____

MANHOLE RISER _____

ALARM _____

PUMP PERFORMANCE TEST _____

Ridge Road

PRE-CONSTRUCTION INSPECTION: 5/30/00 Limited area for repairs in front yard. Back yard unusable.

Existing system is a cesspool that appears to have had a trench connected to it at a later time.

INSPECTION COMMENTS: Don't know if trench is failing, pipe is clogged. Cesspool to be replaced with septic tank. 6/5/00. Dig up existing trench, still appears usable. Pipe in trench to be replaced and regravelled. New tank installed. Old cesspool collapsed and filled. Contractor said he would install manhole riser 1000 gal side of tank and manhole riser or inspection port on other side. (BB)

INSPECTOR

B. Baker

DATE SYSTEM APPROVED

6/5/00

APPLICATION

PERCOLATION TESTING

A _____

P _____

HOWARD COUNTY HEALTH DEPARTMENT

BUREAU OF ENVIRONMENTAL HEALTH

3525-H ELLICOTT MILLS DRIVE/ELLICOTT CITY, MARYLAND 21043
TELEPHONE: 313-2640

DISTRICT _____

DATE _____

TO: THE COUNTY HEALTH OFFICER
ELLICOTT CITY, MARYLAND

I HEREBY APPLY FOR THE NECESSARY TEST PRIOR TO APPLICATION FOR PERMIT TO CONSTRUCT (OR RECONSTRUCT) A SEWAGE DISPOSAL SYSTEM.

PROPERTY OWNER Steve Hannon

ADDRESS 700 Ridge Road PHONE 410-313-6420

McAury, MD 21771

AGENT OR PROSPECTIVE BUYER _____

ADDRESS _____ PHONE _____

PROPERTY LOCATION:

SUBDIVISION FM 17 9 362 LOT NO. 2384 ??

ROAD AND DESCRIPTION _____

TAX MAP _____ PARCEL # _____

SIZE OF LOT Existing 3 Bedroom TYPE BLDG. Single Family

(SINGLE FAMILY DWELLING OR COMMERCIAL)

THE SYSTEM INSTALLED UNDER THIS APPLICATION IS ACCEPTABLE ONLY UNTIL PUBLIC FACILITIES BECOME AVAILABLE. I FULLY UNDERSTAND THE

FEE CONNECTED WITH THE FILING OF THIS PERC TEST APPLICATION IS NON-REFUNDABLE UNDER ANY CIRCUMSTANCES. I ALSO AGREE TO

COMPLY WITH ALL M.O.S.H.A. REQUIREMENTS IN TESTING THIS LOT. James V. Harrison ACR

(SIGNATURE OF APPLICANT)

APPROVED BY _____ FOR _____ DATE _____

DISAPPROVED BY _____ FOR _____ DATE _____

HOLD PENDING FURTHER TESTS _____

REASONS FOR REJECTION OR HOLDING _____

PERCOLATION TEST PLAT/PRELIMINARY PLAT - TITLE OR I.D. # _____ DATE _____

SITE DEVELOPMENT PLAN/FINAL PLAT - TITLE OR I.D. # _____ DATE _____

THIS IS NOT A PERMIT

COUNTY #

SOIL PROFILE

0'

Red Brown
Clay Loam

6.5'

Red Brown
Clay Loam

45% Rock

13.5'

dark brn hL
 bl-red brn
 CL m Pi-mbr
 10% channer (small)
 4 1/2' yel bl-red brn
 CL
 (mbr)
 25% v f ch
 6 1/2' 5-10% f ch
 yel bl/yel brn/yel
 hL-L mbr
 (2-25% v f ch mbr)
 20-25% sa-mch
 mottled bl and
 channer schist

very few
larger stones

13.5'

SOIL PROFILE

0'

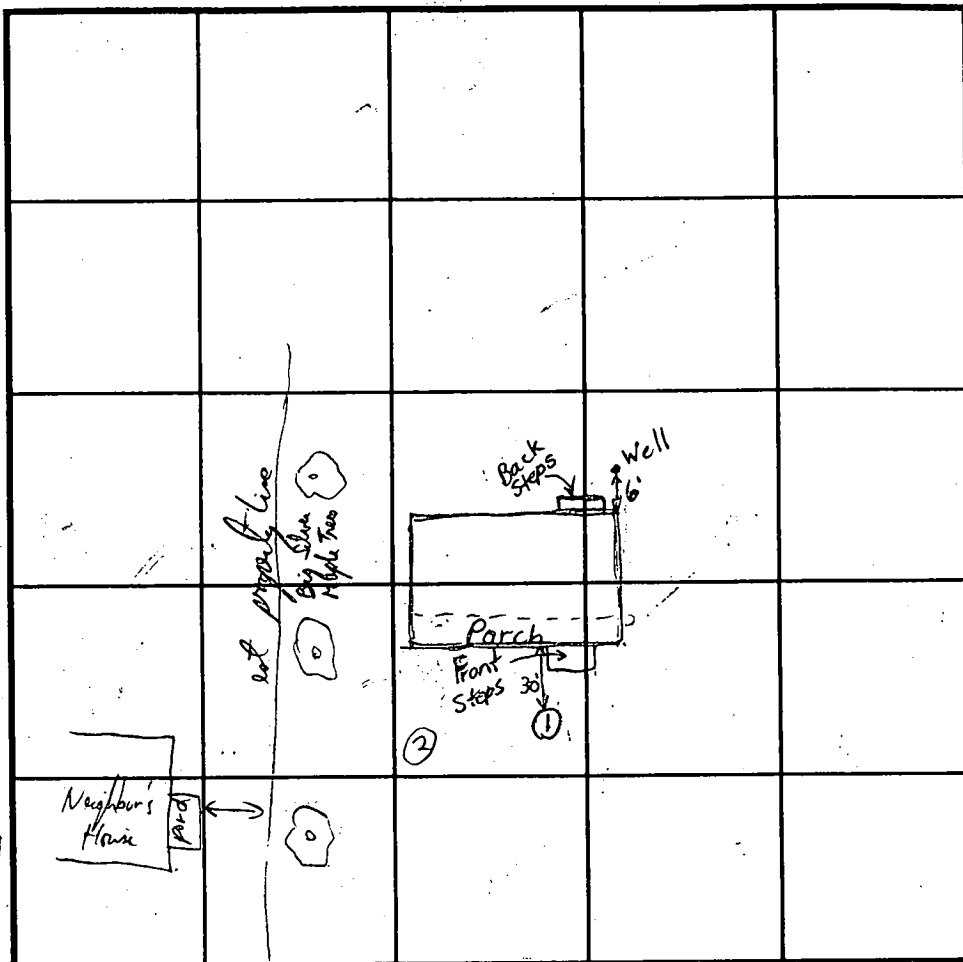

INDICATE NORTH - NAME ADJOINING ROADWAY AS BASE LINE.

Ridge Road

DATE	TEST NO.	DEPTH	PRE-WET		TEST - 1" DROP		TIME
			START	STOP	START	STOP	
5/30/00	1	7' / 13.5V	11:56	11:59	11:59	12:05	6
6/5/00	2	No Test	observation only		in very fine channer hL-L @ 6 1/2' - 13 1/2'		est. 6 mpi

REMARKS

TYPE OF SOIL

TESTED BY B. Baker

ALSO PRESENT

TRENCH DESIGN DATA: AVERAGE PERCOLATION TIME 6 mpiTRENCH WIDTH 3INLET DEPTH 6 1/2MAXIMUM BOTTOM DEPTH 8-8 1/2 OK

SQ. FT./BEDROOM

125 sq ft

PERMIT

SEWAGE DISPOSAL SYSTEM

MARYLAND STATE DEPARTMENT OF HEALTH*

HOWARD COUNTY

INDEXED

ELLICOTT CITY

DISTRICT _____

DATE 6/13/78

app 7-11-78
Jew

P 28202

A REPAIR

Herman Sirk

IS PERMITTED TO INSTALL _____ ALTER X

ADDRESS _____ PHONE _____

SUBDIVISION _____ ROAD Route 27 LOT _____

1st house on right past Penn Shop Road, Mt. Airy

PROPERTY OWNER Dorothy Day

ADDRESS Route 27, Mt. Airy

SPECIFICATIONS

SEPTIC TANK CAPACITY _____ GALLONS

DRAIN FIELD _____ DEPTH _____ FEET, BOTTOM AREA _____ SQ. FT.

DEEP TRENCH _____ DEPTH _____ FEET, BOTTOM AREA _____ SQ. FT.

SEEPAGE PITS _____ ABSORBENT SIDE-WALL AREA _____ SQ. FT.

INLET PIPE _____ FT. BELOW ORIGINAL GRADE. MAXIMUM DEPTH _____ FT. BELOW ORIGINAL GRADE

EFFECTIVE DEPTH AT _____ FT. BELOW ORIGINAL GRADE.

LOCATE DISPOSAL AREA _____ FT. FROM _____ LOT LINE AND _____ FT. FROM _____ LOT LINE AS SEEN WHEN
FACING LOT FROM

REPAIR-CALL FOR INSPECTION WHEN GROUND IS OPENED UP SO SANITARIAN CAN RECOMMEND

REPAIR.

Trench 1 ft deep - 55 ft long - 5 ft. dia

PLANS APPROVED BY Palmer F. Wine DATE 6/13/78

COVER NO WORK UNTIL INSPECTED AND APPROVED.

NEITHER THE HOWARD COUNTY COUNCIL NOR THE HEALTH DEPARTMENT IS RESPONSIBLE FOR THE SUCCESSFUL OPERATION OF ANY SYSTEM.

NOTE: IF TRENCH IS USED CALL FOR INSPECTION BEFORE PLACING GRAVEL IN TRENCH.

NOTE: NO DRY WELL SHALL EXCEED 15 FOOT IN DIAMETER.

NOTE: ALL PIPE FROM HOUSE TO DISPOSAL AREA MUST BE CAST IRON.

PERMIT VOID AFTER THREE YEARS.

NOTE: INSTALL STAND PIPE ON SEPTIC TANK AND DRY WELL. STAND PIPES MUST BE 6 INCHES IN DIAMETER. CAST IRON, CONCRETE OR TERRA
COTTA ACCEPTED.

*INSTALLER IS RESPONSIBLE FOR OBTAINING FINAL APPROVAL ON THIS PERMIT.

28202

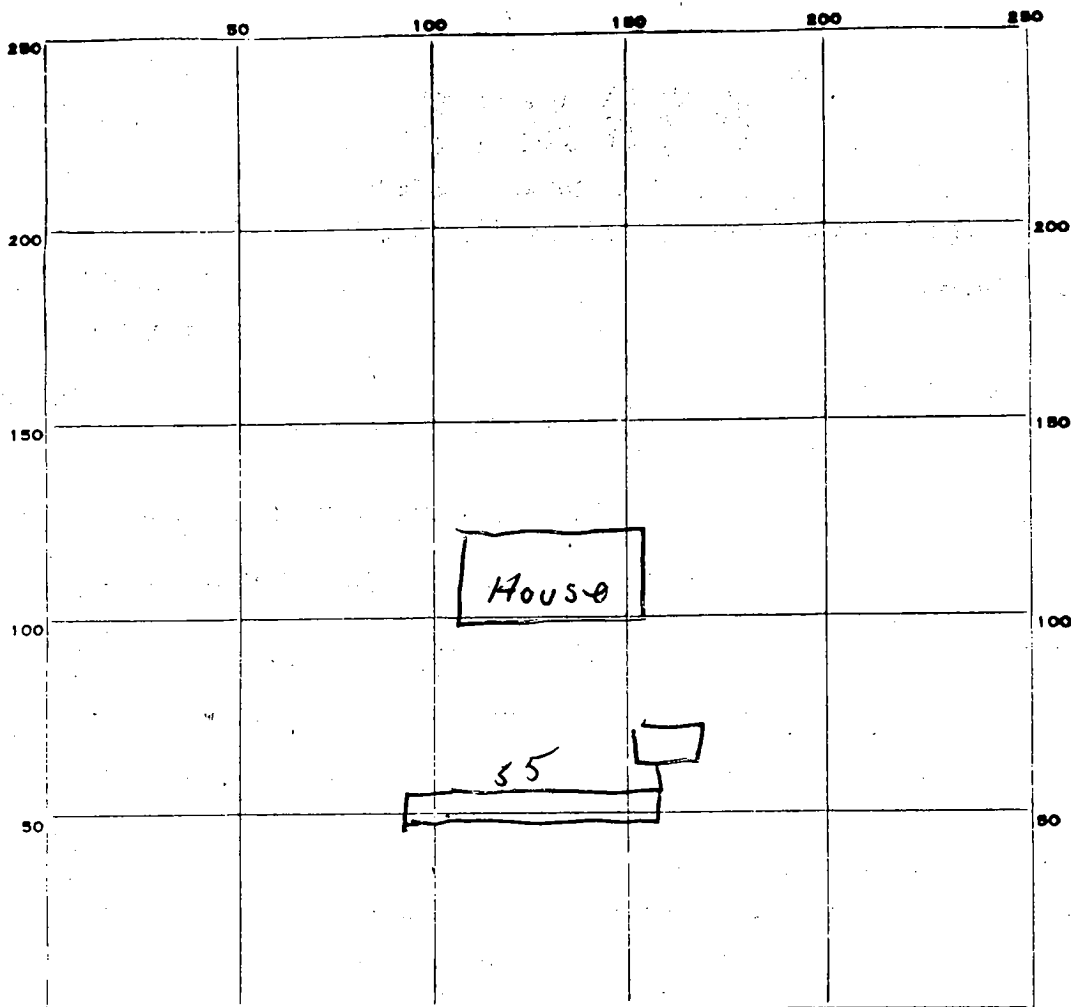

INDICATE NORTH - NAME ADJOINING ROADWAY AS BASE LINE.

RT. 27

PERMIT CARD OK

SEPTIC TANK, LEVEL _____

CLEANOUTS OK

DISTRIBUTION BOX, LEVEL _____

TILE FIELD, DEPTH 13 FT. TRENCH WIDTH 2 FT.

GRAVEL DEPTH 60 IN. TOTAL LENGTH 55 FT.

NUMBER OF TRENCHES 1 TOTAL BOTTOM AREA 110

SEEPAGE PITS, INSIDE DIAMETER _____ FT. DEPTH BELOW INLET _____ FT.

ABSORBENT AREA 275 SQ. FT.

REMARKS _____

DATE SYSTEM APPROVED 2-11-78

INSPECTOR W. Monaghan

Going South from I 70
 Fourth house on right
 after you pass Penn Shop Rd. ??
 or just past Penn Shop Rd. ??

MAP FZ

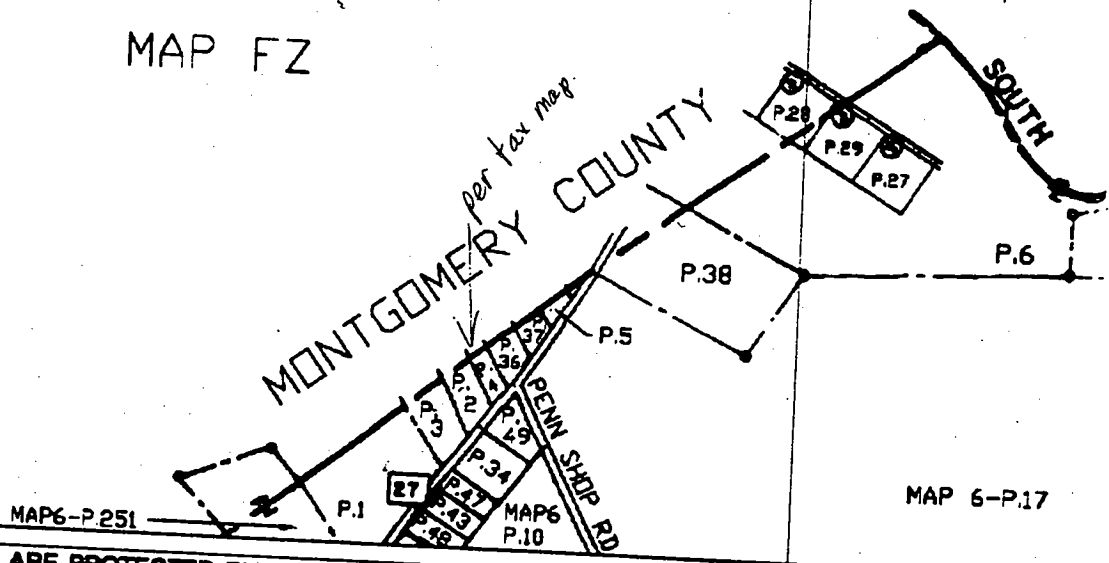

IT - 1992 BY THE
 MARYLAND
 IS RESERVED.

THESE MAPS ARE PROTECTED BY COPYRIGHT. THEY MAY NOT BE COPIED
 OR REPRODUCED IN ANY FORM INCLUDING ELECTRONIC MEANS SUCH AS
 DIGITIZING, SCANNING, VECTORIZING, OR IMAGE PROCESSING OR BY ANY
 SYSTEM NOW KNOWN OR TO BE INVENTED WITHOUT PERMISSION IN
 WRITING FROM THE MARYLAND OFFICE OF PLANNING.

749

752

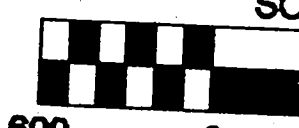

EFFECTIVE AREA
 $6\frac{1}{2} - 9\frac{1}{2}$

2 BOTTOM

6"
 18" SIDEWALL
 FOR VARIABILITY

150
 $\times 3$
~~450~~

24"

$6\frac{1}{2} - 8\frac{1}{2}$

ONE
 SIDEWALL

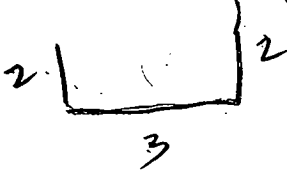

2W

7 \approx 8 \approx 9

50%
 12-50
 IN A PINCH

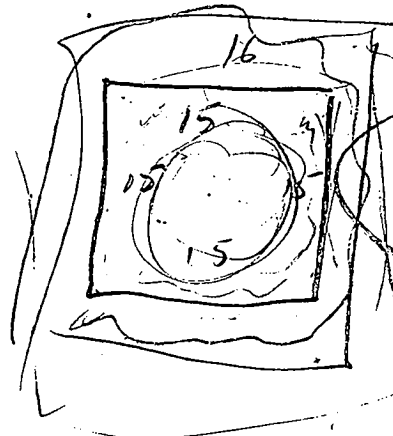

$60 \times 3 = 60$ TRAIL

120 \approx

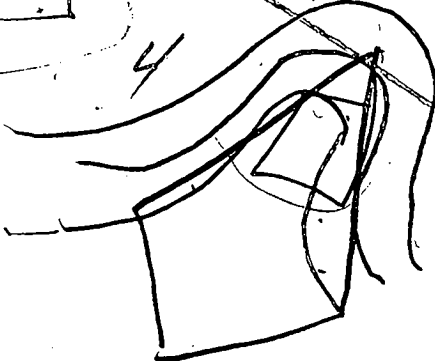

150