

Building Address: 15945 South Ave  
Lisbon MD 21765

Suite/Apt. # \_\_\_\_\_ SDP/WP/BA #: \_\_\_\_\_

Census Tract: \_\_\_\_\_ Subdivision: \_\_\_\_\_

Section: \_\_\_\_\_ Area: \_\_\_\_\_ Lot: \_\_\_\_\_

Tax Map: 7 Parcel: \_\_\_\_\_ Grid: \_\_\_\_\_

Zoning: \_\_\_\_\_ Map Coordinates: \_\_\_\_\_ Lot Size: 1 Acre

Existing Use: \_\_\_\_\_

Proposed Use: \_\_\_\_\_

Estimated Construction Cost: \$ \_\_\_\_\_

Description of Work: Hot Tub

Occupant or Tenant: \_\_\_\_\_

Was tenant space previously occupied? ☐ Yes ☐ No

Contact Name: \_\_\_\_\_

Address: \_\_\_\_\_

City: \_\_\_\_\_ State: \_\_\_\_\_ Zip Code: \_\_\_\_\_

Phone: \_\_\_\_\_ Fax: \_\_\_\_\_

Email: \_\_\_\_\_

Property Owner's Name: Jasper Lee Smith

Address: P O Box 194

City: Lisbon State: MD Zip Code: 21765

Home Phone: 410 489 7563 Work Phone: 301 206 7489

Applicant's Name & Mailing Address, (If other than stated herein): \_\_\_\_\_

Phone: \_\_\_\_\_ Fax: \_\_\_\_\_

Email: JLSmith@verizon.net

Contractor Company: \_\_\_\_\_

Contact Person: \_\_\_\_\_

Address: \_\_\_\_\_

City: \_\_\_\_\_ State: \_\_\_\_\_ Zip Code: \_\_\_\_\_

License No. : \_\_\_\_\_

Phone: \_\_\_\_\_ Fax: \_\_\_\_\_

Email: \_\_\_\_\_

Engineer/Architect Company: \_\_\_\_\_

Responsible Design Prof.: \_\_\_\_\_

Address: \_\_\_\_\_

City: \_\_\_\_\_ State: \_\_\_\_\_ Zip Code: \_\_\_\_\_

Phone: \_\_\_\_\_ Fax: \_\_\_\_\_

Email: \_\_\_\_\_

BUILDING DESCRIPTION - COMMERCIAL

Building Characteristics	Utilities
Height:	<u>Water Supply</u>
No. of stories:	<input type="checkbox"/> Public
Gross area, sq. ft./floor:	<input type="checkbox"/> Private
	<u>Sewage Disposal</u>
Area of construction (sq. ft.):	<input type="checkbox"/> Public
	<input type="checkbox"/> Private
Use group:	Electric: <input type="checkbox"/> Yes <input type="checkbox"/> No
	Gas: <input type="checkbox"/> Yes <input type="checkbox"/> No
<u>Construction type:</u>	<u>Heating System</u>
<input type="checkbox"/> Reinforced Concrete	<input type="checkbox"/> Electric <input type="checkbox"/> Oil
<input type="checkbox"/> Structural Steel	<input type="checkbox"/> Natural Gas <input type="checkbox"/> Propane Gas
<input type="checkbox"/> Masonry	<u>Sprinkler System:</u>
<input type="checkbox"/> Wood Frame	<input type="checkbox"/> N/A
<input type="checkbox"/> State Certified Modular	<input type="checkbox"/> Full
<input checked="" type="checkbox"/> Roadside Tree Project Permit	<input type="checkbox"/> Partial
<input type="checkbox"/> Yes <input type="checkbox"/> No	<input type="checkbox"/> Other Suppression
Roadside Tree Project Permit #	No. of Heads:

BUILDING DESCRIPTION - RESIDENTIAL

Building Characteristics	Utilities
<input type="checkbox"/> SF Dwelling <input type="checkbox"/> SF Townhouse	<u>Water Supply</u>
<u>Depth</u> <u>Width</u>	<input type="checkbox"/> Public
1 <sup>st</sup> floor:	<input checked="" type="checkbox"/> Private
2 <sup>nd</sup> floor:	<u>Sewage Disposal</u>
Basement:	<input type="checkbox"/> Public
<input type="checkbox"/> Finished Basement	<input checked="" type="checkbox"/> Private
<input type="checkbox"/> Unfinished Basement	Electric: <input type="checkbox"/> Yes <input type="checkbox"/> No
<input type="checkbox"/> Crawl Space	Gas: <input type="checkbox"/> Yes <input type="checkbox"/> No
<input type="checkbox"/> Slab on Grade	<u>Heating System</u>
No. of Bedrooms:	<input type="checkbox"/> Electric
<u>Multi-family Dwelling</u>	<input type="checkbox"/> Oil
No. of efficiency units:	<input type="checkbox"/> Natural Gas
No. of 1 BR units:	<input type="checkbox"/> Propane Gas
No. of 2 BR units:	
No. of 3 BR units:	
Other Structure:	
Dimensions:	
Footings:	<input checked="" type="checkbox"/> Roadside Tree Project Permit
Roof:	<input type="checkbox"/> Yes <input type="checkbox"/> No
<input type="checkbox"/> State Certified Modular	Roadside Tree Project Permit #
<input type="checkbox"/> Manufactured Home	

THE UNDERSIGNED HEREBY CERTIFIES AND AGREES AS FOLLOWS: (1) THAT HE/SHE IS AUTHORIZED TO MAKE THIS APPLICATION; (2) THAT THE INFORMATION IS CORRECT; (3) THAT HE/SHE WILL COMPLY WITH ALL REGULATIONS OF HOWARD COUNTY WHICH ARE APPLICABLE THERETO; (4) THAT HE/SHE WILL PERFORM NO WORK ON THE ABOVE REFERENCED PROPERTY NOT SPECIFICALLY DESCRIBED IN THIS APPLICATION; (5) THAT HE/SHE GRANTS COUNTY OFFICIALS THE RIGHT TO ENTER ONTO THIS PROPERTY FOR THE PURPOSE OF INSPECTING THE WORK PERMITTED AND POSTING NOTICES.

Applicant's Signature  
JLSmith@verizon.net  
Email Address  
Owner  
Title/Company

Print Name  
Jasper Lee Smith  
Date  
10/26/11

Checks Payable to: DIRECTOR OF FINANCE OF HOWARD COUNTY

\*\*PLEASE WRITE NEATLY & LEGIBLY\*\*

-FOR OFFICE USE ONLY-

AGENCY	DATE	SIGNATURE OF APPROVAL
State Highways		
Building Officials		
PSZA ( Zoning )		
PSZA ( Engineering )		
Health	10-26-11	[Signature]
Fire Protection		

Is Sediment Control approval required for issuance? ☐ Yes ☐ No

☐ CONTINGENCY CONSTRUCTION START

☐ ONE STOP SHOP

DPZ SETBACK INFORMATION

Front:

Rear:

Side:

Side St.:

All minimum setbacks met? ☐ Yes ☐ No

Is Entrance Permit Required? ☐ Yes ☐ No

Historic District? ☐ Yes ☐ No

Lot Coverage for New Town Zone:

SDP/Red-line approval date:

Filing Fee	\$
Permit Fee	\$
Tech Fee	\$
Excise Tax	\$
PSFS	\$
Guaranty Fund	\$
Add'l per Fee	\$
Total Fees	\$
Sub- Total Paid	\$
Balance Due	\$

South Alley

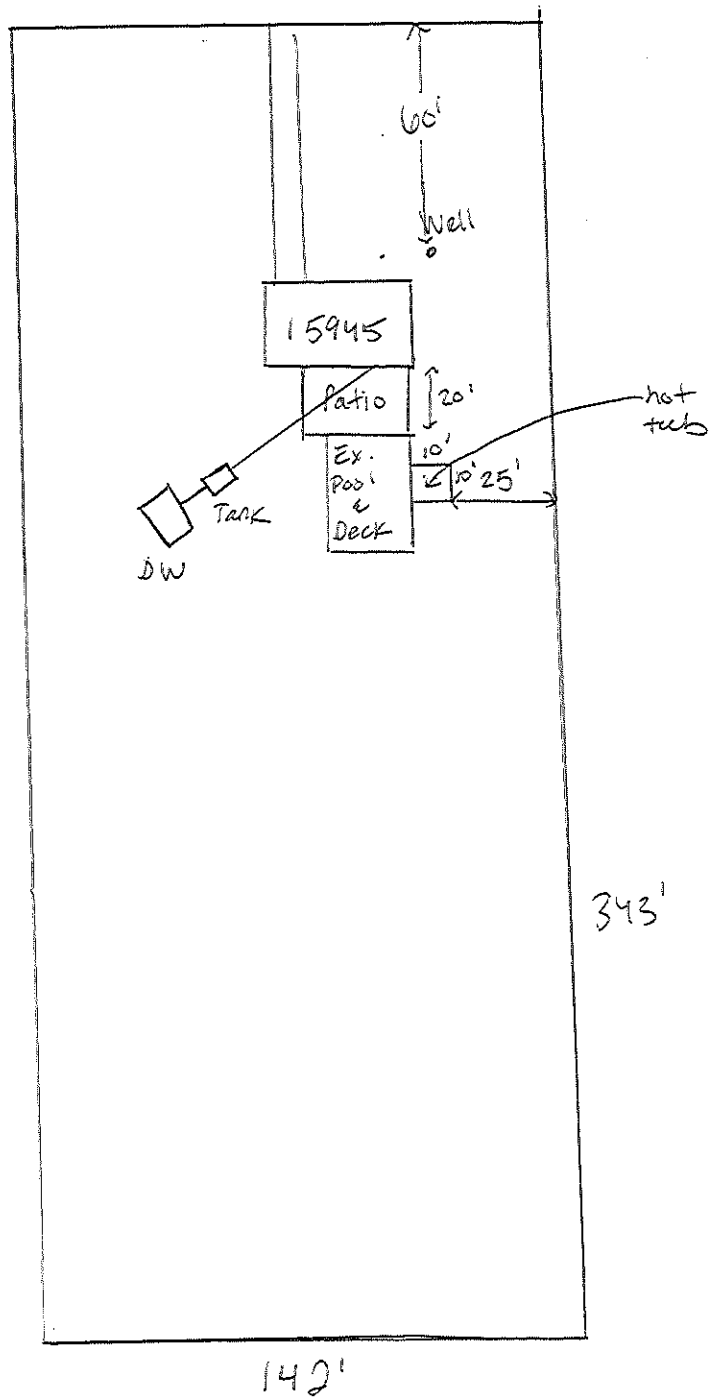

1" = 50'

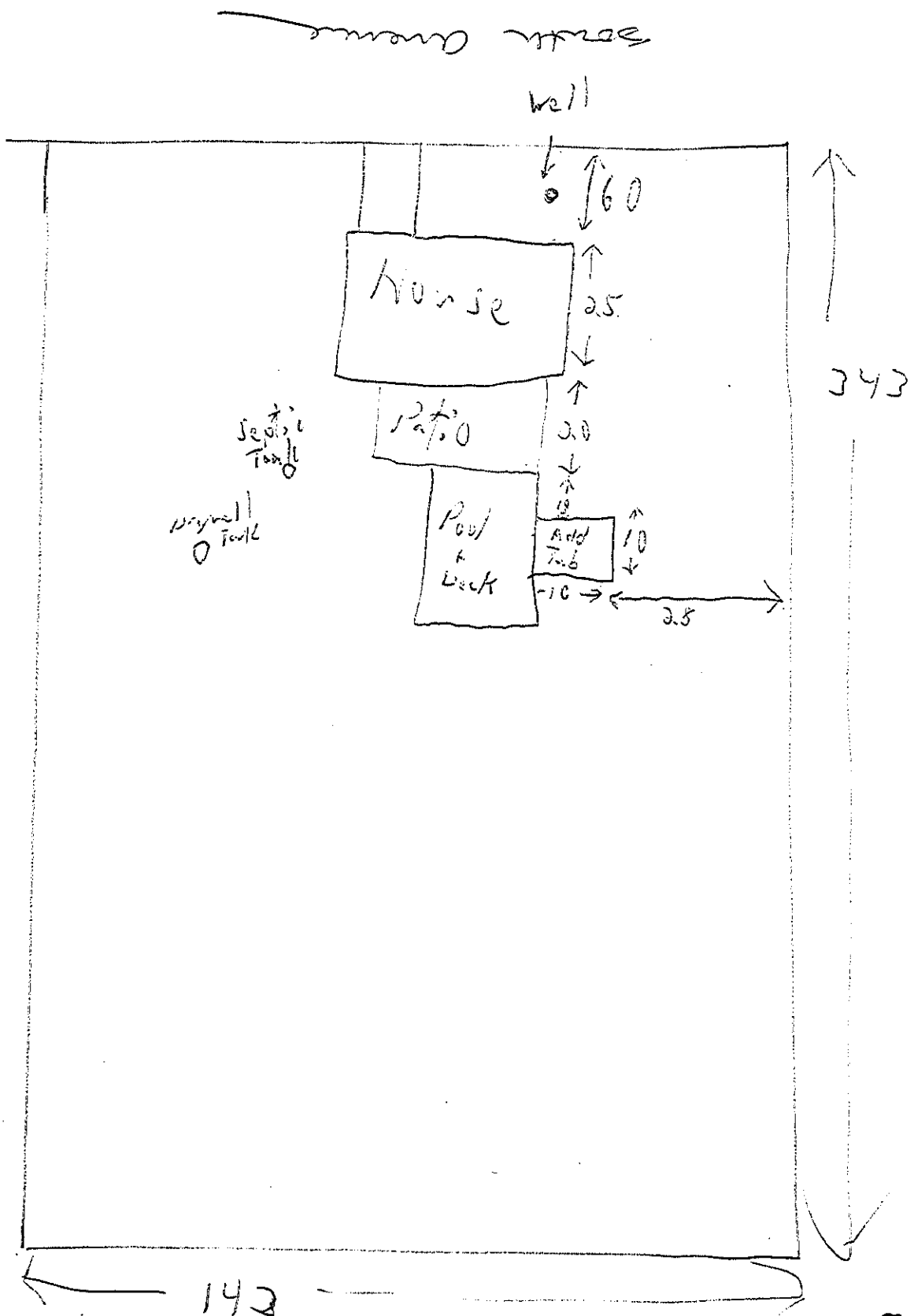

APPROVED

WALK-THRU BUILDING PERMIT

BP# \_\_\_\_\_ A# 23599

APP. SAN. HS DATE: 10-20-11

DESC. OF WORK: hot tub

13945 South Ave.