

05-356024

## PERMIT

SEWAGE DISPOSAL SYSTEM

MARYLAND STATE DEPARTMENT OF HEALTH

HOWARD COUNTY

ELLICOTT CITY

DISTRICT 5thDATE 5/1/80approved 5/2/80  
J. Stager  
P 30659A Repair

INDEXED

Olen Ketterman

IS PERMITTED TO INSTALL ALTER XADDRESS 14960 14060 Frederick Road, Woodbine, Md. 21797 PHONE 442-1336SUBDIVISION 11967 ROAD Route 216 (Scaggsville Rd.) LOTPROPERTY OWNER Miss INTERMIN Mr. Keller ELMER MILES (ORIGINAL OWNER/BOILER) = 40 yearsADDRESS STEPHEN RANKIN (PRESENT OWNER 1986)

## SPECIFICATIONS

SEPTIC TANK CAPACITY \_\_\_\_\_ GALLONS

DRAIN FIELD \_\_\_\_\_ DEPTH \_\_\_\_\_ FEET, BOTTOM AREA \_\_\_\_\_ SQ. FT.

DEEP TRENCH \_\_\_\_\_ DEPTH \_\_\_\_\_ FEET, BOTTOM AREA \_\_\_\_\_ SQ. FT.

SEEPAGE PITS \_\_\_\_\_ ABSORBENT SIDE-WALL AREA \_\_\_\_\_ SQ. FT.

INLET PIPE \_\_\_\_\_ FT. BELOW ORIGINAL GRADE. MAXIMUM DEPTH \_\_\_\_\_ FT. BELOW ORIGINAL GRADE

EFFECTIVE DEPTH AT \_\_\_\_\_ FT. BELOW ORIGINAL GRADE.

LOCATE DISPOSAL AREA \_\_\_\_\_ FT. FROM \_\_\_\_\_ LOT LINE AND \_\_\_\_\_ FT. FROM \_\_\_\_\_ LOT LINE AS SEEN WHEN

FACING LOT FROM

REPAIR - Call for an appointment when ground is opened up and Sanitarian will

recommend the repair system.

45 ft. trench, 11 ft. deep, 8 ft. gravel.  
Fill in drywell & go to trenchPLANS APPROVED BY Palmer F. Wine DATE 4/30/80

COVER NO WORK UNTIL INSPECTED AND APPROVED.

NEITHER THE HOWARD COUNTY COUNCIL NOR THE HEALTH DEPARTMENT IS RESPONSIBLE FOR THE SUCCESSFUL OPERATION OF ANY SYSTEM.

NOTE: IF TRENCH IS USED CALL FOR INSPECTION BEFORE PLACING GRAVEL IN TRENCH.

NOTE: NO DRY WELL SHALL EXCEED 15 FOOT IN DIAMETER.

NOTE: ALL PIPE FROM HOUSE TO DISPOSAL AREA MUST BE CAST IRON.

PERMIT VOID AFTER THREE YEARS.

NOTE: INSTALL STAND PIPE ON SEPTIC TANK AND DRY WELL. STAND PIPES MUST BE 6 INCHES IN DIAMETER. CAST IRON, CONCRETE OR TERRA  
COTTA ACCEPTED.

\*INSTALLER IS RESPONSIBLE FOR OBTAINING FINAL APPROVAL ON THIS PERMIT.

P-30659

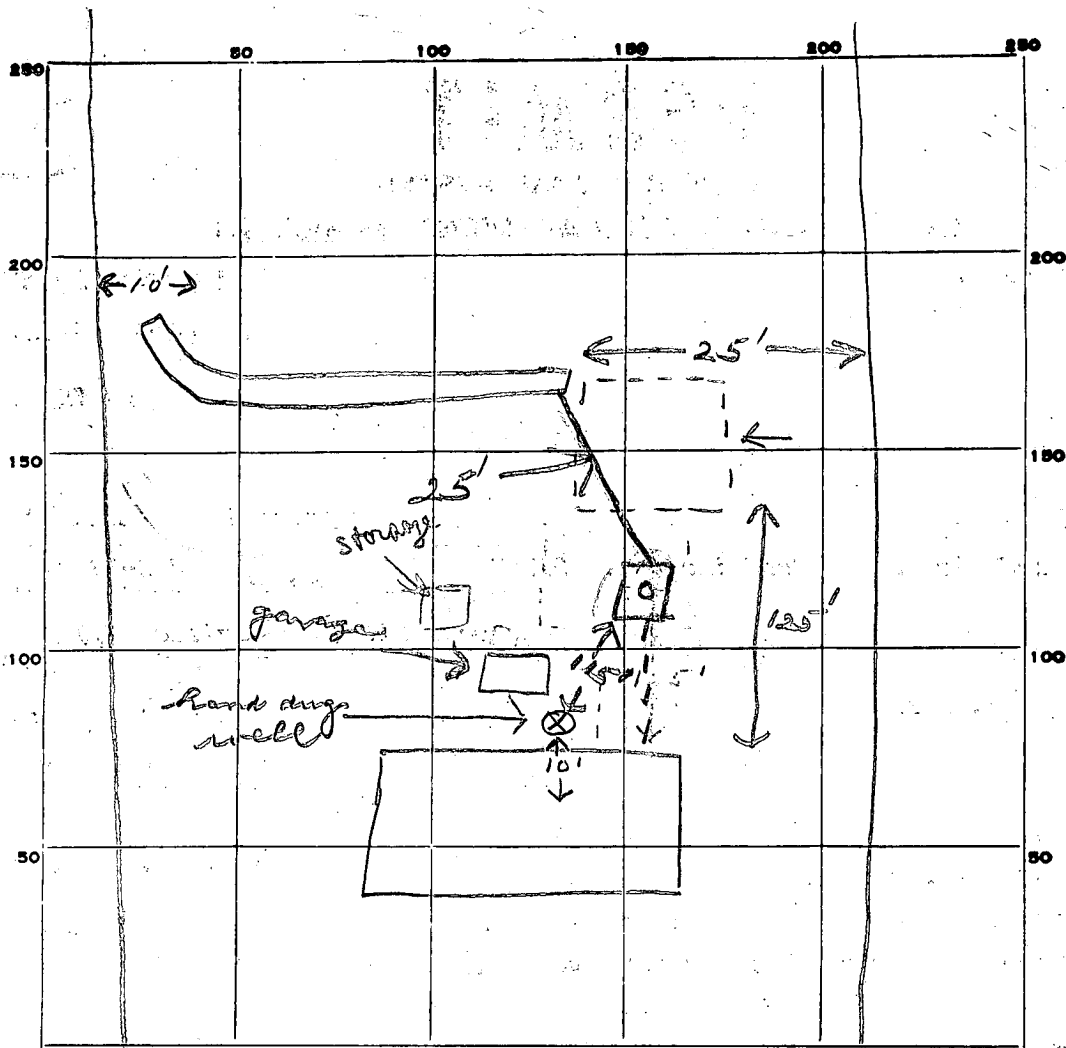

INDICATE NORTH - NAME ADJOINING ROADWAY AS BASE LINE.

PERMIT CARD

SEPTIC TANK, LEVEL

✓ concrete (1250) CLEANOUTS ST/ -concrete

DISTRIBUTION BOX, LEVEL

TILE FIELD, DEPTH 11 FT. TRENCH WIDTH 2 FT.

GRAVEL DEPTH 8 IN. TOTAL LENGTH 47 FT.

NUMBER OF TRENCHES 1 TOTAL BOTTOM AREA 376

SEEPAGE PITS, INSIDE DIAMETER FT. DEPTH BELOW INLET FT.

ABSORBENT AREA 376 SQ. FT.

REMARKS 5/2/80 could not find septic tanks, may be under garage. OK to gravel in trench. If OK to cover all work. J

DATE SYSTEM APPROVED

5/2/80

INSPECTOR

J. Stayer

# HOWARD COUNTY HEALTH DEPARTMENT

JOYCE M. BOYD, M.D., M.P.H.  
DEPUTY STATE AND  
COUNTY HEALTH OFFICER



BUREAU OF ENVIRONMENTAL HEALTH  
3716 COURT PLACE  
ELLCOTT CITY, MARYLAND 21043  
TELEPHONE: 992-2330

May 5, 1980

RE: Property -  
11967 Route 216  
Fulton, Md. 20759

TO WHOM IT MAY CONCERN:

The water sample taken April 9, 1980 from the property located at 11967 Route 216 was free of coliform and fecal coliform bacteria and may be presumed to be bacteriologically safe for drinking at the time of sampling.

An inspection of the property located at 11967 Route 216, on May 2, 1980 revealed that the septic system had been repaired according to specification, and was functioning satisfactorily.

Very truly yours,

A handwritten signature in dark ink, appearing to read "David J. O'Neill".

David J. O'Neill, Director  
Community Hygiene Programs

DJO'N:jr