

# PERMIT

SEWAGE DISPOSAL SYSTEM

P 25491

A Repair

MARYLAND STATE DEPARTMENT OF HEALTH

HOWARD COUNTY

ELLICOTT CITY

DISTRICT 6th

DATE 3/28/77

3/29/77  
after 1:00 please  
Jenkins

Vollmerhausen

06-395392

INDEX

Jacob Brothers

IS PERMITTED TO INSTALL ☒ ALTER

ADDRESS

PHONE

A SEWAGE DISPOSAL SYSTEM LOCATED AT

SUBDIVISION

ROAD 7912 Savage-Guilford Rd. LOT

PROPERTY OWNER Bob G. Skaggs

ADDRESS 7912 Savage-Guilford Road

SPECIFICATIONS 3 bedrooms

DRAIN FIELD DEPTH FEET, BOTTOM AREA SQ. FT.

SEEPAGE PITS ABSORBENT SIDE-WALL AREA SQ. FT.

SEPTIC TANK CAPACITY 1000 GALLONS

FOR GARBAGE GRINDER, INCREASE DISPOSAL AREA 22% & TANK CAPACITY 50%.

OTHER Needs new 1000 gallon septic tank and a sealed tank of at least 1500

gallon capacity with alarm device or try to connect to public sewer.

NOTE: ALL PIPE FROM HOUSE TO DISPOSAL AREA MUST BE CAST IRON.

NOTE: INSTALL STAND PIPE ON SEPTIC TANK. STAND PIPES MUST BE 6 INCHES IN DIAMETER.  
CAST IRON, CONCRETE OR TERRA COTTA ACCEPTED.

PLANS APPROVED BY Donald W. Monaghan

DATE 3/9/77

FILL SEPTIC TANK AND DISTRIBUTION BOX WITH WATER BEFORE CALLING FOR AN INSPECTION. COVER NO WORK UNTIL INSPECTED AND APPROVED.

NEITHER THE HOWARD COUNTY COMMISSIONERS NOR THE HEALTH DEPARTMENT IS RESPONSIBLE FOR THE SUCCESSFUL OPERATION OF ANY SYSTEM.

P 25491

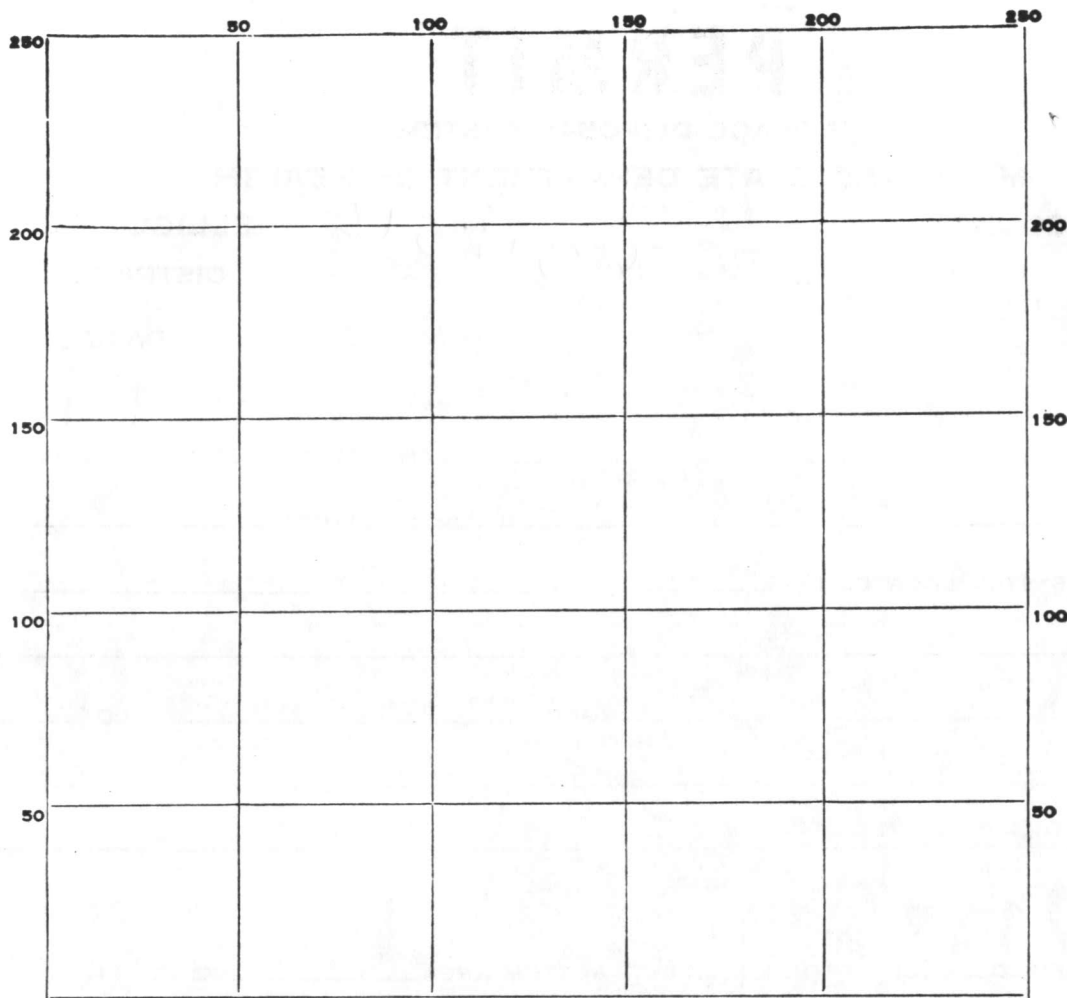

INDICATE NORTH. - NAME ADJOINING ROADWAY AS BASE LINE.

PERMIT CARD \_\_\_\_\_

SEPTIC TANK, LEVEL \_\_\_\_\_

CLEANOUTS \_\_\_\_\_

DISTRIBUTION BOX, LEVEL \_\_\_\_\_

TILE FIELD, DEPTH \_\_\_\_\_ FT. TRENCH WIDTH \_\_\_\_\_ FT.

GRAVEL DEPTH \_\_\_\_\_ IN. TOTAL LENGTH \_\_\_\_\_ FT.

NUMBER OF TRENCHES \_\_\_\_\_ TOTAL BOTTOM AREA \_\_\_\_\_

SEEPAGE PITS, INSIDE DIAMETER \_\_\_\_\_ FT. DEPTH BELOW INLET \_\_\_\_\_ FT.

ABSORBENT AREA \_\_\_\_\_ SQ. FT.

REMARKS \_\_\_\_\_

\_\_\_\_\_

\_\_\_\_\_

\_\_\_\_\_

\_\_\_\_\_

DATE SYSTEM APPROVED \_\_\_\_\_ INSPECTOR \_\_\_\_\_

*Repair perc*

# APPLICATION

A. \_\_\_\_\_

P. \_\_\_\_\_

## SEWAGE DISPOSAL TESTING

STATE OF MARYLAND - DEPARTMENT OF HEALTH AND MENTAL HYGIENE

HOWARD COUNTY HEALTH DEPARTMENT  
ENVIRONMENTAL HEALTH SERVICES

P. O. BOX 476, ELLICOTT CITY, MARYLAND 21043  
TELEPHONE: 465-5000, EXT. 356

DISTRICT 6th

DATE 3/1/77

*3/9/77 p.m. 1:30 3-10-77 needs new 1000 gal ST + a sealed tank of at least 1500 gal capacity with alarm device or try to connect to public sewer.*

TO: THE COUNTY HEALTH OFFICER  
ELLICOTT CITY, MARYLAND

I, HEREBY, APPLY FOR THE NECESSARY TEST IN ORDER TO CONSTRUCT (OR RECONSTRUCT) A SEWAGE DISPOSAL SYSTEM.

PROPERTY OWNER Bob G. Skaggs

Any questions call Jenkins

ADDRESS 7912 Savage-Guilford Road PHONE Bros. - 465-6646

PROPERTY LOCATION:

SUBDIVISION \_\_\_\_\_ LOT NO. \_\_\_\_\_

ROAD AND DESCRIPTION 7912 Savage-Guilford Road

SIZE OF LOT \_\_\_\_\_ TYPE BLDG. \_\_\_\_\_

NUMBER OF BEDROOMS \_\_\_\_\_

IF NOT SINGLE RESIDENCE DESCRIBE \_\_\_\_\_

THE SYSTEM INSTALLED UNDER THIS APPLICATION IS ACCEPTABLE ONLY UNTIL PUBLIC FACILITIES BECOME AVAILABLE.

SIGNATURE OF APPLICANT /s/ Jenkins Brothers

APPROVED BY \_\_\_\_\_ FOR \_\_\_\_\_ DATE \_\_\_\_\_

(KIND OF SYSTEM)

REJECTED BY W. Monaghan FOR Septic System DATE 3-9-77

(KIND OF SYSTEM)

HOLD PENDING FURTHER TESTS \_\_\_\_\_ DATE \_\_\_\_\_

REASONS FOR REJECTION OR HOLDING poor soil - rock - clay - water

# THIS IS NOT A PERMIT

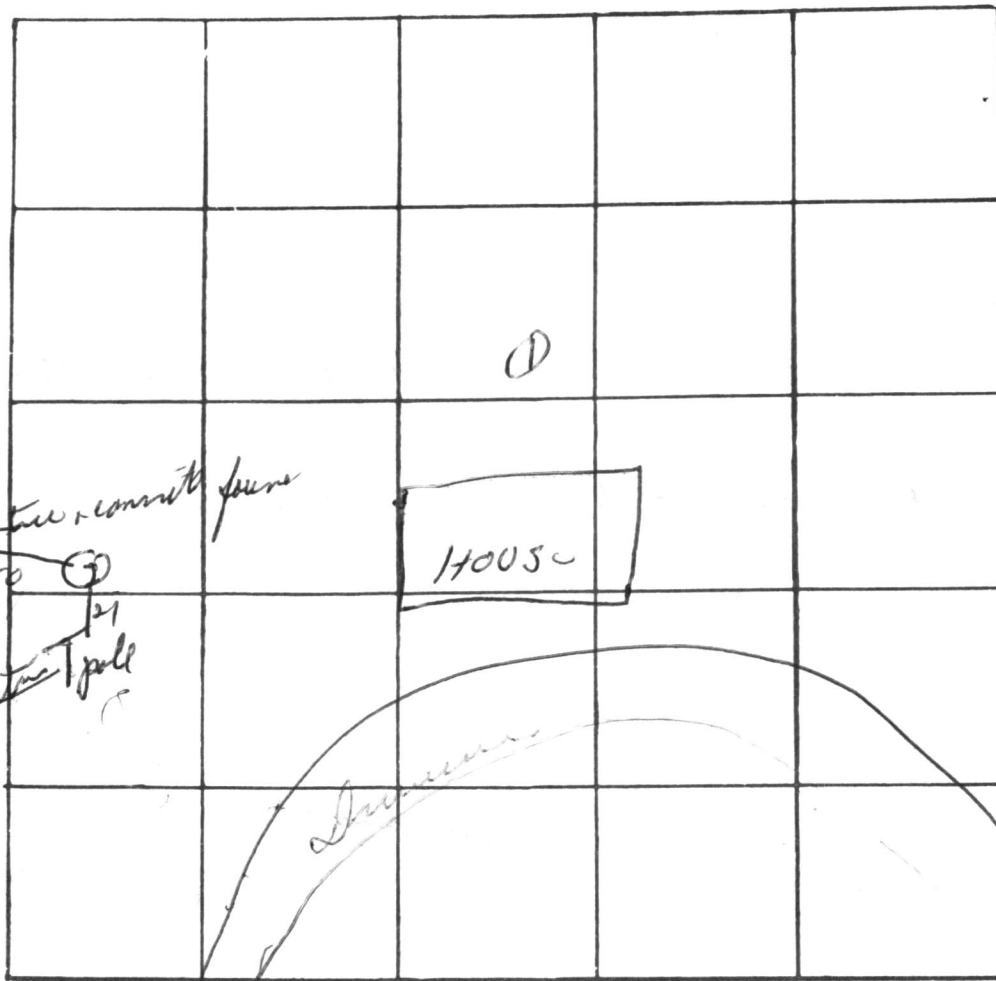

INDICATE NORTH. - NAME ADJOINING ROADWAY AS BASE LINE

DATE	TEST NO.	DEPTH	PRE-WET		TEST - 1" DROP		TIME
			START	STOP	START	STOP	
3/9/77	1	5'	rock				
	2	8 1/2'	all clay	water			
	3	10'	all clay				

REMARKS \_\_\_\_\_

TYPE OF SOIL \_\_\_\_\_

TESTED BY \_\_\_\_\_ ALSO PRESENT: \_\_\_\_\_