

5/2/77
5/3/77
around noon
afternoon please
please

PERMIT

SEWAGE DISPOSAL SYSTEM

MARYLAND STATE DEPARTMENT OF HEALTH

HOWARD COUNTY

05-343097

ELLICOTT CITY

DISTRICT 5th

INDEXED

DATE 4/29/77

Jack Fyock

IS PERMITTED TO INSTALL ALTER X

ADDRESS 13775 Triadelphia Road, Glenelg, Md.

PHONE 988-9270

A SEWAGE DISPOSAL SYSTEM LOCATED AT

SUBDIVISION

BEAN

2169

ROAD

STAR BEAN DRIVE

Murphy Road

LOT

PROPERTY OWNER

? BICKERTON

ADDRESS

SPECIFICATIONS

DRAIN FIELD DEPTH FEET, BOTTOM AREA SQ. FT.

SEEPAGE PITS ABSORBENT SIDE-WALL AREA SQ. FT.

SEPTIC TANK CAPACITY GALLONS

FOR GARBAGE GRINDER, INCREASE DISPOSAL AREA 22% & TANK CAPACITY 50%.

OTHER REPAIR - Call for inspection when ground is opened up and Sanitarian will

recommend repair.

5/2/77 DM SAID OK FOR

OWNER TO SIGN STATEMENT AS TO DEPTH

OK DITCH SO IT CAN BE FILLED WITH STONE

PLANS APPROVED BY Palmer F. Wine

DATE 4/29/77

FILL SEPTIC TANK AND DISTRIBUTION BOX WITH WATER BEFORE CALLING FOR AN INSPECTION. COVER NO WORK UNTIL INSPECTED AND APPROVED.

NEITHER THE HOWARD COUNTY COMMISSIONERS NOR THE HEALTH DEPARTMENT IS RESPONSIBLE FOR THE SUCCESSFUL OPERATION OF ANY SYSTEM.

25748

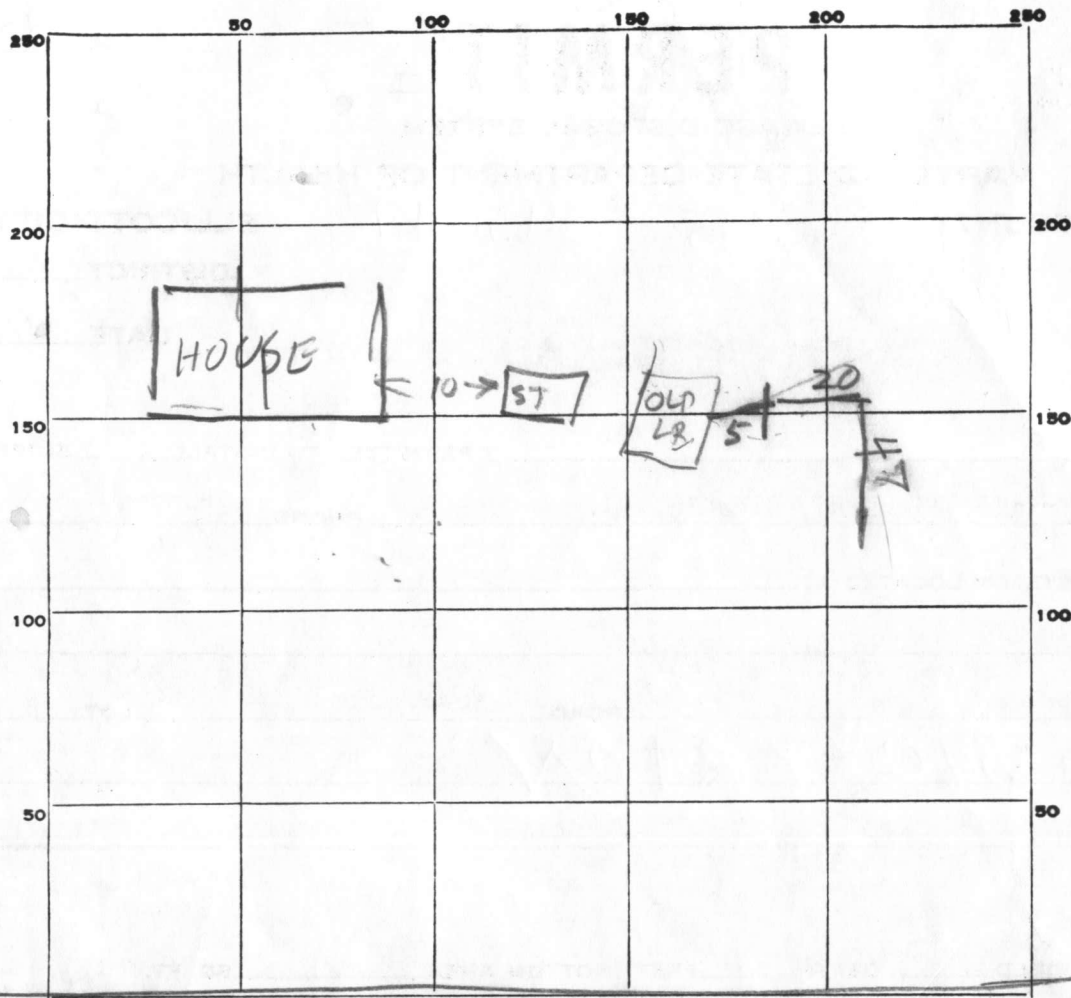

INDICATE NORTH. - NAME ADJOINING ROADWAY AS BASE LINE.

STABEANDR

PERMIT CARD _____

SEPTIC TANK, LEVEL _____

CLEANOUTS _____

DISTRIBUTION BOX, LEVEL _____

TILE FIELD, DEPTH 10 1/2 FT. TRENCH WIDTH 2-5 FT.

GRAVEL DEPTH 7 1/2 FT. IN. TOTAL LENGTH 6-7 FT.

NUMBER OF TRENCHES 1 TOTAL ONESIDE BOTTOM AREA 302

SEEPAGE PITS, INSIDE DIAMETER _____ FT. DEPTH BELOW INLET _____ FT.

ABSORBENT AREA _____ SQ. FT.

REMARKS 5/3/77 AM - DITCH DUG 159 20 FT

ARE FILLED WITH STONE

5/3/77 PM - DITCH FILLED WITH STONE

& IS O.K.

DATE SYSTEM APPROVED

5/3/77
500 PM

INSPECTOR

Raymond Hodge

47
20
47
20
67
67
469
335
33