

8-1-88
1:30-2:00 PM

PERMIT

SEWAGE DISPOSAL SYSTEM

MARYLAND STATE DEPARTMENT OF HEALTH

HOWARD COUNTY
BUREAU OF ENVIRONMENTAL HEALTH
461-9933

INDEXED

03-307905

P 42/62

A 29156

DISTRICT 3rd

DATE 7/21/88

DATE SYSTEM APPROVED 8/2/88

INSPECTOR C. Williams

Paul Schissler/ South Carroll Backhoe, Inc. IS PERMITTED TO INSTALL X ALTER

ADDRESS 4410 Salem Bottom Road, Westminster, Maryland PHONE 875-4197

SUBDIVISION Sunset Valley I ROAD 955 Sunset Valley Drive LOT 6, Sec. 1

PROPERTY OWNER Robert Bennett

ADDRESS

IF GARBAGE GRINDER IS USED INCREASE SEPTIC TANK CAPACITY BY 50% AND ABSORPTION AREA BY 22%.

GARBAGE GRINDER? YES NO X

SEPTIC TANK CAPACITY 1250 GALLONS NUMBER OF BEDROOMS 4

TRENCHES - 187 sq. ft. per bedroom. Trench to be 2 feet wide. Inlet 4½ feet below original grade. Bottom maximum depth 8½ feet below original grade. Effective area begins at 4½ feet below original grade. 4 feet of stone below distribution pipe.

LOCATION - Start the trench 230 feet from the front lot line and 100 feet from the left lot line as seen when facing the lot from Sunset Valley Drive. Run trenches on contour towards the right (617.57') lot line. NOTE: PLACE SEPTIC TANK AT HIGH POINT OF PERC FIELD TO AVOID PLACING TANK 17' IN THE GROUND.

NOTE - No trench to exceed 100 feet in length. Provide 6" - 8" diameter cleanout and cap to grade or above on septic tank. ok/cw

PLANS APPROVED BY C. Williams DATE 2/10/86

COVER NO WORK UNTIL INSPECTED AND APPROVED.

NEITHER THE HOWARD COUNTY COUNCIL NOR THE HEALTH DEPARTMENT IS RESPONSIBLE FOR THE SUCCESSFUL OPERATION OF ANY SYSTEM.

NOTE: CLEANOUT REQUIRED EVERY 70 FEET OF SEWER LINE AND/OR AT 90° SWEEPS IN LINES FROM HOUSE TO DRAIN FIELDS.

NOTE: ALL PARTS OF SEPTIC SYSTEMS (I.E., TANK, DISTRIBUTION BOX, TRENCHES) TO BE 100 FEET FROM WELL (UNLESS OTHERWISE SPECIFICALLY AUTHORIZED)

NOTE: IF DEEP TRENCH(IES) ARE USED CALL FOR INSPECTION BEFORE AND AFTER PLACING GRAVEL IN TRENCH(IES):

NOTE: NO DRY WELL SHALL EXCEED 15 FOOT IN DIAMETER. NO ABSORPTION TRENCH TO EXCEED 100 FEET IN LENGTH.

NOTE: ALL PIPE FROM HOUSE TO SEPTIC TANK MUST BE CAST IRON OR SCHEDULE 40 PVC OR ABS.

PERMIT VOID AFTER TWO YEARS.

NOTE: INSTALL STAND PIPE ON SEPTIC TANK AND DRY WELL. STAND PIPES MUST BE 6 INCHES IN DIAMETER. CAST IRON, CONCRETE OR TERRA COTTA OR PVC OR ABS ACCEPTED. IF TOP OF SEPTIC TANK IS DEEPER THAN 3 FEET, MANHOLE TO GRADE REQUIRED.

NOTE: DISTRIBUTION BOXES MUST HAVE BAFFLES.

*INSTALLER IS RESPONSIBLE FOR OBTAINING FINAL APROVAL ON THIS PERMIT

*CALL 461-9933 FOR INSPECTION OF SEPTIC SYSTEMS.

EH - 2-1186

A 29156

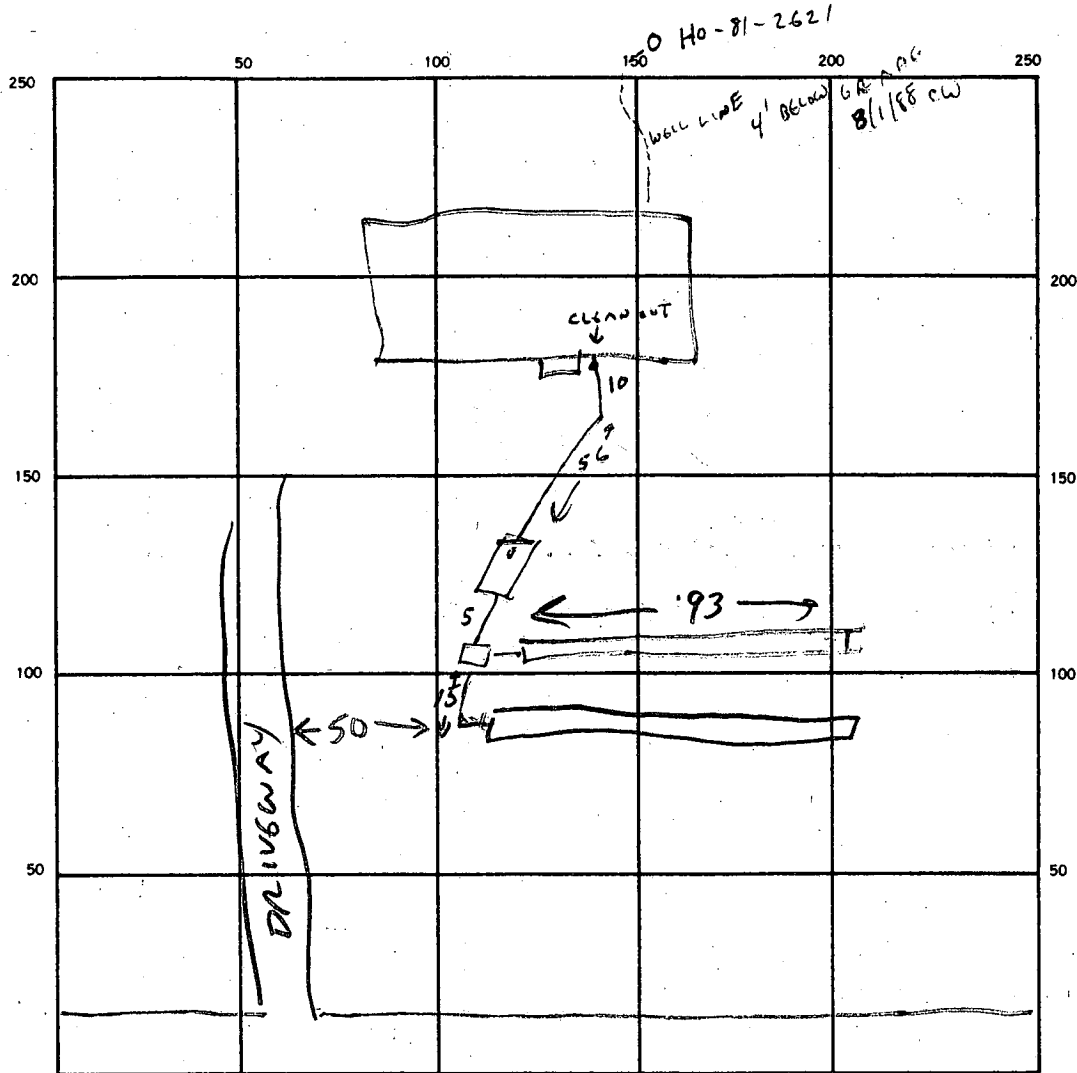

INDICATE NORTH. — NAME ADJOINING ROADWAY AS BASE LINE.
SUNSET VALLEY DR.

SEPTIC TANK. LEVEL ✓ CLEANOUTS 3rd IN LINE ✓

DISTRIBUTION BOX. LEVEL ✓

DRAIN FIELD/TILE FIELD. DEPTH 8 $\frac{1}{2}$ FT. TRENCH WIDTH 2 FT. INLET DEPTH 4 $\frac{1}{2}$ FT.

EFFECTIVE GRAVEL DEPTH 4 FT. TOTAL LENGTH 106 FT.

NUMBER OF TRENCHES 2 ONE SIDEWALL/BOTTOM AREA SQ. FT.

DRYWELL INSIDE DIAMETER FT. EFFECTIVE DEPTH BELOW INLET FT.

ABSORBENT AREA SQ. FT.

REMARKS OK TO FINISH 1ST TRENCH 8/1/88 C.W.

2ND TRENCH OK - COMPLETE & COVER 8/2/88 C.W.

DATE SYSTEM APPROVED

8/2/88

INSPECTOR

C. Williams

SUBDIVISION:

SUNSET VALLEY I

A 29156

LOT NUMBER: 6

DRY WELL OR DRY WELL AND TRENCH

		_____ sq. ft./bedroom
	<u>Septic Tank</u>	<u>Minimum Total Square Feet</u>
3 bedroom	1000 gallon	_____
4 bedroom	1250 gallon	_____
5 bedroom	1500 gallon	_____

Inlet _____ feet below original grade.

Bottom maximum depth _____ feet below original grade.

Effective area begins at _____ feet below original grade.

NOTE: If trench is used to make up absorbent area, run the trench on level ground and leave a 5 foot earth buffer between dry well and trench.
No trench is to exceed 100 feet in length. Trench inlet to be same as dry well, with _____ feet of stone below distribution pipe.

TRENCHES187 sq. ft./bedroomTrench to be 2 wide.Inlet 4 1/2 feet below original grade.Bottom maximum depth 8 1/2 feet below original grade.Effective area begins at 4 1/2 feet below original grade.4 feet of stone below distribution pipe.

- NOTE:
- (1) No trench to exceed 100 feet in length.
 - (2) If more than one trench used, a distribution box is required.
 - (3) Trenches to be installed on level ground.
 - (4) Call for inspection of trench before gravel is installed.
 - (5) Provide 6"-8" diameter cleanout and cap to grade or above on septic tank and drywell.
 - (6) If a Garbage disposal is used, increase septic tank capacity by 50% and increase absorbant sidewall area by 22%.

LOCATION: START THE TRENCH 230 FT FROM THE FRONT
LOT LINE AND 100 FT FROM THE LEFT LOT LINE AS
SEEN WHEN FACING THE LOT FROM SUNSET VALLEY DRIVE.

RUN TRENCHES ON _____ CONTOUR TOWARDS THE RIGHT (617.57')
LOT LINE. NOTE PLACE SEPTIC TANK AT HIGH POINT OF PORC FIELD
TO AVOID PLACING TANK 17' IN (2/10/86 CWJ)
THE GROUND. BP OK TO (3/21/88 Revised)
 Release AS DRAWN. SALL

APPLICATION

SEWAGE DISPOSAL TESTING

STATE OF MARYLAND - DEPARTMENT OF HEALTH AND MENTAL HYGIENE

HOWARD COUNTY HEALTH DEPARTMENT
ENVIRONMENTAL HEALTH SERVICES

P.O. BOX 476 ELLICOTT, MARYLAND 21043
TELEPHONE: 992-2330

A 29156

P _____

DISTRICT 3RD

DATE 10/12/78

RE-TEST REQ'D
SEPTIC TANK POTENTIALLY WET
3/8/88 CW.

RE-TEST SCHEDULED FOR 3/21

TO: THE COUNTY HEALTH OFFICER
ELLICOTT CITY, MARYLAND

I, HEREBY, APPLY FOR THE NECESSARY TEST IN ORDER TO CONSTRUCT (OR RECONSTRUCT) A SEWAGE DISPOSAL SYSTEM.

PROPERTY OWNER ~~VIRGINIA M. GARRATT~~ Robert Bennett

ADDRESS FORSYTHE ROAD SYKESVILLE, MD. 21784 PHONE 301-442-2262

PROPERTY LOCATION:

SUBDIVISION SUNSET VALLEY LOT NO. 8 new 6

ROAD AND DESCRIPTION 955 SUNSET VALLEY DRIVE SER 1

SIZE OF LOT 3.0 AC. ± TYPE BLDG. SINGLE FAMILY RESIDENCE

THE SYSTEM INSTALLED UNDER THIS APPLICATION IS ACCEPTABLE ONLY UNTIL PUBLIC FACILITIES BECOME AVAILABLE.

I FULLY UNDERSTAND THE FEE CONNECTED WITH THE FILING OF THIS PERC TEST APPLICATION IS NON-REFUNDABLE UNDER

ANY CIRCUMSTANCES.

SIGNATURE OF APPLICANT Bruce D. Bunker

APPROVED BY Raymond Hodge FOR French or DATE 3/10/83

REJECTED BY _____ FOR _____ DATE _____

HOLD PENDING FURTHER TESTS _____ DATE _____

REASONS FOR REJECTION OR HOLDING _____

BLDG. PERMIT SIGNED

AND RETURNED 4-21-88

BP-17474

SH

THIS IS NOT A PERMIT

SOIL PROFILE

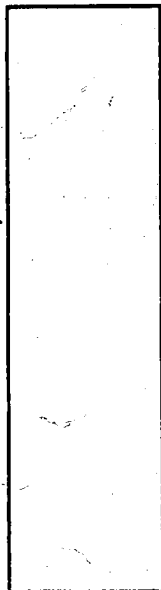

Sweet Valley Dr

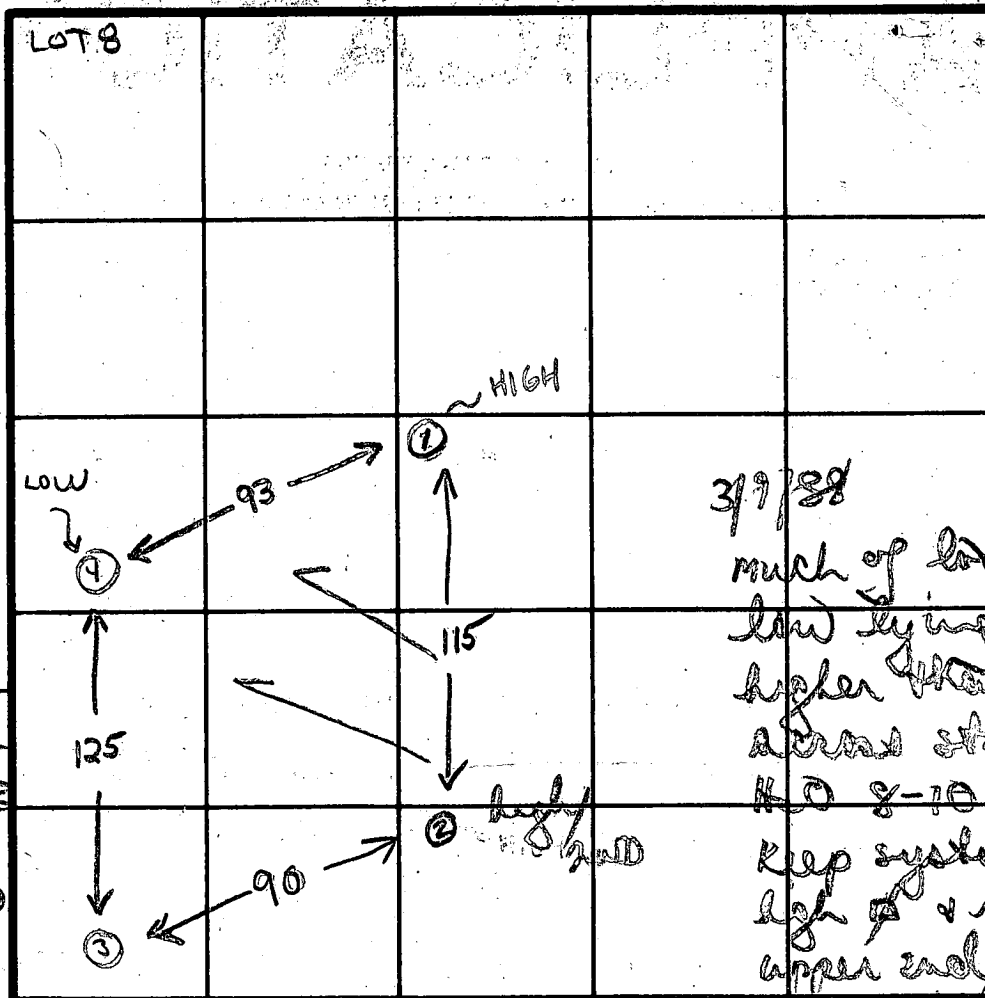

Use
Trenches
② → 1

INDICATE NORTH - NAME ADJOINING ROADWAY AS BASE LINE

DATE	TEST NO.	DEPTH	PRE-WET		TEST - 1" DROP		TIME
			START	STOP	START	STOP	
12/15/78	15 - HIGH	5 1/2'	1037	1043	1043	1052	9
	10	14'	1037	1043	1043	1052	9
	25	6	1052	1101	1101	1112	11
	20	12	visual	- sim	1112		
	35	5 1/2'	1047	1053	1053	1103	10
	30	12 1/2'	1047	1105	1105	1130	25
	45 - LOW	5 1/2'	1041	1043	1043	1052	9
	40	13 1/2'	1041	1052	1052	1110	18

REMARKS open field - high weeds - tests as stated

TYPE OF SOIL Red silty loam below clay ① & ④ sandy loam ② & ③

TESTED BY GLK + RD ALSO PRESENT

APPLICATION

PERCOLATION TESTING

A 29156

P _____

HOWARD COUNTY HEALTH DEPARTMENT
BUREAU OF ENVIRONMENTAL HEALTH
P.O. BOX 476 ELLICOTT CITY, MARYLAND 21043
TELEPHONE: 461-9933

DISTRICT _____

DATE 3/21/88

TO: THE COUNTY HEALTH OFFICER
ELLICOTT CITY, MARYLAND

I, HEREBY, APPLY FOR THE NECESSARY TEST IN ORDER TO CONSTRUCT (OR RECONSTRUCT) A SEWAGE DISPOSAL SYSTEM.

PROPERTY OWNER _____

ADDRESS _____ PHONE _____

PROSPECTIVE BUYER _____

ADDRESS _____ PHONE _____

PROPERTY LOCATION:

SUBDIVISION SUNSET VALLEY ESTATES LOT NO. 6

ROAD AND DESCRIPTION SUNSET VALLEY DRIVE

TAX MAP _____ PARCEL # _____

SIZE OF LOT _____ TYPE BLDG _____
(SINGLE FAMILY DWELLING OR COMMERCIAL)

THE SYSTEM INSTALLED UNDER THIS APPLICATION IS ACCEPTABLE ONLY UNTIL PUBLIC FACILITIES BECOME AVAILABLE. I FULLY UNDERSTAND THE FEE CONNECTED WITH THE FILING OF THIS PERC TEST APPLICATION IS NON-REFUNDABLE UNDER ANY CIRCUMSTANCES. I ALSO AGREE TO COMPLY WITH ALL M.O.S.H.A. REQUIREMENTS IN TESTING THIS LOT.

(SIGNATURE OF APPLICANT)

APPROVED BY B. Nayan FOR Deep system DATE 3/21/88

REJECTED BY _____ FOR _____ DATE _____

HOLD PENDING FURTHER TESTS _____ DATE _____

REASONS FOR REJECTION OR HOLDING Visual reinspection confirms satisfactory

soils (good in top area satisfactory in lower area)
All repairs still to be shallow.

THIS IS NOT A PERMIT

①
SOIL PROFILE

0'
Brown/red
clay w/ few
small shell
frag 4 1/2'
to mostly
brown sandy
purple
silty loam
12'
starting small
frag (small)
13'D front
corner
12'

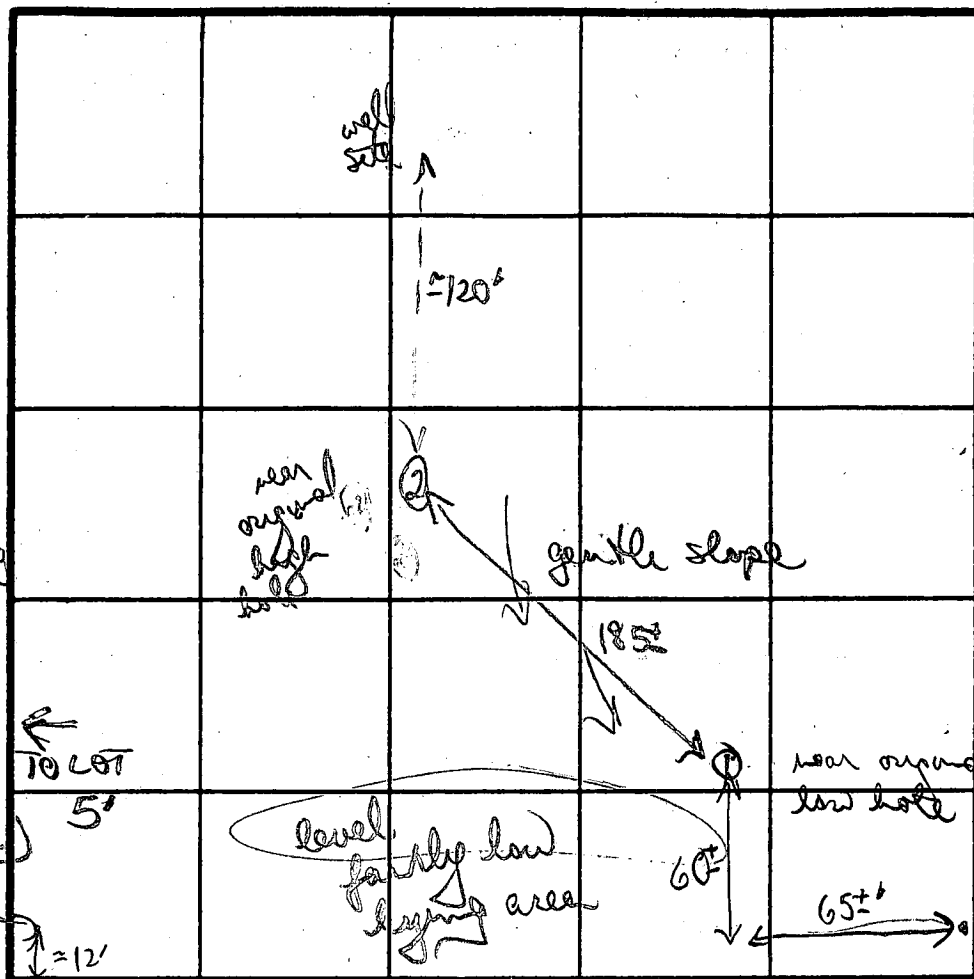

INVEST 4 1/2
MAVD 8 1/2
187 1/100



INDICATE NORTH - NAME ADJOINING ROADWAY AS BASE LINE.
SUNSET VALLEY DRIVE

②

purple/brown
clay/silt
loam 4'
to purple
to purple
powdery silty
loam w/
small shell
frag
13'D

DATE	TEST NO.	DEPTH	PRE-WET		TEST - 1" DROP		TIME
			START	STOP	START	STOP	
3/21/88	1)	VISUAL	ONLY	good soils	4' down		
		13' D	bottom	(see profile)			
	2)	VISUAL	ONLY	good soils	4' down		
		13' D	bottom	(see profile)			

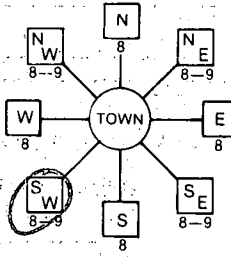
REMARKS soils are fine no sign of mottled or wet soils
in lower hole as originally anticipated
TYPE OF SOIL clay/clay silt loams 4 1/2'; mostly silty loam
TESTED BY B A year ALSO PRESENT Jenkins Brothers
Mc Bennett

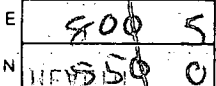
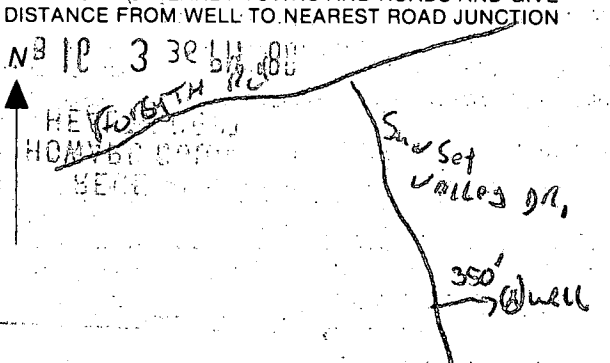
B 1 1 2 3 4 5 6 4929 (THIS NUMBER IS TO BE PUNCHED IN COLS. 3-6 ON ALL CARDS)	SEQUENCE NO. (DP USE ONLY)	STATE OF MARYLAND PERMIT TO DRILL WELL please print or type	STATE PERMIT NUMBER HO-81-2621 <small>fill in this form completely</small>
Date Received (APA) 022488 OWNER INFORMATION 15 Last Name Bennett 13 Owner Robert 34 36 Street or RFD 890 RIVER RD 55 57 Town SYKESVILLE 70 State 72 MD 74 Zip 21784 76		B 3 LOCATION OF WELL 8 COUNTY HOWARD 21 23 SUBDIVISION SUNSET VALLEY 42 SECTION 14 44 46 LOT 6 48 50 52 NEAREST TOWN SYKESVILLE 71 MILES FROM TOWN (enter 0 if in town) 2 73 MI 76 77 78	
DRILLER INFORMATION Driller's Name Ralph Mayne 77 License No. 273 80 Firm Name Ralph Mayne Well Drilling Address 9120 Brown Church Rd. Mt Airy Signature Ralph Mayne 2/16/88 Date		B 4 DIRECTION OF WELL FROM TOWN (CIRCLE BOX)  NEAR WHAT ROAD Sunset Valley Dr. 30 ON WHICH SIDE OF ROAD (CIRCLE APPROPRIATE BOX)  34 380 37 DISTANCE FROM ROAD ENTER FT or MI FT 38 39	
B 2 WELL INFORMATION APPROX. PUMPING RATE (GAL. PER MIN.) 5 8 12 AVERAGE DAILY QUANTITY NEEDED (GAL. PER DAY) 500 14 20		NOT TO BE FILLED IN BY DRILLER HEALTH DEPARTMENT APPROVAL HOWARD COUNTY NAME A29156 COUNTY NO. STATE SIGNATURE _____ INSERT S <input type="checkbox"/> 41 DATE ISSUED 032188 43 48 CO SIGNATURE R. Wilson 49 54 NORTH GRID 550000 50 55 EAST GRID 080500 57 63	
USE FOR WATER (CIRCLE APPROPRIATE BOX) <input checked="" type="checkbox"/> D HOME (SINGLE OR DOUBLE HOUSEHOLD UNIT ONLY) <input type="checkbox"/> F FARMING (LIVESTOCK WATERING & AGRICULTURAL IRRIGATION) <input type="checkbox"/> I INDUSTRIAL, COMMERCIAL, STATE AND FEDERAL GOV. OTHER (REQUIRES APPROPRIATION PERMIT) <input type="checkbox"/> P PUBLIC OR PRIVATE WATER COMPANY (REQUIRES APPROPRIATION PERMIT AND STATE HEALTH DEPARTMENT APPROVAL) <input type="checkbox"/> T TEST, OBSERVATION, MONITORING (MAY REQUIRE APPROPRIATION PERMIT)		SHOW MAJOR FEATURES OF BOX & LOCATE WELL WITH AN X SOURCES OF DRILLING WATER 1. well 2. 3. WRITE THE BOX NUMBER FROM THE MAP HERE 	
APPROXIMATE DEPTH OF WELL 150 24 28 FEET APPROXIMATE DIAMETER OF WELL 6" 30 34 NEAREST INCH		METHOD OF DRILLING (circle one) BORED (or Augered) <input checked="" type="checkbox"/> JETTED <input type="checkbox"/> Jetted & DRIVEN <input type="checkbox"/> 30. AIR-ROTARY 37 AIR-PERCussion ROTARY (Hydraulic Rotary) CABLE REVERSE-ROTARY Drive-POINT other _____	
REPLACEMENT OR DEEPEMED WELLS (CIRCLE APPROPRIATE BOX) <input checked="" type="checkbox"/> N THIS WELL WILL NOT REPLACE AN EXISTING WELL <input type="checkbox"/> Y THIS WELL WILL REPLACE A WELL THAT WILL BE ABANDONED AND SEALED 39 <input type="checkbox"/> S THIS WELL WILL REPLACE A WELL THAT WILL BE USED AS A STANDBY <input type="checkbox"/> D THIS WELL WILL DEEPEN AN EXISTING WELL PERMIT NUMBER OF WELL TO BE REPLACED OR DEEPEMED (IF AVAILABLE) 41 _____ 52		DRAW A SKETCH BELOW SHOWING LOCATION OF WELL IN RELATION TO NEARBY TOWNS AND ROADS AND GIVE DISTANCE FROM WELL TO NEAREST ROAD JUNCTION 	
Not to be filled in by driller (OEP USE ONLY)			
APPROP. PERMIT NUMBER _____ 54 GAP 63 FORCE PER 67 68 WRITE INITIALS IN BOX PERMIT NO. HO-81-2621 70 71 72 73 74 75 76 77 78 79			
SPECIAL CONDITIONS _____			

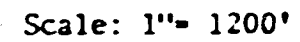
[illegible]

---S 35°-00'-00" W 75.00'

S 55° 00' 00" E 83.30'

④ S 80°-00'-00" W. 35.36'

Property of
Charles J. Karfoni
990/443

FIELD DATA SHEET
HOWARD COUNTY WELL YIELD TEST

Well Permit No. HO - 81-2621
Location of property (road) SUNSET VALLEY DRIVE
Subdivision SUNSET VALLEY ESTATES Lot 6 Block Plat Sec. 1
Well Driller RALPH MAYNE Owner BENNETT, ROBERT

Depth of well _____
Distance of measuring point (M.P.) above ground _____
Static water level (S.W.L.) below M.P. _____

I. High rate pumping -- reservoir drawdown

Time pump started _____ Pumping rate _____
Total time _____ to reach pumping water level _____ ft. below M.P.

II. Recovery pump test data - observations to be recorded every 15 minutes

[illegible]

<div>C1</div> <div>7725</div>		<div>STATE OF MARYLAND</div> <div>WELL COMPLETION REPORT</div> <div>FILL IN THIS FORM COMPLETELY</div> <div>PLEASE PRINT OR TYPE</div>		<div>THIS REPORT MUST BE SUBMITTED WITHIN</div> <div>45 DAYS AFTER WELL IS COMPLETED.</div>	
<div>SEQUENCE NO.</div> <div>(OEP USE ONLY)</div>				<div>COUNTY</div> <div>NUMBER</div> <div>A 29156</div>	
<div>DATE Received</div> <div><div>8</div><div>13</div></div>		<div>DATE WELL COMPLETED</div> <div><div>15</div><div>20</div></div> <div>082588</div>		<div>PERMIT NO.</div> <div>FROM "PERMIT TO DRILL WELL"</div> <div><div>28</div><div>29</div><div>30</div><div>31</div><div>32</div><div>33</div><div>34</div><div>35</div><div>36</div><div>37</div></div> <div>HC-81-2621</div>	
<div>OWNER</div> <div><div>last name</div><div>first name</div></div> <div>BENNETT ROBERT</div>		<div>STREET OR RFD</div> <div>SUNSET VALLEY DRIVE</div>		<div>TOWN</div> <div>SYKESVILLE</div>	
<div>SUBDIVISION</div> <div>SUNSET VALLEY EST.</div>		<div>SECTION</div> <div>1</div>		<div>LOT</div> <div>6</div>	
<div>WELL LOG</div> <div>Not required for driven wells</div>		<div>GROUTING RECORD</div> <div>yes no</div> <div><div>Y</div><div>N</div></div>		<div>C 3</div> <div>1 2</div>	
<div>STATE THE KIND OF FORMATIONS</div> <div>PENETRATED, THEIR COLOR, DEPTH,</div> <div>THICKNESS AND IF WATER BEARING</div>		<div>WELL HAS BEEN GROUTED</div> <div>(Circle Appropriate Box)</div>		<div>PUMPING TEST</div>	
<div>DESCRIPTION (Use</div> <div>additional sheets if needed)</div>		<div>TYPE OF GROUTING MATERIAL</div>		<div>HOURS PUMPED (nearest hour)</div> <div><div>8</div><div>9</div></div> <div>3</div>	
<div>FEET</div> <div>FROM TO</div>		<div>CEMENT</div> <div><div>45</div><div>46</div></div> <div>CM</div>		<div>PUMPING RATE (gal. per min.</div> <div>to nearest gal.)</div> <div><div>11</div><div>15</div></div> <div>10</div>	
<div>Check</div> <div>if water</div> <div>bearing</div>		<div>BENTONITE CLAY</div> <div><div>45</div><div>46</div></div> <div>BC</div>		<div>METHOD USED TO</div> <div>MEASURE PUMPING RATE</div> <div>Bucket</div>	
<div>Top Soil</div> <div>0 2</div>		<div>NO. OF BAGS</div> <div>9</div>		<div>WATER LEVEL (distance from land surface)</div>	
<div>Sandy</div> <div>2 23</div>		<div>NO. OF POUNDS</div> <div>900</div>		<div>BEFORE PUMPING</div> <div><div>17</div><div>20</div></div> <div>22</div>	
<div>Sandstone</div> <div>23 27</div>		<div>GALLONS OF WATER</div> <div>54</div>		<div>WHEN PUMPING</div> <div><div>22</div><div>25</div></div> <div>34</div>	
<div>Micka</div> <div>27 30</div>		<div>DEPTH OF GROUT SEAL (to nearest foot)</div>		<div>TYPE OF PUMP USED (for test)</div>	
<div>Sandstone</div> <div>30 33</div>		<div>from</div> <div><div>48</div><div>52</div></div> <div>ft. to</div> <div><div>54</div><div>58</div></div> <div>ft.</div> <div>31</div>		<div>A air</div> <div><div>27</div></div>	
<div>Micka</div> <div>35 90</div>		<div>(enter 0 if from surface)</div>		<div>P piston</div> <div><div>27</div></div>	
<div>Sandstone</div> <div>92 95</div>		<div>CASING RECORD</div>		<div>C centrifugal</div> <div><div>27</div></div>	
<div>Micka</div> <div>95 105</div>		<div>casing types</div> <div>insert</div> <div>appropriate</div> <div>code</div> <div>below</div>		<div>R rotary</div> <div><div>27</div></div>	
		<div>MAIN CASING TYPE</div> <div><div>60</div><div>61</div></div> <div>P1</div>		<div>O other (describe below)</div>	
		<div>Nominal diameter</div> <div>top (main) casing</div> <div>(nearest inch)</div> <div><div>63</div><div>64</div></div> <div>6</div>		<div>J jet</div> <div><div>27</div></div>	
		<div>Total depth</div> <div>of main casing</div> <div>(nearest foot)</div> <div><div>66</div><div>70</div></div> <div>33</div>		<div>S submersible</div> <div><div>27</div></div>	
		<div>OTHER CASING (if used)</div> <div>diameter</div> <div>inch</div> <div>depth (feet)</div> <div>from to</div>		<div>PUMP INSTALLED</div>	
		<div>SCREEN RECORD</div>		<div>DRILLER WILL INSTALL PUMP</div> <div>YES NO</div> <div>NO</div>	
		<div>screen type</div> <div>or open hole</div> <div>insert</div> <div>appropriate</div> <div>code</div> <div>below</div>		<div>IF DRILLER INSTALLS PUMP, THIS SECTION</div> <div>MUST BE COMPLETED FOR ALL WELLS</div> <div>EXCEPT HOME USE</div>	
		<div>ST STEEL</div> <div>BR BRASS</div> <div>PL PLASTIC</div> <div>HO OPEN HOLE</div> <div>OT OTHER</div>		<div>TYPE OF PUMP INSTALLED</div> <div>PLACE (A,C,J,P,R,S,T,O)</div> <div>IN BOX - SEE ABOVE:</div> <div><div>29</div></div>	
		<div>C 2</div> <div>1 2</div>		<div>CAPACITY:</div> <div>GALLONS PER MINUTE</div> <div>(to nearest gallon)</div> <div><div>31</div><div>35</div></div> <div>31</div>	
		<div>DEPTH (nearest ft.)</div> <div><div>8</div><div>9</div></div> <div>11</div> <div>15</div> <div>17</div> <div>21</div>		<div>PUMP HORSE POWER</div> <div><div>37</div><div>41</div></div> <div>37</div>	
		<div>EACH SCREEN</div> <div><div>23</div><div>24</div></div> <div>26</div> <div>30</div> <div>32</div> <div>36</div>		<div>PUMP COLUMN LENGTH</div> <div>(nearest ft.)</div> <div><div>43</div><div>47</div></div> <div>43</div>	
		<div>SLOT SIZE 1 2 3</div> <div><div>56</div><div>60</div></div> <div>2</div>		<div>CASING HEIGHT (circle appropriate box</div> <div>and enter casing height)</div> <div><div>49</div><div>49</div></div> <div>above</div>	
		<div>DIAMETER OF SCREEN</div> <div>(NEAREST INCH)</div> <div><div>56</div><div>60</div></div> <div>56</div>		<div>LAND SURFACE</div> <div><div>49</div><div>51</div></div> <div>2</div> <div>(nearest foot)</div>	
<div>CIRCLE APPROPRIATE LETTER</div> <div>A WELL WAS ABANDONED AND SEALED</div> <div>WHEN THIS WELL WAS COMPLETED</div>		<div>GRAVEL PACK</div> <div>IF WELL DRILLED WAS</div> <div>FLOWING WELL INSERT</div> <div>F IN BOX 68</div> <div><div>68</div></div>		<div>LOCATION OF WELL ON LOT</div> <div>SHOW PERMANENT STRUCTURE SUCH AS</div> <div>BUILDING, SEPTIC TANKS, AND/OR</div> <div>LANDMARKS AND INDICATE NOT LESS</div> <div>THAN TWO DISTANCES</div> <div>(MEASUREMENTS TO WELL)</div>	
<div>E ELECTRIC LOG OBTAINED</div>		<div>OEP USE ONLY</div> <div>(NOT TO BE FILLED IN BY DRILLER)</div>		<div>70</div> <div>72</div> <div>74</div> <div>75</div> <div>76</div>	
<div>P TEST WELL CONVERTED TO PRODUCTION WELL</div>		<div>TELESCOPE CASING</div> <div>LOG INDICATOR</div> <div>OTHER DATA</div>		<div>70</div> <div>72</div> <div>74</div> <div>75</div> <div>76</div>	
<div>I HEREBY CERTIFY THAT THIS WELL HAS BEEN CONSTRUCTED IN</div> <div>ACCORDANCE WITH COMAR 10.17.13 "WELL CONSTRUCTION"</div> <div>AND IN CONFORMANCE WITH ALL CONDITIONS STATED IN THE</div> <div>ABOVE CAPTIONED PERMIT, AND THAT THE INFORMATION</div> <div>PRESENTED HEREIN IS ACCURATE AND COMPLETE TO THE BEST</div> <div>OF MY KNOWLEDGE.</div>		<div>DRILLERS IDENT. NO.</div> <div>223</div>		<div>DRILLERS SIGNATURE</div> <div>(MUST MATCH SIGNATURE ON APPLICATION)</div>	
<div>SITE SUPERVISOR (sign. of driller or journeyman</div> <div>responsible for sitework if different from permittee)</div>		<div>DRILLERS SIGNATURE</div> <div>(MUST MATCH SIGNATURE ON APPLICATION)</div>		<div>DRILLERS SIGNATURE</div> <div>(MUST MATCH SIGNATURE ON APPLICATION)</div>	

Well Permit No. HO - 81-2621
Location of property (road) SUNSET VALLEY
Subdivision SUNSET VALLEY ESTATES Lot 6 Block Plat Sec. 1
Well Driller RALPH MAYNE Owner BENNETT ROBERT

I. High rate pumping -- reservoir drawdown

Time pump started 8:00 Pumping rate 10 GPM
Total time 15 min to reach pumping water level 34 ft. below M.P.

II. Recovery pump test data - observations to be recorded every 15 minutes

[illegible]

29156

HOWARD COUNTY HEALTH DEPARTMENT
Bureau of Environmental Health
3525-H Ellicott Mills Drive
Ellicott City, MD 21043
461-9933

APPLICATION FOR PITLESS ADAPTER, WELL PUMP AND PRESSURE TANK INSTALLATION

New Installation ☒
Replacement ☐

Receipt # 42677
Date 10/3/88

Name of Installer CLARKE P & H Inc

Telephone 489-4029

License Number 3808

Certified Well Pump Installer _____ Well Driller _____ Registered Plumber 3808

Name of Property Owner Robert Bennett

Telephone 442-1270

Subdivision Sunset Valley Lot # 6

Well Tag # _____

Site Address 955 Sunset Valley Dr

Pump

1. Type
 - a. Deep well jet _____
 - b. Shallow well jet _____
 - c. Submersible ☒
2. Make Goodyear
3. Model # _____
4. Capacity _____ GPM
5. Pump exceeds well capacity Yes _____ No ☒
6. If Yes, is low pressure cutoff switch installed? Yes _____ No _____
7. What methods are used to protect the pump and electrical wiring from vibrations? Torque arrestors _____ Cable guards ☒ Other _____

Motor

1. Horsepower 1/2
2. RPM _____
3. Voltage _____
 - a. 110 _____
 - b. 220 ☒

Pitless Adapter

1. Make _____
2. Model # _____
3. Depth _____

Tank

1. Capacity V-100-669A1
2. Pressure relief valve? 25 lb

Piping

1. Type Plastic
2. Size 1"
3. NSF and/or BOCA Code approved _____
4. Depth of supply line 42"

Well data

1. Depth 120 ft.
2. Yield _____ GPM
3. Static water level _____ ft.
4. Will water supply be disinfected by installer? NO Builder

I understand that it is my responsibility to notify the Howard County Health Department when the installation is ready for inspection (otherwise this permit is null and void).

All information given above is true to the best of my knowledge.

Signature of Applicant: Robert C. Clarke

Date: 9-22-88

Note: A sticker indicating approval/status of the installation will be placed on the well casing at the time of the inspection.