

ISSUE DATE: 8/28/01**PERMIT**P 516 004APPROVAL DATE: 8/28/01**INDEXED**A REPAIR**ON-SITE SEWAGE DISPOSAL SYSTEM
HOWARD COUNTY HEALTH DEPARTMENT
BUREAU OF ENVIRONMENTAL HEALTH****03-299430**

K & K Excavating

IS PERMITTED TO INSTALL ☐ ALTER ☒ADDRESS: 14960 Frederick Road PHONE NUMBER: 410-442-1336SUBDIVISION: Woodmark LOT NUMBER: 27ADDRESS: 12195 Rilland Court PROPERTY OWNER: ShahSEPTIC TANK CAPACITY (GALLONS): 1250 gal existingPUMP CHAMBER CAPACITY (GALLONS): N/ANUMBER OF BEDROOMS: 4SQUARE FEET PER BEDROOM: 180LINEAR FEET OF TRENCH REQUIRED: 140 x 5 1/2 ft. of Stone = 770 sq ft effective area

TRENCHES:	Trench to be <u>2</u> feet wide. Inlet <u>3</u> feet below original grade. Bottom maximum depth <u>8 1/2</u> feet below original grade. Effective area begins at <u>3</u> feet below original grade. <u>5 1/2</u> feet of stone below distribution pipe.
LOCATION:	<u>Place Trenches on contour via New dist. Box to South of existing dry well, OK to Abandon & Fill old dry well when new system complete. Check Baffle on old ST. (Terra Gita)</u>
PURPOSE:	Existing septic system has failed. Call for inspection when ground is opened so sanitarian can recommend repair.

PLANS APPROVED: R. P. Pulley DATE: 8/28/01

NOTE: PERMIT VOID AFTER 2 YEARS

NOTE: CONTRACTOR RESPONSIBLE FOR SCHEDULING A PRE-CONSTRUCTION INSPECTION FOR ALL INSTALLATIONS

NOTE: WATERTIGHT SEPTIC TANKS REQUIRED

NOTE: ALL PARTS OF SEPTIC SYSTEM SHALL BE 100 FEET FROM ANY WATER WELL

NOTE: MANHOLE RISERS REQUIRED ON ALL SEPTIC TANKS AND PUMP CHAMBERS

**NEITHER THE HOWARD COUNTY COUNCIL NOR THE HEALTH DEPARTMENT IS
RESPONSIBLE FOR THE SUCCESSFUL OPERATION OF ANY SYSTEM
PERMITTEE RESPONSIBLE FOR OBTAINING FINAL APPROVAL ON THIS PERMIT
CALL 410-313-2640 FOR INSPECTION OF SEPTIC SYSTEM**

0516004

Test Hole A

see old permit P29586 A18405

8" Topsoil
1/2" Red CL-HL
(2 R-m. 56k)
1/4" color Banded Rubber
1/4" L-57
1/4" Par-pacis cobbles

NOT TO SCALE

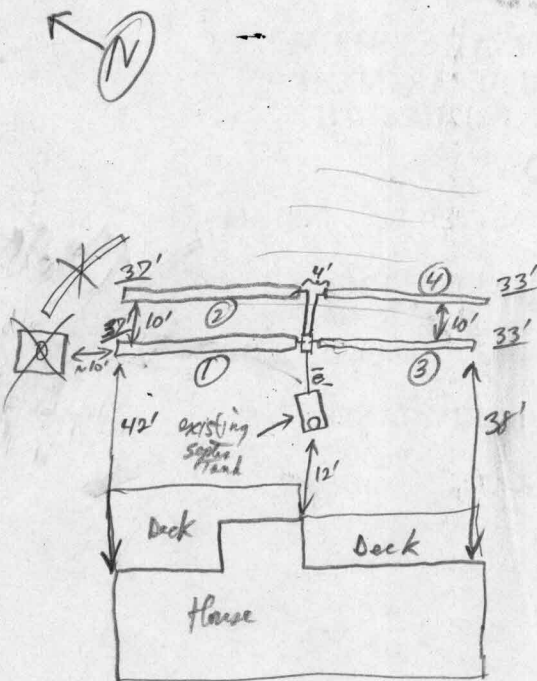

TRENCH DATA

TRENCH WIDTH 2 FT
TRENCH INLET DEPTH 3 FT
TRENCH BOTTOM DEPTH 8 1/2 FT
DEPTH OF STONE 5 1/2 FT
NUMBER OF TRENCHES 4
2 x 33', 2 x 39'
TOTAL TRENCH LENGTH 140 LF
ABSORBENT AREA 770 sq ft
DISTRIBUTION BOX LEVEL ✓
BAFFLE IN DISTRIBUTION BOX ✓

SEPTIC TANK DATA

SEPTIC TANK existing 1250 GALLONS
MANHOLE RISER Narrow 2 1/2 ft
6 INCH INSPECTION PORT NA

PUMP CHAMBER DATA

PUMP CHAMBER GALLONS NA
MANHOLE RISER _____
ALARM _____
PUMP PERFORMANCE TEST _____

Ritland Ct

PRE-CONSTRUCTION INSPECTION: Per Hole Silt ok 3'-14 1/2' (per stragg, nice nice loam - sandy loam)

INSPECTION COMMENTS: Old dry wall collapsed + filled in, old trench abandoned; supply line feeder line laid
First 3 trenches completed + covered, 4 trench open section of v. weak structural aggregate (30% in sandy loam material)
in first 15 ft of Trench #4 - OK to use. Plenty of Absor Area remaining. OK to continue + cover
all work when finished. 8/28/01

INSPECTOR

R. P. P. P.

DATE SYSTEM APPROVED

8/28/01

$$4 \times 35 = 140' \times 4' = 560' \\ 180 \text{ sq ft} \times 4 \text{ lines} = 720 \text{ sq ft} \\ 140 / 180 = 0.777 \\ 140 / 140 = 1.0 \\ 400$$