

LAYOUT _____

INSP 1 _____ INSP 3 _____

INSP 2 _____ INSP 5 _____

ISSUE DATE: 2-17-11

APPROVAL
DATE: _____

PERMIT

SHARED SEPTIC SYSTEM

P 534473

A _____

Tax ID # 04-369750
HOUSE SEWER LINE CONNECTION

HOWARD COUNTY HEALTH DEPARTMENT
BUREAU OF ENVIRONMENTAL HEALTH

Fogles Septic Clean Inc. IS PERMITTED TO INSTALL ☒ ALTER ☐

ADDRESS: 580 Obrecht Rd Sykesville MD 21784 PHONE NUMBER: 410-795-5670

SUBDIVISION Hopkins Choice LOT NUMBER: 5

ADDRESS: 13917 Ryon Drive PROPERTY OWNER: Toll MD II LP

NUMBER OF BEDROOMS: 4

HOUSE SERVED BY PUBLIC WATER? NO

LOCATION:	Install 4" house sewer line connection per the approved site plan.
NOTES:	This permit is limited to the installation of the individual house sewer line connection and installation of the grinder pump, if applicable. The Howard County Bureau of Utilities must be contacted for scheduling of inspection of these items as well, at 410-313-4900.

PLANS APPROVED: Kevin Wolf DATE: 1/6/11

PERMIT VOID AFTER 2 YEARS

1. CONTRACTOR IS RESPONSIBLE FOR SCHEDULING A PRE-CONSTRUCTION INSPECTION FOR ALL INSTALLATIONS.
2. ALL PARTS OF SEPTIC SYSTEM SHALL BE 100 FEET FROM ANY WATER WELL UNLESS SPECIFICALLY AUTHORIZED.
3. MANHOLE RISERS REQUIRED ON ALL SEPTIC TANKS AND PUMP CHAMBERS UNLESS SPECIFICALLY AUTHORIZED.
4. CONTRACTOR RESPONSIBLE FOR COMPLIANCE WITH APPLICABLE REGULATIONS, GUIDELINES AND THE TERMS OF THIS PERMIT.
5. NEITHER THE HOWARD COUNTY COUNCIL NOR THE HEALTH DEPARTMENT IS RESPONSIBLE FOR THE SUCCESSFUL OPERATION OF ANY SYSTEM.
6. PERMITTEE RESPONSIBLE FOR OBTAINING FINAL APPROVAL ON THIS PERMIT.

CALL 410-313-1771 FOR INSPECTION HOUSE CONNECTION

NOT TO SCALE

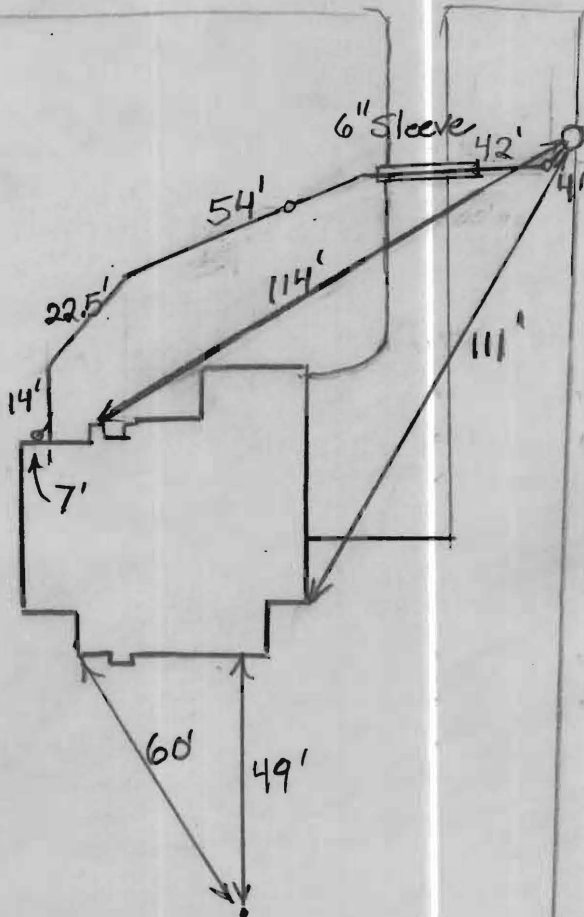

HO-94-4074

ROAD NAME

TRENCH/DRAINFIELD DATA

WIDTH _____ INLET _____ BOTTOM _____
 NUMBER OF TRENCHES _____
 TOTAL LENGTH _____
 ABSORPTION AREA _____
 DISTRIBUTION BOX LEVEL _____
 DISTRIBUTION BOX BAFFLE _____
 DISTRIBUTION BOX PORT _____

SEPTIC TANK DATA

SEPTIC TANK 1 LEVEL _____
 MANUFACTURER _____
 CAPACITY _____ GAL
 SEAM LOC _____
 TANK LID DEPTH _____
 BAFFLES _____
 BAFFLE FILTER _____
 MANHOLE LOC _____
 6" PORT LOC _____
 WATERTIGHT TEST _____
 SLOTTED _____
 DATE ON LID _____

PUMP/SEPTIC TANK LEVEL

MANUFACTURER _____
 CAPACITY _____ GAL
 SEAM LOC _____
 TANK LID DEPTH _____
 BAFFLES _____
 BAFFLE FILTER _____
 MANHOLE LOC _____
 6" PORT LOC _____
 WATERTIGHT TEST _____
 SLOTTED _____
 DATE ON LID _____

PRE-CONSTRUCTION:

INSTALLATION: 3/1/11 Contractor hired lot 19 called in but was on lot 5 instead. Contractor only 10% trench dug (see)
 3/2/2011 House connection made. Part of gravity line installed. BB
 3/3/2010 Connection to grinder pump finished. Need approval from utilities to finish the system. BB

FINAL INSPECTOR _____ DATE OF APPROVAL _____

