

6/25/09 correspondence

LAYOUT 6/26/09 INSP 4 _____

INSP 2 7/1/09 INSP 5 _____

INSP 3 7/2/09 INSP 6 _____

ISSUE DATE: 6-25-09

PERMIT

P 531057

APPROVAL DATE: 12/7/09

A 525157

TAX ID # 04351304

ON-SITE SEWAGE DISPOSAL SYSTEM HOWARD COUNTY HEALTH DEPARTMENT BUREAU OF ENVIRONMENTAL HEALTH

In Pat Trac

Charles A. Klein & Sons, Inc. IS PERMITTED TO INSTALL ☒ ALTER ☐

ADDRESS: 5220 Klee Mill Rd, Sykesville PHONE NUMBER: 410-549-6960

SUBDIVISION: _____ LOT NUMBER: 10

ADDRESS: 3737 Sharp Rd PROPERTY OWNER: Katherine Carta

SEPTIC TANK CAPACITY (GALLONS): 2000 OUTLET BAFFLE FILTER REQUIRED ☐

PUMP CHAMBER CAPACITY (GALLONS): 1500 COMPARTMENTED TANK REQUIRED ☒

NUMBER OF BEDROOMS: 5

SQUARE FEET PER BEDROOM: _____

LINEAR FEET OF TRENCH REQUIRED: 194

TRENCHES:	Trench to be 3.0 feet wide. Inlet 3.0 feet below original grade. Bottom maximum depth 6.0 feet below original grade. Effective area begins at 4.0 feet below original grade. 2.0 feet of stone below distribution pipe.
LOCATION:	
NOTES:	Install system per plan unless directed by Health Department. Layout inspection required prior to installation.

PLANS APPROVED: Sara Sappington DATE: 5/21/07

NOTE: PERMIT VOID AFTER 2 YEARS

NOTE: CONTRACTOR RESPONSIBLE FOR SCHEDULING A PRE-CONSTRUCTION INSPECTION FOR ALL INSTALLATIONS

NOTE: WATERTIGHT SEPTIC TANKS REQUIRED

NOTE: ALL PARTS OF SEPTIC SYSTEM SHALL BE 100 FEET FROM ANY WATER WELL

NOTE: MANHOLE RISERS REQUIRED ON ALL SEPTIC TANKS AND PUMP CHAMBERS UNLESS SPECIFICALLY AUTHORIZED

**NEITHER THE HOWARD COUNTY COUNCIL NOR THE HEALTH DEPARTMENT IS
RESPONSIBLE FOR THE SUCCESSFUL OPERATION OF ANY SYSTEM
PERMITTEE RESPONSIBLE FOR OBTAINING FINAL APPROVAL ON THIS PERMIT
CALL 410-313-1771 FOR INSPECTION OF SEPTIC SYSTEM**

NOT TO SCALE

TRENCH/DRAINFIELD DATA

WIDTH	INLET	BOTTOM
3	3'	6

NUMBER OF TRENCHES 3'

TOTAL LENGTH 195

ABSORPTION AREA 585 + SW

DISTRIBUTION BOX LEVEL Yes

DISTRIBUTION BOX BAFFLE 45° bend

DISTRIBUTION BOX PORT Yes

SEPTIC TANK DATA

SEPTIC TANK 1 LEVEL Yes

MANUFACTURER Babylon

CAPACITY 2000 GAL

SEAM LOC Top

TANK LID DEPTH 2.5'

BAFFLES Yes

BAFFLE FILTER

MANHOLE LOC Front

6" PORT LOC Rear

WATERTIGHT TEST

SLOTTED Yes

DATE ON LID ?

PUMP/SEPTIC TANK LEVEL Yes

MANUFACTURER Babylon

CAPACITY 1500 GAL

SEAM LOC Top

TANK LID DEPTH 3-4'

BAFFLES Front

BAFFLE FILTER

MANHOLE LOC Rear

6" PORT LOC none

WATERTIGHT TEST

SLOTTED no

DATE ON LID ?

See Separate Sheet
for AS-Built

12/7/09 Pump and alarm working. Float
tree installed in tank. Electrical connections
on 4" x 4" outside of tank. Need to tie
together extra float wiring in tank. (RB)

ROAD NAME

PRE-CONSTRUCTION:

6/25/09 Received call from contractor about questions on sys. design. Pulled the
only to realize that permit has not been paid for or received. Told contractor
to stop all work till further notice (KW) 6/26/09 Site visit made to
layout system. Talks were set. Told contractor that some rock
to be removed or tanks may need to be removed. Layout given.
Install 3 trenches. (55, 65, 75' long) to best contour. (KW)

INSTALLATION:

7/1/09 F.M. ran to Dbox. Top most trench installed.

OK to continue. (KW) 7/2/09 Trenches complete. Contractor

used up some area for adjustment of contour. Explained to

homeowner about pump tank, alarm etc... Need p/A test

for final approval (KW) 11/30/09 P/A test failed. Told builder

need float tree and floats securely attached. All electrical connections

need to be mantled outside tank. Call to inspect and perform p/A

FINAL INSPECTOR B. Baker

DATE OF APPROVAL 12/7/09

↑ Sharp Rd. ↑

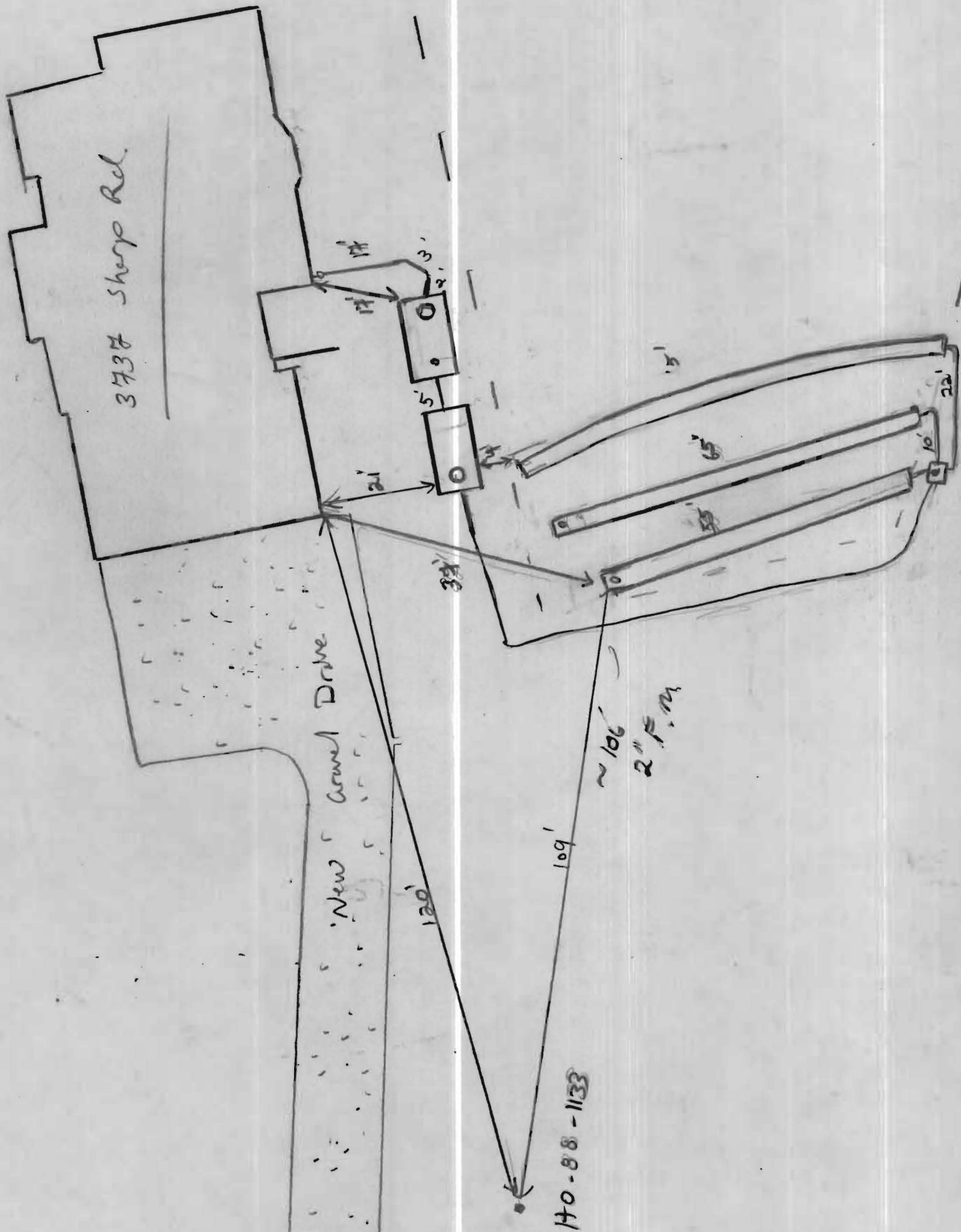

NOT TO SCALE



Howard County
Health Department

7178 Columbia Gateway Drive, Columbia MD 21046
(410) 313-2640 Fax (410) 313-2648
TDD (410) 313-2323 Toll Free 1-866-313-6300
website: www.hchealth.org

Peter L. Beilenson, M.D., M.P.H., Health Officer

January 11, 2010

TO: Priscilla Matthews
Associated Excavators Contractors, LLC

FROM: Sara Sappington, R.S. *SS*
(410) 313 - 4261
Well and Septic Program
Bureau of Environmental Health

RE: 3737 Sharp Rd

The Howard County Health Department has no objection to the release of the demolition permit for the existing house which originally occupied the referenced property. The existing well is to remain and has been connected to the new home. A well line inspection has been completed and an Interim Certificate of Potability has been issued. The original septic system on the property has been properly abandoned.

Cc: File

ASSOCIATED EXCAVATORS CONTRACTORS
16657 FREDERICK ROAD
MT. AIRY, MD 21771
(410) 442-1886 FAX (410) 442-0100

January 11, 2010

Howard County Health Department
C/o Sarah Sappington
7178 Columbia Gateway Drive
Columbia, MD 21045

Dear Ms. Sappington:

This letter is to inform you that my company performed the abandonment of the cesspool located at 3737 Sharp Rd Glenwood, Maryland. The well that is on the property will is being used for new house.

Please see the attached drawing.

If you have any questions please call me at (410) 977.2216.

Thank you,

Mike Johnson

Cc: Mr. Ron Green

3737
Sharp Rd

