

LAYOUT 9/9/08 INSP 4 _____
INSP 2 _____ INSP 5 _____
INSP 3 _____ INSP 6 _____

Upgrade

ISSUE DATE: 09/08/08

P 529555

APPROVAL DATE: 9/10/08

A 528445

PERMIT

TAX ID # 05-395933

**ON-SITE SEWAGE DISPOSAL SYSTEM
HOWARD COUNTY HEALTH DEPARTMENT
BUREAU OF ENVIRONMENTAL HEALTH**

J M Contracting LLC IS PERMITTED TO INSTALL ☒ ALTER ☐

ADDRESS: 425 Obrecht Rd, Sykesville PHONE NUMBER: 443-277-7526

SUBDIVISION: _____ LOT NUMBER: _____

ADDRESS: 13351 Triadelphia Mill Rd PROPERTY OWNER: Yolanda Elliott

SEPTIC TANK CAPACITY (GALLONS): 2000 OUTLET BAFFLE FILTER REQUIRED ☐

PUMP CHAMBER CAPACITY (GALLONS): _____ COMPARTMENTED TANK REQUIRED ☒

NUMBER OF BEDROOMS: 5

*50', 70' + 90' Trenches
5'-9'*

SQUARE FEET PER BEDROOM: _____

LINEAR FEET OF TRENCH REQUIRED: 220 210'

TRENCHES:	Trench to be 3.0 feet wide. Inlet 4.0 feet below original grade. Bottom maximum depth 8.0 feet below original grade. Effective area begins at 6.5 feet below original grade. 4.0 feet of stone below distribution pipe.
LOCATION:	1) Set Distribution box 60 feet from highest septic easement corner. 2) Install 2x70' & 1x80' trenches on contour. 3) Add 1000 gallon septic tank or replace existing septic tank with a 2000 gallon tank.
NOTES:	1) Stake septic easement corners 2) Call for layout inspection. 3) Mark utilities 4) Existing dry well & trench must be properly abandoned prior to septic system installation approval.

PLANS APPROVED: Robert Bricker DATE: 9/8/08

NOTE: PERMIT VOID AFTER 2 YEARS

NOTE: CONTRACTOR RESPONSIBLE FOR SCHEDULING A PRE-CONSTRUCTION INSPECTION FOR ALL INSTALLATIONS

NOTE: WATERTIGHT SEPTIC TANKS REQUIRED

NOTE: ALL PARTS OF SEPTIC SYSTEM SHALL BE 100 FEET FROM ANY WATER WELL

NOTE: MANHOLE RISERS REQUIRED ON ALL SEPTIC TANKS AND PUMP CHAMBERS UNLESS SPECIFICALLY AUTHORIZED

**NEITHER THE HOWARD COUNTY COUNCIL NOR THE HEALTH DEPARTMENT IS
RESPONSIBLE FOR THE SUCCESSFUL OPERATION OF ANY SYSTEM
PERMITTEE RESPONSIBLE FOR OBTAINING FINAL APPROVAL ON THIS PERMIT
CALL 410-313-1771 FOR INSPECTION OF SEPTIC SYSTEM**

NOT TO SCALE

See As-Built
Drawing On
Seperate Sheet

TRENCH/DRAINFIELD DATA

WIDTH INLET BOTTOM
3' 5' 9'

NUMBER OF TRENCHES 3

TOTAL LENGTH 226'

ABSORPTION AREA 678+Sidewall

DISTRIBUTION BOX LEVEL Levelers

DISTRIBUTION BOX BAFFLE Yes

DISTRIBUTION BOX PORT No

SEPTIC TANK DATA

SEPTIC TANK 1 LEVEL Yes

MANUFACTURER _____

CAPACITY _____ GAL

SEAM LOC Midseam

TANK LID DEPTH 6.5'

BAFFLES Yes

BAFFLE FILTER No

MANHOLE LOC Front

6" PORT LOC None

WATERTIGHT TEST No

SLOTTED No

PUMP/SEPTIC TANK LEVEL Yes

MANUFACTURER Babylon

CAPACITY 1000 GAL

SEAM LOC Top

TANK LID DEPTH 2.5'-4'

BAFFLES Yes

BAFFLE FILTER No

MANHOLE LOC Middle

6" PORT LOC Front

WATERTIGHT TEST No

SLOTTED No

PRE-CONSTRUCTION

9/9/08 Can fit a
50', 70' and 90' trench
in upper part of ease-
ment. Trench specs.
changed. Set new

tank just above top middle of easement. (BB)

INSTALLATION: 9/10/08 Trenches and tank installed. System
finished. O.K. to backfill. (BB)

FINAL INSPECTOR

B. Baber

DATE OF APPROVAL

9/10/08

10-81-0278

Driveway

13551 Triadelphia
Mill Road

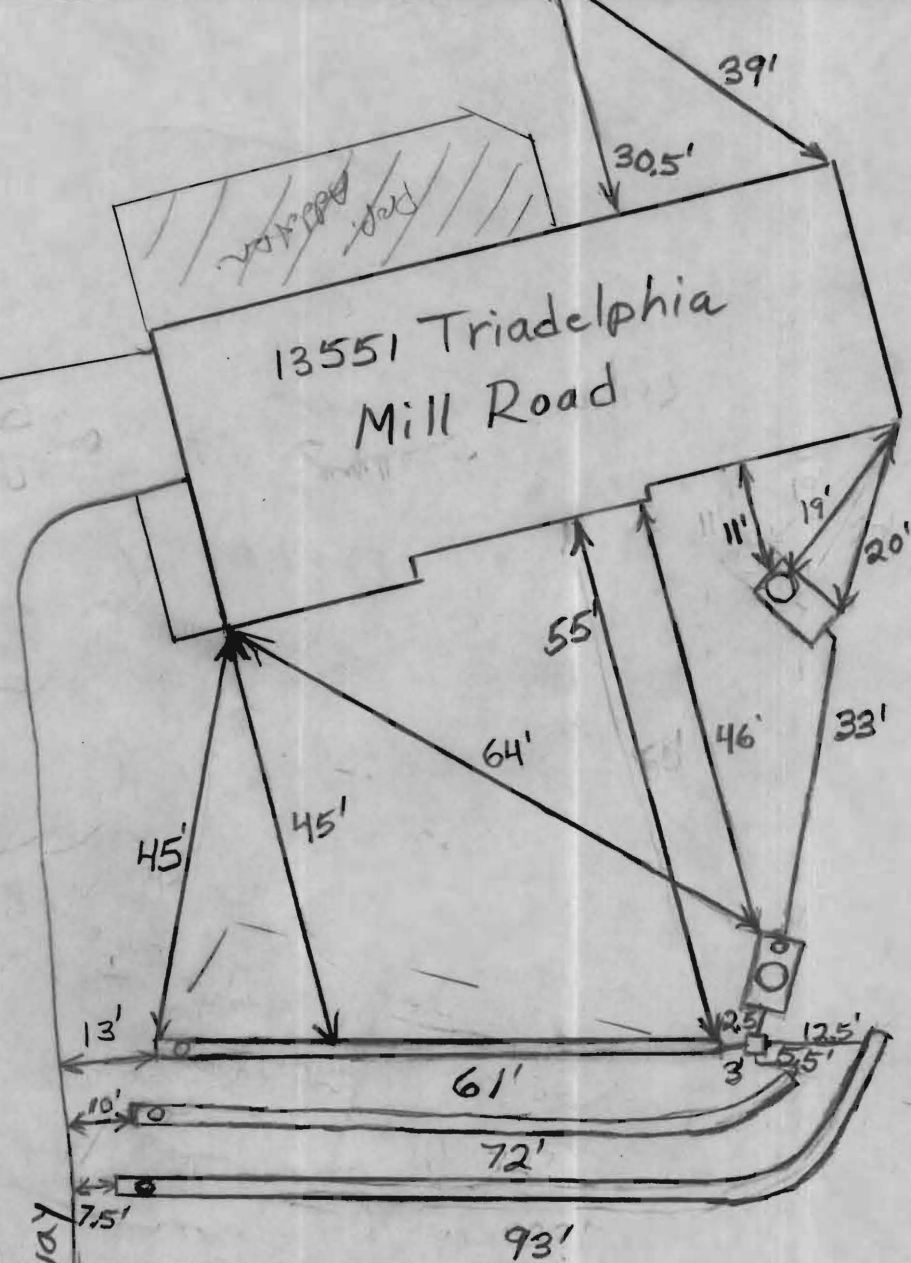

NOT TO SCALE