



Howard County
Health Department

Bureau of Environmental Health
7178 Gateway Drive Columbia, MD 21046
(410) 313-2640 Fax (410) 313-2648
TDD (410) 313-2323 Toll Free 1-866-313-6300
website: www.hchealth.org

Maura J. Rossman, M.D., Health Officer

RECEIPT DATE: 5-30-13 **ONSITE SEWAGE DISPOSAL SYSTEM**

P 545056

INSTALLATION
APPROVAL DATE: 6/21/13

A _____

PERMIT

SEWER HOUSE CONNECTION

PROPERTY ADDRESS: 3305 Secretariat Way

SUBDIVISION: Maplewood Farms

LOT: 1

TAX ID: 04-373065

CONTRACTOR: Envision Builders LLC.

EMAIL: Rgentry@envisionbuild.net

CONTRACTOR ADDRESS: 7939 Honeygo Blvd Ste 112, White Marsh, MD 21236

PHONE: 410-925-5992

PROPERTY OWNER: ABA Properties LLC.

EMAIL: _____

OWNER ADDRESS: 7221 Lee Deforest Drive, Ste 100, Columbia, MD 21046

PHONE: 410-953-0505

NUMBER OF BEDROOMS: 4 HOUSE SQ. FT. 4578 CONNECTED TO PUBLIC WATER: ☐ YES ☐ NO

LOCATION:	INSTALL 4" SEWER LINE PER APPROVED SITE PLAN.
NOTES:	

ISSUED BY: Dana Bernard

ISSUE DATE: 5-30-13

EXPIRATION DATE: 2/11/14

NOTE: HOWARD COUNTY BUREAU OF UTILITIES APPROVAL OF GRINDER PUMP INSTALLATION IS REQUIRED PRIOR TO SEPTIC PERMIT APPROVAL

NOTE: CONTRACTOR MUST SCHEDULE AN INSPECTION AND GAIN APPROVAL OF ALL COMPONENTS PRIOR TO COVERING

NOTE: AN ELECTRICAL PERMIT IS REQUIRED FOR INSTALLATION OF ANY ELECTRICAL COMPONENTS OF THE SYSTEM

**NEITHER THE HOWARD COUNTY COUNCIL NOR THE HEALTH DEPARTMENT IS RESPONSIBLE FOR THE SUCCESSFUL OPERATION OF ANY SYSTEM.
PERMITTEE RESPONSIBLE FOR OBTAINING FINAL APPROVAL ON THIS PERMIT.
CALL 410-313-1771 FOR INSPECTION OF SEPTIC SYSTEM.**

NOT TO SCALE

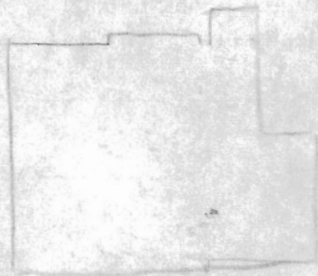

TRENCH/DRAINFIELD DATA

WIDTH INLET BOTTOM

NUMBER OF TRENCHES _____
TOTAL LENGTH _____
ABSORPTION AREA _____
DISTRIBUTION BOX LEVEL _____
DISTRIBUTION BOX BAFFLE _____
DISTRIBUTION BOX PORT _____

SEPTIC TANK DATA

SEPTIC TANK 1 LEVEL _____
MANUFACTURER _____
CAPACITY _____ GAL
SEAM LOC _____
TANK LID DEPTH _____
BAFFLES _____
BAFFLE FILTER _____
MANHOLE LOC _____
6" PORT LOC _____
WATERTIGHT TEST _____
SLOTTED _____
DATE ON LID _____

PUMP/SEPTIC TANK LEVEL _____
MANUFACTURER _____
CAPACITY _____ GAL
SEAM LOC _____
TANK LID DEPTH _____
BAFFLES _____
BAFFLE FILTER _____
MANHOLE LOC _____
6" PORT LOC _____
WATERTIGHT TEST _____
SLOTTED _____
DATE ON LID _____

ROAD NAME

PRE-CONSTRUCTION:

INSTALLATION:

FINAL INSPECTOR _____ DATE OF APPROVAL _____

BURNTWOODS ROAD

60' R/W
(PUBLIC ROAD)

BUILDABLE PRESERVATION
PARCEL 'A'
MAPLEWOOD FARMS
PLAT No. 19375

MCS NAD 83/91

RCF S 14°07'59" W RCF S 10°26'34" E
34.96' 68.84'

10' PRIVATE SURFACE
DRAINAGE EASEMENT
PLAT No. 19374

LOT 1
33,002 S.F.

#3305
SECRETARIAT WAY
POURED CONCRETE
FOUNDATION
TOP WALL ELEV.=567.6'

EX.
WELL

Wall
Check
OK

DB
5-20-13

LOT 2

10' PUBLIC DRAINAGE,
TREE MAINTENANCE
& UTILITY EASEMENT
PLAT No. 19374

SECRETARIAT WAY

40' R/W
(PUBLIC ACCESS PLACE)

10'X20' PUBLIC SEWER
& UTILITY EASEMENT
PLAT No. 19374

LEGEND

RCF =REBAR & CAP FOUND
B.R.L.=BUILDING RESTRICTION LINE

Note:

- THIS PLAT IS OF BENEFIT TO A CONSUMER ONLY INSOFAR AS IT IS REQUIRED BY A LENDER OR A TITLE COMPANY OR ITS AGENT IN CONNECTION WITH CONTEMPLATED TRANSFER, FINANCING, OR RE-FINANCING;
- THE PLAT IS NOT TO BE RELIED UPON FOR THE ESTABLISHMENT OR LOCATION OF FENCES, GARAGES, BUILDINGS, OR OTHER EXISTING OR FUTURE IMPROVEMENTS; AND
- THE PLAT DOES NOT PROVIDE FOR THE ACCURATE IDENTIFICATION OF PROPERTY BOUNDARY LINES, BUT SUCH IDENTIFICATION MAY NOT BE REQUIRED FOR THE TRANSFER OF TITLE OR SECURING FINANCING OR RE-FINANCING.
- THE SUBJECT PROPERTY LIES IN ZONE "X" (AREAS DETERMINED TO BE OUTSIDE THE 2% ANNUAL CHANCE FLOODPLAIN) AS SHOWN ON F.I.R.M. MAP No. 240044 0020B DATED DECEMBER 4, 1986 FOR HOWARD COUNTY, MARYLAND.
- I CERTIFY THAT THESE DOCUMENTS WERE PREPARED BY ME OR UNDER MY RESPONSIBLE CHARGE, AND THAT I AM A DULY LICENSED PROFESSIONAL LAND SURVEYOR UNDER THE LAWS OF THE STATE OF MARYLAND, LICENSE No.21543, EXPIRATION DATE DECEMBER 21, 2013.

D. DARRIN KIRK
D. DARRIN KIRK
PROFESSIONAL LAND SURVEYOR
MD REGISTRATION No. 21543



Pennoni Associates Inc.
Consulting Engineers

Pennoni

8818 Centre Park Drive,
Columbia, MD 21045
T 410.997.8900 F 410.997.9282

WALL CHECK DRAWING

MAPLEWOOD FARMS

LOT 1

MAPLEWOOD FARMS

LOTS 1 THRU 6, BUILDABLE PRESERVATION PARCEL 'A' &
NON-BUILDABLE PARCELS 'B' & 'C'

PLAT No. 19374

4TH ELECTION DISTRICT, HOWARD COUNTY, MARYLAND

SCALE: 1"=40'

PROJ. No. ENVB1202

DRAWN BY: H.J.M.

DATE: 03.11.13