

APPLICATION

PERCOLATION TESTING

HOWARD COUNTY HEALTH DEPARTMENT
BUREAU OF ENVIRONMENTAL HEALTH
3525-H ELLICOTT MILLS DRIVE/ELLICOTT CITY, MARYLAND 21043
TELEPHONE: 410-313-2640

A

P

DISTRICT

DATE

TO: THE COUNTY HEALTH OFFICER
ELLICOTT CITY, MARYLAND

I HEREBY APPLY FOR THE NECESSARY TEST PRIOR TO APPLICATION FOR PERMIT TO CONSTRUCT (OR RECONSTRUCT) A SEWAGE DISPOSAL SYSTEM.

PROPERTY OWNER Frank J. DeFrancis Revocable Trust, Joseph A. DeFrancis, Trustee

ADDRESS 5192 Sheppard Lane, Clarksville, MD 21039 PHONE

AGENT OR PROSPECTIVE BUYER Heritage Land Development

ADDRESS 3060 Washington Rd., Suite 220, Glenwood, MD 21738 PHONE 410-489-7900

PROPERTY LOCATION:

SUBDIVISION WALNUT GROVE LOT NO.

ROAD AND DESCRIPTION

5192 Sheppard Lane, Clarksville, MD 21039

TAX MAP NO. 28 PARCEL # 74

SIZE OF LOT 1 Acre TYPE OF BLDG. SFD

(SINGLE FAMILY DWELLING OR COMMERCIAL)

THE SYSTEM INSTALLED UNDER THIS APPLICATION IS ACCEPTABLE ONLY UNTIL PUBLIC FACILITIES BECOME AVAILABLE. I FULLY UNDERSTAND THE

FEE CONNECTED WITH THE FILING OF THIS PERC TEST APPLICATION IS NON-REFUNDABLE UNDER ANY CIRCUMSTANCES. I ALSO AGREE TO COMPLY

WITH ALL M.O.S.H.A. REQUIREMENTS IN TESTING THIS LOT.

(SIGNATURE OF APPLICANT)

APPROVED BY FOR DATE

DISAPPROVED BY FOR DATE

HOLD PENDING FURTHER TESTS

REASONS FOR REJECTION OR HOLDING

PERCOLATION TEST PLAT/PRELIMINARY PLAT - TITLE OR I.D. # DATE

SITE DEVELOPMENT PLAN/FINAL PLAT - TITLE OR I.D. # DATE

THIS IS NOT A PERMIT

COUNTY #

SOIL PROFILE

0' (3041)
 Red Br
 Loam
 3.5-4'
 Beige
 Sa Loam
 Very Little
 Rock
 4'
 Caving
 6'
 Mottling
 Water
 6.5'
 (1076)
 Br Loam
 2'
 Med Br
 Sa Loam
 Very Little
 Rock

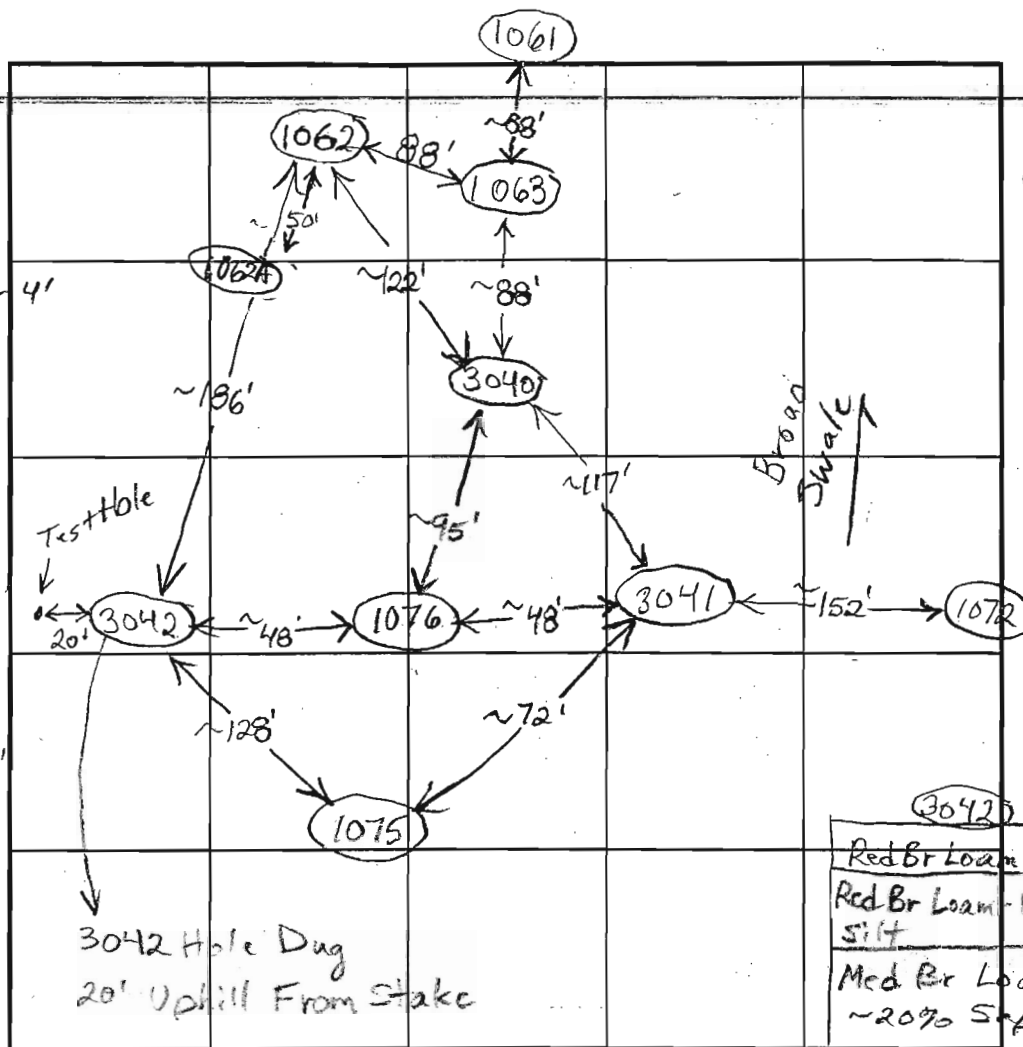

INDICATE NORTH - NAME ADJOINING ROADWAY AS BASE LINE.

SOIL PROFILE

0' (1063) (1061)
 Br Loam
 and Top soil
 1.5-2'
 Med Br
 Sa Loam
 to Loamy
 Sand
 15-20%
 Saprolite
 7'
 Caving
 8'
 Wet
 Water
 9.5'
 (3042)
 Red Br Loam
 3-4'
 Red Br Loam - Primarily
 silt
 4.5-5.5'
 Med Br Loamy Sa
 ~20% Saprolite
 13'
 Water

DATE	TEST NO.	DEPTH	PRE-WET		TEST - 1" DROP		TIME
			START	STOP	START	STOP	
5/30/03	3041	6.5'V					(F)
	3040	8.5'V					(F)
	1076	7'V					(F)
	1063	35' / 9'V	11:29:30	11:30:15	11:30:15	11:31	~1 (F)
		6.5'	11:29:30	11:30:30	11:30:30	11:32:30	2
	1061	3' / 9'V	11:43:45	11:46:15	11:46:15	11:50:15	4 (F)
		4.5'	11:43:15	11:45:15	11:45:15	11:48:30	~3
	1058	7.5'V	Similar to 1063+1061 but Water at 7.5' and Mottling Higher				(F)
	3042	5'4" / 13'V Repour 12"x12"	1:12:15 6:19 1:23	1:15:30 1:25:50	1:15:30 1:25:50	1:25:15 1:29:50	~10 4 OK

REMARKS

TYPE OF SOIL

TESTED BY B. Baker / F. Alfonso

TRENCH DESIGN DATA: AVG. PERCOLATION TIME

INLET DEPTH

MAXIMUM BOTTOM DEPTH

ALSO PRESENT

TRENCH WIDTH

SQ. FT./BEDROOM

Caving

8'
 Water
 Seeping In
 Water
 8.5'

APPLICATION

PERCOLATION TESTING

A 517420-R

P _____

HOWARD COUNTY HEALTH DEPARTMENT
BUREAU OF ENVIRONMENTAL HEALTH

3525-H ELLICOTT MILLS DRIVE/ELLICOTT CITY, MARYLAND 21043
TELEPHONE: 410-313-2640

DISTRICT _____

DATE _____

TO: THE COUNTY HEALTH OFFICER
ELLICOTT CITY, MARYLAND

I HEREBY APPLY FOR THE NECESSARY TEST PRIOR TO APPLICATION FOR PERMIT TO CONSTRUCT (OR RECONSTRUCT) A SEWAGE DISPOSAL SYSTEM.

PROPERTY OWNER Frank J. DeFrancis Revocable Trust, Joseph A. DeFrancis, Trustee

ADDRESS 5192 Sheppard Lane, Clarksville, MD 21039 PHONE _____

AGENT OR PROSPECTIVE BUYER Heritage Land Development

ADDRESS 3060 Washington Rd., Suite 220, Glenwood, MD 21738 PHONE 410-489-7900

PROPERTY LOCATION:

SUBDIVISION WALNUT GROVE LOT NO. 19

ROAD AND DESCRIPTION _____

5192 Sheppard Lane, Clarksville, MD 21039

TAX MAP NO. 28 PARCEL # 74

SIZE OF LOT 1 Acre TYPE OF BLDG. SFD
(SINGLE FAMILY DWELLING OR COMMERCIAL)

THE SYSTEM INSTALLED UNDER THIS APPLICATION IS ACCEPTABLE ONLY UNTIL PUBLIC FACILITIES BECOME AVAILABLE. I FULLY UNDERSTAND THE FEE CONNECTED WITH THE FILING OF THIS PERC TEST APPLICATION IS NON-REFUNDABLE UNDER ANY CIRCUMSTANCES. I ALSO AGREE TO COMPLY WITH ALL M.O.S.H.A. REQUIREMENTS IN TESTING THIS LOT.

(SIGNATURE OF APPLICANT)

APPROVED BY _____ FOR _____ DATE _____

DISAPPROVED BY _____ FOR _____ DATE _____

HOLD PENDING FURTHER TESTS _____

REASONS FOR REJECTION OR HOLDING _____

PERCOLATION TEST PLAT/PRELIMINARY PLAT - TITLE OR I.D. # _____ DATE _____

SITE DEVELOPMENT PLAN/FINAL PLAT - TITLE OR I.D. # _____ DATE _____

THIS IS NOT A PERMIT

517420-R

COUNTY #

SOIL PROFILE

0'

(1075)

Red Br
Heavy Loam

3'-3.5'

Or Brand
Tan Loam
and Sa Loam

5'

Med Br
Sa Loam
10-15%
Rock and
Saprolite

(1078)

13.5'

Red Br
Heavy Loam

2'

Or Br Loam

2.5'-3'

Med Br
Sa Loam
10-15%
Rock and
SaprolitePossible
Mottling, Not
Distinct

10'

Caving

Water

13'

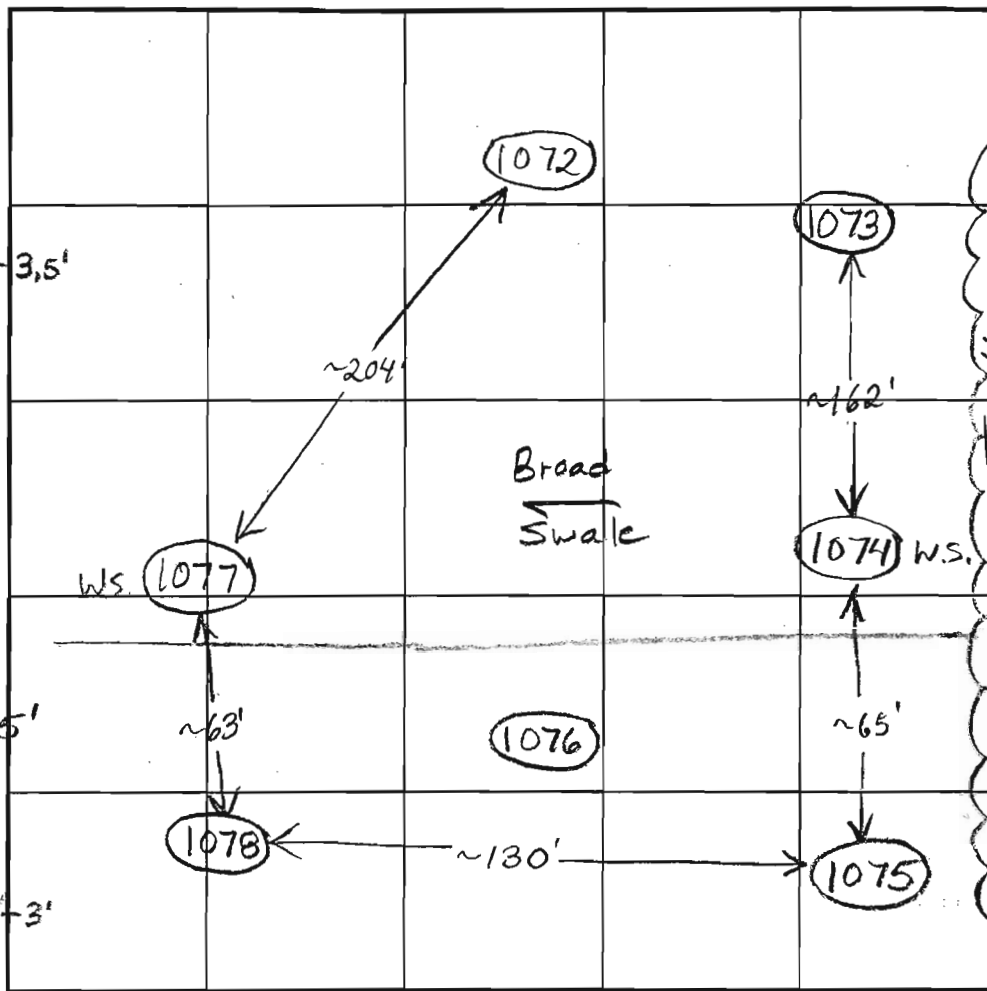

INDICATE NORTH - NAME ADJOINING ROADWAY AS BASE LINE.

SOIL PROFILE

0'

DATE	TEST NO.	DEPTH	PRE-WET		TEST - 1" DROP		TIME
			START	STOP	START	STOP	
11/27/02	1075	5' / 135' V	1:51:45	1:57:30	1:57:30	1:06:30	9 a.
		12"x12" 6'	3:52:30	3:55	3:55	3:59	4
Marginal	1078	5' / 13' V	1:23:30	1:25:30	1:25:30	1:28:20	~3 W.

REMARKS 1078, 1076, 1074 + 1077 Are Wet Season Testing

TYPE OF SOIL

TESTED BY B. Baker

ALSO PRESENT

TRENCH DESIGN DATA: AVG. PERCOLATION TIME

TRENCH WIDTH

INLET DEPTH

MAXIMUM BOTTOM DEPTH

SQ. FT./BEDROOM

Walnut Grove

A/P

500T

orig btm
clm

3.5+

14 btm
sa
lm

50%
rock

13.5

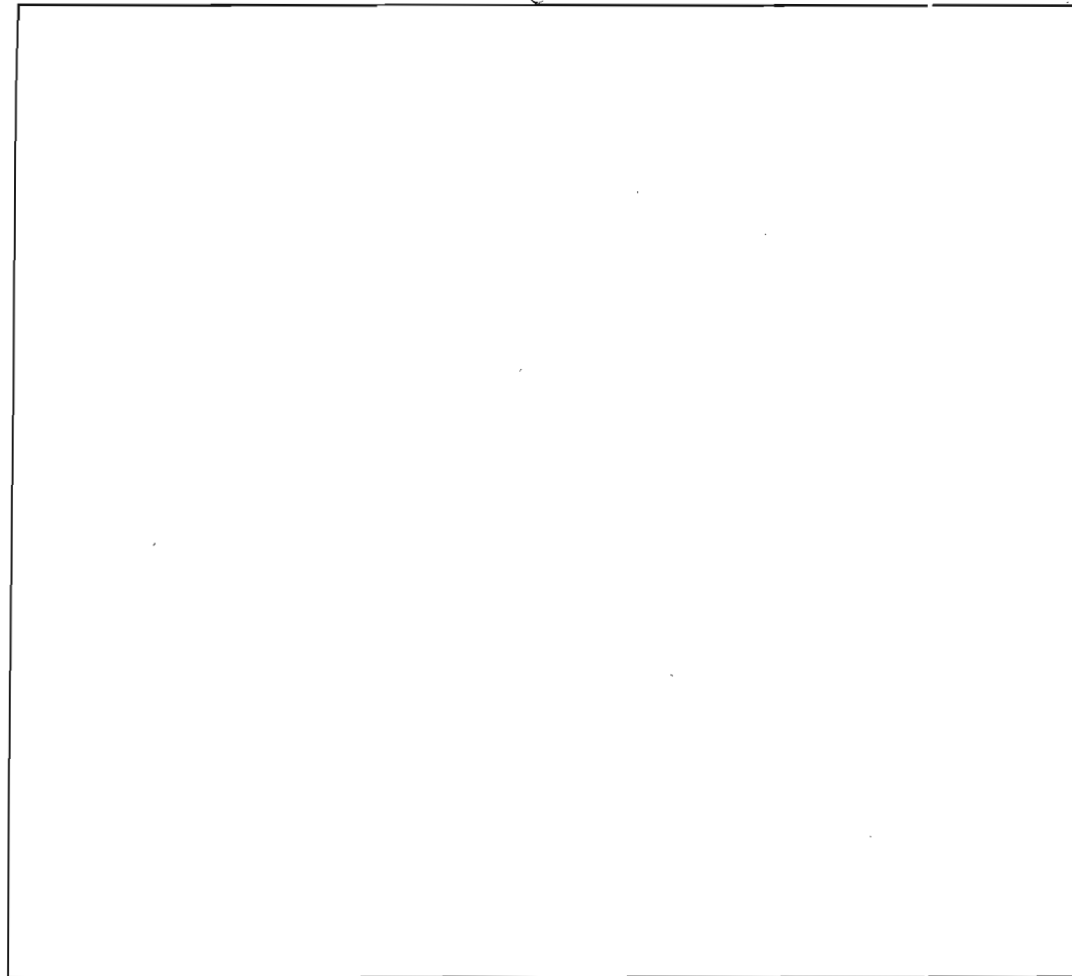

DATE	TEST #	DEPTH	START	BREAK 1" DROP	STOP 2" DROP	TIME OF 2nd INCH	P/F/H
2-5-04	5001	4.5'S	10:46	10:42	10:46	4	D
		13.5'D visual - see profile					
		NO water @ 12:00					

REMARKS

SANITARIAN

D. Clark

BACKHOE

J. Brendel

OTHERS

T. Feaga
C. Tepp

TEST HOLES USED IN SDA

AVG. PERC TIME

SQ. FT/BR

TRENCH WIDTH

INLET DEPTH

MAX. BOT DEPTH

EFFECTIVE S/W

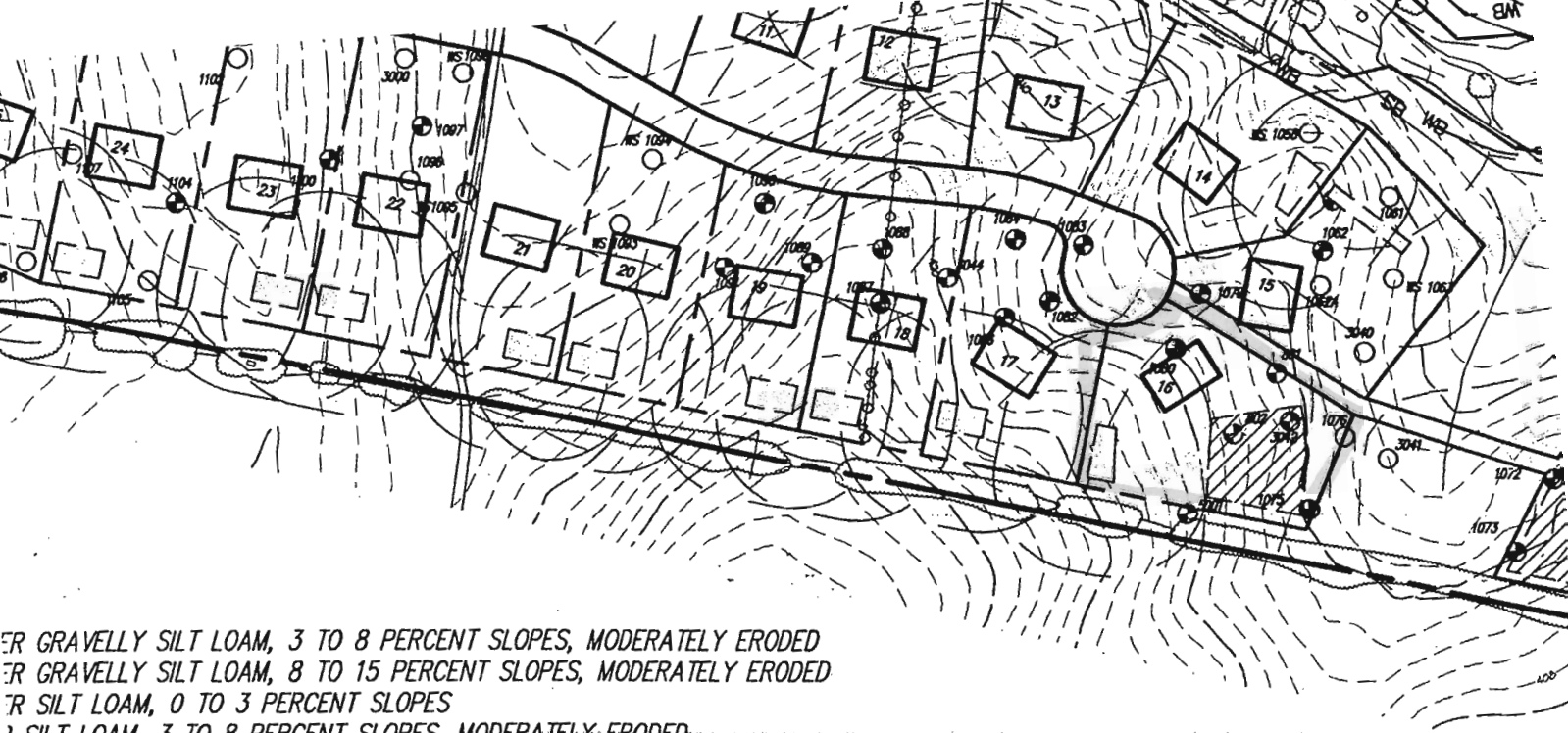

Copy of signed
PC 106

PREPARED FOR :

DEVELOPER

Trust Walnut Grove, L.L.C.
c/o Goodier Builders
10705 Charter Drive, Suite 320
Columbia, Md. 21044

ELECTION DISTRICT No. 5

PERC CERTIFICA

WALNUT GROVE LOTS 1-88 AND PRESERVATION PLAN

Columbia, Md. 21044

ELECTION DISTRICT No. 5