

LAYOUT _____ INSP 4 _____
INSP 2 _____ INSP 5 _____
INSP 3 _____ INSP 6 _____

ISSUE DATE: _____

APPROVAL DATE: _____

PERMIT

P _____

A 518561-A

INDEXED

**ON-SITE SEWAGE DISPOSAL SYSTEM
HOWARD COUNTY HEALTH DEPARTMENT
BUREAU OF ENVIRONMENTAL HEALTH**

03-287920

_____ IS PERMITTED TO INSTALL ☒ ALTER ☐

ADDRESS: _____ PHONE NUMBER: _____

SUBDIVISION: River Park Estates LOT NUMBER: 7

ADDRESS: 1105 River Road PROPERTY OWNER: Gillian Conley

SEPTIC TANK CAPACITY (GALLONS): _____ OUTLET BAFFLE FILTER REQUIRED ☐

PUMP CHAMBER CAPACITY (GALLONS): _____ COMPARTMENTED TANK REQUIRED ☐

NUMBER OF BEDROOMS: _____

SQUARE FEET PER BEDROOM: _____

LINEAR FEET OF TRENCH REQUIRED: _____

TRENCHES:	Trench to be _____ feet wide. Inlet _____ feet below original grade. Bottom maximum depth _____ feet below original grade. Effective area begins at _____ feet below original grade. _____ feet of stone below distribution pipe.
LOCATION:	
NOTES:	

PLANS APPROVED: _____ DATE: _____

NOTE: PERMIT VOID AFTER 2 YEARS

NOTE: CONTRACTOR RESPONSIBLE FOR SCHEDULING A PRE-CONSTRUCTION INSPECTION FOR ALL INSTALLATIONS

NOTE: WATERTIGHT SEPTIC TANKS REQUIRED

NOTE: ALL PARTS OF SEPTIC SYSTEM SHALL BE 100 FEET FROM ANY WATER WELL

NOTE: MANHOLE RISERS REQUIRED ON ALL SEPTIC TANKS AND PUMP CHAMBERS UNLESS SPECIFICALLY AUTHORIZED

**NEITHER THE HOWARD COUNTY COUNCIL NOR THE HEALTH DEPARTMENT IS
RESPONSIBLE FOR THE SUCCESSFUL OPERATION OF ANY SYSTEM**

PERMITTEE RESPONSIBLE FOR OBTAINING FINAL APPROVAL ON THIS PERMIT

BUILDING PERMIT SIGNED

AND RETURNED

6/20/03 800140559 FAMILY ROOM,
PORCH & GARAGE

4518561-A

~~10-25-62~~

10-30-62

PERMIT

Approved 10/30/62 85959
04217

SEWAGE DISPOSAL SYSTEM

MARYLAND STATE DEPARTMENT OF HEALTH

HOWARD COUNTY

ELICOTT CITY

DISTRICT 3
10-18-62

INDEXED

INDEXED

Howard Pickett

IS PERMITTED TO INSTALL ☒ ALTER ☐

ADDRESS _____ PHONE _____

A SEWAGE DISPOSAL SYSTEM LOCATED AT _____

SUBDIVISION River Park Estates ROAD 1932 LOT 7

PROPERTY OWNER Cameron

ADDRESS _____

SPECIFICATIONS

DRAIN FIELD _____ DEPTH _____ FEET, BOTTOM AREA _____ SQ. FT.

SEEPAGE PTS 8 ABSORBENT SIDE-WALL AREA 500 SQ. FT.

SEPTIC TANK CAPACITY 750 GALLONS

FOR GARBAGE GRINDER, INCREASE DISPOSAL AREA 22% & TANK CAPACITY 50%

OTHER To be installed in the yard which
passed the perc test.

PLANS APPROVED BY W. L. Long DATE 9/7/61

FILL SEPTIC TANK AND DISTRIBUTION BOX WITH WATER BEFORE CALLING FOR AN INSPECTION. COVER NO WORK UNTIL INSPECTED AND APPROVED.

NEITHER THE HOWARD COUNTY COMMISSIONERS NOR THE HEALTH DEPARTMENT IS RESPONSIBLE FOR THE SUCCESSFUL OPERATION OF ANY SYSTEM.

04217

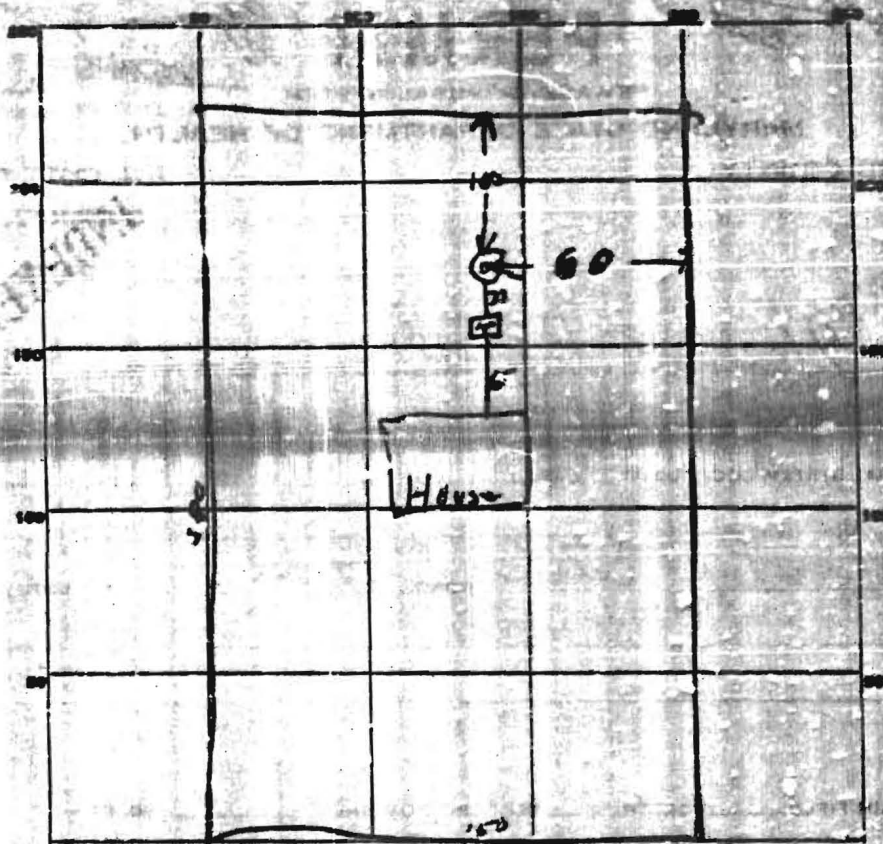

Green Road

INSPECTOR W. W. M. M. M.