

4/3/03
1pm
PUB. SEWER STATUS VERIFIED BY MR

4/4/03
12:30
Final
ISSUE DATE: 3/25/03

APPROVAL DATE: 4/4/03

PERMIT INDEXED

P 518589

A REPAIR

ON-SITE SEWAGE DISPOSAL SYSTEM HOWARD COUNTY HEALTH DEPARTMENT BUREAU OF ENVIRONMENTAL HEALTH

05-364795

Zepp Plumbing

IS PERMITTED TO INSTALL ☐ ALTER ☒

ADDRESS: 12447 RT 108 Clarksville md 21029 PHONE NUMBER: 410 531-6712

SUBDIVISION: Tax Map 46, Parcel 226?

LOT NUMBER: _____

ADDRESS: 11292 Scaggsville Road

PROPERTY OWNER: McMahon

SEPTIC TANK CAPACITY (GALLONS): 1000

PUMP CHAMBER CAPACITY (GALLONS): N/A

NUMBER OF BEDROOMS: 3

SQUARE FEET PER BEDROOM: 180 N/A

LINEAR FEET OF TRENCH REQUIRED: 135 N/A

TRENCHES:	Trench to be _____ feet wide. Inlet _____ feet below original grade. Bottom maximum depth _____ feet below original grade. Effective area begins at _____ feet below original grade. _____ feet of stone below distribution pipe.
LOCATION:	Replace collapsed septic tank with concrete tank. Excavate test hole in vicinity of drywell to confirm soils.
PURPOSE:	Existing septic tank has collapsed. Property was recently granted Emergency Inclusion into the Metro District due to dry water well. Sealing of water well expected in near future. SEWER NOT AVAIL.

PLANS APPROVED: MER

DATE: 3/20/03

NOTE: PERMIT VOID AFTER 2 YEARS

NOTE: CONTRACTOR RESPONSIBLE FOR SCHEDULING A PRE-CONSTRUCTION INSPECTION FOR ALL INSTALLATIONS

NOTE: WATERTIGHT SEPTIC TANKS REQUIRED

NOTE: ALL PARTS OF SEPTIC SYSTEM SHALL BE 100 FEET FROM ANY WATER WELL

NOTE: MANHOLE RISERS REQUIRED ON ALL SEPTIC TANKS AND PUMP CHAMBERS

**NEITHER THE HOWARD COUNTY COUNCIL NOR THE HEALTH DEPARTMENT IS
RESPONSIBLE FOR THE SUCCESSFUL OPERATION OF ANY SYSTEM
PERMITTEE RESPONSIBLE FOR OBTAINING FINAL APPROVAL ON THIS PERMIT
CALL 410-313-2640 FOR INSPECTION OF SEPTIC SYSTEM**

4518589

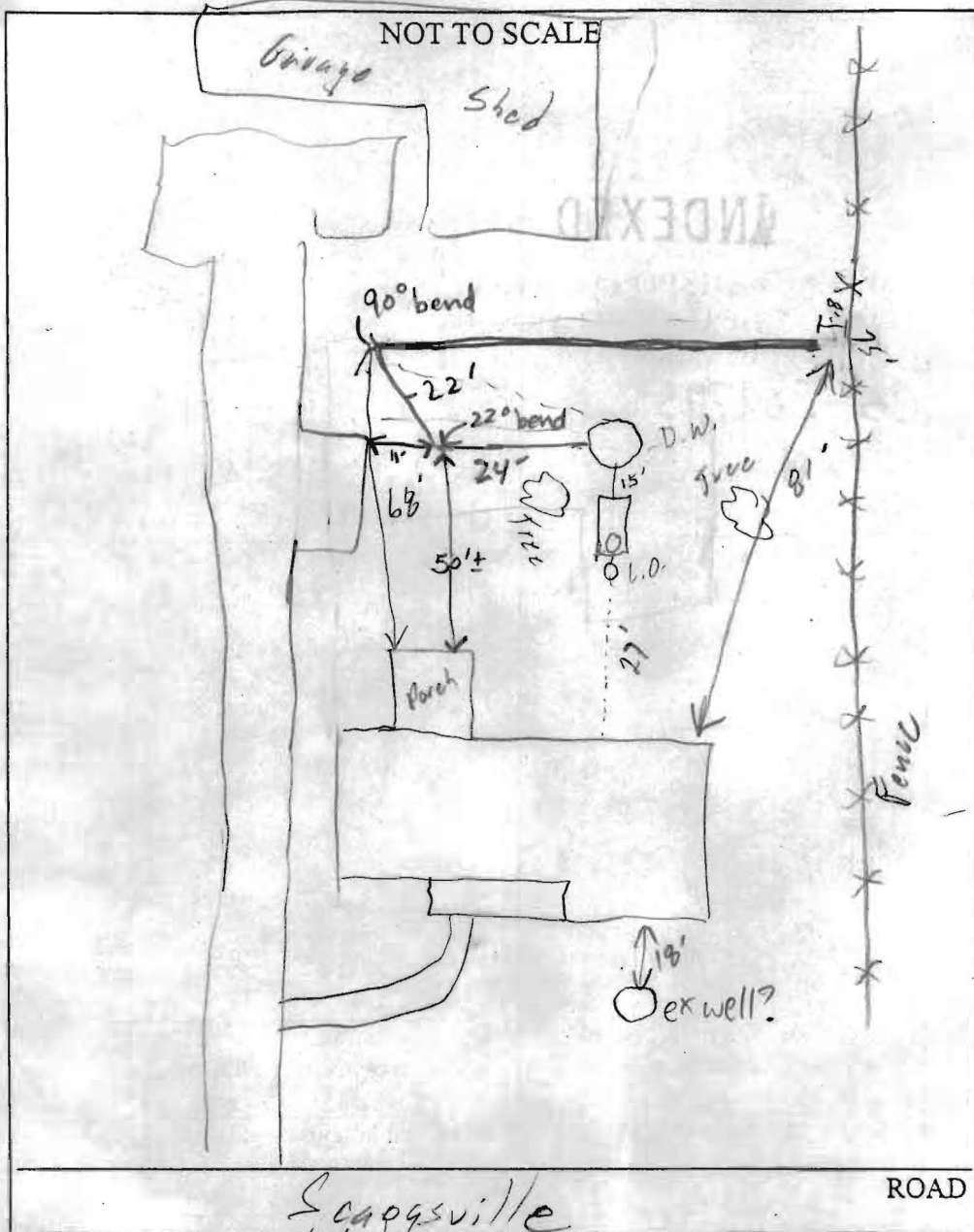

TRENCH/DRAINFIELD DATA		
WIDTH	INLET	BOTTOM
3'	3'	8'
NUMBER OF TRENCHES		
1		
TOTAL LENGTH		
75'		
ABSORPTION AREA		
375 sq ft		
DISTRIBUTION BOX LEVEL		
N/A		
DISTRIBUTION BOX BAFFLE		
✓		
DISTRIBUTION BOX PORT		
✓		

SEPTIC TANK DATA		
SEPTIC TANK 1 LEVEL		
Load bearing lit	CAPACITY	1000 GAL
	SEAM LOC	Top
	TANK LID DEPTH	5'
	BAFFLES	✓
	BAFFLE FILTER	—
	MANHOLE LOC	Front
	6" PORT LOC	—
WATERTIGHT TEST		
SEPTIC TANK 2 LEVEL		
	CAPACITY	— GAL
	SEAM LOC	—
	TANK LID DEPTH	—
	BAFFLES	N/A
	BAFFLE FILTER	—
	MANHOLE LOC	—
	6" PORT LOC	—
WATERTIGHT TEST		

PRE-CONSTRUCTION

INSTALLATION

on 3/3/03. Apparently no one showed up for repair inst. to originally to be a tank replacement. When they dug up tank they notice D.W. was failing. Apparently there was some miscommunication & no one else has been out until today. Tank replace & contr. installed a 75' trench (SD) 4/4/03 Connected drywell to trench; 4/4/03 Connected drywell to trench. OK TO COVER 68' from Porch to trench, 11' from ^{end of} line out of dry well to driveway (KN)

FINAL INSPECTOR

Raele Noonan

DATE OF APPROVAL

4/4/03

PETITION
TO INCORPORATE A SINGLE PARCEL OF LAND
INTO THE METROPOLITAN DISTRICT OF
HOWARD COUNTY, MARYLAND

TO: THE DIRECTOR OF PUBLIC WORKS

The undersigned owners of land in Howard County under the provisions of Section 18.101 of the Howard County Code, do hereby petition to have the following described parcel of land incorporated into the Metropolitan District of Howard County.

NAME OF PROPERTY OWNER(S): SHEILA S HUME
JOSEPH P McMAHON Contract Purchaser

ADDRESS OF PROPERTY: 11292 Scaggsville Road
Fulton, MD

BEING that parcel of land located in the 05 Election District as shown on Tax Map No. 46, Parcel No. 226, Lot No. — consisting of 1 Acres/Square Feet and acquired by Deed dated —, recorded among the Land Records of Howard County in Liber 4642, Folio 651.

WHEREAS, this Petition contains the request relative only to the subject property, whereby the property owners understand that pursuant to the Howard County Code, if the petition is granted, then the aforesaid property shall become subject to all applicable water and sewer charges and fees assessed by the County Council of Howard County for the Metropolitan District, including regular and supplemental ad valorem charges where applicable, and they do hereby petition the Director of Public Works of Howard County to incorporate said parcel of land into the Howard County Metropolitan District pursuant to the provisions of Section 18.101 of the Howard County Code.

WITNESS the Hand and Seal of the Property Owners and/or Petitioners this 27TH day of JANUARY, 2003.

Property Owner/Petitioner:

SHEILA S HUME c/o JOSEPH P. McMAHON

Name (Type or Print)

8354 CHERRY LANE

Mailing Address LAUREL, MARYLAND 20707

301 840-1309

Phone Number

Signature

Name (Type or Print)

Mailing Address

Phone Number

Signature

Contract Purchaser/Petitioner:

Witness

Witness

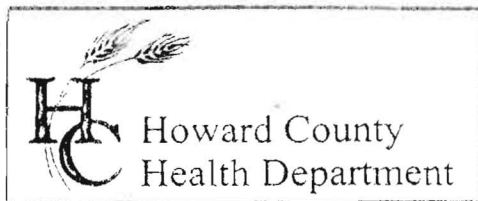

3525 H Ellicott Mills Drive, Ellicott City, MD 21043
(410) 313-2640 Fax (410) 313-2648
TDD (410) 313-2323 Toll Free 1-866-313-6300
website: www.hchealth.org

Penny E. Borenstein, M.D., M.P.H., Health Officer

January 29, 2003

MEMORANDUM

TO: Charlotte Dryden
Division of Real Estate Services

FROM: Mark Rifkin *MR*
Well and Septic Program

RE: Property of Sheila Hume
11292 Scaggsville Road
Tax Map 46, Parcel 226

The Howard County Health Department recommends emergency inclusion of the referenced property into the Metropolitan Service District.

An inspection conducted January 28, 2003 revealed the well is an older style pit well of unknown depth. The tenant reports the well pump recently failed, and the well water tested positive for coliform bacteria. Due to the nature of the well's construction, disinfection for potable needs cannot be reliably performed to provide a potable supply.

Provision of an alternate water supply should be completed as soon as possible.

Proper abandonment (filling and sealing) of the existing well should be completed by a licensed well driller within thirty days after public water connection. The well driller's documentation of said abandonment should be filed with this office immediately thereafter.

MR
cc: Zepp Plumbing
File