

1236

6552

(THIS NUMBER IS TO BE PUNCHED IN COLS. 3-6 ON ALL CARDS)

SEQUENCE NO.  
(MDE USE ONLY)

STATE OF MARYLAND  
WELL COMPLETION REPORT  
FILL IN THIS FORM COMPLETELY  
PLEASE TYPE

THIS REPORT MUST BE SUBMITTED WITHIN  
45 DAYS AFTER WELL IS COMPLETED.

COUNTY  
NUMBER

13

ST/CO USE ONLY  
DATE Received

06 18 03

DATE WELL COMPLETED

06 12 03

Depth of Well

505

(TO NEAREST FOOT)

PERMIT NO.  
FROM "PERMIT TO DRILL WELL"

HO - 94 - 3684

OWNER

Carroll

STREET OR RFD

14771 River Mill Road

SUBDIVISION

D/A

SECTION

Parcel 263

TOWN

West Friendship

LOT

WELL LOG

Not required for driven wells

STATE THE KIND OF FORMATIONS PENETRATED, THEIR  
COLOR, DEPTH, THICKNESS AND IF WATER BEARING

DESCRIPTION (Use additional sheets if needed)	FEET		check if water bearing
	FROM	TO	
Dirt	0	1	
Clay/Br. Schist	1	4	
Soft Br. Schist	4	23	
Soft Br. Sandstone	23	37	X
Hard Blue Sandstone	37	102	
Blue/Br. Schist	102	103	X
Hard Blue Schist	103	109	
Hard Blue Schist/ Blue Sandstone	109	147	
Hard Blue Schist	147	178	
Opening	178	179	X
Hard Blue Schist/ Blue Sandstone	179	238	
Hard Blue Schist	238	245	
Hard Blk./Blue Schist	245	299	
Hard Blue Schist/ Blue Sandstone	299	368	
Hard Blue Schist	368	451	
Hard Blue Schist/ Blue Sandstone	451	497	
Hard Blue Schist	497	505	

GROUTING RECORD

WELL HAS BEEN GROUTED  
(Circle Appropriate Box)

yes Y no N

TYPE OF GROUTING MATERIAL (Circle one)

CEMENT CM BENTONITE CLAY BC

NO. OF BAGS 33 NO. OF POUNDS 3102

GALLONS OF WATER 198

DEPTH OF GROUT SEAL (to nearest foot)

from 0 ft. to 39 ft.

(enter 0 if from surface)

CASING RECORD

casing types insert appropriate code below

STEEL ST CONCRETE CO

PLASTIC PL OTHER OT

MAIN CASING TYPE

Nominal diameter top (main) casing (nearest inch) 6

Total depth of main casing (nearest foot) 44

OTHER CASING (if used)

depth (feet) from to

SCREEN RECORD

screen type or open hole

insert appropriate code below

STEEL ST BRASS BR OPEN HOLE HO

BRONZE PL PLASTIC PL OTHER OT

DEPTH (nearest ft.)

44 505

NUMBER OF UNSUCCESSFUL WELLS: 0

WELL HYDROFRACTURED Y N

CIRCLE APPROPRIATE LETTER

A A WELL WAS ABANDONED AND SEALED WHEN THIS WELL WAS COMPLETED

E ELECTRIC LOG OBTAINED

P TEST WELL CONVERTED TO PRODUCTION WELL

I HEREBY CERTIFY THAT THIS WELL HAS BEEN CONSTRUCTED IN ACCORDANCE WITH COMAR 26.04.04 "WELL CONSTRUCTION" AND IN CONFORMANCE WITH ALL CONDITIONS STATED IN THE ABOVE CAPTIONED PERMIT, AND THAT THE INFORMATION PRESENTED HEREIN IS ACCURATE AND COMPLETE TO THE BEST OF MY KNOWLEDGE.

DRILLERS LIC. NO. M D 296

DRILLERS SIGNATURE

LIC. NO. J W D 334

SITE SUPERVISOR (sign. of driller or journeyman responsible for sitework if different from permittee)

GRAVEL PACK IF WELL DRILLED WAS FLOWING WELL INSERT F IN BOX 68

MDE USE ONLY (NOT TO BE FILLED IN BY DRILLER)

T (E.R.O.S.) W Q

70 72 74 75 76

TELESCOPE CASING LOG INDICATOR OTHER DATA

PUMPING TEST

HOURS PUMPED (nearest hour) 6

PUMPING RATE (gal. per min.) 2

METHOD USED TO MEASURE PUMPING RATE submersible

WATER LEVEL (distance from land surface)

BEFORE PUMPING 31 ft.

WHEN PUMPING 332 ft.

TYPE OF PUMP USED (for test)

A air P piston T turbine

C centrifugal R rotary O other (describe below)

J jet S submersible

PUMP INSTALLED

DRILLER INSTALLED PUMP YES NO

IF DRILLER INSTALLS PUMP, THIS SECTION MUST BE COMPLETED FOR ALL WELLS.

TYPE OF PUMP INSTALLED PLACE (A,C,J,P,R,S,T,O) IN BOX 29.

CAPACITY: GALLONS PER MINUTE (to nearest gallon) 31 35

PUMP HORSE POWER 37 41

PUMP COLUMN LENGTH (nearest ft.) 43 47

CASING HEIGHT (circle appropriate box and enter casing height)

+ above - below

LAND SURFACE 2 (nearest foot)

LOCATION OF WELL ON LOT

SHOW PERMANENT STRUCTURE SUCH AS BUILDING, SEPTIC TANKS, AND /OR LANDMARKS AND INDICATE NOT LESS THAN TWO DISTANCES (MEASUREMENTS TO WELL)

River Mill Road

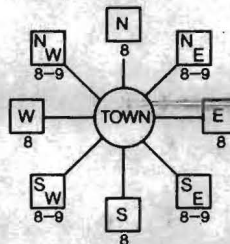
B 1 1 2 3 4 5 6 <b>6239</b>	SEQUENCE NO. (MDE USE ONLY)  518029	<b>STATE OF MARYLAND</b> <b>APPLICATION FOR PERMIT TO DRILL WELL</b> please type	STATE PERMIT NUMBER <b>HO-94-3684</b> fill in this form completely
Date Received (APA) <b>12 17 03</b> 8 MM DD YY 13 <b>OWNER INFORMATION</b> CARROLL JOE 15 Last Name Owner First Name 34 14131 ROVER MILL RD. 36 Street or RFD 55 WEST FRIENDSHIP MD. 21794 57 Town 70 State 72 Zip 76		B 3 <b>HOWARD</b> 8 COUNTY 21 23 SUBDIVISION SECTION <b>N/A</b> 44 46 LOT <b>N/A</b> 48 50 52 NEAREST TOWN <b>WEST FRIENDSHIP</b> 71 MILES FROM TOWN (enter 0 if in town) <b>3</b> M I 73 76 77 78	
<b>DRILLER INFORMATION</b> RONALD KYKER M W D 296 76 Driller's Name License No. 81 WESTMINSTER WELL DRILL INC Firm Name P.O. BOX 861 WESTMINSTER MD. 21157 Address Ronald Kyker DEC 9 02 Signature Date		B 4 1 2 DIRECTION OF WELL FROM TOWN (CIRCLE BOX)  11 30 NEAR WHAT ROAD ON WHICH SIDE OF ROAD (CIRCLE APPROPRIATE BOX) NORTH WEST EAST SOUTH 34 150 37 DISTANCE FROM ROAD ENTER FT OR MI 38 39 TAX MAP: 14 BLK: 12 PARCEL 97	
B 2 <b>WELL INFORMATION</b> APPROX. PUMPING RATE (GAL. PER MIN.) 8 500 12 AVERAGE DAILY QUANTITY NEEDED (GAL. PER DAY) 14 20		NOT TO BE FILLED IN BY DRILLER HEALTH DEPARTMENT APPROVAL COUNTY NAME <b>Howard</b> 13 COUNTY NO. STATE SIGNATURE _____ INSERT S → DATE ISSUED <b>4/30/03</b> <b>Kacie Norman</b> <b>4/30/04</b> 43 MM DD YY 48 CO SIGNATURE EXP. DATE NORTH GRID <b>535</b> 0 0 0 EAST GRID <b>800</b> 0 0 0 50 55 57 63	
<b>USE FOR WATER</b> (CIRCLE APPROPRIATE BOX) <input checked="" type="checkbox"/> DOMESTIC POTABLE SUPPLY & RESIDENTIAL IRRIGATION <input type="checkbox"/> FARMING (LIVESTOCK WATERING & AGRICULTURAL IRRIGATION) <input type="checkbox"/> INDUSTRIAL, COMMERCIAL, DEWATERING <input type="checkbox"/> PUBLIC WATER SUPPLY WELL <input type="checkbox"/> TEST, OBSERVATION, MONITORING <input type="checkbox"/> GEO-THERMAL		SHOW MAJOR FEATURES OF BOX & LOCATE WELL WITH AN X SOURCES OF DRILLING WATER 1. CITY 2. 3. WRITE THE BOX NUMBER FROM THE MAP HERE E <b>790</b> <b>800</b> N <b>535</b> 000 000	
APPROXIMATE DEPTH OF WELL <b>300</b> FEET 24 28 APPROXIMATE DIAMETER OF WELL <b>6</b> INCH <b>METHOD OF DRILLING</b> (circle one) BORED (or Augered) JETTED Jetted & DRIVEN 30 AIR-ROtary AIR-PERcussion ROTARY (Hydraulic Rotary) 37 CABLE REVerse-ROtary DRive-POINT other		DRAW A SKETCH BELOW SHOWING LOCATION OF WELL IN RELATION TO NEARBY TOWNS AND ROADS AND GIVE DISTANCE FROM WELL TO NEAREST ROAD JUNCTION N 150 X well Rover Mill Rd	
<b>REPLACEMENT OR DEEPEENED WELLS</b> (CIRCLE APPROPRIATE BOX) <input checked="" type="checkbox"/> THIS WELL WILL NOT REPLACE AN EXISTING WELL <input type="checkbox"/> THIS WELL WILL REPLACE A WELL THAT WILL BE ABANDONED AND SEALED 39 <input type="checkbox"/> THIS WELL WILL REPLACE A WELL THAT WILL BE USED AS A STANDBY-CONTACT LOCAL APPROVING AUTHORITY FOR POLICY ON STANDBY WELLS <input type="checkbox"/> THIS WELL WILL DEEPEEN AN EXISTING WELL PERMIT NUMBER OF WELL TO BE REPLACED OR DEEPEENED (IF AVAILABLE) 41 _____ 52		Not to be filled in by driller (MDE OR COUNTY USE ONLY) APPROP. PERMIT NUMBER _____ G _____ PERMIT No. <b>HO-94-3684</b> 70 71 72 73 74 75 76 77 78 79	
SPECIAL CONDITIONS NOTE - APPROVING AUTHORITIES SHOULD USE SEPARATE SHEET IF NEEDED			



FIELD DATA SHEET  
HOWARD COUNTY WELL YIELD TEST

Well Permit No. HO - 94-3684  
Location of property (road) 14111 River Mill Road  
Subdivision \_\_\_\_\_ Lot \_\_\_\_\_ Block \_\_\_\_\_ Plat \_\_\_\_\_ Sec. \_\_\_\_\_  
Well Driller Ron Kyker Owner S. Carroll  
Parcel 263  
Depth of well 505 feet  
Distance of measuring point (M.P.) above ground 2 feet  
Static water level (S.W.L.) below M.P. 31 feet

I. High rate pumping -- reservoir drawdown

Time pump started 7:45 Pumping rate 12GPM  
Total time 1 1/2 hr to reach pumping water level 356 ft. below M.P.

II. Recovery pump test data - observations to be recorded every 15 minutes

TIME (in 15 minute intervals)	WATER LEVEL below M.P.	PUMPING RATE time to fill 5 gallon bucket	FLOW METER READING (if used)	CALCULATED FLOW (gallons per minute)
7:45	31'	5 sec.		12
8:00	102'	5 sec.		12
8:15	140'	6 sec.		10
8:30	228'	7 sec.		8.5
8:45	271'	8 sec.		7.5
9:00	311'	10 sec.		6
9:15	356'	30 sec.		2
9:30	355'	30 sec.		2
9:45	354'	30 sec.		2
10:00	353'	30 sec.		2
10:15	352'	30 sec.		2
10:30	351'	30 sec.		2
10:45	350'	30 sec.		2
11:00	349'	30 sec.		2
11:15	348'	30 sec.		2
11:30	347'	30 sec.		2
11:45	346'	30 sec.		2
12:00	345'	30 sec.		2
12:15	344'	30 sec.		2
12:30	343'	30 sec.		2
12:45	342'	30 sec.		2
1:00	341'	30 sec.		2
1:15	340'	30 sec.		2

Date: 06/12/2003

Review

FIELD DATA SHEET  
HYDROGEOLOGIC AREA (3) WELL YIELD TEST

Maryland Well Permit No. HO-94-3684 Election District                     

Location of Property (road) 14111 Rower Mill Road

Subdivision \_\_\_\_\_ Lot \_\_\_\_\_ Block \_\_\_\_\_ Plat \_\_\_\_\_ Sec. \_\_\_\_\_

Well Driller Dana Kyker Jr. III Owner Joe Carroll

Depth of Well 505 feet

Distance of Measuring Point (M.P.) above ground 2 feet

Static Water Level (S.W.L.) below M.P. 31 feet

### I. High Rate Pumping -- reservoir drawdown

Time pump started 7:45 Pumping rate 12GPM

Total time 1 1/2 hr to reach pumping water level 356 ft. below M.P.

II. Recovery pump test data - observations to be recorded every 15 minutes.

[illegible]

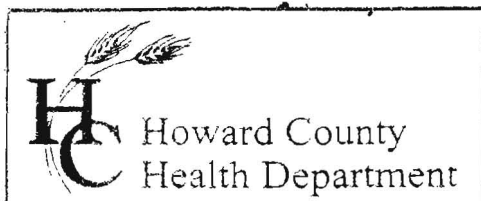

3525 H Ellicott Mills Drive, Ellicott City, MD 21043  
(410) 313-2640 Fax (410) 313-2648  
TDD (410) 313-2323 Toll Free 1-866-313-6300  
website: [www.hchealth.org](http://www.hchealth.org)

---

Penny E. Borenstein, M.D., M.P.H., Health Officer

July 3, 2003

Ms. Carroll  
14111 Rover Mill Road  
West Friendship, MD 21794

RE: **New Well Testing**  
14111 Rover Mill Road  
Well Permit # HO-94-3684

Dear Ms. Carroll:

According to our records your replacement well has been connected to the dwelling and an inspection has been conducted and approved, this office is also requesting that you contact the Community Services Program at (410) 313-1773 to schedule an initial water sampling for the referenced well, as required by the Maryland Well Construction Regulation (COMAR 26.04.04). There is currently no charge for the sampling and it to your benefit to have it tested.

It is preferred that the sample be collected from the primary indoor drinking tap, but if suitable scheduling is not possible, the sample may be taken from an outside tap to complete your sampling obligation. However, the potential for unsuccessful sample results increases when samples are collected from taps exposed to the outside environment.

**Failure to confirm the potability of this well water supply by completion of documentation or water sampling requirements could result in enforcement action.**

If you have any questions, or would like to discuss these matters further please call me at (410) 313-1771. Thank you for your attention to these important matters.

Respectfully,

Kacie Noonan  
Environmental Sanitarian  
Well and Septic Program

cc: Community Services Program  
File

**HOWARD COUNTY HEALTH DEPARTMENT  
BUREAU OF ENVIRONMENTAL HEALTH  
WATER AND SEWERAGE PROGRAM  
TEL: (410)313-2640 FAX: (410)313-2648**

**Information Form for the Installation of the Well Pump, Pitless Adapter, and Supply Piping**

**NOTE:** The installer is responsible for requesting an inspection prior to 9 am on the day of the desired inspection. No work is to be covered until approved by the Health Department. All installations must comply with the National Standard Plumbing Code (NSPC, as amended locally) and COMAR 26.04.04 (MD Well Construction Regulations). Submission of a complete form is required prior to Use and Occupancy approval.

Company Name: RL Feezer Co. Inc. Telephone #: 410-781-4655  
Address: 6321 Barnett Ave  
Sykesville, Md. 21784

(Must circle one) Licensed Plumber Licensed Well Driller Licensed Well Pump Installer  
License # and name of individual responsible for the field installation:

Name (Print): Robert L. Feezer License #: 2122

\*A licensed individual must perform the actual installation. Apprentices must be under the direct supervision of a licensed journeyman or master plumber, pump installer or well driller. Licenses may be subjected to field verification.

Name of Property Owner: Mr. Joseph Carroll Telephone #: 410-442-5592  
Subdivision: \_\_\_\_\_ Lot #: \_\_\_\_\_ Well Tag #: HO-94-3684  
Site Address: 14131 Rover Mill Rd.

West Friendship, Md. 21794

**Submersible Pump Data**

Make: Sumite  
Model #: 5SP4E03HL  
Pump Capacity: 5 GPM  
Well Yield: 2.5 GPM

**Pitless Adapter**

Make: Campbell  
Model #: PA800  
Depth: 42 (36" min)  
NSF approved: ✓

**Well Cap and Electric Conduit**

Two piece watertight cap: ✓  
Screened, vented well cap: ✓  
Cap secured to casing: ✓  
Conduit min 18" B.G.: ✓  
Conduit secured to well cap: ✓

Depth of well encountered at time of pump installation: 505 (feet)  
If pump capacity exceeds well yield, a low water cut off switch is required by NSPC 1990 Section 17.8.4

Torque arrestors or Cable guards are required - Must circle one

Safety rope if used, attached to inside of well casing with eye bolt ✓

**Piping to house**

Type: 1" POLY  
PSI: 160 (160 psi min)  
Depth of supply line: ✓ (36" min)

**House Connection**

PVC sleeved to undisturbed soil at wall penetration: N/A  
Approximate length of sleeve: \_\_\_\_\_  
Sleeve caulked and sealed properly: ✓

The water supply line is required to be at least ten feet from the septic tank, pump chamber, sewage piping, distribution box, drainfields, and sewage reserve area. If this cannot be accomplished, contact this office for approval prior to installation.

Signature of company representative responsible for installation

6/17/03  
date

**For Health Department Use Only - Not to be completed by Installer**

Date Insp. Requested: 6/18/2003 AFTER 12 NOON Date Insp. Approved: 6/18/03 (50)

Inspection Data: Pitless adapter and water supply line at least 36" below grade

Two piece cap installed and attached to casing securely

Elec. conduit extends at least 18" below grade/attached to cap properly

Safety rope installed inside of well casing

Correct well tag attached properly and casing 8" above finished grade

Water supply line sleeved adequately at house connection

Adequate grout observed below pitless adapter

Conn. to ex. line

Water sample  
letter  
sent  
on 7/3/03 (KN)

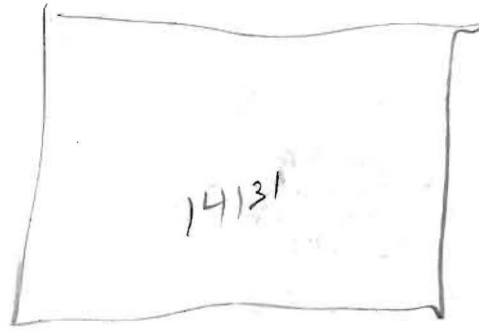

110-94-3684

Ex will line



House A

Ron, Call our office when you schedule to meet Mr. Carroll,

SITE INSPECTION SHEET

OWNER: S. Carroll c/o J. Carroll PHONE #: 301-512-0825 Cell

ADDRESS: 14111 Rover Mill Road CONTRACTOR: Ron Kyker

WELL TAG #: New-140-94-3684

SUBDIVISION: \_\_\_\_\_ LOT: \_\_\_\_\_ COUNTY #: 13

PROPOSAL: 4/29/03 Locate new well for existing residence (currently sharing well with 14131 Rover Mill Rd)

LOCATION DIAGRAM

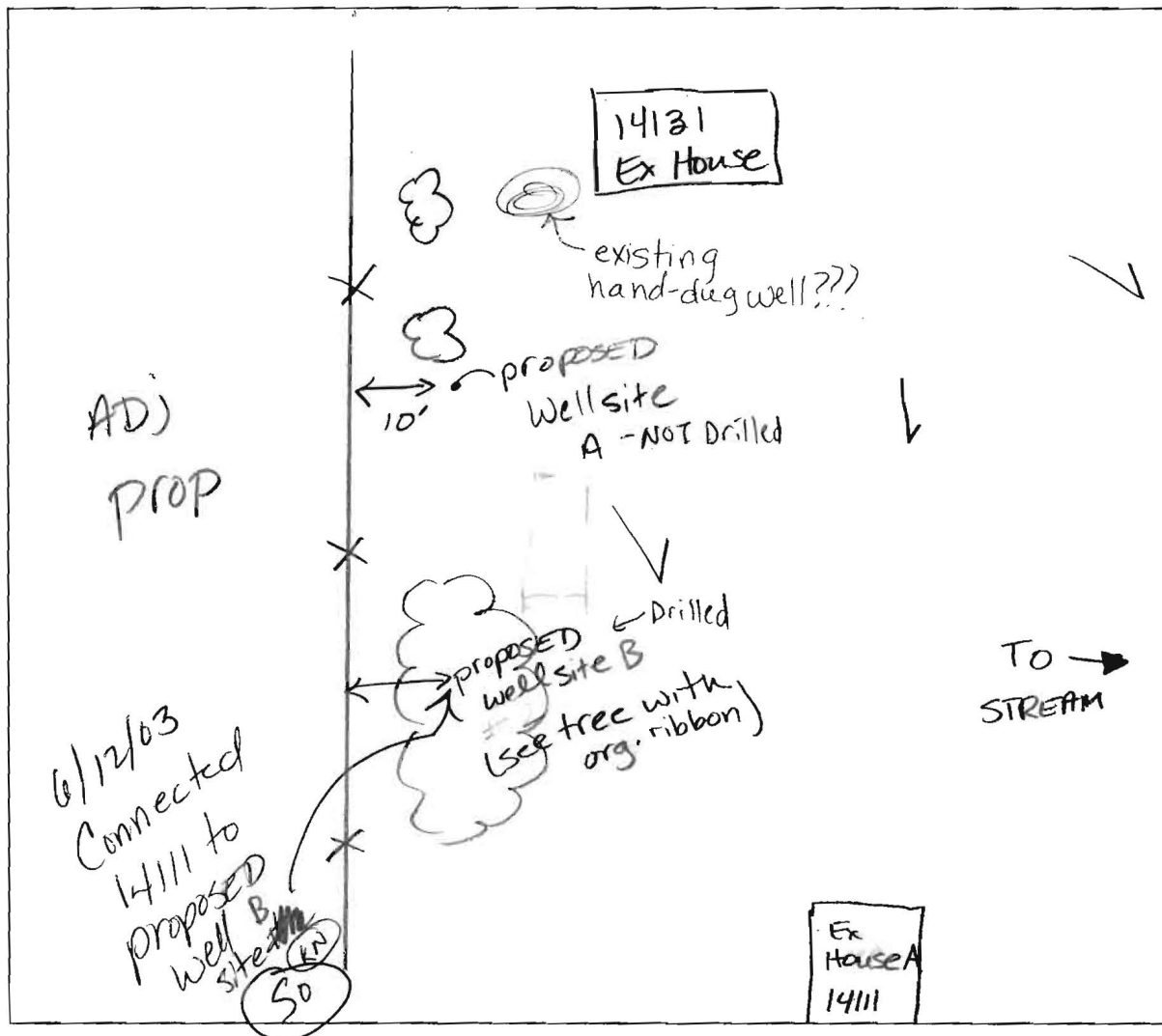

COMMENTS: 4/29/03 Barry Glatfelty reviewed site, locating best, safe well site upslope of potential repair for house #14111. Mr. Carroll is aware of both options and will discuss with

DATE: the driller 4/29/03 INSPECTOR: Kace Noonan