

12/2/03 - 10 AM

PUB. SEWER STATUS VERIFIED BY \_\_\_\_\_

ISSUE DATE: 11/19/03

APPROVAL DATE: 1/15/04

**PERMIT  
INDEXED**

P 519668

A REPAIR

**ON-SITE SEWAGE DISPOSAL SYSTEM  
HOWARD COUNTY HEALTH DEPARTMENT  
BUREAU OF ENVIRONMENTAL HEALTH**

04-328523

Jack Fyock Septic Service, Inc

IS PERMITTED TO INSTALL ☐ ALTER ☒

ADDRESS: PO Box 89, Glenelg, MD 21737

PHONE NUMBER: 410-988-9270

SUBDIVISION: Warfield Estates

LOT NUMBER: Lot 6 Block B Sect 3

ADDRESS: 3424 Shady Lane

PROPERTY OWNER: Glenn Quader

SEPTIC TANK CAPACITY (GALLONS):

1 x 1000

PUMP CHAMBER CAPACITY (GALLONS):

N/A

NUMBER OF BEDROOMS:

4

SQUARE FEET PER BEDROOM:

2104

LINEAR FEET OF TRENCH REQUIRED:

160'

TRENCHES:	Trench to be 3 feet wide. Inlet 3 feet below original grade. Bottom maximum depth 5 feet below original grade. Effective area begins at 3 feet below original grade. 2 feet of stone below distribution pipe.
LOCATION:	(2) 80' trenches 10' CTC on contour
PURPOSE:	Septic system is failing. Call for inspection when the ground has been opened so sanitarian can recommend repair.

PLANS APPROVED:

*[Signature]*

DATE:

12/2/03

NOTE: PERMIT VOID AFTER 2 YEARS

NOTE: CONTRACTOR RESPONSIBLE FOR SCHEDULING A PRE-CONSTRUCTION INSPECTION FOR ALL INSTALLATIONS

NOTE: WATERTIGHT SEPTIC TANKS REQUIRED

NOTE: ALL PARTS OF SEPTIC SYSTEM SHALL BE 100 FEET FROM ANY WATER WELL

NOTE: MANHOLE RISERS REQUIRED ON ALL SEPTIC TANKS AND PUMP CHAMBERS

**NEITHER THE HOWARD COUNTY COUNCIL NOR THE HEALTH DEPARTMENT IS  
RESPONSIBLE FOR THE SUCCESSFUL OPERATION OF ANY SYSTEM  
PERMITTEE RESPONSIBLE FOR OBTAINING FINAL APPROVAL ON THIS PERMIT  
CALL 410-313-2640 FOR INSPECTION OF SEPTIC SYSTEM**

P 519668

NOT TO SCALE

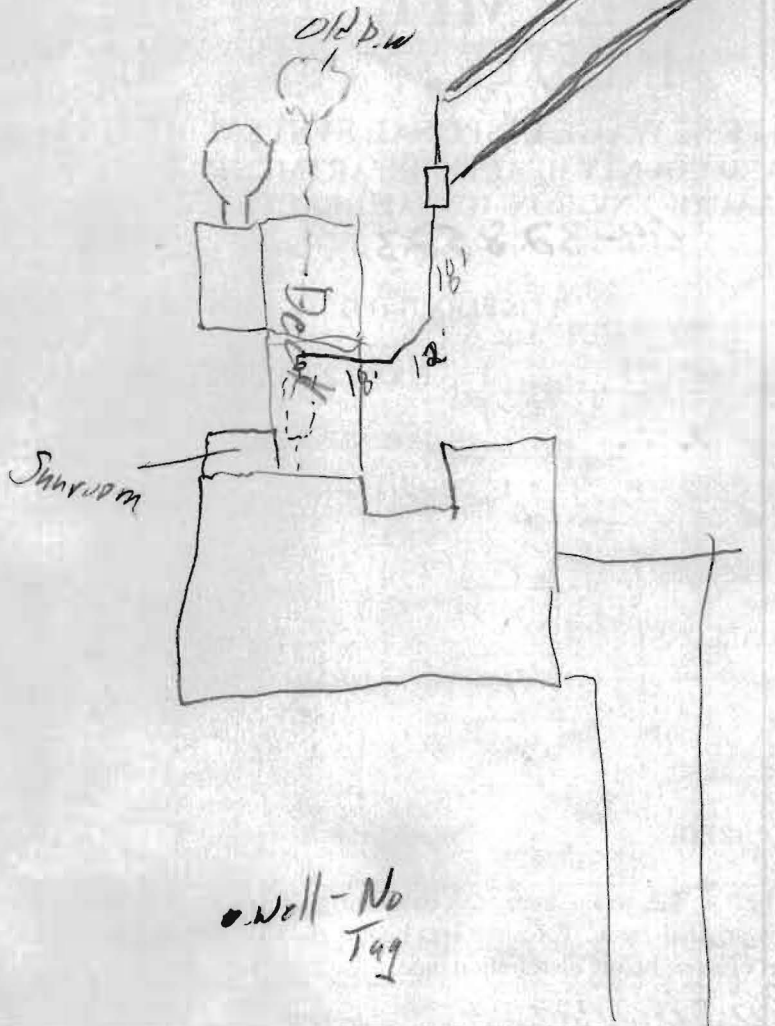

**TRENCH/DRAINFIELD DATA**

WIDTH	INLET	BOTTOM
3'	3'	5'
NUMBER OF TRENCHES		2
TOTAL LENGTH		160'
ABSORPTION AREA		
DISTRIBUTION BOX LEVEL		
DISTRIBUTION BOX BAFFLE		
DISTRIBUTION BOX PORT		

**SEPTIC TANK DATA**

SEPTIC TANK 1 LEVEL	
CAPACITY	EX 1000 GAL
SEAM LOC	
TANK LID DEPTH	
BAFFLES	
BAFFLE FILTER	
MANHOLE LOC	
6" PORT LOC	
WATERTIGHT TEST	
SEPTIC TANK 2 LEVEL	
CAPACITY	GAL
SEAM LOC	
TANK LID DEPTH	
BAFFLES	
BAFFLE FILTER	
MANHOLE LOC	
6" PORT LOC	
WATERTIGHT TEST	

PRE-CONSTRUCTION

INSTALLATION 1/15/04 - OK to cover all work (SD)

FINAL INSPECTOR *[Signature]* DATE OF APPROVAL 1/15/04