

PUB. SEWER STATUS VERIFIED BY _____

ISSUE DATE: 1/9/04

P 520024

APPROVAL DATE: 5/7/04

A REPAIR

PERMIT INDEXED

ON-SITE SEWAGE DISPOSAL SYSTEM
HOWARD COUNTY HEALTH DEPARTMENT
BUREAU OF ENVIRONMENTAL HEALTH

03-281833

Jenkins Brothers

IS PERMITTED TO INSTALL ☐ ALTER ☒

ADDRESS: 7670 Smith's Private Rd., Sykesville PHONE NUMBER: 410-461-9282

SUBDIVISION: Woodmark II LOT NUMBER: 6-B Block B

ADDRESS: 12268 Woodspurge Court PROPERTY OWNER: Paul Casner

SEPTIC TANK CAPACITY (GALLONS): 1000

PUMP CHAMBER CAPACITY (GALLONS): N/A

NUMBER OF BEDROOMS: 3

SQUARE FEET PER BEDROOM: .4 loading rate

LINEAR FEET OF TRENCH REQUIRED: 225

TRENCHES:	Trench to be 3.0 feet wide. Inlet 1.5 feet below original grade. Bottom maximum depth 5.0 feet below original grade. Effective area begins at _____ feet below original grade. _____ feet of stone below distribution pipe.
LOCATION:	Maintain 11.5' center to center, place the flow diverters (levelers) in the distribution box for nesting of the old system.
PURPOSE:	Existing septic system has failed. Call for inspection when ground is opened so sanitarian can recommend repair.

PLANS APPROVED: John A. Boris DATE: 4/30/04

NOTE: PERMIT VOID AFTER 2 YEARS

NOTE: CONTRACTOR RESPONSIBLE FOR SCHEDULING A PRE-CONSTRUCTION INSPECTION FOR ALL INSTALLATIONS

NOTE: WATERTIGHT SEPTIC TANKS REQUIRED

NOTE: ALL PARTS OF SEPTIC SYSTEM SHALL BE 100 FEET FROM ANY WATER WELL

NOTE: MANHOLE RISERS REQUIRED ON ALL SEPTIC TANKS AND PUMP CHAMBERS

**NEITHER THE HOWARD COUNTY COUNCIL OR THE HEALTH DEPARTMENT IS
RESPONSIBLE FOR THE SUCCESSFUL OPERATION OF ANY SYSTEM
PERMITTEE RESPONSIBLE FOR OBTAINING FINAL APPROVAL ON THIS PERMIT
CALL 410-313-2640 FOR INSPECTION OF SEPTIC SYSTEM**

520024

NOT TO SCALE

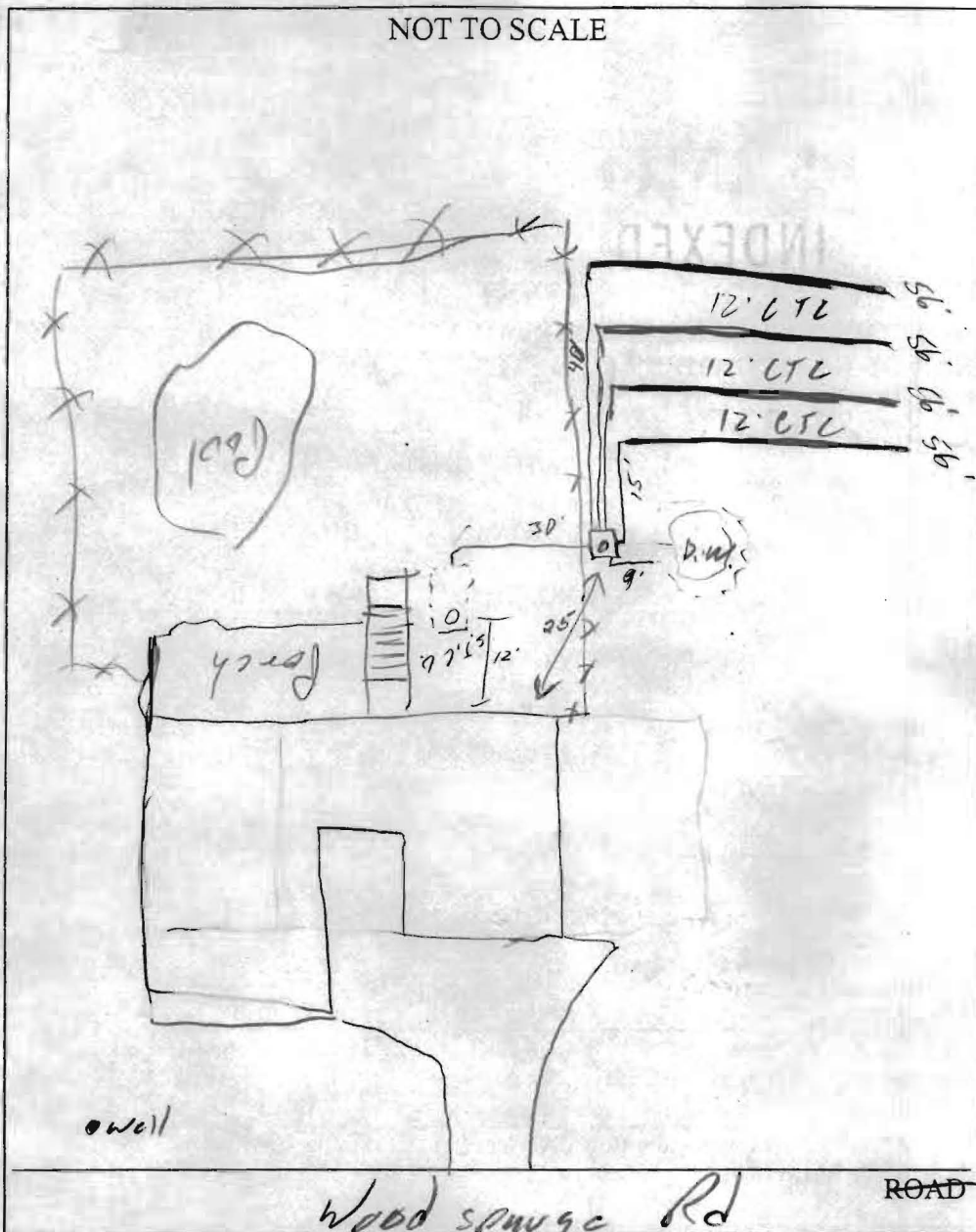

TRENCH/DRAINFIELD DATA		
WIDTH	INLET	BOTTOM
3'	1.5	5'
NUMBER OF TRENCHES	4	
TOTAL LENGTH	224'	
ABSORPTION AREA	6724	
DISTRIBUTION BOX LEVEL	✓	
DISTRIBUTION BOX BAFFLE	✓	
DISTRIBUTION BOX PORT	✓	

SEPTIC TANK DATA

SEPTIC TANK 1 LEVEL	
CAPACITY	_____ GAL
SEAM LOC	_____
TANK LID DEPTH	_____
BAFFLES	_____
BAFFLE FILTER	_____
MANHOLE LOC	_____
6" PORT LOC	_____
WATERTIGHT TEST	_____
SEPTIC TANK 2 LEVEL	
CAPACITY	_____ GAL
SEAM LOC	_____
TANK LID DEPTH	_____
BAFFLES	_____
BAFFLE FILTER	_____
MANHOLE LOC	_____
6" PORT LOC	_____
WATERTIGHT TEST	_____

PRE-CONSTRUCTION 4/30/04 Performed layout due to trees. OK to start work

INSTALLATION 5/7/04 OK to cover all work. Speed loader installed for D.W. turned up (SO)

FINAL INSPECTOR

DATE OF APPROVAL

5/7/04

FILE INQUIRY FORM

11/7/03- Discussion w/ interested parties RE
Addition for this property. Proposed addition
location must be 20' from trenches. As
a result of unorthodox system installation &
limited repair area, addition may not be possible
on right side of house when facing house from
road. Also adjacent well limits new system
relocation. - (SRK)