

LAYOUT 12/5/05 INSP 4 _____
INSP 2 12/7/05 INSP 5 _____
INSP 3 _____ INSP 6 _____

ISSUE DATE: 11/17/2005

P 523674

APPROVAL DATE: 5/3/06

A 520087

PERMIT

TAX ID #05-412838

ON-SITE SEWAGE DISPOSAL SYSTEM HOWARD COUNTY HEALTH DEPARTMENT BUREAU OF ENVIRONMENTAL HEALTH

Fogles Septic Clean, Inc. IS PERMITTED TO INSTALL ☒ ALTER ☐

ADDRESS: 580 Obrecht Road, Sykesville PHONE NUMBER: 410-795-5670

SUBDIVISION: Rutherford LOT NUMBER: 5

ADDRESS: 4525 Rutherford Way PROPERTY OWNER: Navesh Den

SEPTIC TANK CAPACITY (GALLONS): 1500 1250 OUTLET BAFFLE FILTER REQUIRED ☐

PUMP CHAMBER CAPACITY (GALLONS): 1500 1250 COMPARTMENTED TANK REQUIRED ☒

NUMBER OF BEDROOMS: 4

SQUARE FEET PER BEDROOM: 210

LINEAR FEET OF TRENCH REQUIRED: 174 HOUSE SERVED BY PUBLIC WATER ☐

TRENCHES:	Trench to be 3.0 feet wide. Inlet 4.0 feet below original grade. Bottom maximum depth 6.0 feet below original grade. Effective area begins at 4.0 feet below original grade. 2.0 feet of stone below distribution pipe.
LOCATION:	Place the distribution box so you can get 40' trench minimum.
NOTES:	Make sure you are out of the Well radius. (KW)

PLANS APPROVED: Kevin J. Bell Reviewed by: R. Norman 11/17/05 DATE: 9/21/2005

NOTES: PERMIT VOID AFTER 2 YEARS

CONTRACTOR IS RESPONSIBLE FOR SCHEDULING A PRE-CONSTRUCTION INSPECTION FOR ALL INSTALLATIONS
WATERTIGHT SEPTIC TANKS REQUIRED

ALL PARTS OF SEPTIC SYSTEM SHALL BE 100 FEET FROM ANY WATER WELL UNLESS SPECIFICALLY AUTHORIZED
MANHOLE RISERS REQUIRED ON ALL SEPTIC TANKS AND PUMP CHAMBERS UNLESS SPECIFICALLY AUTHORIZED

CONTRACTOR RESPONSIBLE FOR COMPLIANCE WITH APPLICABLE REGULATIONS, GUIDELINES AND THE TERMS OF THIS PERMIT

**NEITHER THE HOWARD COUNTY COUNCIL NOR THE HEALTH DEPARTMENT IS
RESPONSIBLE FOR THE SUCCESSFUL OPERATION OF ANY SYSTEM
PERMITTEE RESPONSIBLE FOR OBTAINING FINAL APPROVAL ON THIS PERMIT
ALL 410-313-1771 FOR INSPECTION OF SEPTIC SYSTEM**

4520087

NOT TO SCALE

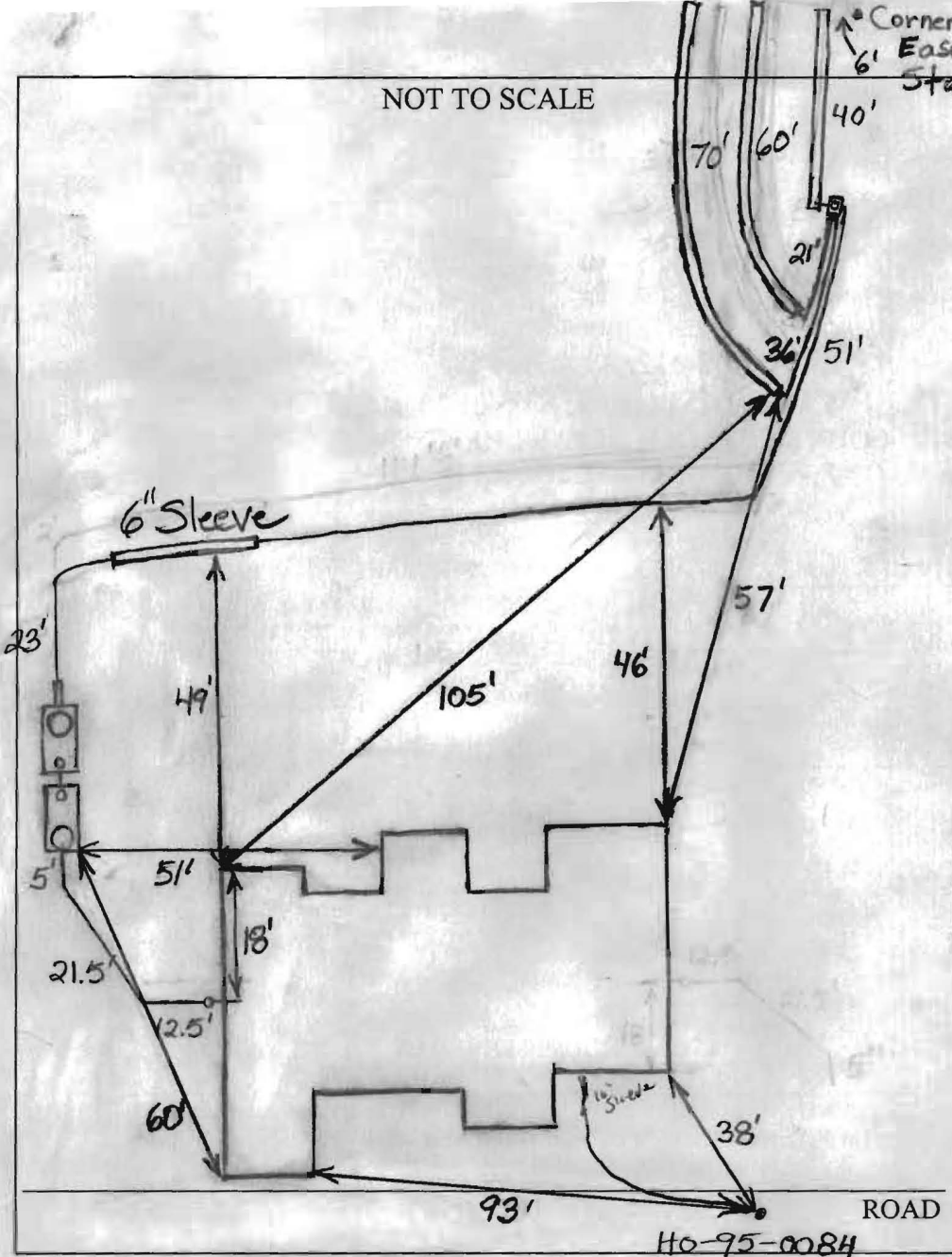

TRENCH/DRAINFIELD DATA

WIDTH	INLET	BOTTOM
3'	5'	7'
NUMBER OF TRENCHES 3		
TOTAL LENGTH 175'		
ABSORPTION AREA 525+Sidewall		
DISTRIBUTION BOX LEVEL Yes		
DISTRIBUTION BOX BAFFLE Elbow		
DISTRIBUTION BOX PORT Yes		

SEPTIC TANK DATA

SEPTIC TANK 1 LEVEL	Yes
CAPACITY	1500 GAL
SEAM LOC	Top
TANK LID DEPTH	1'-3'
BAFFLES	Yes
BAFFLE FILTER	No
MANHOLE LOC	Front
6" PORT LOC	Rear
WATERTIGHT TEST	No
SEPTIC TANK 2 LEVEL	Yes
CAPACITY	1500 GAL
SEAM LOC	Top
TANK LID DEPTH	1'-3'
BAFFLES	Front
BAFFLE FILTER	No
MANHOLE LOC	Rear
6" PORT LOC	Front
WATERTIGHT TEST	No

PRE-CONSTRUCTION 12/5/05 Layout well location on adjacent lot is not as shown

on plan. Septic will be >130' from any point to well. Keep pump line outside

INSTALLATION well radius. (GAC) (Place tanks as per plan maintaining 20' setback)

12/7/05 System finished. Need pump and alarm test for final approval. (BB) 5/3/06 Pump and alarm working. (BB)

FINAL INSPECTOR B. Baker

DATE OF APPROVAL 5/3/06

