

LAYOUT 3/1/04 Am INSP 4 _____
INSP 2 3/23/04 - PM INSP 5 _____
INSP 3 8/30/04 INSP 6 _____

ISSUE DATE: 2/2/2004

APPROVAL DATE: _____

PERMIT

LPD SEPTIC SYSTEM

INDEXED

ON-SITE SEWAGE DISPOSAL SYSTEM HOWARD COUNTY HEALTH DEPARTMENT BUREAU OF ENVIRONMENTAL HEALTH

P 520045

A 519070 UPGRADE

Fogle's Septic Clean _____ IS PERMITTED TO INSTALL ☐ ALTER ☒

ADDRESS: _____ PHONE NUMBER: 410-795-5670

SUBDIVISION _____ LOT TM 16, P 118

ADDRESS: 2480 Thompson Drive PROPERTY OWNER: Walter Kehoe III

SEPTIC TANK CAPACITY (GALLONS): _____ Two-Compartment Tank ☐

Effluent Filter ☐

PUMP CHAMBER CAPACITY (GALLONS): 1500 Two-Compartment Tank ☒

Control Box with elapsed time meter and event counter. High water alarm on a separate circuit & located indoors.
See design plan by Fogle's signed 9/26/03.

LOCATION:	Provide 2"-force main entering SDA from the bottom in the same trench with center-feed manifold. Manifold to be 78" from the right rear lot corner. Run (2) 45' trenches on contour in each direction spaced 7' apart center-to-center. <u>4</u>
NOTES:	Max trench bottom depth is 42" below grade, with 18" of sand mound sand and 6" of 3/4" gravel under 1.5" laterals plus gravel to cover. Lateral length is 43'3" with (13) 5/16" perforations every 41.5". First perf and last perf. are about 1'9" from start and end of lateral. Install turn up at end of lateral furthest from pump. Pump, pressure and alarm test required prior to final approval.

PLANS APPROVED: MER DATE: 1/30/04

NOTES: PERMIT VOID AFTER 2 YEARS
CONTRACTOR IS RESPONSIBLE FOR SCHEDULING A PRE-CONSTRUCTION INSPECTION FOR ALL INSTALLATIONS
WATERTIGHT SEPTIC TANKS REQUIRED
ALL PARTS OF SEPTIC SYSTEM SHALL BE 100 FEET FROM ANY WATER WELL UNLESS SPECIFICALLY AUTHORIZED
MANHOLE RISERS REQUIRED ON ALL SEPTIC TANKS AND PUMP CHAMBERS UNLESS SPECIFICALLY AUTHORIZED
CONTRACTOR RESPONSIBLE FOR COMPLIANCE WITH APPLICABLE REGULATIONS, GUIDELINES AND THE TERMS OF THIS PERMIT

NEITHER THE HOWARD COUNTY COUNCIL NOR THE HEALTH DEPARTMENT IS
RESPONSIBLE FOR THE SUCCESSFUL OPERATION OF ANY SYSTEM
PERMITTEE RESPONSIBLE FOR OBTAINING FINAL APPROVAL ON THIS PERMIT
ALL 410-313-2640 FOR INSPECTION OF SEPTIC SYSTEM

**BUILDING PERMIT SIGNED
AND RETURNED**

9/26/2003 B00141951 POLE BARN/GARAGE

PS 20045

NOT TO SCALE

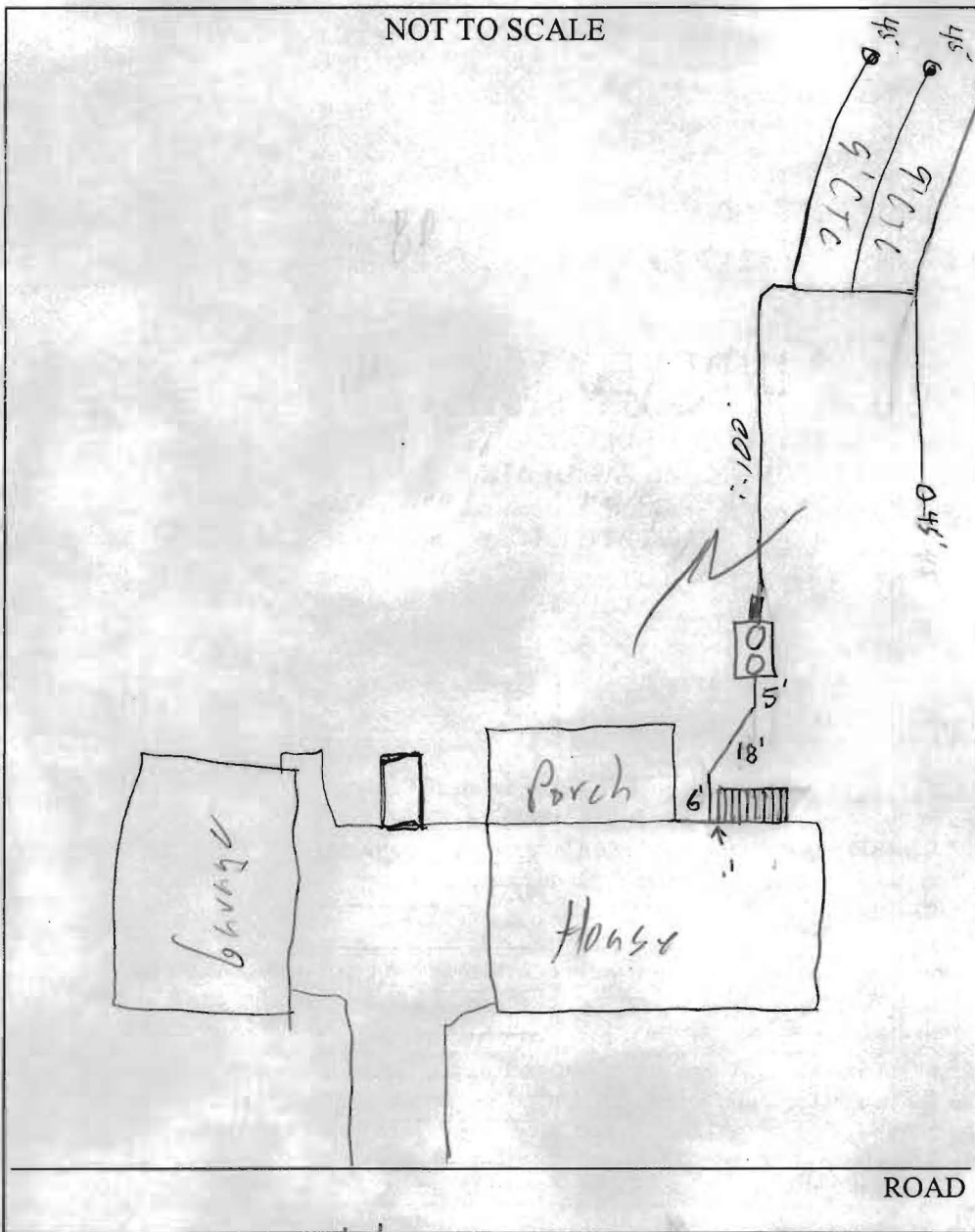

TRENCH/DRAINFIELD DATA		
WIDTH	INLET	BOTTOM
3'	18"	42"
NUMBER OF TRENCHES		4
TOTAL LENGTH		180'
ABSORPTION AREA		1500
DISTRIBUTION BOX LEVEL		N/A
DISTRIBUTION BOX BAFFLE		N/A
DISTRIBUTION BOX PORT		N/A

SEPTIC TANK DATA		
SEPTIC TANK 1 LEVEL	✓	
Comp. CAPACITY	1500	GAL
SEAM LOC	Top	
TANK LID DEPTH	1-1.5'	
BAFFLES	✓	
BAFFLE FILTER		
MANHOLE LOC		
6" PORT LOC		
WATERTIGHT TEST	No	
SEPTIC TANK 2 LEVEL		
CAPACITY		GAL
SEAM LOC		
TANK LID DEPTH		
BAFFLES		
BAFFLE FILTER		
MANHOLE LOC		
6" PORT LOC		
WATERTIGHT TEST		

PRE-CONSTRUCTION 3/1/04 TRENCH LAYOUT COMPLETE; RUN (3) TRENCHES TO REAR, (1) TRENCH TO FRONT TO SAVE TREES (MR)

INSTALLATION 8/23/04 - 1st trench dug (SO)
8/25/04 - All trenches & lateral installed OK to cover in 1/2 of P.M. - installed (SO)

8/26/04 - Tank set, all piping complete. Need alarm box w/ timer & counter & pump test (SO) 8/30/04
Close to 2' of water in all the turn-ups while the pump was running. Alarm working. Event timer and counter working (BB)

FINAL INSPECTOR B. Baker DATE OF APPROVAL 8/30/04