

4/2/04  
PUB. SEWER STATUS VERIFIED BY \_\_\_\_\_

ISSUE DATE: 3/26/04

APPROVAL DATE: 4/21/04

# PERMIT INDEXED

PHA 520120

A UPGRADE

## ON-SITE SEWAGE DISPOSAL SYSTEM HOWARD COUNTY HEALTH DEPARTMENT BUREAU OF ENVIRONMENTAL HEALTH

04-329880

Fyock Septic Service

IS PERMITTED TO

INSTALL ☐

ALTER ☒

ADDRESS: PO Box 89, Glenelg

PHONE NUMBER: 410-988-9270

SUBDIVISION: Warfield Estates

LOT NUMBER: 3

ADDRESS: 3412 Shady Lane

PROPERTY OWNER: David Peterman

SEPTIC TANK CAPACITY (GALLONS):

1250

PUMP CHAMBER CAPACITY (GALLONS):

—

NUMBER OF BEDROOMS:

4 w/ADD'N

SQUARE FEET PER BEDROOM:

210

LINEAR FEET OF TRENCH REQUIRED:

65

TRENCHES:	Trench to be 2 feet wide. Inlet 4.5 feet below original grade. Bottom maximum depth 8.5 feet below original grade. Effective area begins at 4.5 feet below original grade. 4 feet of stone below distribution pipe.
LOCATION:	
PURPOSE:	In support of building permit #B00146538. (Addition includes addition of one bedroom.) Call for inspection when ground is opened so sanitarian can recommend repair.

PLANS APPROVED: \_\_\_\_\_

DATE: \_\_\_\_\_

NOTE: PERMIT VOID AFTER 2 YEARS

NOTE: CONTRACTOR RESPONSIBLE FOR SCHEDULING A PRE-CONSTRUCTION INSPECTION FOR ALL INSTALLATIONS

NOTE: WATERTIGHT SEPTIC TANKS REQUIRED

NOTE: ALL PARTS OF SEPTIC SYSTEM SHALL BE 100 FEET FROM ANY WATER WELL

NOTE: MANHOLE RISERS REQUIRED ON ALL SEPTIC TANKS AND PUMP CHAMBERS

NEITHER THE HOWARD COUNTY COUNCIL OR THE HEALTH DEPARTMENT IS  
RESPONSIBLE FOR THE SUCCESSFUL OPERATION OF ANY SYSTEM

PERMITTEE RESPONSIBLE FOR OBTAINING FINAL APPROVAL ON THIS PERMIT

CALL 410-313-2640 FOR INSPECTION OF SEPTIC SYSTEM

**BUILDING PERMIT SIGNED**

**AND RETURNED**

4/21/04

800146538 BEDROOM, FULL BATH, OFFICE

0520120

NOT TO SCALE

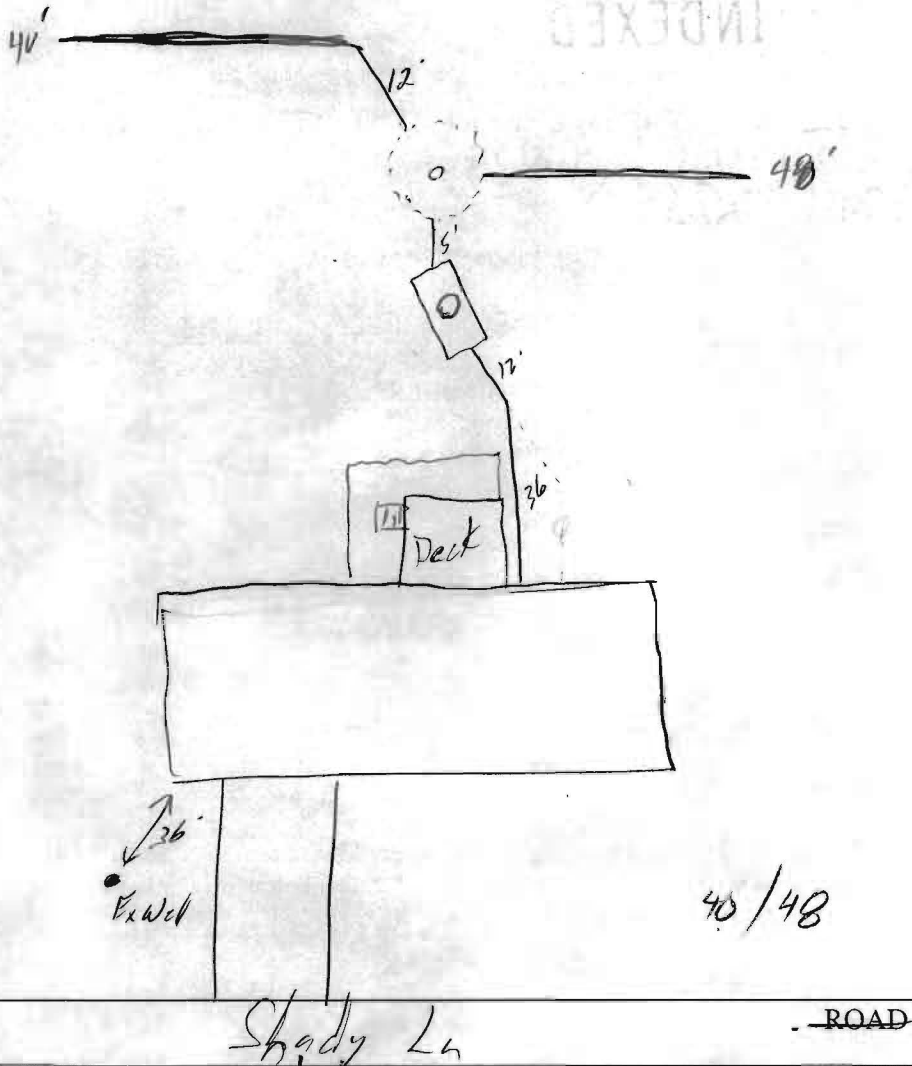

TRENCH/DRAINFIELD DATA		
WIDTH	INLET	BOTTOM
2	3.5	8.5
NUMBER OF TRENCHES	2	
TOTAL LENGTH	88'	
ABSORPTION AREA	440 #	
DISTRIBUTION BOX LEVEL	✓	
DISTRIBUTION BOX BAFFLE	✓	
DISTRIBUTION BOX PORT	—	

SEPTIC TANK DATA	
SEPTIC TANK 1 LEVEL	✓
CAPACITY	1250 GAL
SEAM LOC	TOP
TANK LID DEPTH	3'
BAFFLES	✓
BAFFLE FILTER	✓
MANHOLE LOC	Center
6" PORT LOC	—
WATERTIGHT TEST	✓
SEPTIC TANK 2 LEVEL	—
CAPACITY	— GAL
SEAM LOC	—
TANK LID DEPTH	—
BAFFLES	—
BAFFLE FILTER	—
MANHOLE LOC	—
6" PORT LOC	—
WATERTIGHT TEST	—

PRE-CONSTRUCTION 4/7/04 OK TO START (MR)

INSTALLATION 4/21/04 - OK TO COVER ALL WORK (SO)

BUILDING PERMIT SIGNED  
AND RETURNED

FINAL INSPECTOR [Signature]

DATE OF APPROVAL 4/21/04