

04-310705

PUB. SEWER STATUS VERIFIED BY \_\_\_\_\_

ISSUE DATE: \_\_\_\_\_

APPROVAL DATE: \_\_\_\_\_

**PERMIT  
INDEXED**

P 520435-A

A RE-INDEX

**ON-SITE SEWAGE DISPOSAL SYSTEM  
HOWARD COUNTY HEALTH DEPARTMENT  
BUREAU OF ENVIRONMENTAL HEALTH**IS PERMITTED TO INSTALL ☒ ALTER ☐

ADDRESS: \_\_\_\_\_ PHONE NUMBER: \_\_\_\_\_

SUBDIVISION: \_\_\_\_\_ LOT NUMBER: \_\_\_\_\_

ADDRESS: 652 W. Watersville Road PROPERTY OWNER: \_\_\_\_\_

SEPTIC TANK CAPACITY (GALLONS): \_\_\_\_\_

PUMP CHAMBER CAPACITY (GALLONS): \_\_\_\_\_

NUMBER OF BEDROOMS: \_\_\_\_\_

SQUARE FEET PER BEDROOM: \_\_\_\_\_

LINEAR FEET OF TRENCH REQUIRED: \_\_\_\_\_

TRENCHES:	Trench to be _____ feet wide. Inlet _____ feet below original grade. Bottom maximum depth _____ feet below original grade. Effective area begins at _____ feet below original grade. _____ feet of stone below distribution pipe.
LOCATION:	
PURPOSE:	Reindex file 7/30/04

PLANS APPROVED: \_\_\_\_\_ DATE: \_\_\_\_\_

NOTE: PERMIT VOID AFTER 2 YEARS

NOTE: CONTRACTOR RESPONSIBLE FOR SCHEDULING A PRE-CONSTRUCTION INSPECTION FOR ALL INSTALLATIONS

NOTE: WATERTIGHT SEPTIC TANKS REQUIRED

NOTE: ALL PARTS OF SEPTIC SYSTEM SHALL BE 100 FEET FROM ANY WATER WELL

NOTE: MANHOLE RISERS REQUIRED ON ALL SEPTIC TANKS AND PUMP CHAMBERS

**NEITHER THE HOWARD COUNTY COUNCIL OR THE HEALTH DEPARTMENT IS  
RESPONSIBLE FOR THE SUCCESSFUL OPERATION OF ANY SYSTEM  
PERMITTEE RESPONSIBLE FOR OBTAINING FINAL APPROVAL ON THIS PERMIT  
CALL 410-313-2640 FOR INSPECTION OF SEPTIC SYSTEM**

P 520435-A

P520435-A

check - 3/55/62 - 3/55/62 in P. 41.

# PERMIT

P 04490

A 03413

**INDEXED**

SEWAGE DISPOSAL SYSTEM

MARYLAND STATE DEPARTMENT OF HEALTH

HOWARD COUNTY

ELLICOTT CITY

DISTRICT 4

DATE 11/9/61

**INDEXED**

Bollinger Brothers

IS PERMITTED TO INSTALL ☒ ALTER ☐

ADDRESS Westminister

PHONE 652

A SEWAGE DISPOSAL SYSTEM LOCATED At 2 on West Watersville Rd. about 1/4 mile from Route 40  
on left hand side.

SUBDIVISION \_\_\_\_\_ ROAD \_\_\_\_\_ LOT \_\_\_\_\_

PROPERTY OWNER Bunn, Robert and Laura

ADDRESS Woodbine, Rt. 2

**SPECIFICATIONS**

DRAIN FIELD \_\_\_\_\_ DEPTH \_\_\_\_\_ FEET. BOTTOM AREA \_\_\_\_\_ SQ. FT.

SEEPAGE PITS \_\_\_\_\_ ABSORBENT SIDE-WALL AREA \_\_\_\_\_ SQ. FT.

SEPTIC TANK CAPACITY 750 GALLONS

FOR GARBAGE GRINDER, INCREASE DISPOSAL AREA 22% & TANK CAPACITY 50%.

OTHER one 10 ft. in diameter by 10 ft. deep dry well below the inlet located  
13 ft. from the front property line and 33 ft. from the right side property  
line. Right side property line determined when facing lot from West Watersville  
Road. First 3 feet of ground not to be included in sidewall area.

PLANS APPROVED BY James E. Hennigan DATE 3/13/61

FILL SEPTIC TANK AND DISTRIBUTION BOX WITH WATER BEFORE CALLING FOR AN INSPECTION. COVER NO WORK UNTIL INSPECTED AND APPROVED.

NEITHER THE HOWARD COUNTY COMMISSIONERS NOR THE HEALTH DEPARTMENT IS RESPONSIBLE FOR THE SUCCESSFUL OPERATION OF ANY SYSTEM.

BLOG. PLANS SIGNED 4/2/63  
AND RETURNED 4/2/63  
Serial # 52573  
Sealed. pack.

A. 03413

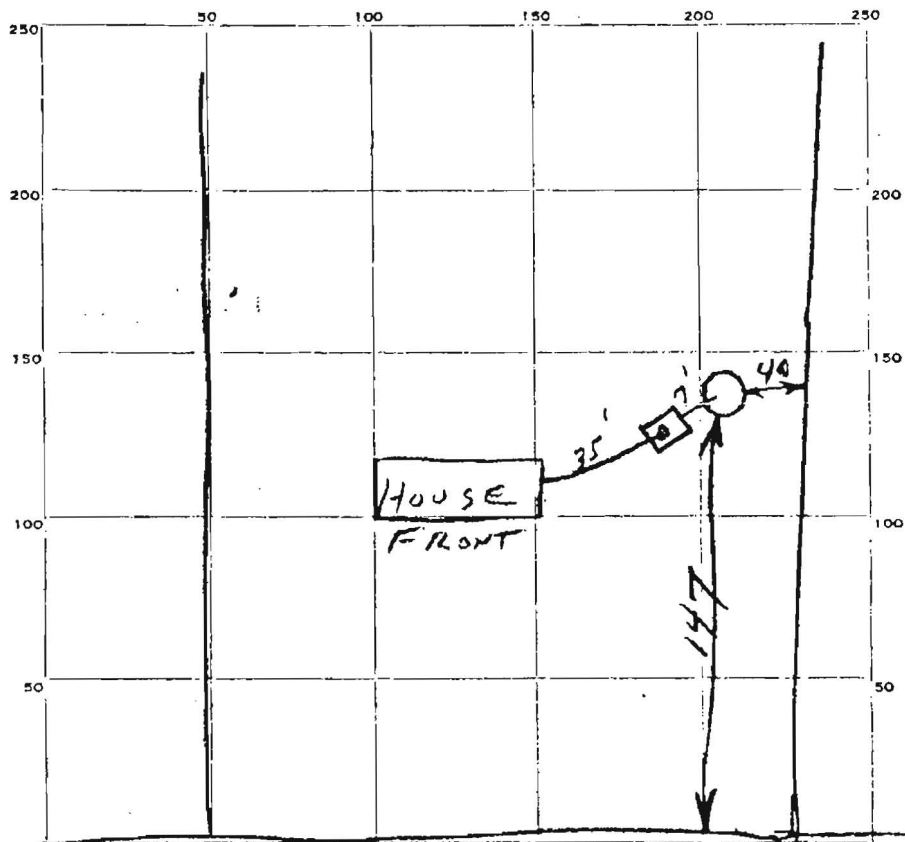

INDICATE NORTH - NAME ADJOINING ROADWAY AS BASE LINE

W. 5th W. in Village Rd.

PERMIT CARD Yes

SEPTIC TANK, LEVEL OK 750 gal

CLEANOUTS OK

DISTRIBUTION BOX, LEVEL None

TILE FIELD, DEPTH \_\_\_\_\_ FT. TRENCH WIDTH \_\_\_\_\_ FT.

GRAVEL DEPTH \_\_\_\_\_ IN. TOTAL LENGTH \_\_\_\_\_ FT.

NUMBER OF TRENCHES \_\_\_\_\_ TOTAL BOTTOM AREA \_\_\_\_\_

SEEPAGE PITS, INSIDE DIAMETER 14 FT. DEPTH BELOW INLET 95 FT.

ABSORBENT AREA over 310 SQ. FT.

REMARKS \_\_\_\_\_  
 \_\_\_\_\_  
 \_\_\_\_\_  
 \_\_\_\_\_  
 \_\_\_\_\_

DATE SYSTEM APPROVED 3-28-62

INSPECTOR [Signature]