

R 4-4  
4-66

NO 2252

State Office Building  
ANNAPOLIS, MARYLAND 21401

STATE OF MARYLAND  
DEPARTMENT OF  
WATER RESOURCES

THIS REPORT  
MUST BE SUBMITTED  
WITHIN 30 DAYS  
AFTER COMPLETION  
OF THE WELL

WELL COMPLETION REPORT **A08981** RECEIVED

WELL DESCRIPTION

'69

WELL LOG

State the kind of formations penetrated, their color, their depth, their thickness, and if water-bearing

CASING AND SCREEN RECORD

State the kind and size and position of casing, liner, shoe, screen, and other accessories (if no casing used, give diameter of well)

Permit Number **H0690137**  
Owner **Lawrence F. Downs**  
Address **6212 Plymouth Rd.**  
Subdivision **Burntwoods**  
Section **D** Lot **13**

Mica sand surface

FEET  
from \_\_\_ to \_\_\_  
to 50 ft.

50 ft.  
6" steel casing

DIAM.  
(inches)

FEET  
from \_\_\_ to \_\_\_

Mica Rock

50 to 125

PUMPING TEST

Hours Pumped **2**  
Type of Pump Used **Air**  
Pumping Rate **30**  
Gallons per Minute **2**

WATER LEVEL

Distance from land surface to water)  
Before Pumping **25** Ft.  
When Pumping **Out** Ft.

APPEARANCE OF WATER

Clear **X** Cloudy \_\_\_\_\_  
Taste \_\_\_\_\_  
Odor \_\_\_\_\_

Height of Casing Above Land

Surface **1** Ft.

PUMP INSTALLED

Type \_\_\_\_\_  
Capacity  
Gallons per Minute \_\_\_\_\_  
Gallons per Hour \_\_\_\_\_  
Pump Column Length \_\_\_\_\_ Ft.

LOCATION OF WELL ON LOT

Show permanent structures such as building(s), septic tank, and/or other landmarks and indicate not less than 2 distances (measurements) to well.

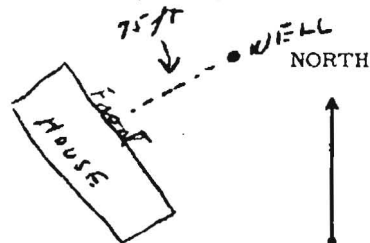

DATE  
WELL WAS  
COMPLETED

I hereby affirm that this report contains no willful misrepresentation or falsifications and that information given in this report is true, accurate and complete to the best of my knowledge and belief.

*H. G. Wilson*

, Well Driller

April 10-69

Well Driller License No.:

157

**Help Me**   
**Map Reset**   
**Zoom Fit**   
**Find Location**   
**Remove Pin**   
**Layer Control**   
**Image Control**   
**Theme Map**   
**Local Print**   
**Print Layout**   
**Email Map**   
**Map Exit** 

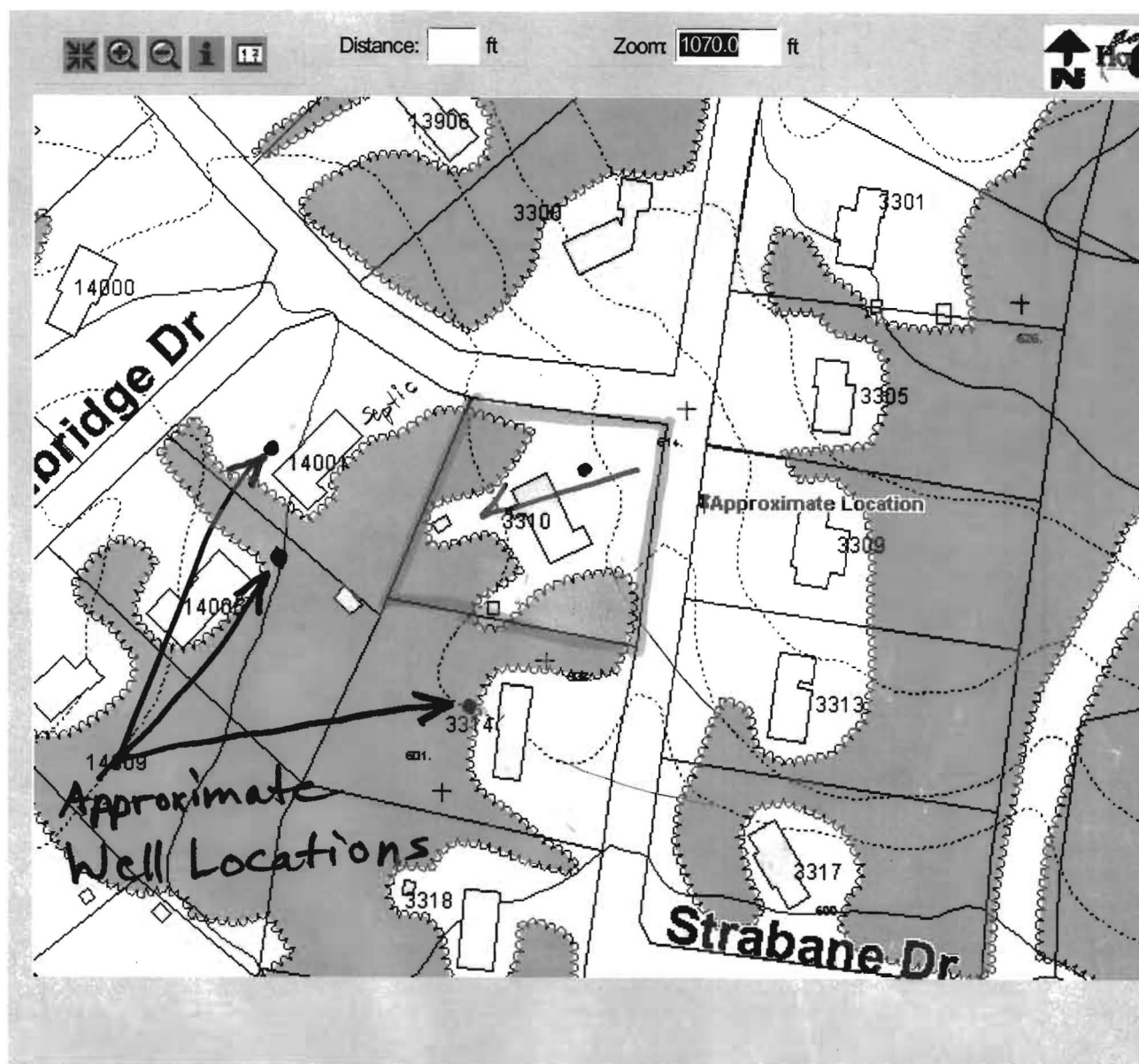

**Disclaimer:** Howard County, Maryland assumes no responsibility for the accuracy of the map or the information contained herein or derived therefrom. The buyer and/or seller assumes all risks and liabilities whatsoever resulting from or arising out of the use of this map. There are no oral agreements or warranties relating to this sale and/or use of this map.

Wednesday, June 16 2004 | 10:37:54 AM | @651

<b>Contacts:</b>	John Bussiere (x3044)	Virginia Peterman (x3659)	Yut Phasukyued (x3093)	Robert Slivinsky (x3094)
------------------	--------------------------	------------------------------	---------------------------	-----------------------------