

LAYOUT _____ INSP 4 _____

INSP 2 _____ INSP 5 _____

INSP 3 _____ INSP 6 _____

ISSUE DATE: 3/11/05

PERMIT

P 522029

APPROVAL DATE: 4/18/05

A REPAIR

05381967

**ON-SITE SEWAGE DISPOSAL SYSTEM
HOWARD COUNTY HEALTH DEPARTMENT
BUREAU OF ENVIRONMENTAL HEALTH**

FYOCKS

IS PERMITTED TO INSTALL ☒ ALTER ☐

ADDRESS: _____ PHONE NUMBER: _____

SUBDIVISION: WESLEY HILLS LOT NUMBER: 7

ADDRESS: 11447 Rowley Road PROPERTY OWNER: _____

SEPTIC TANK CAPACITY (GALLONS): _____ OUTLET BAFFLE FILTER REQUIRED ☐

PUMP CHAMBER CAPACITY (GALLONS): _____ COMPARTMENTED TANK REQUIRED ☐

NUMBER OF BEDROOMS: 4

SQUARE FEET PER BEDROOM: 180

LINEAR FEET OF TRENCH REQUIRED: 120

TRENCHES:	Trench to be _____ feet wide. Inlet _____ feet below original grade. Bottom maximum depth _____ feet below original grade. Effective area begins at _____ feet below original grade. _____ feet of stone below distribution pipe.
LOCATION:	
NOTES:	

PLANS APPROVED: _____ DATE: _____

NOTE: PERMIT VOID AFTER 2 YEARS

NOTE: CONTRACTOR RESPONSIBLE FOR SCHEDULING A PRE-CONSTRUCTION INSPECTION FOR ALL INSTALLATIONS

NOTE: WATERTIGHT SEPTIC TANKS REQUIRED

NOTE: ALL PARTS OF SEPTIC SYSTEM SHALL BE 100 FEET FROM ANY WATER WELL

NOTE: MANHOLE RISERS REQUIRED ON ALL SEPTIC TANKS AND PUMP CHAMBERS UNLESS SPECIFICALLY AUTHORIZED

**NEITHER THE HOWARD COUNTY COUNCIL NOR THE HEALTH DEPARTMENT IS
RESPONSIBLE FOR THE SUCCESSFUL OPERATION OF ANY SYSTEM
PERMITTEE RESPONSIBLE FOR OBTAINING FINAL APPROVAL ON THIS PERMIT
CALL 410-313-2640 FOR INSPECTION OF SEPTIC SYSTEM**

0522029 - A 24867

40-73-3045

NOT TO SCALE

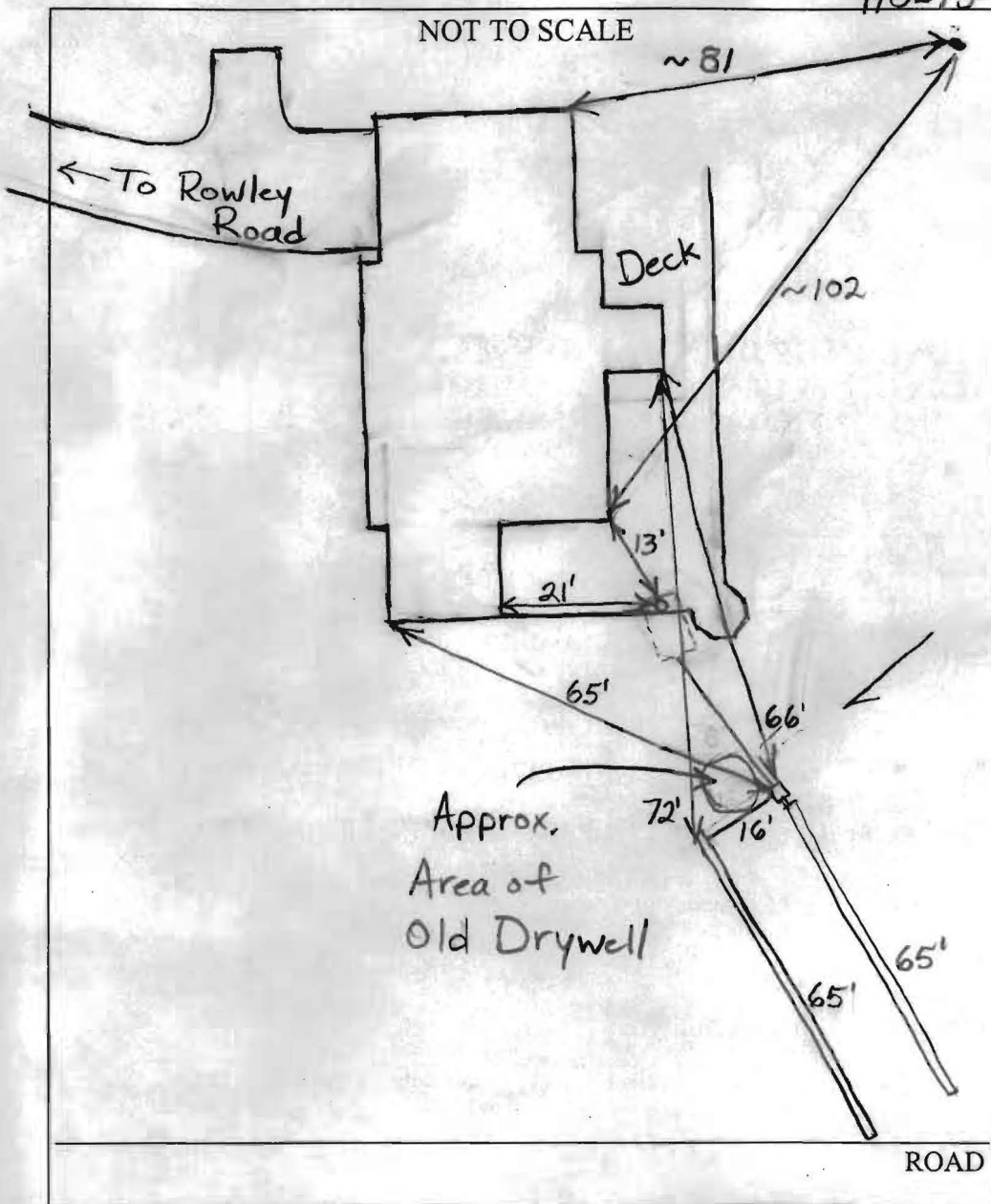

TRENCH/DRAINFIELD DATA

WIDTH	INLET	BOTTOM
3'	4.5'	7'
NUMBER OF TRENCHES		2
TOTAL LENGTH		130'
ABSORPTION AREA		390' + Sidewall
DISTRIBUTION BOX LEVEL		Yes
DISTRIBUTION BOX BAFFLE		Yes
DISTRIBUTION BOX PORT		No

SEPTIC TANK DATA

SEPTIC TANK 1 LEVEL	?
CAPACITY	1250 ? GAL
SEAM LOC	Midseam
TANK LID DEPTH	1.5'
BAFFLES	Yes
BAFFLE FILTER	No
MANHOLE LOC	None
6" PORT LOC	Front
WATERTIGHT TEST	No
SEPTIC TANK 2 LEVEL	N/A
CAPACITY	GAL
SEAM LOC	
TANK LID DEPTH	
BAFFLES	
BAFFLE FILTER	
MANHOLE LOC	
6" PORT LOC	
WATERTIGHT TEST	

PRE-CONSTRUCTION

INSTALLATION 4/18/05 Old drywell pumped out and filled with dirt. Rear tank baffle replaced. Trenches installed as per spec. on Robert Foyoko permit, (BB)

FINAL INSPECTOR B. Baber

DATE OF APPROVAL 4/18/05