

01-169084

11/25 1:30PM ✓  
11-27-87 am ✓  
**PERMIT**

**SEWAGE DISPOSAL SYSTEM**

**MARYLAND STATE DEPARTMENT OF HEALTH**

**HOWARD COUNTY**  
BUREAU OF ENVIRONMENTAL HEALTH  
461-9933

**INDEXED**

P 40309

A 30767

DISTRICT 1st

DATE 10/27/87

DATE SYSTEM APPROVED 11-27-87

INSPECTOR JEN

{ I.C.O.P. issued only }  
Time expired }

Paul Schissler/South Carroll Backhoe

IS PERMITTED TO INSTALL X ALTER

ADDRESS 4410 Salem Bottom Road, Westminster, Maryland 21157 PHONE 531-2166

SUBDIVISION Talbot's Last Shift ROAD 5269 Talbots Landing LOT 9D

PROPERTY OWNER Charles Phillips

ADDRESS \_\_\_\_\_

IF GARBAGE GRINDER IS USED INCREASE SEPTIC TANK CAPACITY BY 50% AND ABSORPTION AREA BY 22%.

GARBAGE GRINDER? YES \_\_\_\_\_ NO X

SEPTIC TANK CAPACITY 1000 GALLONS NUMBER OF BEDROOMS 3

150 ft  
41600  
20

TRENCHES - 200 sq. ft. per bedroom. Trench to be 2 feet wide. Inlet 3.5 feet below original grade. Bottom maximum depth 7.5 feet below original grade. Effective area begins at 3.5 feet below original grade. 4 feet of stone below distribution pipe.

LOCATION - Place the distribution box 165 feet down the right (309.62') lot line and 80 feet off the right lot line as seen when facing the lot from Right of way. Run trenches on contour toward the back right side of lot.

NOTE - No trench to exceed 100 feet in length. Provide 5" - 8" diameter cleanout and cap to grade or above on septic tank.

07/58

PLANS APPROVED BY S. Abel DATE 1/27/87

COVER NO WORK UNTIL INSPECTED AND APPROVED.

NEITHER THE HOWARD COUNTY COUNCIL NOR THE HEALTH DEPARTMENT IS RESPONSIBLE FOR THE SUCCESSFUL OPERATION OF ANY SYSTEM.

NOTE: CLEANOUT REQUIRED EVERY 70 FEET OF SEWER LINE AND/OR AT 90° SWEEPS IN LINES FROM HOUSE TO DRAIN FIELDS.

NOTE: ALL PARTS OF SEPTIC SYSTEMS (I.E., TANK, DISTRIBUTION BOX, TRENCHES) TO BE 100 FEET FROM WELL. (UNLESS OTHERWISE SPECIFICALLY AUTHORIZED)

NOTE: IF DEEP TRENCH(IES) ARE USED CALL FOR INSPECTION BEFORE AND AFTER PLACING GRAVEL IN TRENCH(IES).

NOTE: NO DRY WELL SHALL EXCEED 15 FOOT IN DIAMETER. NO ABSORPTION TRENCH TO EXCEED 100 FEET IN LENGTH.

NOTE: ALL PIPE FROM HOUSE TO SEPTIC TANK MUST BE CAST IRON OR SCHEDULE 40 PVC OR ABS.

PERMIT VOID AFTER TWO YEARS.

NOTE: INSTALL STAND PIPE ON SEPTIC TANK AND DRY WELL. STAND PIPES MUST BE 6 INCHES IN DIAMETER. CAST IRON, CONCRETE OR TERRA COTTA OR PVC OR ABS ACCEPTED. IF TOP OF SEPTIC TANK IS DEEPER THAN 3 FEET, MANHOLE TO GRADE REQUIRED.

NOTE: DISTRIBUTION BOXES MUST HAVE BAFFLES.

**\*INSTALLER IS RESPONSIBLE FOR OBTAINING FINAL APPROVAL ON THIS PERMIT**

**\*CALL 461-9933 FOR INSPECTION OF SEPTIC SYSTEMS.**

EH - 2-1186

A-30767

11-25-87  
 WP I - no \$ pd.  
 Pitless adaptor at  
 42 in. House  
 connection ok.  
 Ground line  
 on well. JENadeau

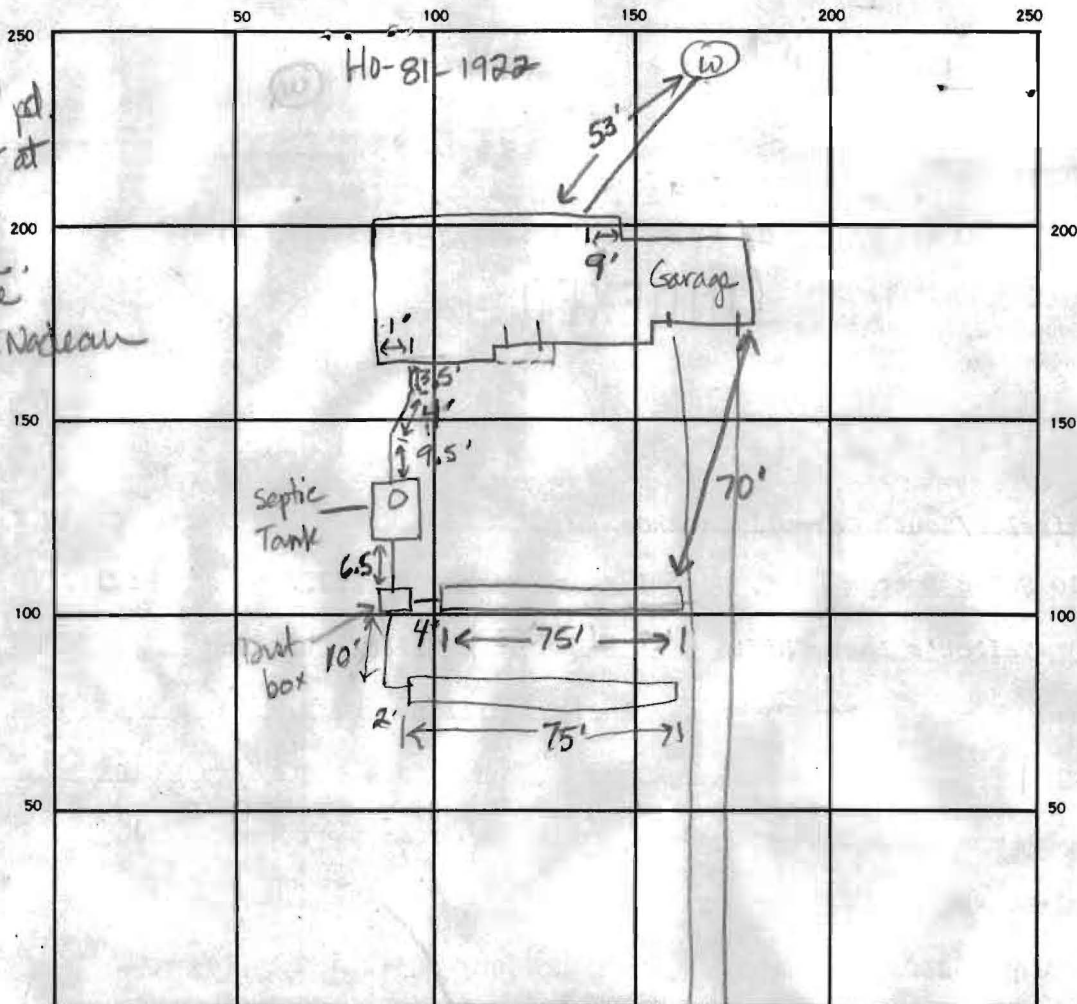

22  
 2.4  
 88  
 44  
 52  
 29  
 2.4  
 116  
 58  
 69

INDICATE NORTH. — NAME ADJOINING ROADWAY AS BASE LINE.

Talbots Landing Road

SEPTIC TANK, LEVEL \_\_\_\_\_ CLEANOUTS 1 on septic tank @ 3 ft depth  
 DISTRIBUTION BOX, LEVEL OK - remove clay & sand from floor of box  
 DRAIN FIELD/TILE FIELD, DEPTH 1.5 FT. TRENCH WIDTH 2 FT. INLET DEPTH 3.5 FT.  
 EFFECTIVE GRAVEL DEPTH 4 FT. TOTAL LENGTH 75' FT.  
 NUMBER OF TRENCHES 2 ONE SIDEWALL/BOTTOM AREA 300 SQ. FT.  
 DRYWELL INSIDE DIAMETER \_\_\_\_\_ FT. EFFECTIVE DEPTH BELOW INLET \_\_\_\_\_ FT.  
 ABSORBENT AREA 600 SQ. FT.

REMARKS 11-25-87 OK to add stone, pipe & paper to trench #1. OK to cover house to distribution box JEN. 11-27-87 OK to cover trench #1, add stone, pipe & paper to trench #2. OK to cover trench #2 and all other work. JEN

DATE SYSTEM APPROVED 11-21-87 INSPECTOR Jane E. Nadeau

11-25-87  
 WP I - no #  
 Pitless adaptor at  
 42 in. House  
 connection ok.  
 Ground line  
 on well. JENadeau

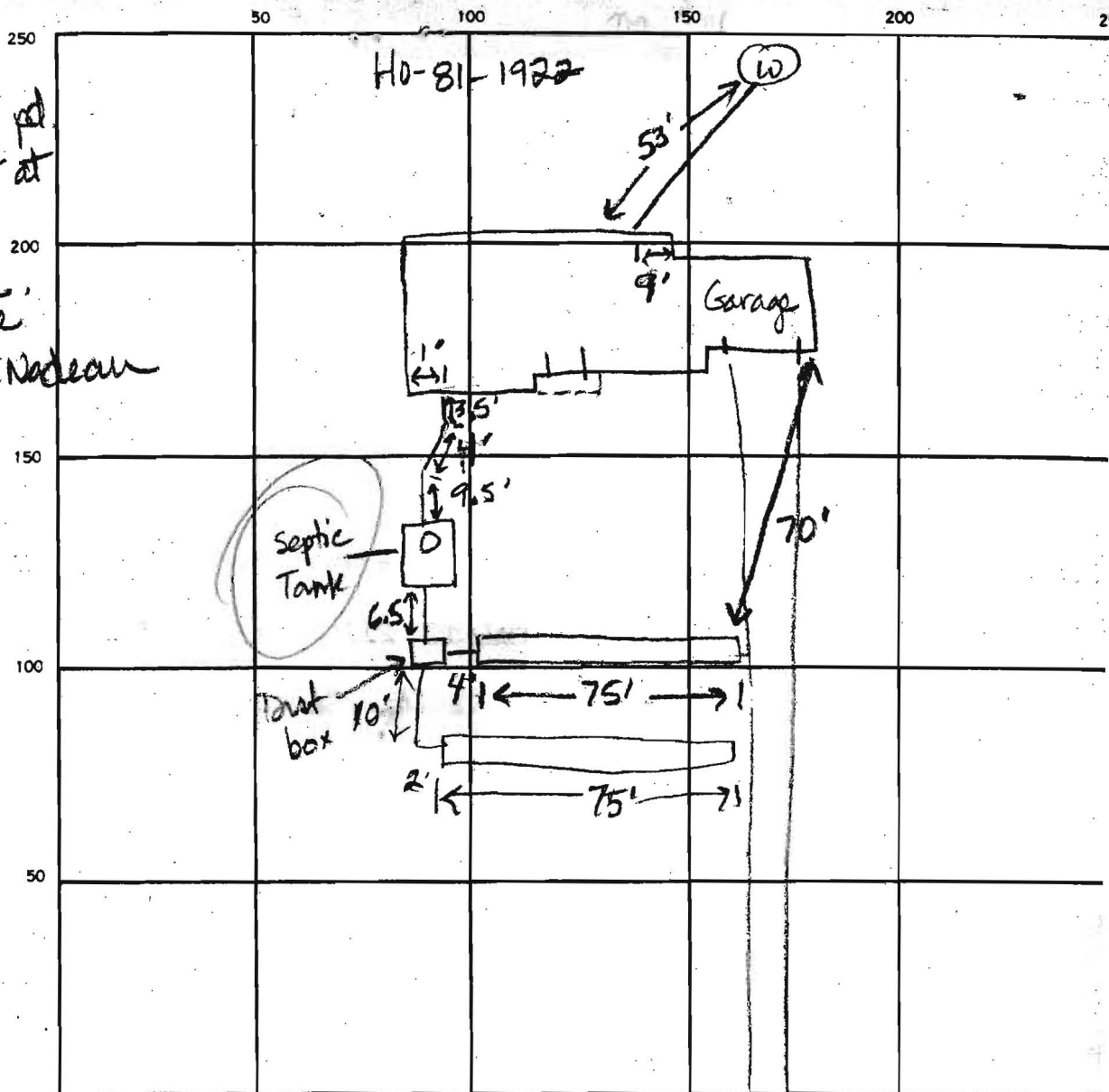

INDICATE NORTH. — NAME ADJOINING ROADWAY AS BASE LINE.

Talbot's Landing Road

SEPTIC TANK, LEVEL \_\_\_\_\_ CLEANOUTS 1 on septic tank  
 DISTRIBUTION BOX, LEVEL OK - remove clay & sand from floor of bc  
 DRAIN FIELD/TILE FIELD, DEPTH 1.5 FT. TRENCH WIDTH 2 FT. INLET DEPTH 3.5 FT.  
 EFFECTIVE GRAVEL DEPTH 4 FT. TOTAL LENGTH 75' FT.  
 NUMBER OF TRENCHES 2 ONE SIDEWALL/BOTTOM AREA 300 SQ.  
 DRYWELL INSIDE DIAMETER \_\_\_\_\_ FT. EFFECTIVE DEPTH BELOW INLET \_\_\_\_\_ FT.  
 ABSORBENT AREA 600 SQ. FT.

REMARKS 11-25-87 OK to add stone, pipe & paper to trench  
to cover house to distribution box JEN. 11-27-8