

4/6/88 1 PM

05-404894

# PERMIT

SEWAGE DISPOSAL SYSTEM

MARYLAND STATE DEPARTMENT OF HEALTH\*

DISTRICT

HOWARD COUNTY

BUREAU OF ENVIRONMENTAL HEALTH

461-9933

INDEXED

DATE 10/16/87

DATE SYSTEM APPROVED

INSPECTOR

P 40223

A 37254

4/6/88

RH

~~Alan Whitworth~~

RCM

IS PERMITTED TO INSTALL ☒ ALTER

ADDRESS 12680 Clarksville Pike, Clarksville, MD 21029 PHONE 531-5033

SUBDIVISION Thistle Down ROAD 7221 Tall Pine Way LOT 13

PROPERTY OWNER

~~Kevin Foster~~

DALE & MARY Young

ADDRESS

IF GARBAGE GRINDER IS USED INCREASE SEPTIC TANK CAPACITY BY 50% AND ABSORPTION AREA BY 22%.

GARBAGE GRINDER? YES NO ☒

SEPTIC TANK CAPACITY 1250 GALLONS NUMBER OF BEDROOMS 4

TRENCHES - 180 sq. ft. per bedroom. Trench to be 3 feet wide. Inlet 3.5 feet below original grade. Bottom maximum depth 5.0 feet below original grade. Effective area begins at 3.5 feet below original grade. 1.5 feet of stone below distribution pipe.

LOCATION - Place the distribution box 170 feet down the right (280') lot line and 100 feet off the right lot line as seen when facing the lot from the Tall Pine Way. Run trenches on contour toward the right lot line.

NOTE - No trench to exceed 100 feet in length. Provide 6" - 8" diameter cleanout and cap to grade or above on septic tank.

OLDG. PERMIT SIGNED

AND RETURNED

10-21-98

Serial # 200714710

DATE 1/09/87

PLANS APPROVED BY S. Abel

COVER NO WORK UNTIL INSPECTED AND APPROVED.

NEITHER THE HOWARD COUNTY COUNCIL NOR THE HEALTH DEPARTMENT IS RESPONSIBLE FOR THE SUCCESSFUL OPERATION OF ANY SYSTEM.

NOTE: CLEANOUT REQUIRED EVERY 70 FEET OF SEWER LINE AND/OR AT 90° SWEEPS IN LINES FROM HOUSE TO DRAIN FIELDS.

NOTE: ALL PARTS OF SEPTIC SYSTEMS (I.E., TANK, DISTRIBUTION BOX, TRENCHES) TO BE 100 FEET FROM WELL. (UNLESS OTHERWISE SPECIFICALLY AUTHORIZED)

NOTE: IF DEEP TRENCH(IES) ARE USED CALL FOR INSPECTION BEFORE AND AFTER PLACING GRAVEL IN TRENCH(IES).

NOTE: NO DRY WELL SHALL EXCEED 15 FOOT IN DIAMETER. NO ABSORPTION TRENCH TO EXCEED 100 FEET IN LENGTH.

NOTE: ALL PIPE FROM HOUSE TO SEPTIC TANK MUST BE CAST IRON OR SCHEDULE 40 PVC OR ABS.

PERMIT VOID AFTER TWO YEARS.

NOTE: INSTALL STAND PIPE ON SEPTIC TANK AND DRY WELL. STAND PIPES MUST BE 6 INCHES IN DIAMETER. CAST IRON, CONCRETE OR TERRA COTTA OR PVC OR ABS ACCEPTED. IF TOP OF SEPTIC TANK IS DEEPER THAN 3 FEET, MANHOLE TO GRADE REQUIRED.

NOTE: DISTRIBUTION BOXES MUST HAVE BAFFLES.

\*INSTALLER IS RESPONSIBLE FOR OBTAINING FINAL APROVAL ON THIS PERMIT

\*CALL 461-9933 FOR INSPECTION OF SEPTIC SYSTEMS.

EH - 2-1186

A 37254

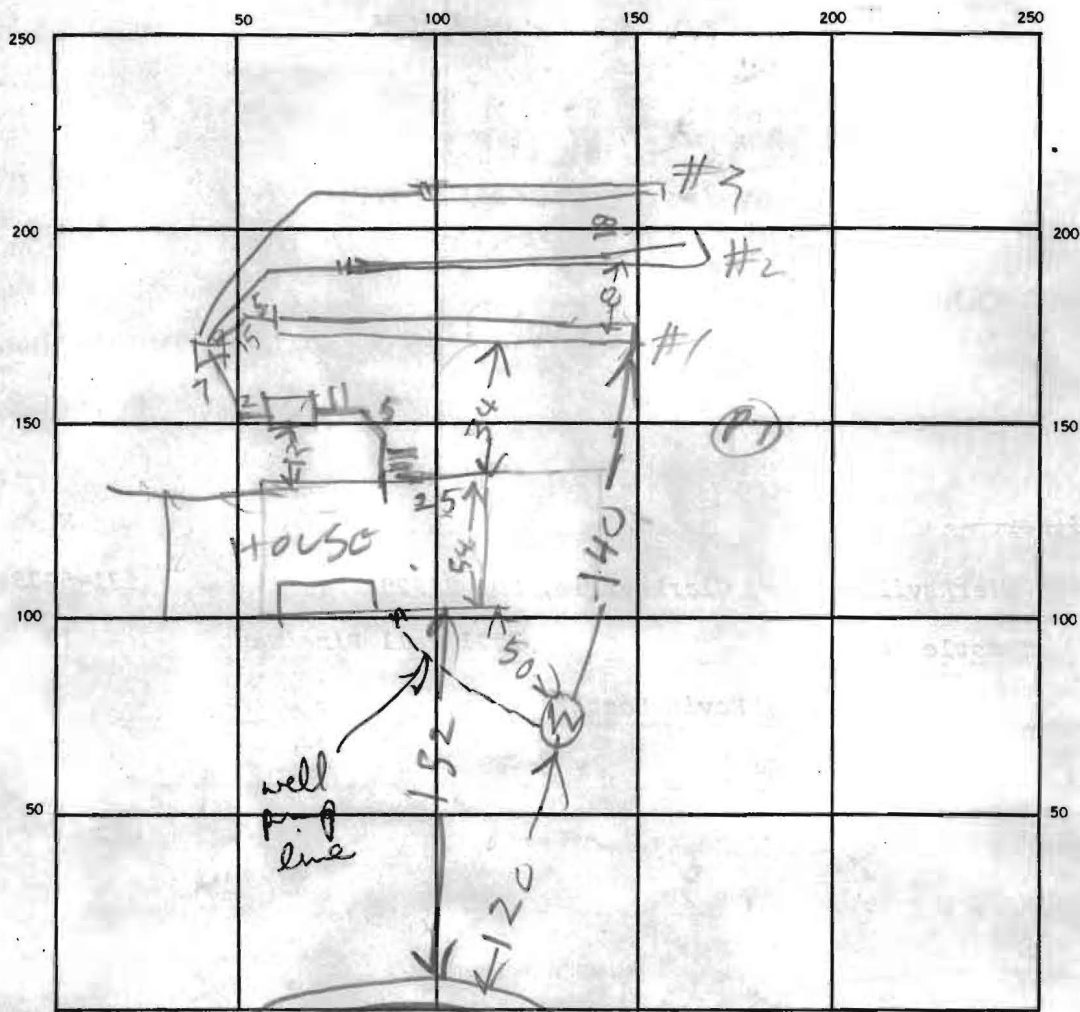

SEPTIC TANK, LEVEL OK 1500 CLEANOUTS OK

DISTRIBUTION BOX, LEVEL \_\_\_\_\_

DRAIN FIELD/TILE FIELD, DEPTH 4 FT. TRENCH WIDTH 3 1/3 FT. INLET DEPTH 4 1/2 FT.

EFFECTIVE GRAVEL DEPTH 1 1/2 FT. TOTAL LENGTH 97 FT.

NUMBER OF TRENCHES 3 ONE-SIDEWALL/BOTTOM AREA 762 SQ. FT.

DRYWELL INSIDE DIAMETER \_\_\_\_\_ FT. EFFECTIVE DEPTH BELOW INLET \_\_\_\_\_ FT.

ABSORBENT AREA \_\_\_\_\_ SQ. FT.

REMARKS 4/6/88 LOCATION A LITTLE OFF BUT NOT

TOO MUCH. TRENCHES OK

DATE SYSTEM APPROVED 4/6/88 INSPECTOR Raymond Mody