

WR-W-4  
2-65

State Office Building  
ANNAPOLIS, MARYLAND 21401

RECEIVED  
STATE OF MARYLAND  
DEPARTMENT OF  
WATER RESOURCES

THIS REPORT  
MUST BE SUBMITTED  
WITHIN 30 DAYS  
AFTER COMPLETION  
OF THE WELL

# WELL COMPLETION REPORT

## WELL DESCRIPTION

### WELL LOG

State the kind of formations penetrated, their color, their depth, their thickness, and if water-bearing

### CASING AND SCREEN RECORD

State the kind and size and position of casing, lining, shoe, screen, and other accessories (if no casing used, give diameter of well).

80 ft well  
Dirt + loose  
Rock — 0-35  
Orange Clay 35-43  
Soft Brown  
Rock 43-60  
Water — 60  
Soft Brown  
Rock 60-80

FEET  
from — to —

57 ft well  
5.5" casing

DIAM.  
(Inches)  
5 5/8

FEET  
from — to —  
0-57

Permit Number HD 66 W 322  
Owner Eugene Connors  
Address Glenwood Md  
Subdivision \_\_\_\_\_  
Section \_\_\_\_\_ Lot \_\_\_\_\_

### PUMPING TEST

Hours Pumped One  
Type of Pump Used Driller  
Pumping Rate 7  
Gallons per Minute 7

### WATER LEVEL

Distance from land surface to water:

Before Pumping 41 Ft.  
When Pumping 59 Ft.

### APPEARANCE OF WATER

Clear ☒ Cloudy \_\_\_\_\_  
Taste OK  
Odor None

Height of Casing Above Land

Surface \_\_\_\_\_ Ft.

### PUMP INSTALLED

Type \_\_\_\_\_  
Capacity \_\_\_\_\_  
Gallons per Minute \_\_\_\_\_  
Gallons per Hour \_\_\_\_\_  
Pump Column Length \_\_\_\_\_ Ft.

### LOCATION OF WELL ON LOT

Show permanent structures such as building(s), septic tank, and/or other landmarks and indicate not less than 2 distances (measurements) to well.

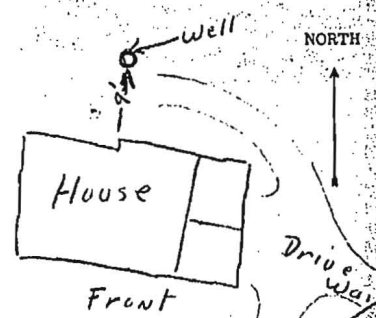

Date Well  
Was Completed June 28 '66

Well Driller Walter Barnes  
Signature Walter Barnes

TRIPPLICATE