



Building Permit Application

Howard County Maryland
Department of Inspections, Licenses and Permits
3430 Court House Drive
Permits: 410-313-2455
www.howardcountymd.gov

Date Received: 6-19-13

Permit No.: B13002439

Building Address: 11233 Whithorn Way
City: Ellicott City State: MD Zip Code: 21042
Suite/Apt. #: _____ SDP/WP/BA #: _____
Census Tract: _____ Subdivision: Riverwood
Section: _____ Area: _____ Lot: 72
Tax Map: 29 Parcel: 20 Grid: 4
Zoning: RCOEU Map Coordinates: _____ Lot Size: 42,595
sq ft

Existing Use: Vacant
Proposed Use: SFD
Estimated Construction Cost: \$ 350,000
Description of Work: Garrett w/2 story
finished basement, rear salarum, 4 BR,
4 FB, 1 HB, FP, 3 car side load garage

Occupant or Tenant: _____
Was tenant space previously occupied? ☐ Yes ☐ No
Contact Name: _____
Address: _____
City: _____ State: _____ Zip Code: _____
Phone: _____ Fax: _____
Email: _____

Commercial Building Characteristics	Residential Building Characteristics
Height: _____	<input type="checkbox"/> SF Dwelling <input type="checkbox"/> SF Townhouse
No. of stories: _____	Depth: _____ Width: _____
Gross area, sq. ft./floor: _____	1 st floor: <u>66'</u> <u>56'</u>
Area of construction (sq. ft.): _____	2 nd floor: <u>66'</u> <u>56'</u>
Use group: _____	Basement: <u>66'</u> <u>56'</u>
<u>Construction type:</u>	<input checked="" type="checkbox"/> Finished Basement
<input type="checkbox"/> Reinforced Concrete	<input type="checkbox"/> Unfinished Basement
<input type="checkbox"/> Structural Steel	<input type="checkbox"/> Crawl Space
<input type="checkbox"/> Masonry	<input type="checkbox"/> Slab on Grade
<input type="checkbox"/> Wood Frame	No. of Bedrooms: <u>4</u>
<input type="checkbox"/> State Certified Modular	<u>Multi-family Dwelling</u>
	No. of efficiency units: _____
	No. of 1 BR units: _____
	No. of 2 BR units: _____
	No. of 3 BR units: _____
	Other Structure: _____
	Dimensions: _____
<input checked="" type="checkbox"/> Roadside Tree Project Permit	Footings: _____
<input type="checkbox"/> Yes <input checked="" type="checkbox"/> No	Roof: _____
Roadside Tree Project Permit # _____	<input type="checkbox"/> State Certified Modular
	<input type="checkbox"/> Manufactured Home

Property Owner's Name: Winchester Homes
Address: 6905 Rockledge Dr. #200
City: Bethesda State: MD Zip Code: 20817
Phone: 301-203-4803 Fax: _____
Email: _____

Applicant's Name & Mailing Address, (if other than stated herein)
Applicant's Name: Carol Viers
Address: 503 Sylvan Dr.
City: Pasadena State: MD Zip Code: 21122
Phone: 410-279-1424 Fax: _____
Email: Carolspermits@broadstrips.net

Contractor Company: Winchester Home
Contact Person: Lynn Reich
Address: Same As Above
City: _____ State: _____ Zip Code: _____
License No.: 57
Phone: _____ Fax: _____
Email: _____

Engineer/Architect Company: Benchmark Engineer
Responsible Design Prof.: John Carey
Address: 8480 Baltimore National Pike
City: Ellicott City State: MD Zip Code: 21043
Phone: 410-6105 Fax: 410-665-6644
Email: _____

Utilities
<u>Water Supply</u>
<input type="checkbox"/> Public
<input checked="" type="checkbox"/> Private
<u>Sewage Disposal</u>
<input type="checkbox"/> Public
<input checked="" type="checkbox"/> Private
Electric: <input checked="" type="checkbox"/> Yes <input type="checkbox"/> No
Gas: <input type="checkbox"/> Yes <input type="checkbox"/> No
<u>Heating System</u>
<input type="checkbox"/> Electric <input type="checkbox"/> Oil
<input checked="" type="checkbox"/> Natural Gas <input type="checkbox"/> Propane Gas
<input type="checkbox"/> Other: _____
<u>Sprinkler System:</u>
<input type="checkbox"/> Yes <input type="checkbox"/> No
<u>Grading Permit Number:</u>
<u>61100058</u>
<u>Building Shell Permit Number:</u>

THE UNDERSIGNED HEREBY CERTIFIES AND AGREES AS FOLLOWS: (1) THAT HE/SHE IS AUTHORIZED TO MAKE THIS APPLICATION; (2) THAT THE INFORMATION IS CORRECT; (3) THAT HE/SHE WILL COMPLY WITH ALL REGULATIONS OF HOWARD COUNTY WHICH ARE APPLICABLE THERETO; (4) THAT HE/SHE WILL PERFORM NO WORK ON THE ABOVE REFERENCED PROPERTY NOT SPECIFICALLY DESCRIBED IN THIS APPLICATION; (5) THAT HE/SHE GRANTS COUNTY OFFICIALS THE RIGHT TO ENTER ONTO THIS PROPERTY FOR THE PURPOSE OF INSPECTING THE WORK PERMITTED AND POSTING NOTICES.

Applicant's Signature: Carol Viers
Email Address: Carolspermits@broadstrips.net
Permit Runner
Title/Company

Print Name: Carol Viers
Date: 6-19-13

Checks Payable to: DIRECTOR OF FINANCE OF HOWARD COUNTY

PLEASE WRITE NEATLY & LEGIBLY
FOR OFFICE USE ONLY

AGENCY	DATE	SIGNATURE OF APPROVAL
<input checked="" type="checkbox"/> State Highways		
<input checked="" type="checkbox"/> Building Officials		
<input checked="" type="checkbox"/> PSZA (Zoning)		
<input checked="" type="checkbox"/> PSZA (Engineering)		
Health	<u>7-2-13</u>	<u>Dana Bernard</u>

Is Sediment Control approval required for issuance? ☐ Yes ☐ No
☐ CONTINGENCY CONSTRUCTION START

DPZ SETBACK INFORMATION
Front: _____
Rear: _____
Side: _____
Side St.: _____
All minimum setbacks met? <input type="checkbox"/> Yes <input type="checkbox"/> No
Is Entrance Permit Required? <input type="checkbox"/> Yes <input type="checkbox"/> No
Historic District? <input type="checkbox"/> Yes <input type="checkbox"/> No
Lot Coverage for New Town Zone: _____
SDP/Red-line approval date: _____

Filing Fee	\$ <u>100</u>
Permit Fee	\$
Tech Fee	\$
Excise Tax	\$
PSFS	\$
Guaranty Fund	\$ <u>50</u>
Add'l per Fee	\$
Total Fees	\$
Sub-Total Paid	\$
Balance Due	\$
Check	# <u>35201</u>



SOILS LEGEND		
MAP SYMBOL	SOIL GROUP	SOIL TYPE
ChB2	B	CHESTER SILT LOAM, 3 TO 8 PERCENT SLOPES, MODERATELY ERODED
* INDICATES HYDRIC SOILS		
TAKEN FROM SOILS SURVEY, ISSUED JULY 1968, MAP NO. 33		

GRID NORTH

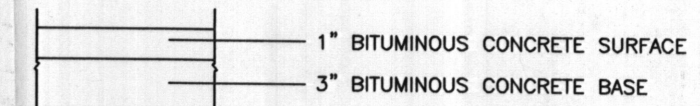

FULL DEPTH BITUMINOUS CONCRETE

PAVING SECTION
NOT TO SCALE

LEGEND

- EXISTING CONTOURS ESTABLISHED UNDER F-04-082
- FIELD SURVEYED WELL LOCATION
- PASSED PERCOLATION TEST PER TEST NOTES
- FAILED PERCOLATION TEST PER TEST NOTES

SOILS DELINEATION

NOTES:

- THE LOT SHOWN HEREON WAS RECORDED ON THE PLAT FOR RIVERWOOD, PLAT No. 19724. REFER TO THE PLAT FOR LOT DIMENSIONS, LOT AREAS AND ALL EASEMENTS.
- SEDIMENT AND EROSION CONTROLS WERE APPROVED BY HOWARD SOIL CONSERVATION DISTRICT UNDER A GRADING PLAN AND MODIFIED FOR THIS SPECIFIC HOUSE.
- TOPOGRAPHY SHOWN HEREON IS TAKEN FROM THE APPROVED ROAD CONSTRUCTION PLANS AND HAS BEEN FIELD VERIFIED BY J.A. RICE, INC., ON OR ABOUT SEPTEMBER 2002.
- ALL SEDIMENT AND EROSION CONTROL FEATURES USED ON THIS SITE SHALL COMPLY WITH 1994 MARYLAND STANDARDS AND SPECIFICATIONS FOR SOIL EROSION AND SEDIMENT CONTROL.
- ALL DRAINAGE AND STORMWATER MANAGEMENT FEATURES USED ON THIS SITE MUST COMPLY WITH THE APPROVED ROAD CONSTRUCTION PLANS EXCEPT AS WAIVED.
- THE EXISTING WELL SHOWN ON THIS PLAN, HO-95-0717, HAS BEEN FIELD LOCATED BY BENCHMARK ENGINEERING, INC., AND IS ACCURATELY SHOWN.
- THERE ARE NO EXISTING WELLS OR SEPTIC SYSTEMS WITHIN 100' OF THIS PROJECT'S BOUNDARY EXCEPT AS NOTED.
- ANY CHANGES TO A PRIVATE SEWAGE EASEMENT OR WELL BOX SHALL REQUIRE A REVISED PERCOLATION CERTIFICATION PLAN.
- STORMWATER MANAGEMENT FOR THE LOT SHALL BE IN CONFORMANCE WITH THE STORMWATER MANAGEMENT REPORT SUBMITTED WITH THIS BUILDING PERMIT PLAN. THE USE OF 4 DRYWELLS AND ONE FILTER STRIP PROVIDE STORMWATER MANAGEMENT TO THE MAXIMUM EXTENT PRACTICABLE.
- THE PURPOSE OF THIS PERCOLATION CERTIFICATION PLAN IS TO ABANDON THE WELL BOX FOR THE THIS LOT AND SHOW TWO WELL REPLACEMENT LOCATIONS DUE TO THE DRYWELL LOCATIONS.

Approved Septic System Plan
Howard County Health Department
Signature: [Signature]
Date: 6/4/2013

BENCHMARK
ENGINEERS ▲ LAND SURVEYORS ▲ PLANNERS
ENGINEERING, INC.
8480 BALTIMORE NATIONAL PIKE ▲ SUITE 418
ELLICOTT CITY, MARYLAND 21043
PHONE: 410-465-6105 ▲ FAX: 410-465-6644
BEI@BEI-CIVILENGINEERING.COM

OWNER/BUILDER:
CAMBERLEY HOMES, INC.
6905 ROCKLEDGE DRIVE
SUITE 800
BETHESDA, MD 20817
PHONE: 301-803-4800
FAX: 301-803-4929

PROJECT:
RIVERWOOD LOT 72
LOCATION: 11233 WHITHORN WAY
ELLICOTT CITY, MD 21042
TAX MAP No. 29 - BLOCK Nos. 3, 4, 9 & 10 - PARCEL No. 20
3rd ELECTION DISTRICT, HOWARD COUNTY, MARYLAND
TITLE: **BUILDING PERMIT PLAN AND REVISED PERCOLATION CERTIFICATION PLAN**
HOUSE TYPE: **GARRETT (02GA96)**
DATE: MAY, 2013 PROJECT NO. 1950
SCALE: 1" = 30' DRAWING 1 OF 1

I CERTIFY THAT THE INFORMATION SHOWN HEREON IS BASED ON FIELD WORK PERFORMED BY ME OR UNDER MY DIRECT SUPERVISION, AND IS CORRECT, TO THE BEST OF KNOWLEDGE AND BELIEF.

PLAN PREPARER
JOHN M. CARNEY FOR BENCHMARK ENGINEERING, INC.

APPROVED:
APPROVED FOR PRIVATE WATER SYSTEM AND SHARED SEPTIC SYSTEM (LOT 72)
HOWARD COUNTY HEALTH DEPARTMENT

APPROVED FOR MARYLAND DEPARTMENT OF ENVIRONMENTAL & NATURAL RESOURCES
DATE: 6/4/2013

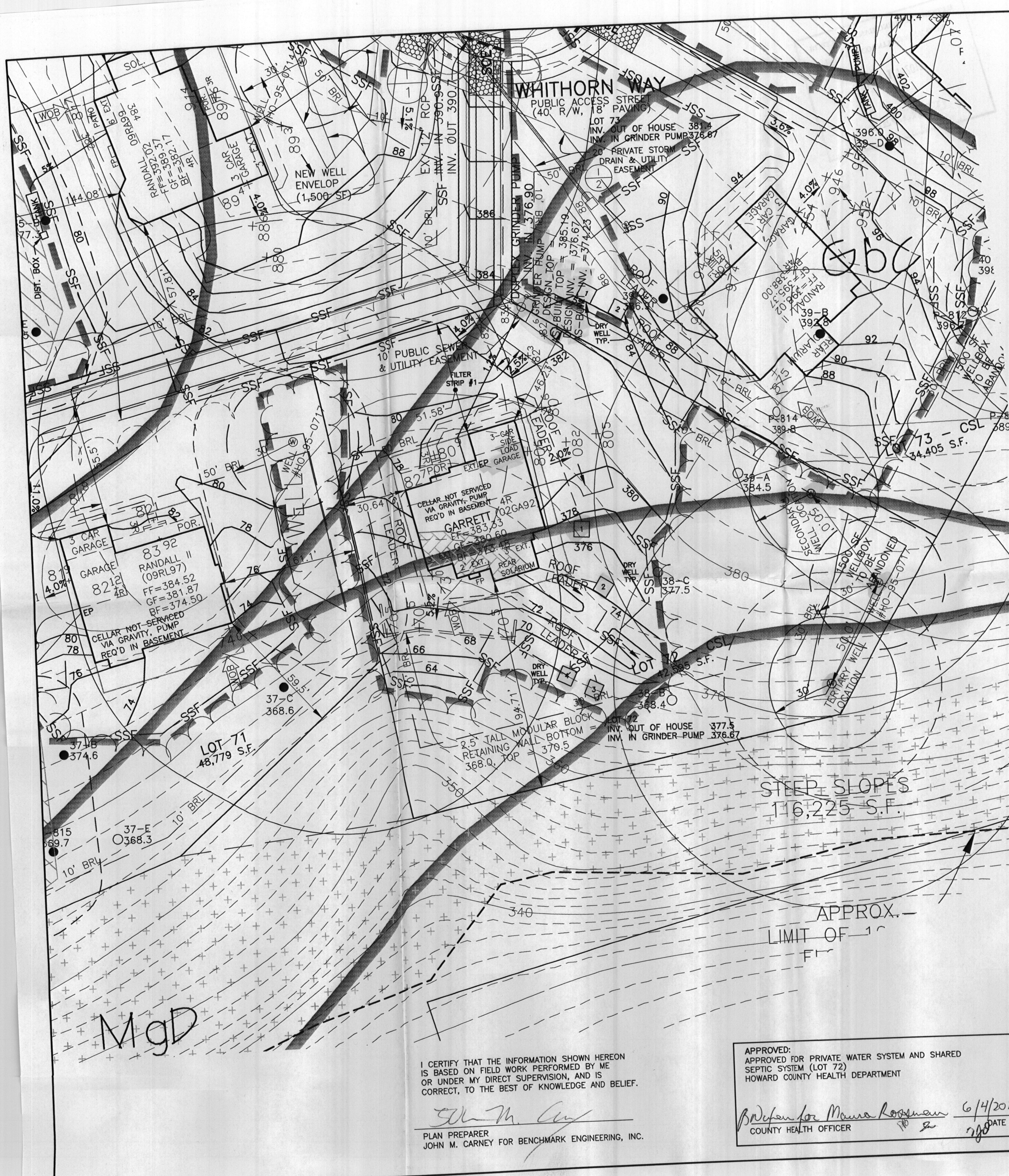

SOILS LEGEND		
MAP SYMBOL	SOIL GROUP	SOIL TYPE
ChB2	B	CHESTER SILT LOAM, 3 TO 8 PERCENT SLOPES, MODERATELY ERODED
* INDICATES HYDRIC SOILS		
TAKEN FROM SOILS SURVEY, ISSUED JULY 1968, MAP NO. 33		

GRID NORTH

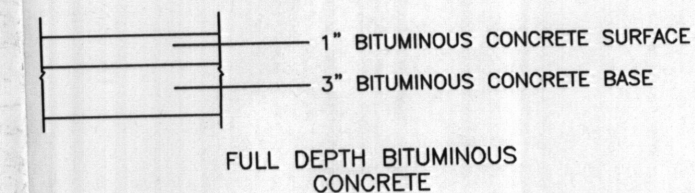

PAVING SECTION
NOT TO SCALE

LEGEND

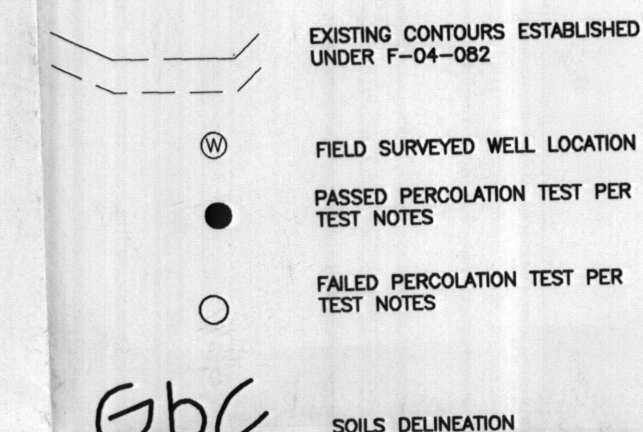

NOTES:

- THE LOT SHOWN HEREON WAS RECORDED ON THE PLAT FOR RIVERWOOD, PLAT No. 19724. REFER TO THE PLAT FOR LOT DIMENSIONS, LOT AREAS AND ALL EASEMENTS.
- SEDIMENT AND EROSION CONTROLS WERE APPROVED BY HOWARD SOIL CONSERVATION DISTRICT UNDER A GRADING PLAN AND MODIFIED FOR THIS SPECIFIC HOUSE.
- TOPOGRAPHY SHOWN HEREON IS TAKEN FROM THE APPROVED ROAD CONSTRUCTION PLANS AND HAS BEEN FIELD VERIFIED BY J.A. RICE, INC., ON OR ABOUT SEPTEMBER 2002.
- ALL SEDIMENT AND EROSION CONTROL FEATURES USED ON THIS SITE SHALL COMPLY WITH 1994 MARYLAND STANDARDS AND SPECIFICATIONS FOR SOIL EROSION AND SEDIMENT CONTROL.
- ALL DRAINAGE AND STORMWATER MANAGEMENT FEATURES USED ON THIS SITE MUST COMPLY WITH THE APPROVED ROAD CONSTRUCTION PLANS EXCEPT AS WAIVED.
- THE EXISTING WELL SHOWN ON THIS PLAN, HO-95-0717, HAS BEEN FIELD LOCATED BY BENCHMARK ENGINEERING, INC., AND IS ACCURATELY SHOWN.
- THERE ARE NO EXISTING WELLS OR SEPTIC SYSTEMS WITHIN 100' OF THIS PROJECT'S BOUNDARY EXCEPT AS NOTED.
- ANY CHANGES TO A PRIVATE SEWAGE EASEMENT OR WELL BOX SHALL REQUIRE A REVISED PERCOLATION CERTIFICATION PLAN.
- STORMWATER MANAGEMENT FOR THE LOT SHALL BE IN CONFORMANCE WITH THE STORMWATER MANAGEMENT REPORT SUBMITTED WITH THIS BUILDING PERMIT PLAN. THE USE OF 4 DRYWELLS AND ONE FILTER STRIP PROVIDE STORMWATER MANAGEMENT TO THE MAXIMUM EXTENT PRACTICABLE.
- THE PURPOSE OF THIS PERCOLATION CERTIFICATION PLAN IS TO ABANDON THE WELL BOX FOR THE THIS LOT AND SHOW TWO WELL REPLACEMENT LOCATIONS DUE TO THE DRYWELL LOCATIONS.

BENCHMARK
ENGINEERS • LAND SURVEYORS • PLANNERS
ENGINEERING, INC.

8480 BALTIMORE NATIONAL PIKE • SUITE 418
ELLICOTT CITY, MARYLAND 21043
PHONE: 410-465-6105 • FAX: 410-465-6644
BEI@BEI-CVLENGINEERING.COM

OWNER/BUILDER:

CAMBERLEY HOMES, INC.
6905 ROCKLEDGE DRIVE
SUITE 800
BETHESDA, MD 20817
PHONE: 301-803-4800
FAX: 301-803-4929

PROJECT:

**RIVERWOOD
LOT 72**

LOCATION: 11233 WHITHORN WAY
ELLICOTT CITY, MD 21042
TAX MAP No. 29 - BLOCK Nos. 3, 4, 9 & 10 - PARCEL No. 20
3rd ELECTION DISTRICT, HOWARD COUNTY, MARYLAND

TITLE: BUILDING PERMIT PLAN AND REVISED
PERCOLATION CERTIFICATION PLAN

HOUSE TYPE: GARRETT (02GA96)

DATE: MAY, 2013 PROJECT NO. 1950

SCALE: 1" = 30' DRAWING 1 OF 1

DESIGN: JMC DRAFT: JMC

I CERTIFY THAT THE INFORMATION SHOWN HEREON
IS BASED ON FIELD WORK PERFORMED BY ME
OR UNDER MY DIRECT SUPERVISION, AND IS
CORRECT, TO THE BEST OF KNOWLEDGE AND BELIEF.

PLAN PREPARER
JOHN M. CARNEY FOR BENCHMARK ENGINEERING, INC.

APPROVED:
APPROVED FOR PRIVATE WATER SYSTEM AND SHARED
SEPTIC SYSTEM (LOT 72)
HOWARD COUNTY HEALTH DEPARTMENT

COUNTY HEALTH OFFICER