

PERMIT

SEWAGE DISPOSAL SYSTEM

P 11393

A 09615

MARYLAND STATE DEPARTMENT OF HEALTH

HOWARD COUNTY

ELLICOTT CITY

DISTRICT 3

DATE 12/27/65

Walter A. Shank

IS PERMITTED TO INSTALL X ALTER

ADDRESS Avoca Ave., Ellicott City, Md. PHONE HO 5-3464

A SEWAGE DISPOSAL SYSTEM LOCATED AT Shepherds Glen

SUBDIVISION Shepherds Glen ROAD Walt-Ann Drive LOT 13

PROPERTY OWNER ~~Walter A. Shank~~ Stephen Lee

ADDRESS Avoca Ave., Ellicott City

SPECIFICATIONS

DRAIN FIELD _____ DEPTH _____ FEET, BOTTOM AREA _____ SQ. FT.

SEEPAGE PITS _____ ABSORBENT SIDE-WALL AREA _____ SQ. FT.

SEPTIC TANK CAPACITY 1,000 GALLONS

FOR GARBAGE GRINDER, INCREASE DISPOSAL AREA 22% & TANK CAPACITY 50%.

OTHER Dry Well - ³ bedrooms, 12 ft. in diameter by 10 ft. deep below the
inlet pipe located 190 ft. from the front property line and 18 ft.
from the right side property line as seen when facing the lot from
Folly Quarter Dr., locate inlet 4 ft. below original grade. (750 gal.)
4 bedrooms - Same as above with these exceptions: Dry well 13 ft. in
diameter by 12 ft. deep below the inlet. 1,000 gal. tank

PLANS APPROVED BY _____ DATE _____

FILL SEPTIC TANK AND DISTRIBUTION BOX WITH WATER BEFORE CALLING FOR AN INSPECTION. COVER NO WORK UNTIL INSPECTED AND APPROVED.

NEITHER THE HOWARD COUNTY COMMISSIONERS NOR THE HEALTH DEPARTMENT IS RESPONSIBLE FOR THE SUCCESSFUL OPERATION OF ANY SYSTEM.

A 09615

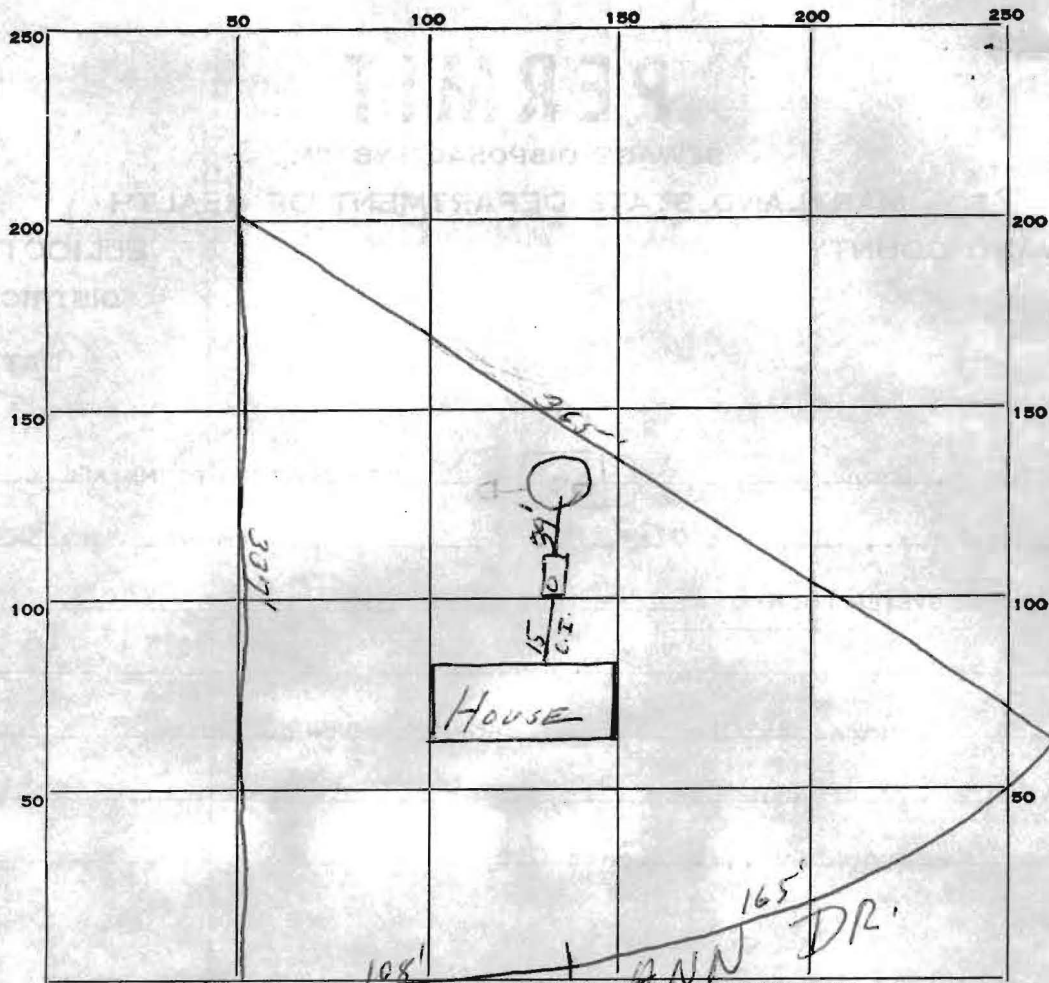

PERMIT CARD

None Seen

SEPTIC TANK, LEVEL

✓ 1000 gal - concrete

CLEANOUTS

6" Standpipe

DISTRIBUTION BOX, LEVEL

TILE FIELD, DEPTH

FT.

TRENCH WIDTH

FT.

GRAVEL DEPTH

IN.

TOTAL LENGTH

FT.

NUMBER OF TRENCHES

TOTAL BOTTOM AREA

SEEPAGE PITS, INSIDE DIAMETER

14

FT.

DEPTH BELOW INLET

12 1/2

FT.

ABSORBENT AREA

OK

SQ. FT.

REMARKS

DATE SYSTEM APPROVED

3-16-66

INSPECTOR

J. Hennigan

THIS PROPERTY IS NOT LOCATED WITHIN ANY
PREVIOUSLY DETERMINED FLOOD PLAIN AREA
UNLESS OTHERWISE INDICATED

HOWARD COUNTY
MARYLAND

WALT-ANN

SCALE: 1" = 50'

LS #6138

The Surveyors
Professional Land Surveyors
307 W. LAFAYETTE AVENUE
BALTIMORE, MD 21217
PHONE: (410) 728-8767