

LAYOUT \_\_\_\_\_ INSP 4 \_\_\_\_\_

INSP 2 \_\_\_\_\_ INSP 5 \_\_\_\_\_

INSP 3 \_\_\_\_\_ INSP 6 \_\_\_\_\_

ISSUE DATE: 4/5/06

APPROVAL DATE: 4/12/06

**PERMIT**

**INDEXED**

**TAX ID #05-370264**

P 524390

A 524039

**ON-SITE SEWAGE DISPOSAL SYSTEM  
HOWARD COUNTY HEALTH DEPARTMENT  
BUREAU OF ENVIRONMENTAL HEALTH**

Sam's Excavating \_\_\_\_\_ IS PERMITTED TO INSTALL ☒ ALTER ☐

ADDRESS: P. O. Box 0157, Fulton MD 20759 PHONE NUMBER: 443-277-7915

SUBDIVISION: \_\_\_\_\_ LOT NUMBER: \_\_\_\_\_

ADDRESS: 11863 Scaggsville Road PROPERTY OWNER: Henry Horn

SEPTIC TANK CAPACITY (GALLONS): 1250 OUTLET BAFFLE FILTER REQUIRED ☐

PUMP CHAMBER CAPACITY (GALLONS) n/a COMPARTMENTED TANK REQUIRED ☒

NUMBER OF BEDROOMS: 4

SQUARE FEET PER BEDROOM: 210

LINEAR FEET OF TRENCH REQUIRED: 240 HOUSE SERVED BY PUBLIC WATER ☐

TRENCHES:	Trench to be 2.0 feet wide. Inlet 4.0 feet below original grade. Bottom maximum depth 8.0 feet below original grade. Effective area begins at 6.0 feet below original grade. 4.0 feet of stone below distribution pipe.
LOCATION:	Install new septic tank and two trenches equal to 175 feet. Pump and collapse old septic tank and drywell.
NOTES:	Ensure existing trench is functioning properly.

PLANS APPROVED: Kevin Bell Reviewed by: \_\_\_\_\_ DATE: 3/28/06

**NOTES: PERMIT VOID AFTER 2 YEARS**

CONTRACTOR IS RESPONSIBLE FOR SCHEDULING A PRE-CONSTRUCTION INSPECTION FOR ALL INSTALLATIONS  
WATERTIGHT SEPTIC TANKS REQUIRED

ALL PARTS OF SEPTIC SYSTEM SHALL BE 100 FEET FROM ANY WATER WELL UNLESS SPECIFICALLY AUTHORIZED  
MANHOLE RISERS REQUIRED ON ALL SEPTIC TANKS AND PUMP CHAMBERS UNLESS SPECIFICALLY AUTHORIZED

CONTRACTOR RESPONSIBLE FOR COMPLIANCE WITH APPLICABLE REGULATIONS, GUIDELINES AND THE TERMS OF THIS PERMIT

**NEITHER THE HOWARD COUNTY COUNCIL NOR THE HEALTH DEPARTMENT IS  
RESPONSIBLE FOR THE SUCCESSFUL OPERATION OF ANY SYSTEM  
PERMITTEE RESPONSIBLE FOR OBTAINING FINAL APPROVAL ON THIS PERMIT  
ALL 410-313-1771 FOR INSPECTION OF SEPTIC SYSTEM**

524039

H0-95-0287

NOT TO SCALE

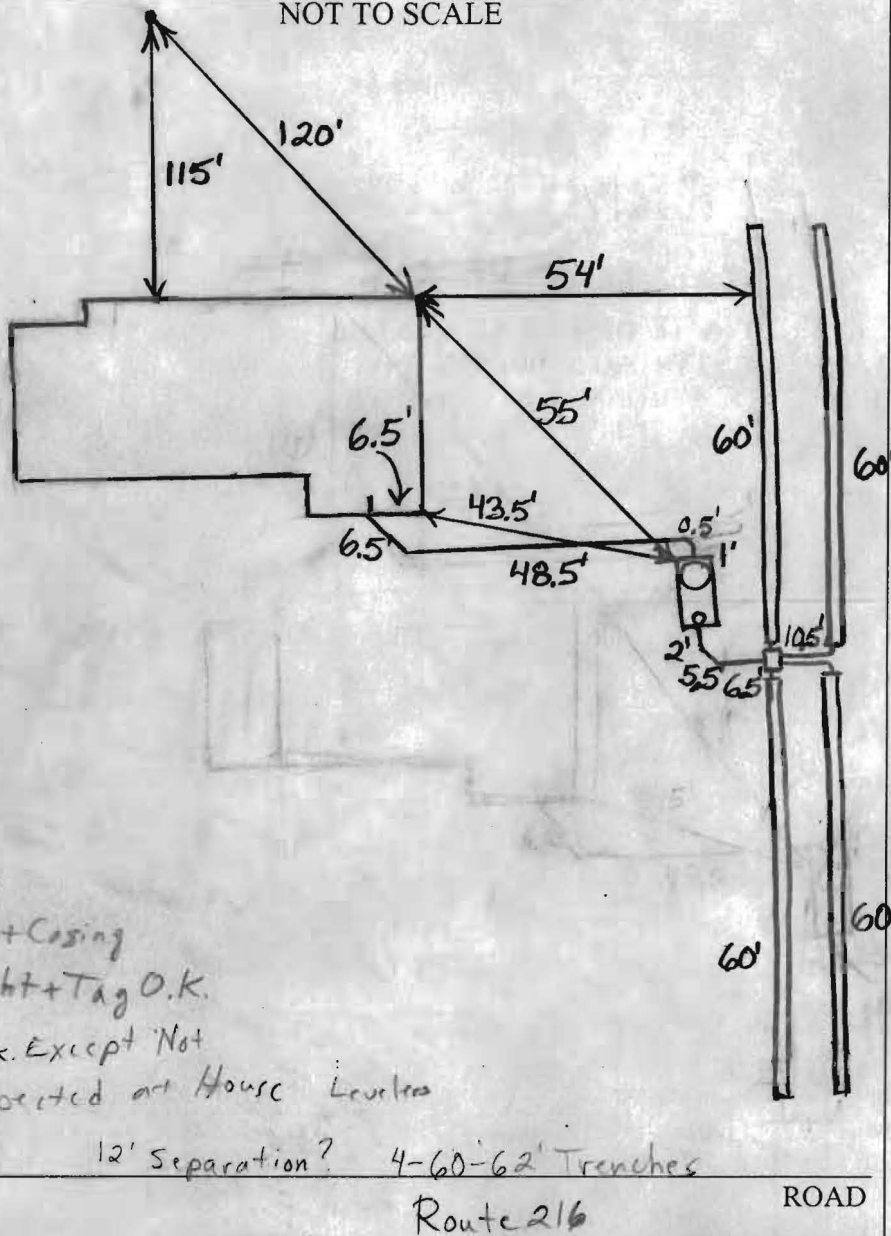

TRENCH/DRAINFIELD DATA		
WIDTH	INLET	BOTTOM
2'	5'	8.0'
NUMBER OF TRENCHES 4		
TOTAL LENGTH 240+		
ABSORPTION AREA 480+		
DISTRIBUTION BOX LEVEL Yes		
DISTRIBUTION BOX BAFFLE Yes		
DISTRIBUTION BOX PORT No		

SEPTIC TANK DATA		
SEPTIC TANK 1 LEVEL	Yes	
CAPACITY	1500	GAL
SEAM LOC	Top	
TANK LID DEPTH	2.5'-3.5'	
BAFFLES	Yes	
BAFFLE FILTER	No	
MANHOLE LOC	Front	
6" PORT LOC	Rear	
WATERTIGHT TEST	No	
SEPTIC TANK 2 LEVEL	N/A	
CAPACITY		GAL
SEAM LOC		
TANK LID DEPTH		
BAFFLES		
BAFFLE FILTER		
MANHOLE LOC		
6" PORT LOC		
WATERTIGHT TEST		

Well  
Cap+Casing  
Height+Tag O.K.  
All O.K. Except Not  
Inspected at House Level

12' Separation? 4-60'-62' Trenches  
Route 216

PRE-CONSTRUCTION 4/6/06 Abandon old S.T. & Dr. Install new 1500 TS  
S.T. 20' off new foundation, (4) 60' trenches w/ DB in the

INSTALLATION middle (SD)

4/12/06 System installed. Old tank and dry well are pumped  
out but need to be filled in by contractor. Gravity to trenches  
required an inlet of ~5'. O.K. to cover everything (BB)

FINAL INSPECTOR B. Baker

DATE OF APPROVAL 4/12/06