

SEQUENCE NO. (MDE USE ONLY) STATE OF MARYLAND WELL COMPLETION REPORT FILL IN THIS FORM COMPLETELY PLEASE TYPE THIS REPORT MUST BE SUBMITTED WITHIN 45 DAYS AFTER WELL IS COMPLETED. COUNTY NUMBER DATE RECEIVED DATE WELL COMPLETED Depth of Well PERMIT NO. FROM "PERMIT TO DRILL WELL" OWNER WELL SITE ADDRESS TOWN SUBDIVISION SECTION LOT

WELL LOG Not required for driven wells STATE THE KIND OF FORMATIONS PENETRATED, THEIR COLOR, DEPTH, THICKNESS AND IF WATER BEARING

| DESCRIPTION (Use additional sheets if needed) | FEET FROM | TO | check if water bearing |
|---|-----------|-----|------------------------|
| Brown to black soil | 0 | 38 | ✓ |
| collapsing river rock | | | |
| Gray Limestone | 38 | 92 | |
| Quartz | 92 | 93 | ✓ |
| Limestone | 93 | 200 | ✓ |

GROUTING RECORD WELL HAS BEEN GROUTED (Circle Appropriate Box) TYPE OF GROUTING MATERIAL (Circle one) CEMENT BENTONITE CLAY NO. OF BAGS NO. OF POUNDS GALLONS OF WATER DEPTH OF GROUT SEAL (to nearest foot) from TOP ft. to BOTTOM ft. (enter 0 if from surface) CASING RECORD casing types insert appropriate code below MAIN CASING TYPE Nominal diameter top (main) casing (nearest inch) Total depth of main casing (nearest foot) OTHER CASING (if used) diameter inch depth (feet) from to

PUMPING TEST HOURS PUMPED (nearest hour) PUMPING RATE (gal. per min.) METHOD USED TO MEASURE PUMPING RATE WATER LEVEL (distance from land surface) BEFORE PUMPING WHEN PUMPING TYPE OF PUMP USED (for test) A air P piston T turbine C centrifugal R rotary O other (describe below) J jet S submersible

NUMBER OF UNSUCCESSFUL WELLS: WELL HYDROFRACTURED CIRCLE APPROPRIATE LETTER A A WELL WAS ABANDONED AND SEALED WHEN THIS WELL WAS COMPLETED E ELECTRIC LOG OBTAINED P TEST WELL CONVERTED TO PRODUCTION WELL HEREBY CERTIFY THAT THIS WELL HAS BEEN CONSTRUCTED IN ACCORDANCE WITH COMAR 26.04.04 "WELL CONSTRUCTION" AND IN CONFORMANCE WITH ALL CONDITIONS STATED IN THE ABOVE CAPTIONED PERMIT, AND THAT THE INFORMATION PRESENTED HEREIN IS ACCURATE AND COMPLETE TO THE BEST OF MY KNOWLEDGE. DRILLERS LIC. NO. DRILLERS SIGNATURE (MUST MATCH SIGNATURE ON APPLICATION) LIC. NO. SITE SUPERVISOR (sign. of driller or journeyman responsible for sitework if different from permittee)

DEPTH (nearest ft.) SLOT SIZE 1 2 3 DIAMETER OF SCREEN (NEAREST INCH) GRAVEL PACK IF WELL DRILLED WAS FLOWING WELL INSERT F IN BOX 68 MDE USE ONLY (NOT TO BE FILLED IN BY DRILLER) T (E.R.O.S.) W Q TELESCOPE CASING LOG INDICATOR OTHER DATA

PUMP INSTALLED DRILLER INSTALLED PUMP (CIRCLE) (YES OR NO) IF DRILLER INSTALLS PUMP, THIS SECTION MUST BE COMPLETED FOR ALL WELLS. TYPE OF PUMP INSTALLED PLACE (A,C,J,P,R,S,T,O) IN BOX 29. CAPACITY: GALLONS PER MINUTE (to nearest gallon) PUMP HORSE POWER PUMP COLUMN LENGTH (nearest ft.) CASING HEIGHT (circle appropriate box and enter casing height) LAND SURFACE LATITUDE 3 LONGITUDE 7 (DEFAULT COORD. WGS 84) NOTES:

B 1 09361

SEQUENCE NO.
(MDE USE ONLY)

STATE OF MARYLAND
APPLICATION FOR PERMIT TO DRILL WELL
538089 please type

STATE PERMIT NUMBER

Ho -95 -2423
fill in this form completely

Date Received (APA)
10/09/12
8 MM DD YY 13

OWNER INFORMATION

Isaac Brian
13940 Rovermill Rd
West Friendship Md
57 Town 70 State 72 Zip 76

B 3

LOCATION OF WELL

Howard
8 COUNTY 21
23 SUBDIVISION 42
SECTION 44 46 LOT 13 48 50
West Friendship
52 NEAREST TOWN 71

DRILLER INFORMATION

Allen Compton M S D 009
Driller's Name 76 License No. 81
Foggs Well Drilling, LLC
P.O. Box 202 Woodbine Md 21797
Allen Compton 10-4-12
Signature Date

B 4

SOURCES OF DRILLING WATER

Rovermill Rd
11 STREET ADDRESS 30
ON WHICH SIDE OF ROAD
(CIRCLE APPROPRIATE BOX)
NORTH
W 32 E
WEST SOUTH
34 880' 37
250' DISTANCE FROM ROAD
ENTER FT OR MI 38 39
TAX MAP: 0015 BLK: 0013 PARCEL 0116

B 2

WELL INFORMATION

APPROX. PUMPING RATE
(GAL. PER MIN.) 5
AVERAGE DAILY QUANTITY NEEDED
(GAL. PER DAY) 500
14 20

USE FOR WATER (CIRCLE APPROPRIATE BOX)

- ☒ DOMESTIC POTABLE SUPPLY & RESIDENTIAL IRRIGATION
☐ FARMING (LIVESTOCK WATERING & AGRICULTURAL IRRIGATION)
☐ INDUSTRIAL, COMMERCIAL, DEWATERING
☐ PUBLIC WATER SUPPLY WELL
☐ TEST, OBSERVATION, MONITORING
☐ OPEN LOOP GEOTHERMAL
☐ CLOSED LOOP GEOTHERMAL

NOT TO BE FILLED IN BY DRILLER
HEALTH DEPARTMENT APPROVAL

Howard A 531931 13
COUNTY NAME COUNTY NO.
STATE SIGNATURE INSERT S 41
DATE ISSUED 10/22/2012 RKT 10/22/13
43 MM DD YY 48 CO SIGNATURE EXP. DATE

APPROXIMATE DEPTH OF WELL 300 FEET
24 28

APPROXIMATE DIAMETER OF WELL 6 NEAREST INCH

METHOD OF DRILLING (circle one)

BORED (or Augered) JETTED Jetted & DRIVEN
AIR-ROTARY AIR-PERCussion ROTARY (Hydraulic Rotary)
CABLE REVERSE-ROTARY Drive-POINT
other

REPLACEMENT OR DEEPEMED WELLS
(CIRCLE APPROPRIATE BOX)

- ☒ THIS WELL WILL NOT REPLACE AN EXISTING WELL
☐ THIS WELL WILL REPLACE A WELL THAT WILL BE ABANDONED AND SEALED
☐ THIS WELL WILL REPLACE A WELL THAT WILL BE USED AS A STANDBY-CONTACT LOCAL APPROVING AUTHORITY FOR POLICY ON STANDBY WELLS
☐ THIS WELL WILL DEEPEMED AN EXISTING WELL
PERMIT NUMBER OF WELL TO BE REPLACED OR DEEPEMED (IF AVAILABLE) 41 52

Not to be filled in by driller (MDE OR COUNTY USE ONLY)

APPROX. PERMIT NUMBER G
PERMIT No. Ho -95 -2423
70 71 72 73 74 75 76 77 78 79

SPECIAL CONDITIONS

NOTE APPROVING AUTHORITIES SHOULD USE SEPARATE SHEET IF NEEDED

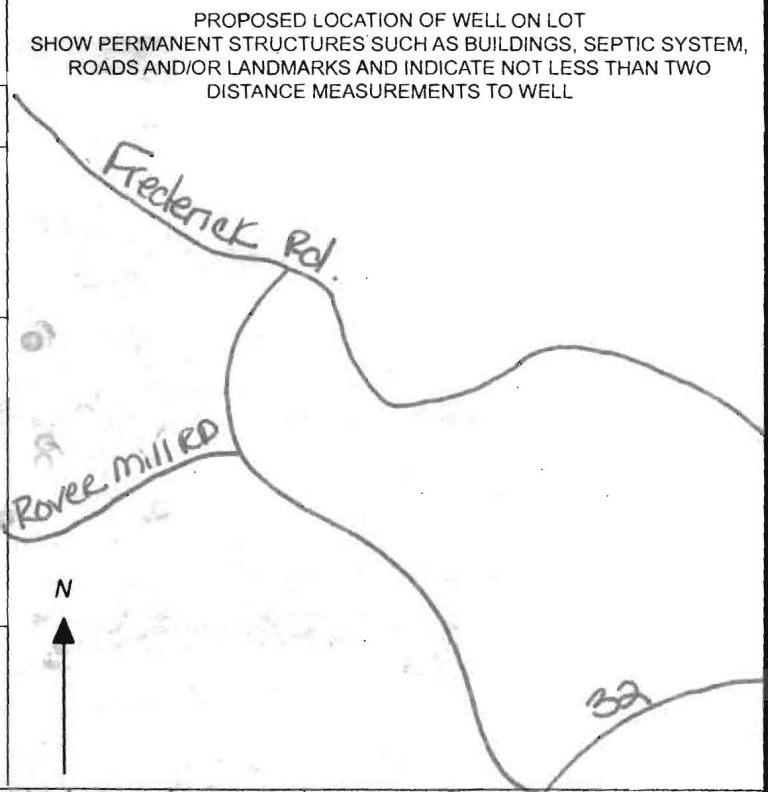

Steel casing must be set a minimum of 50' or 10' into the competent bedrock whichever is deeper!

Depth of well 200'
Distance of measuring point (M.P.) above ground 2'
Static water level (S.W.L.) below M.P. 8'

HD-224



Bureau of Environmental Health

7178 Columbia Gateway Drive, Columbia, MD 21046-2147

Main: 410-313-2640 | Fax: 410-313-2648

TDD 410-313-2323 | Toll Free 1-866-313-6300

www.hchealth.org

Facebook: www.facebook.com/hocohealth

Twitter: HowardCoHealthDep

Maura J. Rossman, M.D., Health Officer

**OPERATION AND MAINTENANCE AGREEMENT
FOR AN ON-SITE SEWAGE DISPOSAL SYSTEM
HAVING AN ADVANCED PRE-TREATMENT SYSTEM**

THIS AGREEMENT is made this 13th day of May, 2014, among Brian G. Isaac, hereinafter collectively referred to as "Owner", and the Howard County Health Department hereinafter referred to as the "County".

WHEREAS, Owner is the owner or contract owner of a parcel of land located at 13936 Rover Mill Road, West Friendship, MD 21794, in the 3rd Election District of Howard County, Maryland, and the deed to same is recorded or shall be recorded among the Land Records of Howard County, Maryland in Liber 11857 Folio 44.

WHEREAS, The Lot is suitable for the installation of a conventional on-site sewage disposal system with an advanced pre-treatment system, utilizing best available technology to perform nitrogen reduction, in accordance with the Code of Maryland Regulations 26.04.02.07, effective January 1, 2013.

NOW, THEREFORE, the parties hereto agree as follows:

- A. Owner hereby grants to the County the right to enter upon the Lot at any reasonable time for access to the system to make periodic inspections and the Owner agrees to provide any information and data in Owner's possession reasonably requested and needed by the County to develop accurate and thorough test results.
- B. Owner acknowledges and agrees that neither the County nor any of its agents or ~~employees, either officially or individually, underwrites the operation of any system~~ approved by them.
- C. The Owner will devote reasonable care and effort to the operation and maintenance of the system in perpetuity or until a public sewer connection is made so that a system malfunction is not the result of poor maintenance, faulty operation, or neglect.
- D. The Owner agrees to enter into a contract reasonably acceptable to the Owner and the County with a private entity to operate and maintain on a regularly scheduled basis an approved advanced pre-treatment system. The owner shall supply a copy of the contract to the County when it is renewed or altered.
- E. This agreement shall run with the land and upon Owner's taking title to the Lot shall bind the Owner, their heirs, successors, and assigns to the provisions of the agreement as

20
40
43

long as the property is in existence and after installation of the system. Owner further agrees that they shall inform in writing any subsequent purchaser or lessee of the Lot that the system shall require maintenance or other attention. Upon taking title to the Lot, the Owner agrees to cause this agreement to be recorded in the Land Records of Howard County and assure that it becomes part of the Deed for the subject property in order that prospective buyers may be aware of the special conditions affecting this property.

F. This agreement shall not be construed to limit any authority of the County to protect the public health, safety or comfort or to issue any other orders to take any other action which is now or may hereafter be within its authority.

G. This agreement may be voided at any time at the discretion of the County.

H. This agreement contains the entire agreement and understanding between the County and the Owner. There are no additional terms other than as contained in this agreement. This agreement may not be modified, except in writing signed by each of the parties or by their authorized representatives.

I. The laws of the State of Maryland govern the provisions of all transactions pursuant to this agreement.

J. Owner acknowledges and agrees that interior renovations to increase the number of bedrooms or an increase in living space shall not be permitted without approval from the County.

IN WITNESS WHEREOF, the parties have signed and sealed this agreement on the date indicated above.

Brian Isaac 5/13/2014
Owner Brian Isaac Date

Owner

Date

Paul Nelson 5/14/2014
Howard County Health Department

LG - Agreement
Recording Fee 20.00
County/Notary Name:
Isaac/Howard County
Health Dept.
Reference/Control #:
45
LG - Agreement
Signature 40.00
Subtotal: 60.00
Total: 80.00
05/28/2014 01:00
0018-YB
#2239418 C0502 -
Howard Co
Column 14/0005.00.05 -
Register W5

**TRACE LABORATORIES, INC**

5 North Park Drive
Hunt Valley, MD 21030 USA
Telephone: 410/584-9099 / Fax: 410/584-9117
Website: www.tracelabs.com / Email: info@tracelabs.com

Maryland State Certified Laboratory #318

CERTIFICATE OF ANALYSIS**Requester:**

Patton Homes
10 Venture Way, Suite A
Sykesville, Maryland 21784

S/O Number: 97817**Report Date:** January 22, 2015

Property Sampled: 13936 Rover Mill Road, 21794
Sample Location: Pressure Tank Tap
Residual Chlorine: <0.1 mg/L

Building Permit #: B13002990
Sampler ID #: 7483AM
Samples Iced: Yes

County: Howard**Subdivision:** Rover Meadows**Lot #:** 13**Date/Time Collected in Field:** January 21, 2015 11:46 am**Date/Time Received in Lab:** January 21, 2015 1:20 pm**Well Tag #:** HO-95-2423**Well Condition:** 2-Piece Cap, 1 Bolt Missing, Cap Tight**Water Treatment/Conditioning:** None

| PARAMETER | METHOD | MCL/*SMCL | RESULT | COMMENT |
|----------------|--------------------------|----------------|----------------|---------|
| Total Coliform | SM 9223B | Absent | Absent | Pass |
| <i>E. coli</i> | SM 9223B | Absent | Absent | Pass |
| Nitrate | SM 4500-NO3D | 10 mg/L as N | <1.0 mg/L as N | Pass |
| Turbidity | EPA 180.1 | 10 NTU | 4.1 NTU | Pass |
| pH (Field) | SM 4500-H ⁺ B | *6.5-8.5 Units | 7.0 Units | *** |
| Sand | | Absent | Absent | Pass |

The results in this report relate only to those items tested. If any additional information or clarification of this report is required, please contact us. This test report shall not be reproduced except in full without the written approval of Trace Laboratories Inc.

Katherine C. Higgs
Manager – Drinking Water Testing

MCL: Maximum Contamination Level, an enforceable level established by the EPA

*SMCL: Secondary Maximum Contamination Level, a level recommended by the EPA

***A non-enforceable parameter that may cause cosmetic effects or aesthetic effects (such as taste, color or odor) in drinking water.



Bureau of Environmental Health
 7178 Columbia Gateway Drive, Columbia, MD 21046-2147
 (410) 313-2640 Fax (410) 313-2648
 TDD (410) 313-2323 Toll Free 1-866-313-6380
 website: www.hchd.org

Peter L. Beilenson, M.D., M.P.H., Health Officer

TO ALL INTERESTED PARTIES

When submitting a well permit application for a proposed well for new construction, please indicate one of the following:

Well Site Location:

Rover Meadows # 13 13940 Rover Mill RD
 Subdivision/Property Name Lot# Road Name

☒ The well site has been staked by Robert H. Vogel Engineering
 (professional land surveyor or company employing professional land surveyors)
 on 10-3-12 (date) and does not require a site inspection.

☐ The well driller, builder or property owner will call the Health Department to schedule a time to meet in the field to verify the proposed well site location.

This sheet, along with two copies of an acceptable well site plan, must be attached to the green well permit application.

Revised 3/11/05

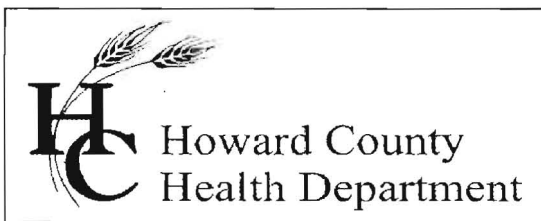

Bureau of Environmental Health

8930 Stanford Blvd., Columbia, MD 21045
Main: 410-313-2640 | Fax: 410-313-2648
TDD 410-313-2323 | Toll Free 1-866-313-6300
www.hchealth.org
Facebook: www.facebook.com/hocohealth
Twitter: HowardCoHealthDep

Maura J. Rossman, M.D., Health Officer

INTERIM CERTIFICATE OF POTABILITY

Expiration Date – August 10, 2015

February 10, 2015

Homeowner
13936 Rover Mill Road
W. Friendship, MD 21794

**RE: Rover Meadows, Lot 13
13936 Rover Mill Road
Building Permit: B13002990
Well Permit: HO-95-2423**

Dear Homeowner:

This is to advise you that the septic system installation and water well construction for the above referenced property have been inspected and approved. Final approval of the septic system was granted on **2/4/2015**. Final approval of the well line connection to the dwelling was granted on **7/24/2014**. The well construction was completed on **12/7/2012**. Water samples were collected on **1/21/2015**.

The water sample results indicate that the water samples submitted for testing were free of coliform and fecal coliform bacteria at the time of sampling and are bacteriologically safe for drinking. This certifies that the initial sampling requirements of COMAR 26.04.04 "Well Regulations" have been met for the water supply system installed under well permit HO-95-2423. Although the submitted sample results are in compliance with COMAR standards, the Health Department does not guarantee water supplies.

This Interim Certificate of Potability will expire **six months** from the date of issuance. Submission of a second bacteriological test indicating the water is free of coliform and fecal coliform bacteria is required prior to the expiration date, after which time a Final Certificate of Potability will be issued. **Failure to submit an additional sample and obtain a Final Certificate of Potability will result in a Notice of Violation and is punishable as a misdemeanor under the Annotated Code of Maryland, Environment Article, 9-1311, subject to a fine of up to \$500 or imprisonment not to exceed three months.**

Please contact (410) 313-1773 to schedule a final water sample appointment or contact a Maryland certified water laboratory to schedule a water sample. A list of laboratories certified by the state of Maryland may be found at the following website:

<http://www.mde.state.md.us/assets/document/WSP-Labs-2010apr16.pdf>

Approving Authority,

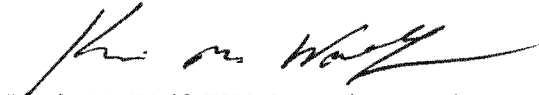
A handwritten signature in dark ink, appearing to read 'Kevin M. Wolf', written over a horizontal line.

Kevin M. Wolf, EHS Supervisor
Environmental Sanitarian
Well & Septic Program

cc: Howard County Dept. of Inspections, Licenses, and Permits
Community Hygiene Program
File