

LAYOUT 2/8/13 Kw INSP 4 _____
INSP 2 3/15/13 INSP 5 _____
INSP 3 3/18/13 INSP 6 _____

ISSUE DATE: 12-11-12

PERMIT

P 544427

APPROVAL DATE: 4/1/2013

A _____

Tax ID #05- 594009

**ON-SITE SEWAGE DISPOSAL SYSTEM
HOWARD COUNTY HEALTH DEPARTMENT
BUREAU OF ENVIRONMENTAL HEALTH**

Cof Excavating (New Contractor) IS PERMITTED TO INSTALL ☒ ALTER ☐

ADDRESS: _____ PHONE NUMBER: _____

SUBDIVISION: St. Paul's Lutheran Church Property LOT NUMBER: 1

ADDRESS: 8140 Stabean Drive PROPERTY OWNER: Rich and Jenn Tayag

SEPTIC TANK CAPACITY (GALLONS): 2000 OUTLET BAFFLE FILTER REQUIRED ☐

PUMP CHAMBER CAPACITY (GALLONS): _____ COMPARTMENTED TANK REQUIRED ☒

NUMBER OF BEDROOMS: 4 APPLICATION RATE: 0.8

SQUARE FOOTAGE OF HOUSE: ±3500

LINEAR FEET OF TRENCH REQUIRED: 155'

*Inlet 4.5' 2' wide
Bottom 8'
3x60' trenches (Kw)*

TRENCHES:	Trenches to be 3.0 feet wide. Inlet is at 4.0 feet below original grade with 3.0 feet of stone below the distribution pipe. Bottom maximum depth is 7.0 feet below original grade. Effective sidewall begins at 5.0 feet below original grade. Maintain at least 9.0 feet of spacing between trenches. <i>~ 9' for</i>
LOCATION:	Set septic tank per plan. Set distribution box per plan. Install 2 x 78' trenches on contour. Ejector pump required in basement for gravity service.
NOTES:	Do not order the septic tank until after layout inspection and Sanitarian approval. Stake easement corners. Call for layout inspection. Mark utilities. Gravel tickets must be available for Environmental Sanitarians. Stone must be approved by the Howard County Health Department. A written variance request is required for tanks deeper than 3 feet. A traffic bearing lid is required for tanks deeper than 4 feet.

PLANS APPROVED: Heidi Scott DATE: 8/2/12

NOTE: PERMIT VOID AFTER 2 YEARS
NOTE: CONTRACTOR RESPONSIBLE FOR SCHEDULING A PRE-CONSTRUCTION INSPECTION FOR ALL INSTALLATIONS
NOTE: WATERTIGHT SEPTIC TANKS REQUIRED
NOTE: ALL PARTS OF SEPTIC SYSTEM SHALL BE 100 FEET FROM ANY WATER WELL
NOTE: MANHOLE RISERS REQUIRED ON ALL SEPTIC TANKS AND PUMP CHAMBERS

**NEITHER THE HOWARD COUNTY COUNCIL OR THE HEALTH DEPARTMENT IS RESPONSIBLE FOR
THE SUCCESSFUL OPERATION OF ANY SYSTEM
PERMITTEE RESPONSIBLE FOR OBTAINING FINAL APPROVAL ON THIS PERMIT
CALL 410-313-1771 FOR INSPECTION OF SEPTIC SYSTEM**

NOT TO SCALE

See Separate Sheet
for As-Built

ROAD NAME

TRENCH/DRAINFIELD DATA

WIDTH 2' INLET 35'4' BOTTOM, 7.5'-8'
NUMBER OF TRENCHES 3
TOTAL LENGTH 184'
ABSORPTION AREA 552
DISTRIBUTION BOX LEVEL Levelers
DISTRIBUTION BOX BAFFLE Yes
DISTRIBUTION BOX PORT Yes

SEPTIC TANK DATA

SEPTIC TANK 1 LEVEL Yes
MANUFACTURER Babylon
CAPACITY 2000 GAL
SEAM LOC Top
TANK LID DEPTH 0.5'-2.5'
BAFFLES Yes
BAFFLE FILTER No
MANHOLE LOC Front + Rear
6" PORT LOC None
WATERTIGHT TEST No
SLOTTED Yes
DATE ON LID Dry

~~PUMP/SEPTIC TANK LEVEL N/A~~

~~MANUFACTURER
CAPACITY GAL
SEAM LOC
TANK LID DEPTH
BAFFLES
BAFFLE FILTER
MANHOLE LOC
6" PORT LOC
WATERTIGHT TEST
SLOTTED
DATE ON LID~~

PRE-CONSTRUCTION:

2/8/13 Met contractor on site. Never done septic in Ho Co before. Briefly went over required reg's. Did not have laser level w/ him. Have tank location. Sewer not coming out of house as shown on bp plan. OK to set S.T. just off of proposed drive. Keep away from area of proposed new garden (KJ)

INSTALLATION: 3/15/2013 Need tank cleanouts. Plumbing from house to dist. box is finished. Starting on top trench. Trench layout done. (BB)

3/18/2013 System finished except for rear tank cleanout. (BB)

4/1/2013 Rear cleanout installed. (BB)

FINAL INSPECTOR

B. Baker

DATE OF APPROVAL

4/1/2013

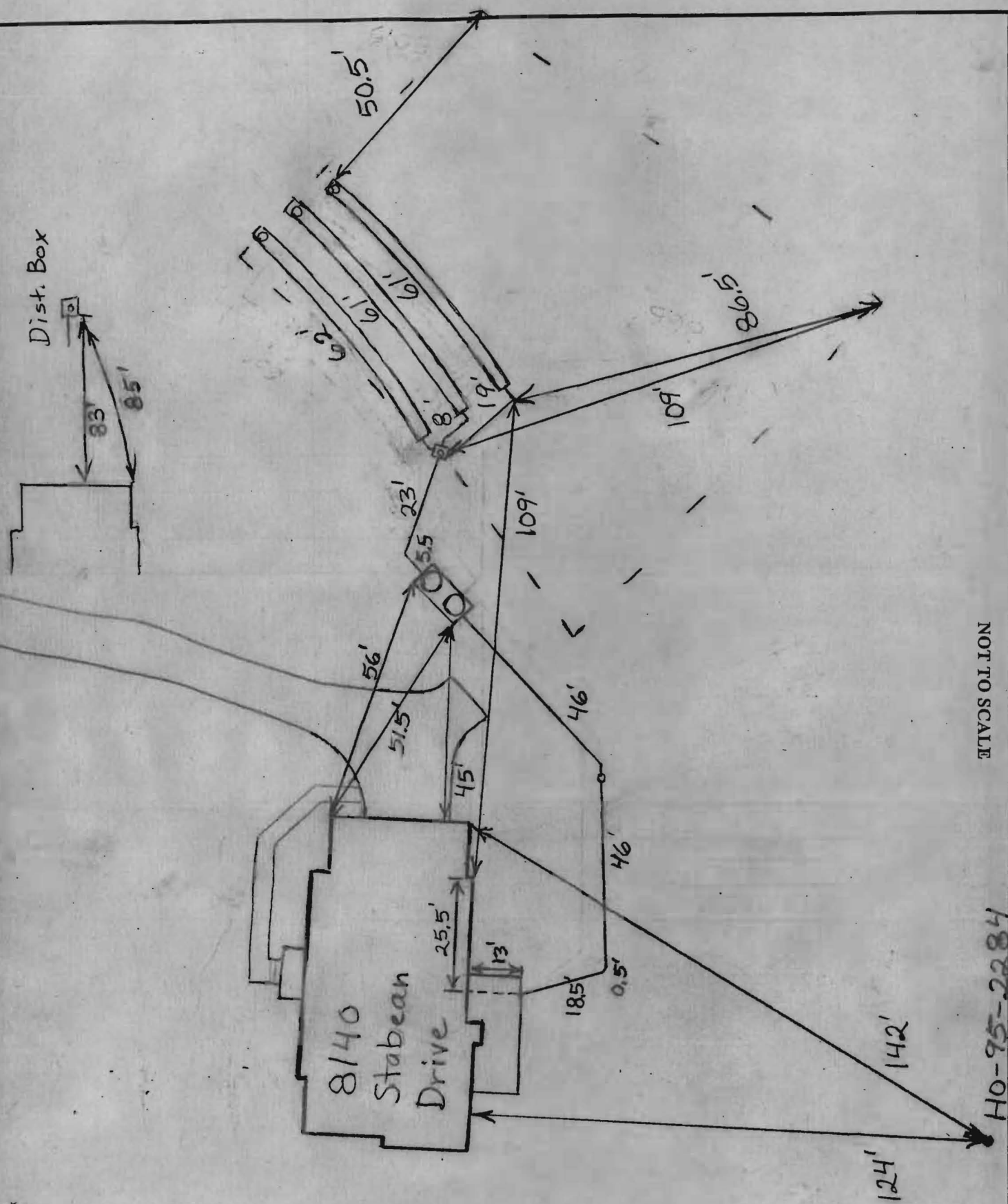

IND. STATE CRID MAD '63/61

2002 22

Wall
check OK
12-11-12
DZ
FOREST

FOREST
CONSERVATION
EASEMENT

SEE
INSET

12.7' 31.9' 12.5' 4.0' 48.0' 12.0' 2.0' 18.9' 2.0' 19.0' 24.6' 0.8' 2.8' 5.0'

CONCRETE FOUNDATION
TOP OF WALL ELEV. = 459.4 ±

FEE = 2

INSET
 $1'' = 50'$

B.R.L.'S SHOWN HEREON PER HOUSE SITING PLOT PLAN.
SETBACK DISTANCES SHOWN HEREON AS "±" HAVE AN ACCURACY OF ±0.1' FOOT.

GLW GUTSCHICK LITTLE & WEBER, P.A.

CIVIL ENGINEERS, LAND SURVEYORS, LAND PLANNERS, LANDSCAPE ARCHITECTS
3909 NATIONAL DRIVE - SUITE 250 - BURTOWNSVILLE OFFICE PARK
BURTOWNSVILLE, MARYLAND 20866
TEL: 301-421-4024 BALT: 410-880-1820 DC/VA: 301-989-2524 FAX: 301-421-4186

THE PROPERTY SHOWN HEREON LIES WITHIN ZONE C (AREA OF MINIMAL FLOODING) AS SHOWN ON THE F.E.M.A. FLOOD INSURANCE RATE MAP, COMMUNITY PANEL No. 240044 0042 B, REVISED DECEMBER 4, 1986.

REFERENCE : PLAT No. 21966

DATE OF LATEST FIELD WORK: 10-09-12

DRAWN BY : *SDS*

SCALE : $1'' = 100'$

G.L.W. FILE No. **12046**

THIS IS TO CERTIFY TO:
"BATTAGLIA HOMES LLC".

THAT TO THE BEST OF MY KNOWLEDGE, INFORMATION AND BELIEF,
THE POSITION OF THE ABOVE REFERENCED BUILDING FOUNDATION
HAS BEEN ESTABLISHED BY ACCEPTED FIELD PRACTICES.

For Gutschick, Little and Weber, P.A. :
Thomas C. O'Connor, Jr.,
Professional Land Surveyor, No. 10954 (EXP. DATE: 07/03/2014)

THIS WALLCHECK IS VALID ONLY WITH AN ORIGINAL SIGNATURE AND EMBOSSED SEAL OF THE ABOVE SURVEYOR

WALLCHECK (SPECIAL PURPOSE SURVEY)

"ST. PAUL'S LUTHERAN
CHURCH PROPERTY"
LOT 1
8140 STABEAN DRIVE

HOWARD COUNTY, MARYLAND

We are an Equal Opportunity Employer

SAVAGE STONE, LLC

SAVAGE, MARYLAND

Mailing Address: P.O. Box 850, Laurel, Maryland 20725

DISPATCH / SALES
301-953-8973
410-792-3753

INSPECTOR'S COPY

BILLING INQUIRIES
301-953-7650
410-792-7234

TICKET # 6664094

STATION 59

DATE 03/15/13 TIME 13:09:20

CUSTOMER WILLCO
WILLIS CONCRETE
10964 GUILFORD RD
ANNAPOLIS JUNCT, MD 20701

TRUCK 142A LICENSE
DRIVER: W.L. PARHAM

3 AXLES

JOB STABEA : STABEAN DR
P.O. # PROJECT #: JOHN 410-913-6408
32W-298-216W GO ABOUT 1MILE
L- MURPHY RD JUST PAST SCHOOL
R-8140 STABEAN DR.
BACK DOWN DRIVEWAY

	SCALE A	
GROSS	69540 lb	
TARE IN (STORED)	26560 lb	
NET	42980 lb	
NET	21.49 t	

	Loads	Tons
DAILY	3	63.79
TOTAL	4	85.44
TIME IN 13:09:20		TIME OUT 13:09:20

MAT'L 0022 : MD #2 STONE
HAUL ZONE HC03

WEIGHMASTER

Gail Harrison

RECEIVED BY

SAFETY FIRST! HAVE A GREAT DAY! PLEASE CHECK YOUR TICKET!

We are an Equal Opportunity Employer

Savage Stone, LLC

Savage, Maryland

Mailing Address: P.O. Box 850, Laurel, Maryland 20725

DISPATCH / SALES
301-953-8973
410-792-3753

INSPECTOR'S COPY

BILLING INQUIRIES

TICKET # 664161

301-953-7850

410-792-7234

STATION SS

DATE 03/15/13 TIME 14:13:06

CUSTOMER WILLCO

WILLIS CONCRETE

10964 BUILFORD RD

ANNAPOLIS JUNCT, MD 20701

TRUCK 126A LICENSE

DRIVER: MEC TRUCKING -ARTIE

3 AXLES

GROSS

SCALE A

69860 lb

TARE

IN

(STORED)

25000 lb

NET

44860 lb

NET

22.43 t

JOB STABEA : STABEAN DR

P.O. # PROJECT #: JOHN 410-913-6408

32W-29S-216W 60 ABOUT 1MILE

L- MURPHY RD JUST PAST SCHOOL

R-8140 STABEAN DR.

BACK DOWN DRIVEWAY

Loads

Tons

DAILY

4

86.22

TOTAL

5

108.87

TIME IN 14:13:06

TIME OUT 14:13:06

MAT'L 0022 : MD #2 STONE

HAUL ZONE HC03

WEIGHMASTER

Gail Harrison

RECEIVED BY

SAFETY FIRST! HAVE A GREAT DAY! PLEASE CHECK YOUR TICKET!

We are an Equal Opportunity Employer

SAVAGE STONE, LLC

SAVAGE, MARYLAND

Mailing Address: P.O. Box 850, Laurel, Maryland 20725

DISPATCH / SALES

301-953-8973

410-792-3753

INSPECTOR'S COPY

BILLING INQUIRIES

301-953-7650

410-792-7234

TICKET #00654047

STATION SS

DATE 03/15/13 TIME 12:16:34

CUSTOMER WILLCO

WILLIS CONCRETE

10964 GUILFORD RD

ANNAPOLIS JUNCT, MD 20701

TRUCK 140A LICENSE

3 AXLES

DRIVER: D M B TRUCKING

JOB STABEA : STABEAN DR

P.O. # PROJECT #: JOHN 410-913-6408

32W-299-216W GO ABOUT 1MILE

L- MURPHY RD JUST PAST SCHOOL

R-8140 STABEAN SR.

BACK DOWN DRIVEWAY

GROSS	SCALE A	69180 lb
TARE	IN (STORED)	23760 lb
NET		45420 lb
NET		22.71 t

	Loads	Tons
DAILY	1	22.71
TOTAL	2	45.36
TIME IN 12:16:34		TIME OUT 12:16:34

MAT'L 0022 : MD #2 STONE

HAUL ZONE HC03

WEIGHMASTER

Gail Harrison

RECEIVED BY

SAFETY FIRST! HAVE A GREAT DAY! PLEASE CHECK YOUR TICKET!

We are an Equal Opportunity Employer

SAVAGE STONE, LLC

SAVAGE, MARYLAND

Mailing Address: P.O. Box 850, Laurel, Maryland 20725

DISPATCH / SALES
301-953-8973
410-792-3753

INSPECTOR'S COPY

BILLING INQUIRIES
301-953-7650
410-792-7234

TICKET # 066489

STATION 5

DATE 03/15/13 TIME 13:03:5

CUSTOMER WILLCO
WILLIS CONCRETE
10964 GUILFORD RD
ANNAPOLIS JUNCT, MD 20701

TRUCK 940A LICENSE
DRIVER: HENDERSON PHILLIPS

3 AXLES

JOB STABEA : STABEAN DR
P.O. # PROJECT #: JOHN 410-913-6408
32W-29S-216W GO ABOUT 1MILE
L- MURPHY RD JUST PAST SCHOOL
R-0140 STABEAN DR.
BACK DOWN DRIVEWAY

GROSS	SCALE A	68000 lb
TARE	IN (STORED)	28900 lb
NET		39100 lb
NET		19.59 t

	Loads	Tons
DAILY	2	42.30
TOTAL	3	64.95
TIME IN 13:03:56		TIME OUT 13:03:5

MAT'L 0022 : MD #2 STONE
HAUL ZONE HC03

WEIGHMASTER

Gail Harrison

RECEIVED BY

SAFETY FIRST! HAVE A GREAT DAY! PLEASE CHECK YOUR TICKET!