

LAYOUT _____ INSP 4 _____
INSP 2 9/6/2013 INSP 5 _____
INSP 3 _____ INSP 6 _____

ISSUE DATE:

8/19/13
~~8/19/13~~

PERMIT

P 544462

APPROVAL DATE:

9/6/2013

A upgrade

Tax ID # 03-320863

**ON-SITE SEWAGE DISPOSAL SYSTEM
TANK REPLACEMENT
HOWARD COUNTY HEALTH DEPARTMENT
BUREAU OF ENVIRONMENTAL HEALTH**

Fogles Septic Clean Inc.

IS PERMITTED TO

INSTALL ☒ ALTER ☐

ADDRESS: 580 Obrecht Road PHONE NUMBER: 410-795-5670

SUBDIVISION: Quarterfield LOT NUMBER: Par 3A

ADDRESS: 3720 Running Springs Court PROPERTY OWNER: Syrakes Shah

SEPTIC TANK CAPACITY (GALLONS): 2000 OUTLET BAFFLE FILTER REQUIRED ☐

PUMP CHAMBER CAPACITY (GALLONS): _____ COMPARTMENTED TANK REQUIRED ☒

NUMBER OF BEDROOMS: _____ APPLICATION RATE: _____

SQUARE FOOTAGE OF HOUSE: _____

LINEAR FEET OF TRENCH REQUIRED: _____

NOTES:

Do not order the septic tank until after layout inspection and Sanitarian approval. Layout inspection required prior to tank installation. Original septic tank must be properly abandoned before new tank installation. A written variance request is required for tanks deeper than 3 feet. A traffic bearing lid is required for tanks deeper than 4 feet.

PLANS APPROVED:

RB

DATE: _____

NOTE: PERMIT VOID AFTER 2 YEARS

NOTE: CONTRACTOR RESPONSIBLE FOR SCHEDULING A PRE-CONSTRUCTION INSPECTION FOR ALL INSTALLATIONS

NOTE: WATERTIGHT SEPTIC TANKS REQUIRED

NOTE: ALL PARTS OF SEPTIC SYSTEM SHALL BE 100 FEET FROM ANY WATER WELL

NOTE: MANHOLE RISERS REQUIRED ON ALL SEPTIC TANKS AND PUMP CHAMBERS

**NEITHER THE HOWARD COUNTY COUNCIL OR THE HEALTH DEPARTMENT IS
RESPONSIBLE FOR THE SUCCESSFUL OPERATION OF ANY SYSTEM
PERMITTEE RESPONSIBLE FOR OBTAINING FINAL APPROVAL ON THIS PERMIT
CALL 410-313-1771 FOR INSPECTION OF SEPTIC SYSTEM**

NOT TO SCALE

See As-Built Drawing On
Separate Sheet

ROAD NAME

PRE-CONSTRUCTION:

INSTALLATION: 9/6/2013 New tank set to replace existing 1500
gallon tank, O.K. to backfill. (PB)

FINAL INSPECTOR

B. Baker

DATE OF APPROVAL

9/6/2013

TRENCH/DRAINFIELD DATA

WIDTH INLET BOTTOM

NUMBER OF TRENCHES

TOTAL LENGTH

ABSORPTION AREA

DISTRIBUTION BOX LEVEL

DISTRIBUTION BOX BAFFLE

DISTRIBUTION BOX PORT

SEPTIC TANK DATA

SEPTIC TANK 1 LEVEL Yes

MANUFACTURER Babylon

CAPACITY 2000 GAL

SEAM LOC Top

TANK LID DEPTH 25-1.5'

BAFFLES Yes

BAFFLE FILTER No

MANHOLE LOC Front + Rear

6" PORT LOC None

WATERTIGHT TEST No

SLOTTED Yes

DATE ON LID 7/4/2013

PUMP/SEPTIC TANK LEVEL N/A

MANUFACTURER

CAPACITY GAL

SEAM LOC

TANK LID DEPTH

BAFFLES

BAFFLE FILTER

MANHOLE LOC

6" PORT LOC

WATERTIGHT TEST

SLOTTED

DATE ON LID

Running Springs Road

HO-94-2203

309'

3720 Running
Springs Road

2014
Addition

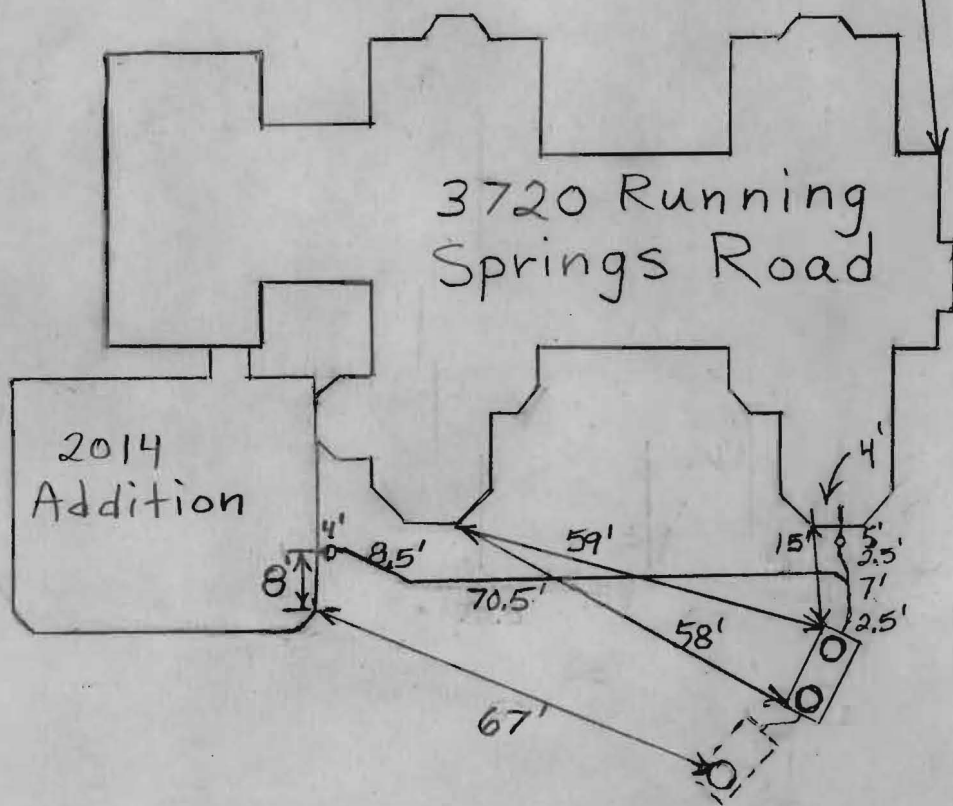



Howard County
Health Department

Bureau of Environmental Health
7178 Gateway Drive Columbia, MD 21046
(410) 313-2640 Fax (410) 313-2648
TDD (410) 313-2323 Toll Free 1-866-313-6300
website: www.hchealth.org

Maura J. Rossman, M.D., Health Officer

RECEIPT DATE: 5/30/2014

ONSITE SEWAGE DISPOSAL SYSTEM

P 546380

INSTALLATION
APPROVAL DATE: 6/2/2014

PERMIT

A _____

SEWER HOUSE CONNECTION

PROPERTY ADDRESS: 3720 Running Springs Road, Ellicott City, MD 21042

SUBDIVISION: Quarterfield, Section 2 LOT: 3A TAX ID: 1403320863

CONTRACTOR: Sterling Homes, Inc. EMAIL: Scotthare01@gmail.com

CONTRACTOR ADDRESS: 20901 New Hampshire Ave., Brookeville, MD 20833 PHONE: 4109487046

PROPERTY OWNER: Charles Shah EMAIL: cshah@cstaff.com

OWNER ADDRESS: 3720 Running Springs Road, Ellicott City, MD 21042 PHONE: _____

NUMBER OF BEDROOMS: 1 HOUSE SQ. FT. 1500 CONNECTED TO PUBLIC WATER: ☐ YES ☒ NO

LOCATION:	INSTALL 4" SEWER LINE PER APPROVED SITE PLAN.
NOTES:	Connect discharge from addition to septic system. Install cleanouts at bends and at wye connection in existing SHC (before septic tank. Install cleanout in SHC run of more than 70 feet.

ISSUED BY: Robert Bricker ISSUE DATE: 5/30/2014 EXPIRATION DATE: 5/30/2015

NOTE: CONTRACTOR MUST SCHEDULE AN INSPECTION AND GAIN APPROVAL OF ALL COMPONENTS PRIOR TO COVERING
NOTE: AN ELECTRICAL PERMIT IS REQUIRED FOR INSTALLATION OF ANY ELECTRICAL COMPONENTS OF THE SYSTEM

NEITHER THE HOWARD COUNTY COUNCIL NOR THE HEALTH DEPARTMENT IS RESPONSIBLE
FOR THE SUCCESSFUL OPERATION OF ANY SYSTEM.
PERMITTEE RESPONSIBLE FOR OBTAINING FINAL APPROVAL ON THIS PERMIT.
CALL 410-313-1771 FOR INSPECTION OF SEPTIC SYSTEM.

NOT TO SCALE

See As-Built On
Additional Sheet

ROAD NAME

TRENCH/DRAINFIELD DATA

WIDTH INLET BOTTOM

NUMBER OF TRENCHES _____
TOTAL LENGTH _____
ABSORPTION AREA _____
DISTRIBUTION BOX LEVEL _____
DISTRIBUTION BOX BAFFLE _____
DISTRIBUTION BOX PORT _____

SEPTIC TANK DATA

SEPTIC TANK 1 LEVEL _____
MANUFACTURER _____
CAPACITY _____ GAL
SEAM LOC _____
TANK LID DEPTH _____
BAFFLES _____
BAFFLE FILTER _____
MANHOLE LOC _____
6" PORT LOC _____
WATERTIGHT TEST _____
SLOTTED _____
DATE ON LID _____

PUMP/SEPTIC TANK LEVEL _____
MANUFACTURER _____
CAPACITY _____ GAL
SEAM LOC _____
TANK LID DEPTH _____
BAFFLES _____
BAFFLE FILTER _____
MANHOLE LOC _____
6" PORT LOC _____
WATERTIGHT TEST _____
SLOTTED _____
DATE ON LID _____

PRE-CONSTRUCTION:

INSTALLATION: 6/2/2014 Connection made from addition to
4" pipe before septic tank BB

FINAL INSPECTOR

B. Baker

DATE OF APPROVAL

6/2/2014

EXISTING SEPTIC
AREA 14,365 A
NEW ADDITIONAL
SEPTIC RESERVE
AREA 7,582

EASE AND
SENTENCE

ALTERNATE
WELL LOCATION
(2) TOTAL

Health Officer, Howard County Health. Dept. *MS* Date *6/26/13*

THIS PLAN DESIGNATES
20,000 ~~sq~~ + OF SEPTIC
RESERVE AREA PLUS 2
ALTERNATE WELL LOCATIONS
REQUIRED FOR THE CONSTRUCTION OF THE NEW ADDITION
"ACCESSORY APARTMENT".

-  “This area designates a private sewage disposal area of at least 10,000 sq. ft. as required by the Maryland Department of Environment for individual sewage disposal. Improvements of any nature in this area are restricted. This sewage disposal area shall become null and void upon connection to a public sewerage system. The County Health Officer shall have authority to grant adjustments to the private sewage easement Recordation of a revised sewage easement shall not be necessary.”
- Any changes to a private sewage easement shall require a revised percolation certification
- All wells and septic systems located within 100’ of the property boundaries and 200’ down gradient of any wells and/or septic systems have been shown

DAVID K. SADLER
PRESIDENT
EATBLING HOMES

6-19-13
DATE

NOTE: ADDITION
PLUMBING TO BE
CONNECTED TO
EXISTING HOUSE
PLUMBING ON
INTERIOR OF
HOME

SHAH
ADDITION
3720
RUNNING
SPRINGS RD.

PROPOSED
ADDITION

SCALE:
1" = 50'

~~Approved Public System Plan~~
~~Howard County Health Department~~

PRESERVATION PA
SINGLE RESIDENT
CONSERVATION
162,044 \$.

