



Building Permit Application

Howard County Maryland
Department of Inspections, Licenses and Permits
3430 Court House Drive
Permits: 410-313-2455
www.howardcountymd.gov

Date Received: _____

Permit No.: B13003082

Building Address: 3181 River Valley Chase
City: West Friendship State: MD Zip Code: 21794
Suite/Apt. #: _____ SDP/WP/BA #: _____
Census Tract: _____ Subdivision: _____
Section: _____ Area: _____ Lot: 12
Tax Map: 15 Parcel: 42 Grid: 16
Zoning: _____ Map Coordinates: _____ Lot Size: 1.19 Acres

Existing Use: Residential (Single family home)
Proposed Use: SFH w/ 2 car garage, covered breezeway
Estimated Construction Cost: \$ 125,000.00
Description of Work: Construct 2 car garage with covered breezeway and porch
garage w/ 1,115 sq ft of covered porch/patio

Occupant or Tenant: Robert Coleman
Was tenant space previously occupied? ☒ Yes ☐ No
Contact Name: Robert Coleman
Address: 3181 River Valley Chase
City: West Friendship State: MD Zip Code: 21794
Phone: 410-489-0454 Fax: _____
Email: _____

Property Owner's Name: Robert Coleman
Address: 3181 River Valley Chase
City: West Friendship State: MD Zip Code: 21794
Phone: 410-489-0454 Fax: _____
Email: _____

Applicant's Name & Mailing Address, (if other than stated herein)
Applicant's Name: Nichole Tiede
Address: 11 Ivy Bridge Ct
City: Reisterstown State: MD Zip Code: 21136
Phone: 410-277-3191 Fax: 410-833-0136
Email: nichole@ctcontractinginc.com

Contractor Company: CT Contracting Inc
Contact Person: Chris Tiede
Address: 11 Ivy Bridge Ct
City: Reisterstown State: MD Zip Code: 21136
License No.: 87154
Phone: 410-277-2970 Fax: 410-833-0136
Email: chris@ctcontractinginc.com

Engineer/Architect Company: JRA Architecture
Responsible Design Prof.: Jonathan Rivera
Address: 1242 Morgan Station Rd
City: Woodhine State: MD Zip Code: 21797
Phone: 443-226-5745 Fax: _____
Email: _____

Commercial Building Characteristics	Residential Building Characteristics
Height:	<input checked="" type="checkbox"/> SF Dwelling <input type="checkbox"/> SF Townhouse
No. of stories:	Depth Width
Gross area, sq. ft./floor:	1 st floor:
	2 nd floor:
Area of construction (sq. ft.):	Basement:
	<input type="checkbox"/> Finished Basement
Use group:	<input type="checkbox"/> Unfinished Basement
	<input type="checkbox"/> Crawl Space
Construction type:	<input type="checkbox"/> Slab on Grade
<input type="checkbox"/> Reinforced Concrete	No. of Bedrooms:
<input type="checkbox"/> Structural Steel	Multi-family Dwelling
<input type="checkbox"/> Masonry	No. of efficiency units:
<input type="checkbox"/> Wood Frame	No. of 1 BR units:
<input checked="" type="checkbox"/> State Certified Modular	No. of 2 BR units:
	No. of 3 BR units:
	Other Structure:
	Dimensions:
Roadside Tree Project Permit	Footings:
<input type="checkbox"/> Yes <input checked="" type="checkbox"/> No	Roof:
Roadside Tree Project Permit #	<input type="checkbox"/> State Certified Modular
	<input type="checkbox"/> Manufactured Home

Utilities
Water Supply
<input type="checkbox"/> Public
<input checked="" type="checkbox"/> Private
Sewage Disposal
<input type="checkbox"/> Public
<input checked="" type="checkbox"/> Private
Electric: <input checked="" type="checkbox"/> Yes <input type="checkbox"/> No
Gas: <input type="checkbox"/> Yes <input checked="" type="checkbox"/> No
Heating System
<input checked="" type="checkbox"/> Electric <input type="checkbox"/> Oil
<input type="checkbox"/> Natural Gas <input type="checkbox"/> Propane Gas
<input type="checkbox"/> Other:
Sprinkler System:
<input type="checkbox"/> Yes <input checked="" type="checkbox"/> No
Grading Permit Number:
Building Shell Permit Number:

THE UNDERSIGNED HEREBY CERTIFIES AND AGREES AS FOLLOWS: (1) THAT HE/SHE IS AUTHORIZED TO MAKE THIS APPLICATION; (2) THAT THE INFORMATION IS CORRECT; (3) THAT HE/SHE WILL COMPLY WITH ALL REGULATIONS OF HOWARD COUNTY WHICH ARE APPLICABLE THERETO; (4) THAT HE/SHE WILL PERFORM NO WORK ON THE ABOVE REFERENCED PROPERTY NOT SPECIFICALLY DESCRIBED IN THIS APPLICATION; (5) THAT HE/SHE GRANTS COUNTY OFFICIALS THE RIGHT TO ENTER ONTO THIS PROPERTY FOR THE PURPOSE OF INSPECTING THE WORK PERMITTED AND POSTING NOTICES.

Applicant's Signature: Nichole Tiede
Email Address: nichole@ctcontractinginc.com

Print Name: Nichole Tiede
Date: 8/8/13

* Health: R. Buehler 10/1/2013

3181 River Valley Chase
West Friendship, MD 21794

B# B1300382

SETBACKS:

REAR PL 6'
SIDE PL 6'
HOUSE 0'
SEPTIC 20'
WELL 20'

PRIVATE WELL
& SEPTIC

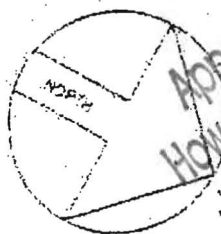

Approved Septic System Plan
Howard County Health Department
B1300382

Garage & concrete porch
approved as shown
10/4/13
Date
P-dox, 10/1/13
approved in
signature

REVISED

Date: 9/30/13

Comments: B1300382

Relocated Septic
Per Health

1015 S&P 8" RCP
RINGS CONCRETE
DECK (BY MP)

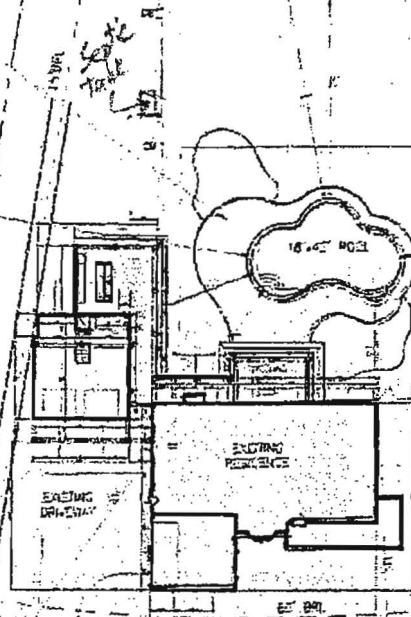

USE 1 1/2" 48" HIGH
ALUMINUM FENCE TO
CODE BY OWNER

FILTER EQUIPMENT
LOCATION

#3181

RIVER VALLEY CHASE

50 R/W

SITE PLAN

1" = 30'

1" = 50' ± 10%