



# Building Permit Application

Howard County Maryland  
Department of Inspections, Licenses and Permits  
3430 Court House Drive  
Permits: 410-313-2455  
www.howardcountymd.gov

Date Received: \_\_\_\_\_

Permit No.: \_\_\_\_\_

Building Address: 12926 Wexford Park  
City: Clarksville State: MD Zip Code: 21029  
Suite/Apt. #: \_\_\_\_\_ SDP/WP/BA #: \_\_\_\_\_  
Census Tract: \_\_\_\_\_ Subdivision: \_\_\_\_\_  
Section: \_\_\_\_\_ Area: \_\_\_\_\_ Lot: 15  
Tax Map: 0034 Parcel: 0261 Grid: 0009  
Zoning: \_\_\_\_\_ Map Coordinates: \_\_\_\_\_ Lot Size: 3.0800 AC  
Existing Use: Residential Home  
Proposed Use: \_\_\_\_\_  
Estimated Construction Cost: \$ 30,000.00  
Description of Work: 22' x 43' Inground Pool  
20x40' stone Patio  
Occupant or Tenant: Owner  
Was tenant space previously occupied? ☐ Yes ☐ No  
Contact Name: Henrich Werner  
Address: 12926 Wexford Park  
City: Clarksville State: MD Zip Code: 21029  
Phone: \_\_\_\_\_ Fax: \_\_\_\_\_  
Email: \_\_\_\_\_

Property Owner's Name: Henrich Werner  
Address: 12926 Wexford Park  
City: Clarksville State: MD Zip Code: 21029  
Phone: 410-963-1943 Fax: \_\_\_\_\_  
Email: \_\_\_\_\_  
Applicant's Name & Mailing Address, (If other than stated herein)  
Applicant's Name: Harry Hyland  
Address: 1704 Old Generals Hwy  
City: Annapolis State: MD Zip Code: 21401  
Phone: 410-963-1943 Fax: \_\_\_\_\_  
Email: hyland@olmo-bros.com  
Contractor Company: Olmo Brothers Landscaping  
Contact Person: Harry Hyland  
Address: 1704 Old Generals Hwy  
City: Annapolis State: MD Zip Code: 21401  
License No.: MHC 88317  
Phone: 410-963-1943 Fax: \_\_\_\_\_  
Email: hyland@olmo-bros.com  
Engineer/Architect Company: \_\_\_\_\_  
Responsible Design Prof.: \_\_\_\_\_  
Address: \_\_\_\_\_  
City: \_\_\_\_\_ State: \_\_\_\_\_ Zip Code: \_\_\_\_\_  
Phone: \_\_\_\_\_ Fax: \_\_\_\_\_  
Email: \_\_\_\_\_

Commercial Building Characteristics	Residential Building Characteristics
Height:	<input checked="" type="checkbox"/> SF Dwelling <input type="checkbox"/> SF Townhouse
No. of stories:	Depth Width
Gross area, sq. ft./floor:	1 <sup>st</sup> floor:
	2 <sup>nd</sup> floor:
Area of construction (sq. ft.):	Basement:
	<input type="checkbox"/> Finished Basement
Use group:	<input type="checkbox"/> Unfinished Basement
	<input type="checkbox"/> Crawl Space
Construction type:	<input type="checkbox"/> Slab on Grade
<input type="checkbox"/> Reinforced Concrete	No. of Bedrooms:
<input type="checkbox"/> Structural Steel	Multi-family Dwelling
<input type="checkbox"/> Masonry	No. of efficiency units:
<input type="checkbox"/> Wood Frame	No. of 1 BR units:
<input type="checkbox"/> State Certified Modular	No. of 2 BR units:
	No. of 3 BR units:
	Other Structure:
	Dimensions:
➤ Roadside Tree Project Permit	Footings:
<input type="checkbox"/> Yes <input type="checkbox"/> No	Roof:
Roadside Tree Project Permit #	<input type="checkbox"/> State Certified Modular
	<input type="checkbox"/> Manufactured Home

Utilities
Water Supply
<input type="checkbox"/> Public
<input checked="" type="checkbox"/> Private
Sewage Disposal
<input type="checkbox"/> Public
<input checked="" type="checkbox"/> Private
Electric: <input checked="" type="checkbox"/> Yes <input type="checkbox"/> No
Gas: <input type="checkbox"/> Yes <input checked="" type="checkbox"/> No
Heating System
<input type="checkbox"/> Electric <input type="checkbox"/> Oil
<input type="checkbox"/> Natural Gas <input type="checkbox"/> Propane Gas
<input type="checkbox"/> Other:
Sprinkler System:
<input type="checkbox"/> Yes <input type="checkbox"/> No
Grading Permit Number:
Building Shell Permit Number:

THE UNDERSIGNED HEREBY CERTIFIES AND AGREES AS FOLLOWS: (1) THAT HE/SHE IS AUTHORIZED TO MAKE THIS APPLICATION; (2) THAT THE INFORMATION IS CORRECT; (3) THAT HE/SHE WILL COMPLY WITH ALL REGULATIONS OF HOWARD COUNTY WHICH ARE APPLICABLE THERETO; (4) THAT HE/SHE WILL PERFORM NO WORK ON THE ABOVE REFERENCED PROPERTY NOT SPECIFICALLY DESCRIBED IN THIS APPLICATION; (5) THAT HE/SHE GRANTS COUNTY OFFICIALS THE RIGHT TO ENTER ONTO THIS PROPERTY FOR THE PURPOSE OF INSPECTING THE WORK PERMITTED AND POSTING NOTICES.

Applicant's Signature: Harry Hyland Print Name: Harry Hyland  
Email Address: hyland@olmo-bros.com Date: 8/12/2015  
Title/Company: \_\_\_\_\_

Checks Payable to: DIRECTOR OF FINANCE OF HOWARD COUNTY  
\*\*PLEASE WRITE NEATLY & LEGIBLY\*\*  
-FOR OFFICE USE ONLY-

AGENCY	DATE	SIGNATURE OF APPROVAL
State Highways		
Building Officials		
PSZA (Zoning)		
PSZA (Engineering)		
Health		<u>8-12-15 DBurnard</u>

Is Sediment Control approval required for issuance? ☐ Yes ☐ No  
☐ CONTINGENCY CONSTRUCTION START

DPZ SETBACK INFORMATION
Front:
Rear:
Side:
Side St.:
All minimum setbacks met? <input type="checkbox"/> Yes <input type="checkbox"/> No
Is Entrance Permit Required? <input type="checkbox"/> Yes <input type="checkbox"/> No
Historic District? <input type="checkbox"/> Yes <input type="checkbox"/> No
Lot Coverage for New Town Zone:
SDP/Red-line approval date:

Filing Fee	\$
Permit Fee	\$ <u>250.00</u>
Tech Fee	\$ <u>25.00</u>
Excise Tax	\$
PSFS	\$
Guaranty Fund	\$
Add'l per Fee	\$
Total Fees	\$ <u>275.00</u>
Sub-Total Paid	\$
Balance Due	\$
Check	#

FOR CRAIG STEWART

R&D CONT.

NOTE: No Portion of this lot lies within the 100 Year Flood Plain.

LOCATION OF HOUSE  
12326 WEXFORD COURT  
LOT 15

WATERFORD  
SECTION 2 LOTS 12-22  
A RESUBDIVISION OF LOT 4  
5TH ELECTION DISTRICT  
HOWARD COUNTY MARYLAND

Wall Check: 11-8-88  
TOP OF WALL ELEV: 457.4

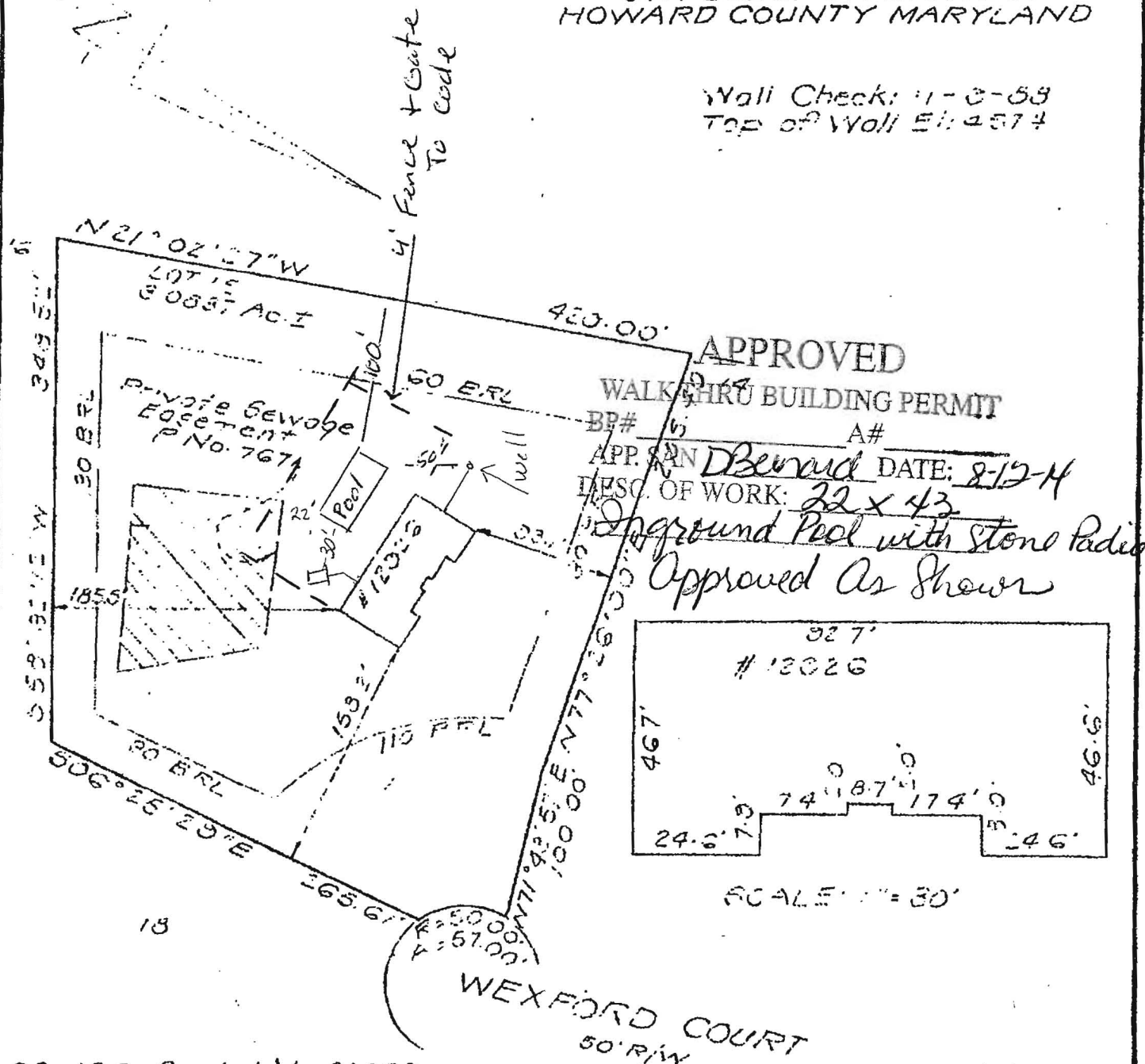

88-138 Serial No. 21453

### SURVEYOR'S CERTIFICATE

I hereby certify that the position of all existing improvements on the above described property have been carefully established by a transit-tape survey and that unless otherwise shown, there are no encroachments.

CLARK • FINEFROCK & SACKETT, INC.

ENGINEERS • PLANNERS • SURVEYORS  
7135 MINSTREL WAY COLUMBIA, MD. 21045  
(301) 381-7500-BALTO. • (301) 621-8100-WASH.

REFERENCE

Plat

7671

DRAWN BY SNE

DATE 11-15-88

SCALE 1" = 100'

CHECKED BY KWC

FILE NO.

0405-K

Donald P. Sackett #6057