

Bureau of Environmental Health  
7178 Columbia Gateway Drive, Columbia, MD 21046  
(410) 313-2640 Fax (410) 313-2648  
TDD (410) 313-2323 Toll Free 1-866-313-6300  
website: [www.hchealth.org](http://www.hchealth.org)

---

Penny E. Borenstein, M.D., M.P.H., Health Officer

June 5, 2006

Sharon Naylor  
1029 Day Road  
Sykesville, Maryland

RE: PERCOLATION TEST RESULTS – A524476  
1029 Day Road – SDA reconfirmation  
BP – B00159477

Dear Ms. Naylor:

Percolation testing conducted June 2, 2006 on the referenced property indicated both satisfactory and unsatisfactory soil conditions. A limiting factor influencing soil conditions included rock refusal at shallow depths. Testing re-confirmed adequate repair area on the property and determined the proposed structure to not interfere with the sewage disposal area. Copies of the test results are enclosed.

Further review is contingent upon an updated site plan showing an accurate dry well location and the proposed structure to be 20 feet from both the septic tank and the dry well.

If you have any questions regarding this matter, please contact me at the above address or by calling (410) 313-1771.

Sincerely,

Sara Fegel  
Well and Septic Program  
Development Coordination Section

SF  
Enclosures  
Cc: File

A/P

1  
brown L  
25% gravel  
2'5" reddish brown  
silt m  
micaceous  
4' reddish brown  
sl sg  
5% gravel  
well compact  
? brown yellow  
sl sg  
5% gravel  
13'

2  
brown L  
reddish brown  
silt m  
4' reddish brown  
sl sg  
5' brownish yellow  
sl sg  
5% gravel  
12'

3  
brown L  
reddish brown  
silt m  
↓  
sl sg  
25% cobbles  
story  
4' HB

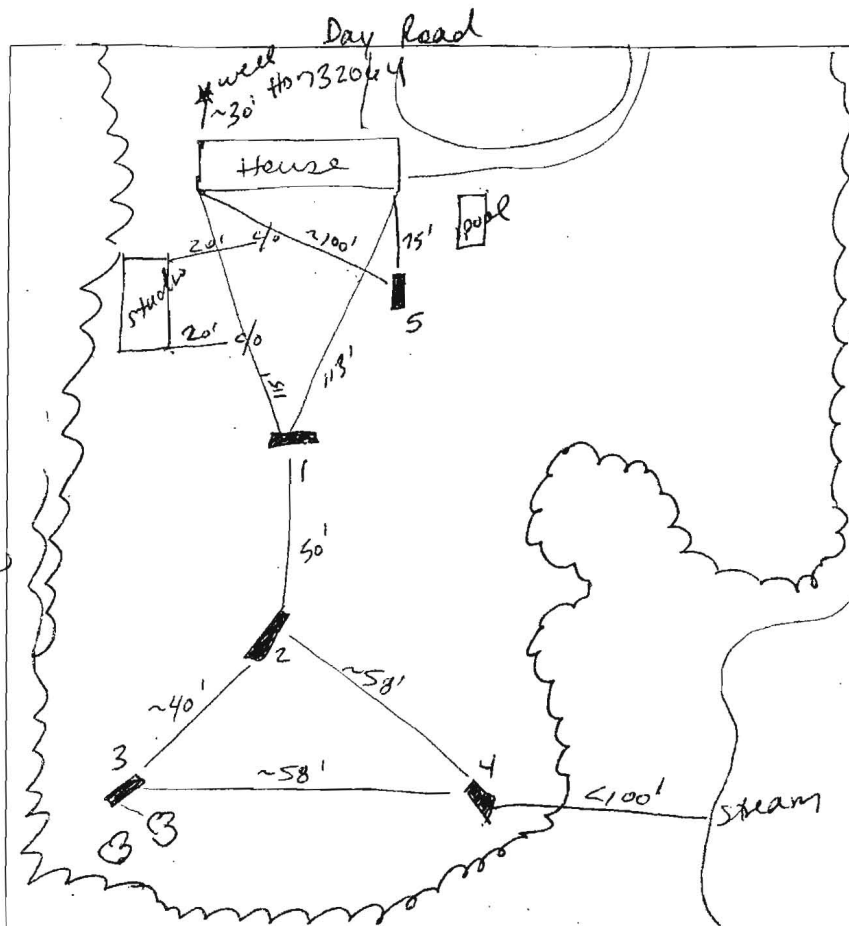

4  
brown L  
2' roots  
light red  
silt m  
4' transition  
to sl sg  
strong brown  
sl sg  
5' 25%-30%  
cobbles  
11'5" water  
13' water  
5  
brown L  
1' reddish  
yellow  
sl m  
5-10%  
gravel  
cobbles  
3'5" brownish  
yellow  
sl sg  
10% gravel  
sopralite  
13'

DATE	TEST #	DEPTH	START	BREAK 1" DROP	STOP 2" DROP	TIME OF 2ND INCH	P/F/H
6/2/00	1	4'5" / 13'	9:25	9:30	9:35	5	P
	2	12'			visual ok		P
	3	4'		rock	HB		F
	4	13'			visual ok		P
	5	4'5" / 13'	10:03	10:06	10:12	6	P

REMARKS All holes are consistent

SANITARIAN SF BACKHOE Fogles OTHERS

TEST HOLES USED IN SDA AVG. PERC TIME SQ. FT/BR

TRENCH WIDTH INLET DEPTH MAX. BOT DEPTH EFFECTIVE SW 4'



# APPLICATION

## FOR PERCOLATION TESTING AND SITE EVALUATION

TEST DATE(S) \_\_\_\_\_ TEST TIME \_\_\_\_\_

CAP 524476

AGENCY REVIEW: \_\_\_\_\_

DATE 5/23/06

DO NOT WRITE ABOVE THIS LINE

I HEREBY APPLY FOR THE NECESSARY TESTING/EVALUATION PRIOR TO ISSUANCE OF SEWAGE DISPOSAL SYSTEM PERMIT(S) TO:

CHECK AS NEEDED:

- ☐ CONSTRUCT NEW SEPTIC SYSTEM(S)  
☐ REPAIR/ADD TO AN EXISTING SEPTIC SYSTEM  
☐ REPLACE AN EXISTING SEPTIC SYSTEM

CHECK AS NEEDED:

- ☒ NEW STRUCTURE(S)  
☐ ADDITION TO AN EXISTING STRUCTURE  
☐ REPLACE AN EXISTING STRUCTURE

CHECK ONE:

- ☐ CREATE NEW LOT(S)  
☐ BUILD ON AN EXISTING LOT IN A SUBDIVISION  
☐ BUILD ON AN EXISTING PARCEL OF RECORD

IS THE PROPERTY WITHIN 2500' OF ANY RESERVOIR?

- ☐ YES  
☐ NO

THE TYPE OF STRUCTURE IS:

- ☒ RESIDENTIAL WITH 35 PROPOSED BEDROOMS IN THE COMPLETED STRUCTURE (NOTE **UNKNOWN** IF APPROPRIATE)  
☐ COMMERCIAL (PROVIDE DETAIL OF NUMBERS AND TYPES OF EMPLOYEES/ CUSTOMERS ON ACCOMPANYING PLAN)  
☐ INSTITUTIONAL/GOVERNMENT (PROVIDE DETAIL OF NUMBERS AND TYPES OF EMPLOYEES/USERS ON ACCOMPANYING PLAN)

PROPERTY OWNER(S) Sharon Naylor

DAYTIME PHONE 410 442-1543 CELL \_\_\_\_\_ FAX \_\_\_\_\_

MAILING ADDRESS 1029 Day Rd Sykesville  
STREET CITY/TOWN STATE ZIP

APPLICANT Fogle's Septic (Kurt)

DAYTIME PHONE 410 795-5670 CELL \_\_\_\_\_ FAX \_\_\_\_\_

MAILING ADDRESS 580 Obrecht Rd Sykes  
STREET CITY/TOWN STATE ZIP

APPLICANT'S ROLE: DEVELOPER BUILDER BUYER RELATIVE/FRIEND REALTOR .. CONSULTANT

PROPERTY LOCATION  
SUBDIVISION/PROPERTY NAME 1029 Day Rd LOT NO. \_\_\_\_\_

PROPERTY ADDRESS \_\_\_\_\_  
STREET TOWN/POST OFFICE Sykes

TAX MAP PAGE(S) \_\_\_\_\_ GRID \_\_\_\_\_ PARCEL(S) \_\_\_\_\_ PROPOSED LOT SIZE \_\_\_\_\_

AS APPLICANT, I UNDERSTAND THE FOLLOWING: THE SYSTEM INSTALLED SUBSEQUENT TO THIS APPLICATION IS ACCEPTABLE ONLY UNTIL PUBLIC SEWERAGE IS AVAILABLE. THIS APPLICATION IS COMPLETE WHEN ALL APPLICABLE FEES AND A SUITABLE SITE PLAN HAVE BEEN RECEIVED. I ACCEPT THE RESPONSIBILITY FOR COMPLIANCE WITH ALL M.O.S.H.A. AND "MISS UTILITY" REQUIREMENTS. APPROVAL IS BASED UPON SATISFACTORY REVIEW OF A PERC CERTIFICATION PLAN.

TEST RESULTS WILL BE MAILED TO APPLICANT.

Kurt A. Caswell  
SIGNATURE OF APPLICANT

HOWARD COUNTY HEALTH DEPARTMENT, BUREAU OF ENVIRONMENTAL HEALTH, WELL AND SEPTIC PROGRAM  
7178 COLUMBIA GATEWAY DRIVE COLUMBIA, MARYLAND 21046 (410) 313-2640 FAX (410) 313-2648  
TDD (410) 313-2323 TOLL FREE 1-877-4MD-DHMH

A/P

1  
brown L  
25% gravel  
2'5" reddish brown  
silt m  
micaceous  
4' reddish brown  
sl sg  
5% gravel  
well compact  
?  
brown yellow  
sl sg  
5% gravel  
13'

2  
brown L  
reddish brown  
silt m  
4' reddish brown  
sl sg  
5' brownish yellow  
sl sg  
5% gravel  
12'

3  
brown L  
reddish brown  
silt m  
↓  
sl sg  
25% cobbles  
strong  
4' HB

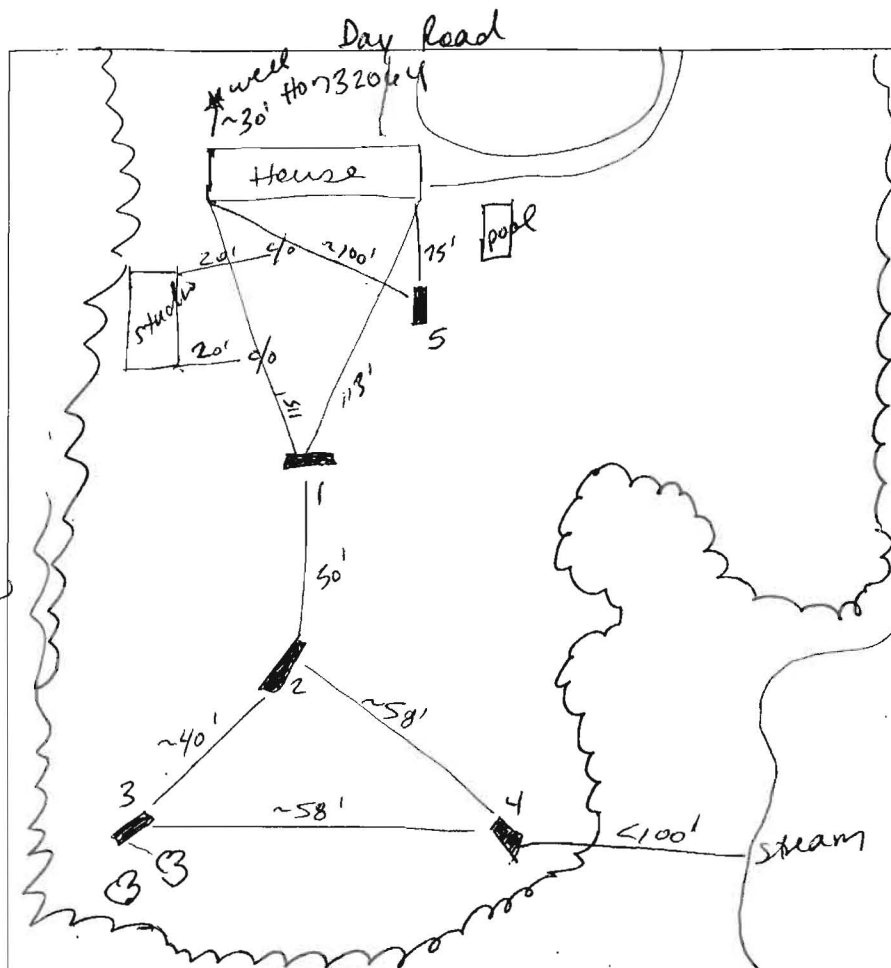

4  
brown L  
2' roots  
light red  
silt m  
4' transition  
to sl sg  
strong brown  
sl sg  
5' 25%-30%  
cobbles  
11'5" water  
13' water  
5  
brown L  
1' reddish  
yellow  
silt m  
5-10%  
gravel  
cobbles  
3'5" brownish  
yellow  
sl sg  
10% gravel  
soprolite  
13'

DATE	TEST #	DEPTH	START	BREAK 1" DROP	STOP 2" DROP	TIME OF 2ND INCH	P/F/H
6/2/06	1	4'5" / 13'	9:25	9:30	9:35	5	P
	2	12'			visual	ok	P
	3	4'		rock		HB	F
	4	13'			visual	ok	P
	5	4'5" / 13'	10:03	10:06	10:12	6	P

REMARKS All holes rock consistent

SANITARIAN SF

BACKHOE Fogles

OTHERS

TEST HOLES USED IN SDA

AVG. PERC TIME

SQ. FT/BR

TRENCH WIDTH

INLET DEPTH

MAX. BOT DEPTH

EFFECTIVE S/W

4'

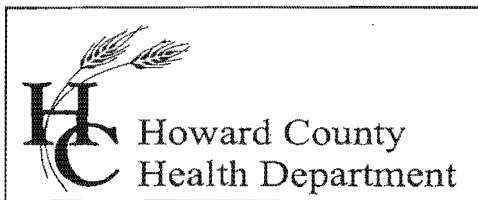

Bureau of Environmental Health  
7178 Columbia Gateway Drive, Columbia, MD 21046  
(410) 313-2640 Fax (410) 313-2648  
TDD (410) 313-2323 Toll Free 1-866-313-6300  
website: [www.hchealth.org](http://www.hchealth.org)

---

Penny E. Borenstein, M.D., M.P.H., Health Officer

June 5, 2006

Sharon Naylor  
1029 Day Road  
Sykesville, Maryland

RE: PERCOLATION TEST RESULTS – A524476  
1029 Day Road – SDA reconfirmation  
BP – B00159477

Dear Ms. Naylor:

Percolation testing conducted June 2, 2006 on the referenced property indicated both satisfactory and unsatisfactory soil conditions. A limiting factor influencing soil conditions included rock refusal at shallow depths. Testing re-confirmed adequate repair area on the property and determined the proposed structure to not interfere with the sewage disposal area. Copies of the test results are enclosed.

Further review is contingent upon an updated site plan showing an accurate dry well location and the proposed structure to be 20 feet from both the septic tank and the dry well.

If you have any questions regarding this matter, please contact me at the above address or by calling (410) 313-1771.

Sincerely,

Sara Fegel  
Well and Septic Program  
Development Coordination Section

SF  
Enclosures  
Cc: File

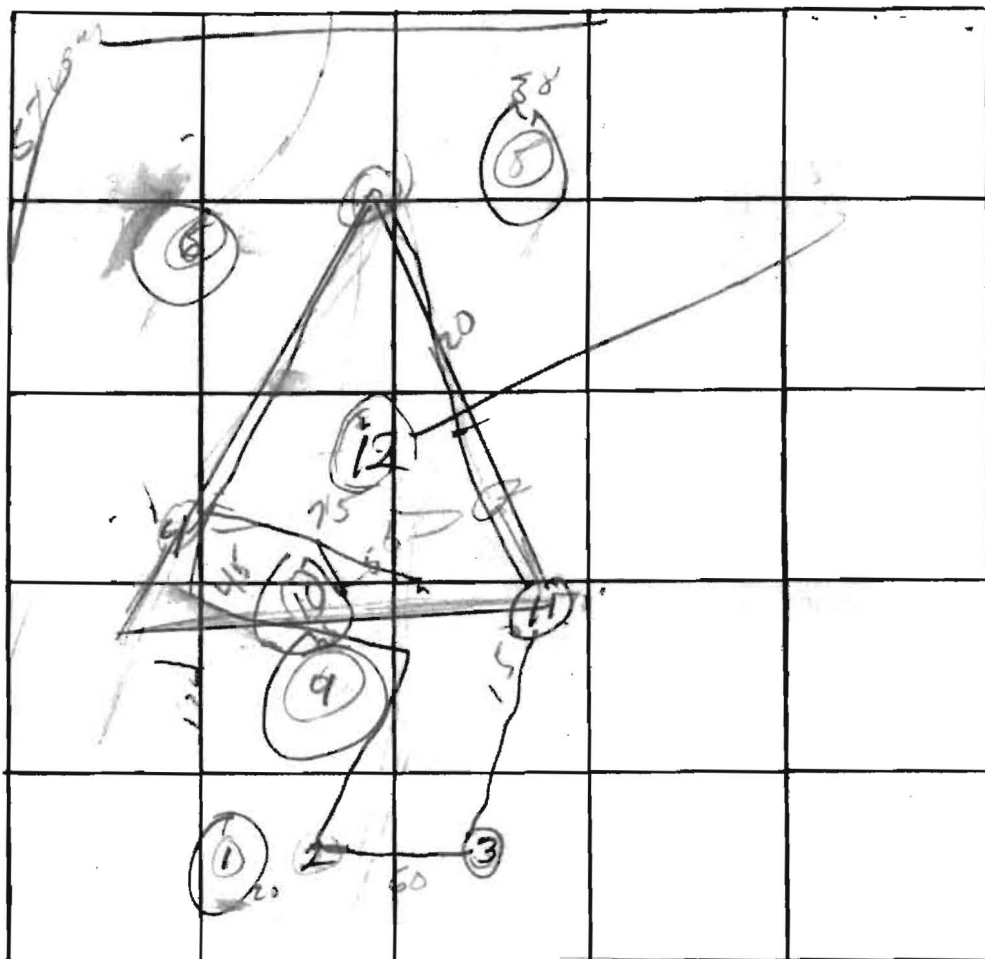

INDICATE NORTH. - NAME ADJOINING ROADWAY AS BASE LINE.

Rock

DATE	TEST NO.	DEPTH	PRE-WET		TEST - 1" DROP		TIME
			START	STOP	START	STOP	
4/25/74	1	Rock	11'				
	2	4' 13'	242	250	250	255	5
	3	5' 13'	242	247	299	300	17
	4	9' 13'	258	258	300	301	18
	5	4' 13'	Good	402			
	6	10'	Well				
	7	3' 13'	311	317			
	8	Rock	6'				
	9	Rock	4'				
	10	1 1/2' 10'	Rock	Flag		330	25 min
	11	5' 9' 10'	352	353	350	356	5

REMARKS

TYPE OF SOIL

TESTED BY

O'Neil

ALSO PRESENT:

SG

Visual  
Hole  
Here!  
per DWTS.  
again

Bot. OK

OK  
Dw. Holes