

Approved GLK
14 MAR 79

PERMIT

SEWAGE DISPOSAL SYSTEM

MARYLAND STATE DEPARTMENT OF HEALTH*

HOWARD COUNTY

ELLICOTT CITY

DISTRICT 3rd

DATE 10/30/78

INDEXED

Bud Arnold

John R. Browning, III

IS PERMITTED TO INSTALL ☒ ALTER

ADDRESS 2067 Beechwood Ave., Balto., Md. 21207

PHONE 448-0389

SUBDIVISION (Dickey Farms)

ROAD 1039 Day Road

LOT 28

PROPERTY OWNER John R. Browning, III

ADDRESS same as above

SPECIFICATIONS 3 bedrooms

SEPTIC TANK CAPACITY 1000 GALLONS

DRAIN FIELD _____ DEPTH _____ FEET, BOTTOM AREA _____ SQ. FT.

DEEP TRENCH _____ DEPTH _____ FEET, BOTTOM AREA _____ SQ. FT.

SEEPAGE PITS ☒ ABSORBENT SIDE-WALL AREA 170 SQ. FT. sidewall area per bedroom below inlet.

INLET PIPE 3 1/2 FT. BELOW ORIGINAL GRADE. MAXIMUM DEPTH 12 FT. BELOW ORIGINAL GRADE

EFFECTIVE DEPTH AT _____ FT. BELOW ORIGINAL GRADE.

LOCATE DISPOSAL AREA 70 FT. FROM front LOT LINE AND 100 FT. FROM right LOT LINE AS SEEN WHEN

FACING LOT FROM front of property. (Center of Jim's Way.)

If trench is needed to make up sidewall area in system; leave 5 ft. earth buffer

between dry well and trench and run the necessary distance. Trench to run towards

rear of lot.

PLANS APPROVED BY Charles B. Streaker

DATE 6/19/78

COVER NO WORK UNTIL INSPECTED AND APPROVED.

NEITHER THE HOWARD COUNTY COUNCIL NOR THE HEALTH DEPARTMENT IS RESPONSIBLE FOR THE SUCCESSFUL OPERATION OF ANY SYSTEM.

NOTE: IF TRENCH IS USED CALL FOR INSPECTION BEFORE PLACING GRAVEL IN TRENCH.

NOTE: NO DRY WELL SHALL EXCEED 15 FOOT IN DIAMETER.

NOTE: ALL PIPE FROM HOUSE TO DISPOSAL AREA MUST BE CAST IRON.

PERMIT VOID AFTER THREE YEARS.

NOTE: INSTALL STAND PIPE ON SEPTIC TANK AND DRY WELL. STAND PIPES MUST BE 6 INCHES IN DIAMETER. CAST IRON, CONCRETE OR TERRA COTTA ACCEPTED.

*INSTALLER IS RESPONSIBLE FOR OBTAINING FINAL APPROVAL ON THIS PERMIT.

BLDG. PERMIT SIGNED
AND RETURNED 8/21/78

Serial # 66440

Addition - Sunroom & Garage

A 28018

DAY
ROAD

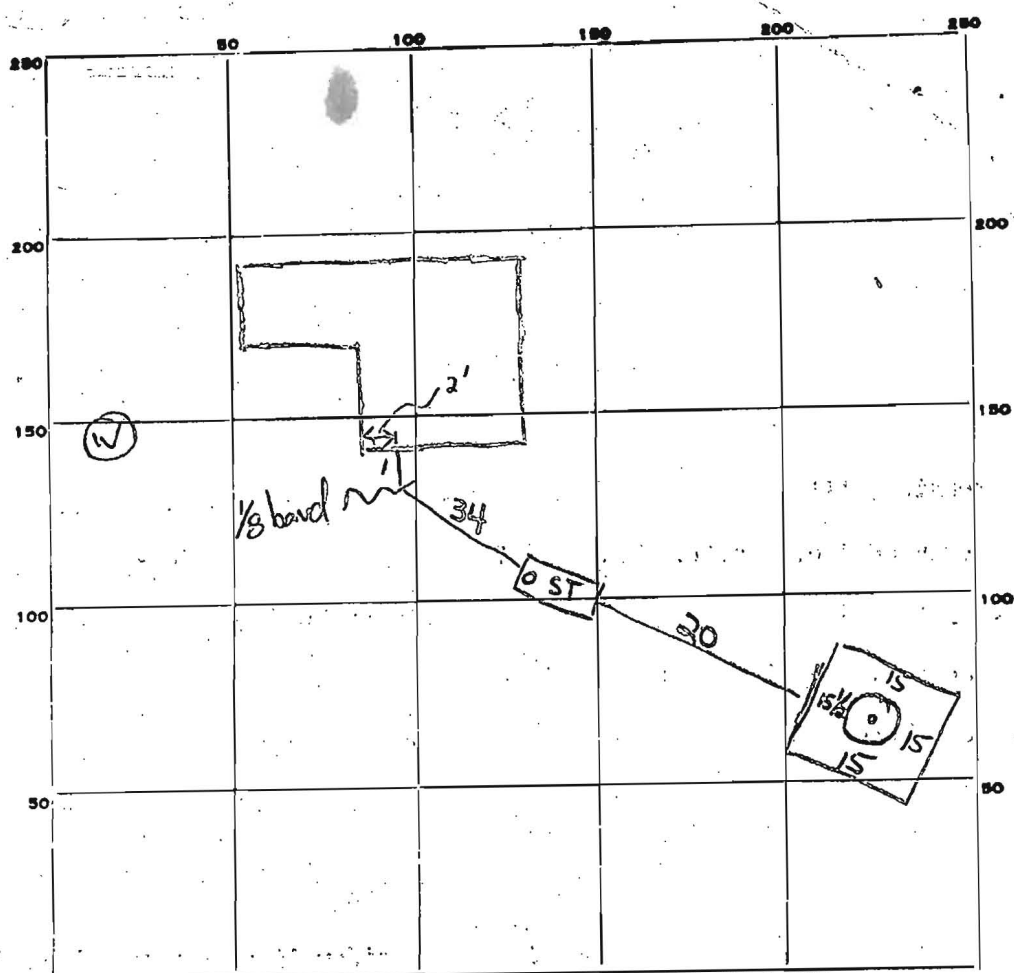

INDICATE NORTH - NAME ADJOINING ROADWAY AS BASE LINE.

JIM'S WAY

PERMIT CARD conductor

SEPTIC TANK, LEVEL 1000 rectangular CLEANOUTS ST DW CAST IRON

DISTRIBUTION BOX, LEVEL Na

TILE FIELD, DEPTH Na FT. TRENCH WIDTH _____ FT.

GRAVEL DEPTH _____ IN. TOTAL LENGTH _____ FT.

NUMBER OF TRENCHES _____ TOTAL BOTTOM AREA _____

SEEPAGE PITS, INSIDE DIAMETER precast perimeter +60 FT. DEPTH BELOW INLET 8 1/2 FT.

ABSORBENT AREA +510 SQ. FT.

REMARKS 14 MAR 79 - Final OK. (GLK)

DATE SYSTEM APPROVED 14 MAR. 79 INSPECTOR George Keller