



Bureau of Environmental Health  
7178 Columbia Gateway Drive, Columbia, MD 21046-2147  
Main: 410-313-2640 | Fax: 410-313-2648  
TDD 410-313-2323 | Toll Free 1-866-313-6300  
[www.hchealth.org](http://www.hchealth.org)  
Facebook: [www.facebook.com/hocohealth](https://www.facebook.com/hocohealth)  
Twitter: HowardCoHealthDep

Maura J. Rossman, M.D., Health Officer

**MEMORANDUM**

Sent via email to [grizconstruction@icloud.com](mailto:grizconstruction@icloud.com)

TO: Mark Slowinski

FROM: Kevin M. Wolf, LEHS, REHS/RS, Supervisor   
Groundwater Mgmt. Sec.  
Well & Septic Program

DATE: May 18, 2016

RE: 7054 Washington Blvd (01-178091)  
Eldridge, MD 21075  
M. 37, G.23 P. 185– 10.00AC  
(Demolition of existing building, return to grass land)

This is to advise that the Howard County Health Department recommends issuance of the demolition permit for the above referenced property.

The existing drilled well (no tag) that was utilized for the above referenced dwelling has been located and sealed by Michael Barlow MWD 355 on 4/19/2016. The property is currently connected to public water and will remain so.

No records were found regarding any septic system components. According to utility records, the property is currently connected to public sewer and will remain so.

If you plan to re-build on this parcel, you will need to re-connect to public water and sewer per Howard County specifications and regulations.

**IF ANY WELL OR SEPTIC COMPONENTS ARE FOUND DURING SITE WORK, YOU MUST NOTIFY THIS OFFICE IMMEDIATELY!!**

KMW

Cc: File

FAX

GRIZ  
3902 Sweet Air Road  
Phoenix, Maryland, 21131  
410-592-9425  
Fax 410-592-2739

DATE: 5-14-2016

TO: Howard Co Health Dept

ATTENTION: Karen Wolf

FAX# 410 319-2648

Please look for 2 pages

Comments

Attached Well Report From Darlow  
for 7054 Washington Blvd.

Need Durno Release Letter

From

Mark J. Shamba

04/20/2016 09:24 410 833 3582

Barlow Well Driller

#7713 P.001 /001

MARYLAND DEPARTMENT OF THE ENVIRONMENT, WATER MANAGEMENT ADMINISTRATION  
1800 Washington Blvd., Baltimore, Maryland 21230 (410) 537-3784

\*\*\*\*\*  
WATER WELL ABANDONMENT-SEALING REPORT FORM  
\*\*\*\*\*

SUBMIT COPIES OF COMPLETED FORM TO:

- \* COUNTY ENVIRONMENT AGENCY (contact MDE, WMA if address needed)
- \* WELL OWNER
- \* MDE, WATER MANAGEMENT ADMINISTRATION, WELL PROGRAM

DATE WELL ABANDONED: 4-19-16 (month/day/year)

PERMIT NUMBER OF ABANDONED WELL (if any) \_\_\_\_\_

PERMIT NUMBER OF REPLACEMENT WELL \_\_\_\_\_

PERSON ABANDONING WELL: Michael Barlow

WELL DRILLERS LICENSE NUMBER: 355

OWNER'S NAME: Howard County, MD

CIRCLE MWD/MSD/MGD

WELL LOCATION:  
COUNTY: Howard  
NEAREST TOWN: Elkridge  
TAX MAP 357 BLOCK 18 PARCEL 336  
SUBDIVISION: \_\_\_\_\_  
SECTION: \_\_\_\_\_ LOT: \_\_\_\_\_  
NEAREST ROAD: 7054 Washington Blvd

SITE LOCATION MAP

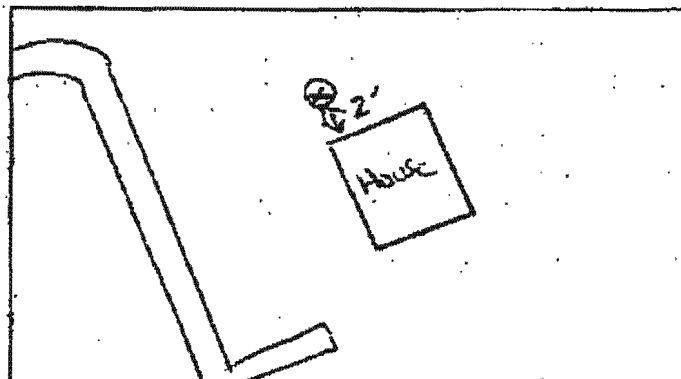

TYPE OF WELL BEING ABANDONED:

☒ DRILLED ☐ JETTED  
☐ BORED/AUGERED ☐ HAND DUG  
☐ OTHER (specify) \_\_\_\_\_

USE CODE:

☒ DOMESTIC ☐ MUNICIPAL/PUBLIC  
☐ IRRIGATION ☐ INDUSTRIAL  
☐ TEST/OBSERVATION ☐ GEOTHERMAL

TYPE OF CASING:

☒ STEEL ☐ PLASTIC  
☐ CONCRETE ☐ OTHER (specify) \_\_\_\_\_

SIZE OF CASING: 6 INCHES IN DIAMETER

DEPTH OF WELL: 50 FEET DEEP

WAS ANY CASING REMOVED? ☐ YES ☒ NO  
if yes, length removed, in feet: \_\_\_\_\_

WAS CASING RIPPED OR PERFORATED? ☐ YES ☒ NO

LOG OF SEALING MATERIAL

MATERIAL	FEET	
	FROM	TO
Portland Cement	50	0
VOLUME OF MATERIAL USED		

SIGNATURE-MASTER WELL DRILLER OR SUPERVISING SANITARIAN  
DENV 828 JULY 1997

355

LICENSE #

CIRCLE ONE MWD/MSD/MGD

4/20/16  
DATE



Howard County  
Health Department

Bureau of Environmental Health  
7178 Gateway Drive Columbia, MD 21046  
(410) 313-2640 Fax (410) 313-2648  
TDD (410) 313-2323 Toll Free 1-866-313-6300  
website: www.hchealth.org

Dr. Peter Beilenson, M.D., M.P.H., Health Officer

## DEMOLITION REQUEST FORM

(Please fill in all blanks)

### Information of Property to be Demolished:

Howard Co Rec & Park  
Current Owner's Name

Washington Blvd  
7450 ~~Cemetery Lane~~ 21075  
Property Address

Subdivision (if applicable)

Lot #

All Prior Owners' Names (if requested or known)

Tax Map

Parcel #

Tax ID #

Make Property Clean & Green  
Purpose/Reason for Demolition

Future plans of property after demo (i.e. subdivision, parking lot, re-build new house, etc...)

If a subdivision, SDP# \_\_\_\_\_ Has the structure(s) been deemed unsafe by DILP ☐ YES ☐ NO

### UTILITY RECORDS:

Property currently connected to public water ☒ YES ☐ NO

Property currently connected to public sewer ☒ YES ☒ NO

Does the property currently have any wells and/or septic systems ☒ YES ☐ NO

→ Explain:

\*Note: Any wells and/or septic systems that are to remain may require an approved percolation certification plan under Howard County Code Sec. 3.805

\*Note: Any septic systems that are to be abandoned must be done by a septic contractor with documentation of the process.

\*Note: All abandoned wells are to be sealed by a well driller licensed by the Maryland State Board of Well Drillers COMAR Sec 26.04.04.11 Abandonment Standards D (3)

### COMMENTS:

4/20

Mark J. Slowinski  
Applicant's Name (please print)

410 215 1444  
Applicant's Phone #

grisconstruction@icloud.com  
Applicant's Email

410 592 2739  
Applicant's Fax #

Mark J. Slowinski  
Applicant's Signature

4-11-2010  
Date

FAX

GRIZ  
3902 Sweet Air Road  
Phoenix, Maryland, 21131  
410-592-9425  
Fax 410-592-2739

DATE: 4-14-2016

TO: Ho Co. Health Dept

ATTENTION: Kevin Wolf

FAX# 410-313-2648

Please look for 2 pages

Comments

7450  
Demo Request Form For Washington Blvd

well is not in use

Mike Isom from Barton Well Drilling  
will abandon well on Tuesday  
4-19-2016

Septic was abandoned when  
house was hooked to city sewer  
From

Mandy J. Sander.

Confirmed onsite that



## Real Property Data Search ( w1)

Guide to searching the database

Search Result for HOWARD COUNTY

View Map		View GroundRent Redemption		View GroundRent Registration	
<b>Account Identifier:</b>		<b>District - 01 Account Number - 178091</b>			
<b>Owner Information</b>					
<b>Owner Name:</b>		HOWARD COUNTY MD DEPT PARKS AND RECREATION		<b>Use:</b> Principal Residence:	EXEMPT COMMERCIAL NO
<b>Mailing Address:</b>		3430 COURT HOUSE DR ELLCOTT CITY MD 21043- 4300		<b>Deed Reference:</b>	/05341/ 00078
<b>Location &amp; Structure Information</b>					
<b>Premises Address:</b>		PRIVATE RD ELKRIDGE 21075-0000		<b>Legal Description:</b>	10.00 A PRIVATE RD ELKRIDGE
<b>Map:</b>	<b>Grid:</b>	<b>Parcel:</b>	<b>Sub District:</b>	<b>Subdivision:</b>	<b>Section: Block: Lot: Assessment Year: Plat No: Plat Ref:</b>
0037	0023	0185		0000	2015
<b>Special Tax Areas:</b>				<b>Town:</b> <b>Ad Valorem:</b> <b>Tax Class:</b>	NONE 102
<b>Primary Structure Built</b>	<b>Above Grade Enclosed Area</b>	<b>Finished Basement Area</b>	<b>Property Land Area</b>	<b>County Use</b>	
			10.0000 AC		
<b>Stories</b>	<b>Basement</b>	<b>Type</b>	<b>Exterior</b>	<b>Full/Half Bath</b>	<b>Garage Last Major Renovation</b>
<b>Value Information</b>					
		<b>Base Value</b>	<b>Value As of 01/01/2015</b>	<b>Phase-in Assessments As of 07/01/2015 As of 07/01/2016</b>	
<b>Land:</b>		1,661,500	1,661,500		
<b>Improvements</b>		0	0		
<b>Total:</b>		1,661,500	1,661,500	1,661,500	1,661,500
<b>Preferential Land:</b>		0			0
<b>Transfer Information</b>					
<b>Seller: RORABAUGH ROBERT E</b>		<b>Date: 11/05/1999</b>		<b>Price: \$825,000</b>	
<b>Type: NON-ARMS LENGTH OTHER</b>		<b>Deed1: /05341/ 00078</b>		<b>Deed2:</b>	
<b>Seller: RORABAUGH ROBERT &amp; WIFE</b>		<b>Date: 06/27/1996</b>		<b>Price: \$0</b>	
<b>Type: NON-ARMS LENGTH OTHER</b>		<b>Deed1: /03760/ 00473</b>		<b>Deed2:</b>	
<b>Seller:</b>		<b>Date:</b>		<b>Price:</b>	
<b>Type:</b>		<b>Deed1:</b>		<b>Deed2:</b>	
<b>Exemption Information</b>					
<b>Partial Exempt Assessments:</b>		<b>Class</b>	<b>07/01/2015</b>	<b>07/01/2016</b>	
<b>County:</b>		420	1,661,500.00	1,661,500.00	
<b>State:</b>		420	1,661,500.00	1,661,500.00	
<b>Municipal:</b>		420	0.00 0.00	0.00 0.00	
<b>Tax Exempt:</b>		<b>Special Tax Recapture:</b>			
<b>Exempt Class:</b>		NONE			
<b>Homestead Application Information</b>					
<b>Homestead Application Status: No Application</b>					

1. This screen allows you to search the Real Property database and display property records.

2. Click [here](#) for a glossary of terms.

## **Wolf, Kevin**

---

**From:** Wolf, Kevin  
**Sent:** Friday, April 15, 2016 10:33 AM  
**To:** Mark Slowinski (~~gniazda.mark@icloud.com~~)  
**Cc:** Peach, Mike  
**Subject:** 7450 Washington Blvd DEMO  
**Attachments:** 20160415103626476.pdf

Gentlemen, please see map below. I believe this is the property you are requesting to be razed (Highlighted in yellow). Please confirm. Thanks



# HowardCounty maryland

Map Tools

Search Google....

Map La



Thanks,

Kevin M. Wolf, LEHS, REHS/RS  
Groundwater Mgmt. Sec. Supervisor  
Well & Septic Program  
Bureau of Environmental Health  
8930 Stanford Blvd.  
Columbia, MD 21045  
(o) 410-313-2645  
(f) 410-313-2648



[kwolf@howardcountymd.gov](mailto:kwolf@howardcountymd.gov)

#### CONFIDENTIALITY NOTICE

This message and the accompanying documents are intended only for the use of the individual or entity to which they are addressed and may contain information that is privileged, confidential, or exempt from disclosure under applicable law. If the reader of this email is not the intended recipient, you are hereby notified that you are strictly prohibited from reading, disseminating, distributing, or copying this communication. If you have received this email in error, please notify the sender immediately and destroy the original transmission.

MARYLAND DEPARTMENT OF THE ENVIRONMENT, WATER MANAGEMENT ADMINISTRATION  
1800 Washington Blvd., Baltimore, Maryland 21230 (410) 537-3784

WATER WELL ABANDONMENT-SEALING REPORT FORM

SUBMIT COPIES OF COMPLETED FORM TO:

- \* COUNTY ENVIRONMENT AGENCY (contact MDE, WMA if address needed)
- \* WELL OWNER
- \* MDE, WATER MANAGEMENT ADMINISTRATION, WELL PROGRAM

DATE WELL ABANDONED: 4-19-16 (month/day/year)

OK  
9/14/16 SC

\* PERMIT NUMBER OF ABANDONED WELL (if any) \_\_\_\_\_

\* PERMIT NUMBER OF REPLACEMENT WELL \_\_\_\_\_

\* PERSON ABANDONING WELL: Michael Barlow

WELL DRILLERS LICENSE NUMBER: 355

CIRCLE: MWD/MSD/MGD

\* OWNER'S NAME: Howard County, MD

SITE LOCATION MAP

\* WELL LOCATION:  
COUNTY: Howard  
NEAREST TOWN: Ft. Detrick  
TAX MAP 37 BLOCK 18 PARCEL 336  
SUBDIVISION: \_\_\_\_\_  
SECTION: \_\_\_\_\_ LOT: \_\_\_\_\_  
NEAREST ROAD: 7054 Washington Blvd

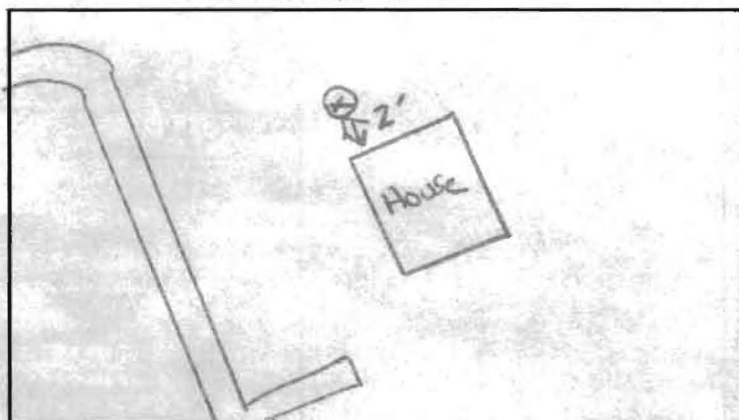

\* TYPE OF WELL BEING ABANDONED:

☒ DRILLED ☐ JETTED  
☐ BORED/AUGERED ☐ HAND DUG  
☐ OTHER (specify) \_\_\_\_\_

\* USE CODE:

☒ DOMESTIC ☐ MUNICIPAL/PUBLIC  
☐ IRRIGATION ☐ INDUSTRIAL  
☐ TEST/OBSERVATION ☐ GEOTHERMAL

\* TYPE OF CASING:

☒ STEEL ☐ PLASTIC  
☐ CONCRETE ☐ OTHER (specify) \_\_\_\_\_

\* SIZE OF CASING: 6 INCHES IN DIAMETER

\* DEPTH OF WELL: 50 FEET DEEP

\* WAS ANY CASING REMOVED? ☐ YES ☒ NO  
if yes, length removed, in feet: \_\_\_\_\_

\* WAS CASING RIPPED OR PERFORATED? ☐ YES ☒ NO

LOG OF SEALING MATERIAL

MATERIAL	FEET	
	FROM	TO
Portland Cement	50	0
VOLUME OF MATERIAL USED		

SIGNATURE-MASTER WELL DRILLER OR SUPERVISING SANITARIAN

LICENSE # 355

CIRCLE ONE

DATE 4/20/16