



# Building Permit Application

Howard County Maryland  
Department of Inspections, Licenses and Permits  
3430 Court House Drive  
Permits: 410-313-2455  
www.howardcountymd.gov

Date Received: \_\_\_\_\_

Permit No.: B17000070

Building Address: 3302 Sang Rd  
City: Beltsville State: MD Zip Code: 21738  
Suite/Apt. #: \_\_\_\_\_ SDP/WP/BA #: \_\_\_\_\_  
Census Tract: \_\_\_\_\_ Subdivision: 1000 Dupont  
Section: \_\_\_\_\_ Area: \_\_\_\_\_ Lot: 60  
Tax Map: 14 Parcel: 106 Grid: 24  
Zoning: \_\_\_\_\_ Map Coordinates: \_\_\_\_\_ Lot Size: 3300

Existing Use: Residential  
Proposed Use: 1 Duplex Townhouse  
Estimated Construction Cost: \$ \_\_\_\_\_  
Description of Work: \_\_\_\_\_

Occupant/Tenant Name: \_\_\_\_\_  
Was tenant space previously occupied? ☐ Yes ☐ No  
Contact Name: \_\_\_\_\_  
Address: \_\_\_\_\_  
City: \_\_\_\_\_ State: \_\_\_\_\_ Zip Code: \_\_\_\_\_  
Phone: \_\_\_\_\_ Fax: \_\_\_\_\_  
Email: \_\_\_\_\_

Commercial Building Characteristics	Residential Building Characteristics
Height:	<input type="checkbox"/> SF Dwelling <input type="checkbox"/> SF Townhouse
No. of stories:	<u>Depth</u> <u>Width</u>
Gross area, sq. ft./floor:	1 <sup>st</sup> floor: _____ 2 <sup>nd</sup> floor: _____
Area of construction (sq. ft.):	Basement: _____ <input type="checkbox"/> Finished Basement <input type="checkbox"/> Unfinished Basement <input type="checkbox"/> Crawl Space
Use group:	<input type="checkbox"/> Slab on Grade
<u>Construction type:</u>	No. of Bedrooms: _____
<input type="checkbox"/> Reinforced Concrete	<u>Multi-family Dwelling</u>
<input type="checkbox"/> Structural Steel	No. of efficiency units: _____
<input type="checkbox"/> Masonry	No. of 1 BR units: _____
<input type="checkbox"/> Wood Frame	No. of 2 BR units: _____
<input type="checkbox"/> State Certified Modular	No. of 3 BR units: _____
	Other Structure: _____
	Dimensions: _____
<input checked="" type="checkbox"/> Roadside Tree Project Permit	Footings: _____
<input type="checkbox"/> Yes <input type="checkbox"/> No	Roof: _____
Roadside Tree Project Permit #	<input type="checkbox"/> State Certified Modular
	<input type="checkbox"/> Manufactured Home

Property Owner's Name: Andrew D. ...  
Address: 3302 Sang Rd  
City: Beltsville State: MD Zip Code: 21738  
Phone: \_\_\_\_\_ Fax: \_\_\_\_\_  
Email: \_\_\_\_\_

**Applicant's Name & Mailing Address, (If other than stated herein)**  
Applicant's Name: Andrew D. ...  
Address: 3302 Sang Rd  
City: Beltsville State: MD Zip Code: 21738  
Phone: \_\_\_\_\_ Fax: \_\_\_\_\_  
Email: \_\_\_\_\_

Contractor Company: \_\_\_\_\_  
Contact Person: \_\_\_\_\_  
Address: \_\_\_\_\_  
City: \_\_\_\_\_ State: \_\_\_\_\_ Zip Code: 20737  
License No.: \_\_\_\_\_  
Phone: \_\_\_\_\_ Fax: \_\_\_\_\_  
Email: \_\_\_\_\_

Engineer/Architect Company: \_\_\_\_\_  
Responsible Design Prof.: \_\_\_\_\_  
Address: \_\_\_\_\_  
City: \_\_\_\_\_ State: \_\_\_\_\_ Zip Code: \_\_\_\_\_  
Phone: \_\_\_\_\_ Fax: \_\_\_\_\_  
Email: \_\_\_\_\_

Utilities
Electric: <input type="checkbox"/> Yes <input type="checkbox"/> No
Gas: <input type="checkbox"/> Yes <input type="checkbox"/> No
<u>Water Supply</u>
<input type="checkbox"/> Public
<input type="checkbox"/> Private
<u>Sewage Disposal</u>
<input type="checkbox"/> Public
<input type="checkbox"/> Private
<u>Heating System</u>
<input type="checkbox"/> Electric <input type="checkbox"/> Oil
<input type="checkbox"/> Natural Gas <input type="checkbox"/> Propane Gas
<input type="checkbox"/> Other: _____
<u>Sprinkler System:</u>
<input type="checkbox"/> Yes <input type="checkbox"/> No
Grading Permit Number: _____
Building Shell Permit Number: _____

THE UNDERSIGNED HEREBY CERTIFIES AND AGREES AS FOLLOWS: (1) THAT HE/SHE IS AUTHORIZED TO MAKE THIS APPLICATION; (2) THAT THE INFORMATION IS CORRECT; (3) THAT HE/SHE WILL COMPLY WITH ALL REGULATIONS OF HOWARD COUNTY WHICH ARE APPLICABLE THERETO; (4) THAT HE/SHE WILL PERFORM NO WORK ON THE ABOVE REFERENCED PROPERTY NOT SPECIFICALLY DESCRIBED IN THIS APPLICATION; (5) THAT HE/SHE GRANTS COUNTY OFFICIALS THE RIGHT TO ENTER ONTO THIS PROPERTY FOR THE PURPOSE OF INSPECTING THE WORK PERMITTED AND POSTING NOTICES.

Applicant's Signature \_\_\_\_\_ Print Name \_\_\_\_\_  
Email Address \_\_\_\_\_ Date \_\_\_\_\_  
Title/Company \_\_\_\_\_

Checks Payable to: DIRECTOR OF FINANCE OF HOWARD COUNTY

\*\*PLEASE WRITE NEATLY & LEGIBLY\*\*

-FOR OFFICE USE ONLY-

AGENCY	DATE	SIGNATURE OF APPROVAL
State Highways		
Building Officials		
PSZA ( Zoning )		
PSZA ( Engineering )		
Health	1/19/17	<u>Paul ...</u>

DPZ SETBACK INFORMATION
Front: _____
Rear: _____
Side: _____
Side St.: _____
All minimum setbacks met? <input type="checkbox"/> Yes <input type="checkbox"/> No
Is Entrance Permit Required? <input type="checkbox"/> Yes <input type="checkbox"/> No
Historic District? <input type="checkbox"/> Yes <input type="checkbox"/> No
Lot Coverage for New Town Zone: _____
SDP/Red-line approval date: _____

Filing Fee	\$
Permit Fee	\$
Tech Fee	\$
Excise Tax	\$
PSFS	\$
Guaranty Fund	\$
Add'l per Fee	\$
Total Fees	\$
Sub- Total Paid	\$
Balance Due	\$
Check	#

distribution of Copies: White: Building Officials Green: PSZA,Zoning Yellow: PSZA,Engineering Pink: Health Gold: SHA

# CONSUMER INFORMATION NOTES:

1. This plan is a benefit to a consumer insofar as it is required by a lender or a title insurance company or its agent in connection with contemplated transfer, financing or re-financing.
2. This plan is not to be relied upon for the establishment or location of fences, garages, buildings, or other existing or future improvements.
3. This plan does not provide for the accurate identification of property boundary lines, but such identification may not be required for the transfer of title or securing financing or re-financing.
4. Building line and/or Flood Zone information is taken from available sources and is subject to interpretation of originator.
5. No Title Report furnished.

## Notes:

1. Setback distances as shown to the principal structure from property lines are approximate. The level of accuracy for this drawing should be taken to be no greater than plus or minus 1 foot.
2. Fences, if shown, have been located by approximate methods.

LOT 9  
HOLLY HILLS

LOT 6  
3.063 Acres

LOT 7

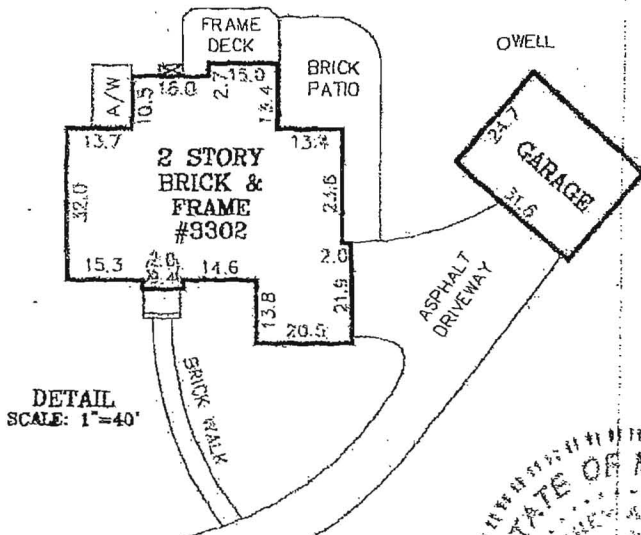

LOCATION DRAWING  
LOT 6  
CHOI PROPERTY  
HOWARD COUNTY, MARYLAND



## SURVEYOR'S CERTIFICATE

"THE INFORMATION SHOWN HEREON HAS BEEN BASED UPON THE RESULTS OF A FIELD INSPECTION PURSUANT TO THE DEED OR PLAT OF RECORD. EXISTING STRUCTURES SHOWN HAVE BEEN FIELD LOCATED BASED UPON MEASUREMENTS FROM PROPERTY MARKERS FOUND OR FROM EVIDENCE OF LINES OF APPARENT OCCUPATION."

*Jeffrey A. Foster*  
MARYLAND PROPERTY LINE SURVEYOR REG. NO. 587  
Expires: 04-02-2015

## REFERENCES

PLAT BK.  
PLAT NO. 10693

LIBER  
FOLIO



SNIDER & ASSOCIATES  
LAND SURVEYORS

20270 Goldenrod Lane, Suite 110  
Germantown, Maryland 20876  
301/948-5100 Fax 301/948-1288

DATE OF LOCATIONS

SCALE: 1" = 100'

WALL CHECK:

DRAWN BY: K.W.L.

HSE. LOC.: 02-24-14

JOB NO.: 14-00375