

DEPT. OF INSPECTIONS, LICENSES AND PERMITS
3430 COURT HOUSE DRIVE
ELLICOTT CITY, MD 21043
PERMITS (410) 313-2455
INSPECTIONS (410) 313-1810
AUTOMATED INFORMATION (410) 313-3800

HOWARD COUNTY
PERMIT APPLICATION
PERMIT NUMBER R1001/44

Building Address 1144 Rte 32
Sykesville MD 21784
Suite/Apt. #: SDP/WP/Petition #:
Census Tract Subdivision
Section Area Lot
Tax Map Parcel Grid
Zoning RC Map Coordinates Lot Size .9 A
Existing Use Empty lot
Proposed Use New Single Family Home
Estimated Construction Cost \$ 250,000
Description of Work
Occupant or Tenant
Contact Name
Address
City State Zip Code
Phone Fax

BUILDING DESCRIPTION - COMMERCIAL
Building Characteristics
Height:
No. of stories:
Gross area, sq. ft. per floor:
Use group:
Construction type:
Reinforced Concrete
Structural Steel
Masonry
Wood Frame
State Certified Modular
Utilities
Water Supply:
Public
Private
Sewage Disposal:
Public
Private
Electric Yes No
Gas Yes No
Heating System:
Electric Oil
Natural Gas Propane Gas
Sprinkler system: N/A
Full
Partial
Other Suppression
of Heads

BUILDING DESCRIPTION - RESIDENTIAL
Building Characteristics
SF Dwelling SF Townhouse
Depth Width
1st floor:
2nd floor:
Basement:
Finished Basement Unfinished Basement Crawl space Slab on Grade
No. of Bedrooms
Multi-family dwellings:
No. of efficiency units:
No. of 1 BR units:
No. of 2 BR units:
No. of 3 BR units:
Other Structure:
Dimensions:
Footings:
Roof:
State Certified Modular
Manufactured Home
Utilities
Water Supply:
Public
Private
Sewage Disposal:
Public
Private
Electric Yes No
Gas Yes No
Heating System:
Electric Oil
Natural Gas Propane Gas
Sprinkler system: N/A
NFPA #13D
NFPA #13R
Other:

THE UNDERSIGNED HEREBY CERTIFIES AND AGREES AS FOLLOWS: (1) THAT HE/SHE IS AUTHORIZED TO MAKE THIS APPLICATION; (2) THAT THE INFORMATION IS CORRECT; (3) THAT HE/SHE WILL COMPLY WITH ALL REGULATIONS OF HOWARD COUNTY WHICH ARE APPLICABLE THERETO; (4) THAT HE/SHE WILL PERFORM NO WORK ON THE ABOVE REFERENCED PROPERTY NOT SPECIFICALLY DESCRIBED IN THIS APPLICATION; (5) THAT HE/SHE GRANTS COUNTY OFFICIALS THE RIGHT TO ENTER ONTO THIS PROPERTY FOR THE PURPOSE OF INSPECTING THE WORK PERMITTED AND POSTING NOTICES.

Applicant's Signature
Print Name
Email Address
Title/Company
Date

Checks payable to: DIRECTOR OF FINANCE OF HOWARD COUNTY
PLEASE WRITE NEATLY AND LEGIBLY.
- FOR OFFICE USE ONLY -
AGENCY DATE SIGNATURE APPROVAL
Land Development, DPZ
State Highways
Building Officials
Dev. Engineering, DPZ
Health 6/30/2010 R. Buckner
Fire Protection
Is Sediment Control approval required prior to issuance?
YES NO
CONTINGENCY CONSTRUCTION START:
ONE STOP SHOP:
DPZ SETBACK INFORMATION
Front:
Rear:
Side:
Side St.:
All minimum setbacks met?
YES NO
Is Entrance Permit Required?
YES NO
Historic District?
YES NO
Lot Coverage for New Town Zone
SDP/Red-line approval date
Filing fee
Permit fee
Excise tax
Add'l per fee
TOTAL FEES
Sub-total paid
Balance due
Check
Validation
Accepted by



Building Permit Application

Howard County Maryland
Department of Inspections, Licenses and Permits
3430 Court House Drive
Permits: 410-313-2455
www.howardcountymd.gov

Date Received: _____

Permit No.: _____

Building Address: 1144 Sykesville Rd

City: Sykesville State: MD Zip Code: 21784

Suite/Apt. # _____ SDP/WP/BA #: _____

Census Tract: _____ Subdivision: _____

Section: _____ Area: _____ Lot: _____

Tax Map: _____ Parcel: _____ Grid: _____

Zoning: _____ Map Coordinates: _____ Lot Size: _____

Existing Use: house

Proposed Use: add Deck

Estimated Construction Cost: \$ _____

Description of Work: Build a deck

Occupant or Tenant: _____

Was tenant space previously occupied? ☐ Yes ☐ No

Contact Name: _____

Address: _____

City: _____ State: _____ Zip Code: _____

Phone: _____ Fax: _____

Email: _____

Commercial Building Characteristics

Height: _____

No. of stories: _____

Gross area, sq. ft./floor: _____

Area of construction (sq. ft.): _____

Use group: _____

Construction type: _____

☐ Reinforced Concrete

☐ Structural Steel

☐ Masonry

☐ Wood Frame

☐ State Certified Modular

☐ Roadside Tree Project Permit

☐ Yes ☐ No

Roadside Tree Project Permit # _____

Property Owner's Name: Denise & Stephen Adams

Address: 1144 Sykesville Rd

City: Sykesville State: MD Zip Code: 21784

Phone: 443 472 2669 Fax: _____

Email: deniseadams@live.com

Applicant's Name & Mailing Address, (If other than stated herein)

Applicant's Name: _____

Address: _____

City: _____ State: _____ Zip Code: _____

Phone: _____ Fax: _____

Email: _____

Contractor Company: None

Contact Person: _____

Address: _____

City: _____ State: _____ Zip Code: _____

License No.: _____

Phone: _____ Fax: _____

Email: _____

Engineer/Architect Company: _____

Responsible Design Prof.: _____

Address: _____

City: _____ State: _____ Zip Code: _____

Phone: _____ Fax: _____

Email: _____

Residential Building Characteristics

☐ SF Dwelling ☐ SF Townhouse

Depth _____ Width _____

1st floor: _____

2nd floor: _____

Basement: _____

☐ Finished Basement

☐ Unfinished Basement

☐ Crawl Space

☐ Slab on Grade

No. of Bedrooms: _____

Multi-family Dwelling

No. of efficiency units: _____

No. of 1 BR units: _____

No. of 2 BR units: _____

No. of 3 BR units: _____

Other Structure: _____

Dimensions: _____

Footings: _____

Roof: _____

☐ State Certified Modular

☐ Manufactured Home

Utilities

Water Supply

☐ Public

☒ Private

Sewage Disposal

☐ Public

☒ Private

Electric: ☐ Yes ☐ No

Gas: ☐ Yes ☐ No

Heating System

☐ Electric ☐ Oil

☐ Natural Gas ☐ Propane Gas

☐ Other: _____

Sprinkler System:

☐ Yes ☐ No

Grading Permit Number: _____

Building Shell Permit Number: _____

THE UNDERSIGNED HEREBY CERTIFIES AND AGREES AS FOLLOWS: (1) THAT HE/SHE IS AUTHORIZED TO MAKE THIS APPLICATION; (2) THAT THE INFORMATION IS CORRECT; (3) THAT HE/SHE WILL COMPLY WITH ALL REGULATIONS OF HOWARD COUNTY WHICH ARE APPLICABLE THERETO; (4) THAT HE/SHE WILL PERFORM NO WORK ON THE ABOVE REFERENCED PROPERTY NOT SPECIFICALLY DESCRIBED IN THIS APPLICATION; (5) THAT HE/SHE GRANTS COUNTY OFFICIALS THE RIGHT TO ENTER ONTO THIS PROPERTY FOR THE PURPOSE OF INSPECTING THE WORK PERMITTED AND POSTING NOTICES.

Applicant's Signature: Denise Adams

Email Address: deniseadams@live.com

Print Name: Denise Adams

Date: 6/12/14

Distribution of Copies: White: Building Officials Green: PSZA, Zoning Yellow: PSZA, Engineering Pink: Health Gold: SHA

Operations\Updated Forms\Building applmp 8.2012.docx

Lumber Species: Pine

Ledger board, joists and beams
are 2 x 10 treated lumber

Existing House

1/2" bolts to be installed to
attach the ledger board
16" on center

All joists will be attached using
joist hangers 16" on center

Joists hangers

Footers will be 22"
diameter or
20" x 20" square
30" deep 10" thick

All joist will be
attached to the top
of the beam using
mechanical fasteners

Existing House

Double 2x10 beam
notched with 6x6

5/4 x 6 or 2x6 Decking to
be installed

Duraflash Ledger board vinyl flashing will be installed
D22T brackets to be installed on all railing posts
Vinyl railing to be installed

Joists will sit on top of beam
allowing for a 24" cantilever

Rim joist

Steps

Final height has not been determined
at this time. Plans are to have
10" runs and 7 1/4" rise. Treads
will be either 5/4" x 6" or

Steppen and Denise Adams

21 x 16 Deck

Steps

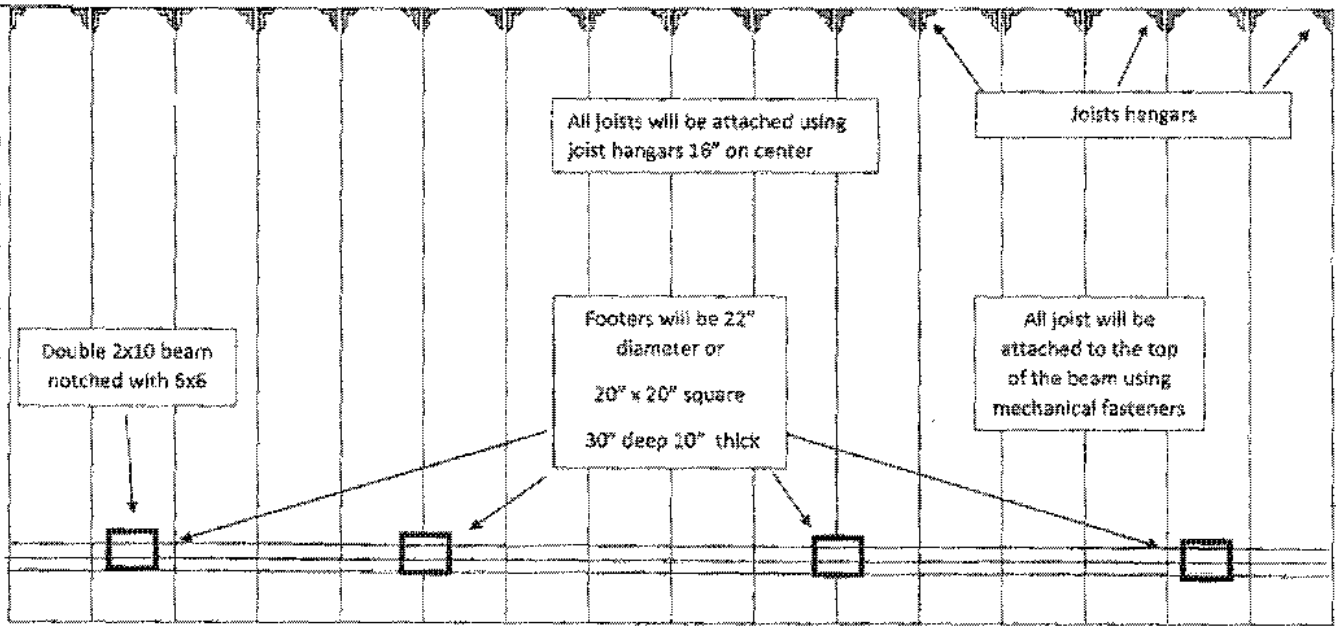

Scale: 1" = 30'

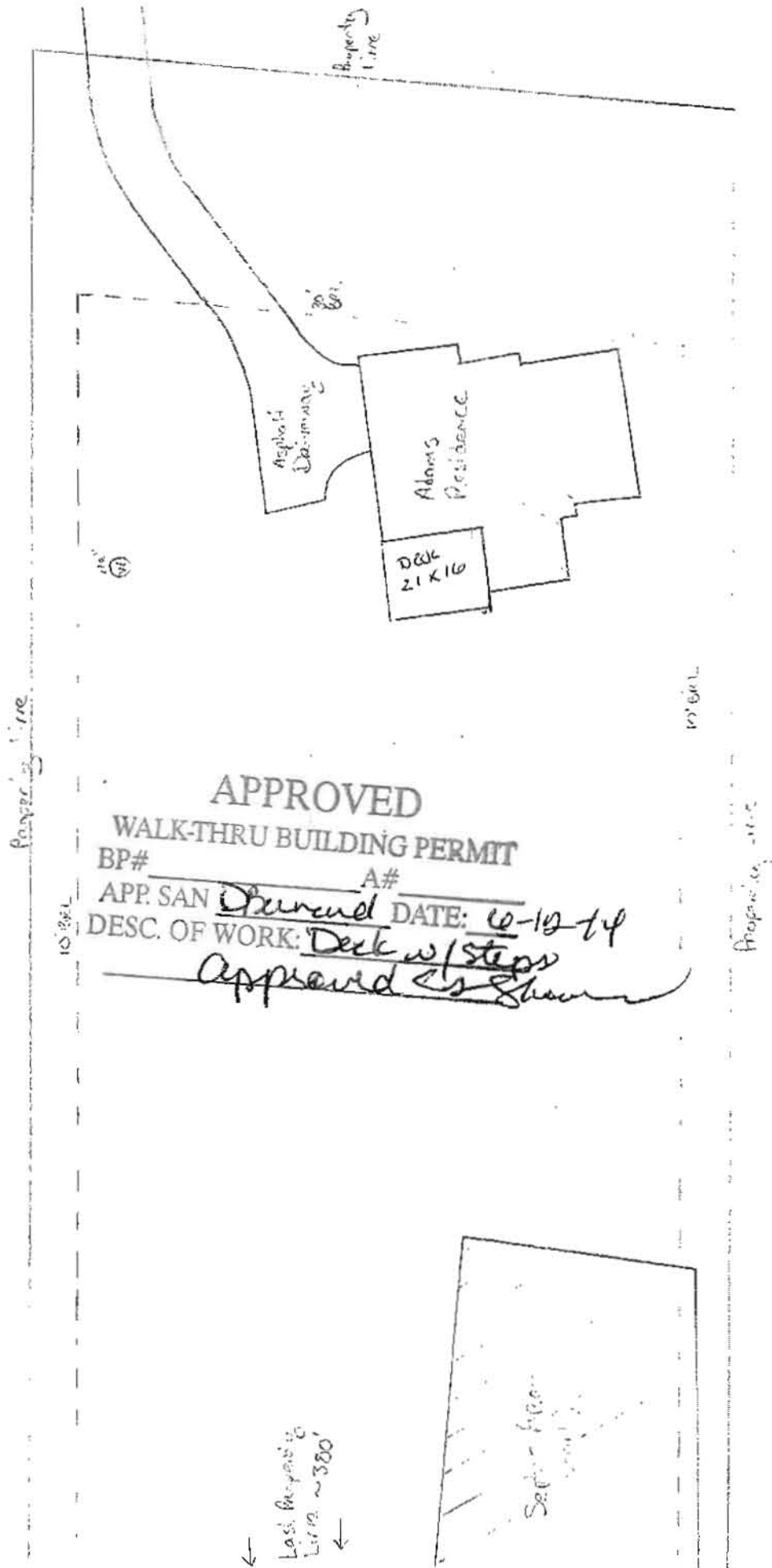

Permits: 410-313-2455
Inspections: 410-313-1810
Automated Line: 410-313-3800

Howard County Building/Fire Permit Application
Department of Inspections, Licenses & Permits
3430 Court House Drive
Ellicott City, MD 21043

Permit Number:

B12002764

Building Address: 1144 Sykesville Rd
Sykesville MD 21787

Suite/Apt. #: _____ SOP/WP/BA #: _____

Census Tract: _____ Subdivision: _____

Section: _____ Area: _____ Lot: _____

Tax Map: _____ Parcel: _____ Grid: _____

Zoning: _____ Map Coordinates: _____ Lot Size: _____

Existing Use: Plan grazing
Proposed Use: above 2nd pad
Estimated Construction Cost: \$ 400
Description of Work: put in an
above ground pull
30 diameter x 52" high

Occupant or Tenant: _____

Was tenant space previously occupied? ☐ Yes ☐ No

Contact Name: _____

Address: _____

City: _____ State: _____ Zip Code: _____

Phone: _____ Fax: _____

Email: _____

Property Owner's Name: Denise Steppen Adams
Address: 144 Sykesville Rd
City: Sykesville State: MD Zip Code: 21787

Home Phone: _____ Work Phone: _____

Applicant's Name & Mailing Address, (if other than stated herein):
SAME

Phone: _____ Fax: _____

Email: _____

Contractor Company: owner
Contact Person: _____
Address: _____
City: _____ State: _____ Zip Code: _____
License No.: _____
Phone: _____ Fax: _____
Email: _____

Engineer/Architect Company: _____
Responsible Design Prof.: _____
Address: _____
City: _____ State: _____ Zip Code: _____
Phone: _____ Fax: _____
Email: _____

BUILDING DESCRIPTION - COMMERCIAL

Building Characteristics	Utilities
Height: _____	<u>Water Supply</u>
No. of stories: _____	<input type="checkbox"/> Public
Gross area, sq. ft./floor: _____	<input type="checkbox"/> Private
Area of construction (sq. ft.): _____	<u>Sewage Disposal</u>
Use group: _____	<input type="checkbox"/> Public
Construction type: _____	<input type="checkbox"/> Private
<input type="checkbox"/> Reinforced Concrete	Electric: <input type="checkbox"/> Yes <input type="checkbox"/> No
<input type="checkbox"/> Structural Steel	Gas: <input type="checkbox"/> Yes <input type="checkbox"/> No
<input type="checkbox"/> Masonry	<u>Heating System</u>
<input type="checkbox"/> Wood Frame	<input type="checkbox"/> Electric <input type="checkbox"/> Oil
<input type="checkbox"/> State Certified Modular	<input type="checkbox"/> Natural Gas <input type="checkbox"/> Propane Gas
<input checked="" type="checkbox"/> Roadside Tree Project Permit	<u>Sprinkler System</u>
<input type="checkbox"/> Yes <input type="checkbox"/> No	<input type="checkbox"/> Full
Roadside Tree Project Permit # _____	<input type="checkbox"/> Partial
	<input type="checkbox"/> Other Suppression
	No. of Heads: _____

BUILDING DESCRIPTION - RESIDENTIAL

Building Characteristics	Utilities
<input type="checkbox"/> SF Dwelling <input type="checkbox"/> SF Townhouse	<u>Water Supply</u>
Depth: _____ Width: _____	<input type="checkbox"/> Public
1 st floor: _____	<input checked="" type="checkbox"/> Private
2 nd floor: _____	<u>Sewage Disposal</u>
Basement: _____	<input type="checkbox"/> Public
<input type="checkbox"/> Finished Basement	<input checked="" type="checkbox"/> Private
<input type="checkbox"/> Unfinished Basement	Electric: <input type="checkbox"/> Yes <input type="checkbox"/> No
<input type="checkbox"/> Crawl Space	Gas: <input type="checkbox"/> Yes <input type="checkbox"/> No
<input type="checkbox"/> Slab on Grade	<u>Heating System</u>
No. of Bedrooms: _____	<input type="checkbox"/> Electric
<u>Multi-family Dwelling</u>	<input type="checkbox"/> Oil
No. of efficiency units: _____	<input type="checkbox"/> Natural Gas
No. of 1 BR units: _____	<input type="checkbox"/> Propane Gas
No. of 2 BR units: _____	
No. of 3 BR units: _____	
Other Structure: _____	
Dimensions: _____	
Footings: _____	<input checked="" type="checkbox"/> Roadside Tree Project Permit
Roof: _____	<input type="checkbox"/> Yes <input type="checkbox"/> No
<input type="checkbox"/> State Certified Modular	<u>Roadside Tree Project Permit #</u>
<input type="checkbox"/> Manufactured Home	

THE UNDERSIGNED HEREBY CERTIFIES AND AGREES AS FOLLOWS: (1) THAT HE/SHE IS AUTHORIZED TO MAKE THIS APPLICATION; (2) THAT THE INFORMATION IS CORRECT; (3) THAT HE/SHE WILL COMPLY WITH ALL REGULATIONS OF HOWARD COUNTY WHICH ARE APPLICABLE THEREON; (4) THAT HE/SHE WILL PERFORM NO WORK ON THE ABOVE REFERENCED PROPERTY NOT SPECIFICALLY DESCRIBED IN THIS APPLICATION; (5) THAT HE/SHE GRANTS CONSENT TO THE RIGHT TO ENTER ONTO THIS PROPERTY FOR THE PURPOSE OF INSPECTING THE WORK PERMITTED AND POSTING NOTICES.

Applicant's Signature: Denise Steppen Adams
Print Name: Denise Steppen Adams
Date: 8/10/12
Email Address: adams@steppenstore.com
Title/Company: * mail to owner

Checks Payable to: DIRECTOR OF FINANCE OF HOWARD COUNTY
PLEASE WRITE NEATLY & LEGIBLY
FOR OFFICE USE ONLY:

AGENCY	DATE	SIGNATURE OF APPROVAL
State Highways		
Building Officials		
PSZA (Zoning)		
PSZA (Engineering)		
Health		<u>8/10/12 R. Bickel</u>
Fire Protection		

Is Sediment Control approval required for issuance? ☐ Yes ☐ No
☐ CONTINGENCY CONSTRUCTION START
☐ ONE STOP SHOP

DPT SETBACK INFORMATION	
Front:	
Rear:	
Side:	
Side St.:	
All minimum setbacks met?	<input type="checkbox"/> Yes <input type="checkbox"/> No
Is Entrance Permit Required?	<input type="checkbox"/> Yes <input type="checkbox"/> No
Historic District?	<input type="checkbox"/> Yes <input type="checkbox"/> No
Lot Coverage for New Town Zone:	
SOP/Red-line approval date:	

Filing Fee	
Filing Fee	\$
Permit Fee	\$ <u>100</u>
Tech Fee	\$ <u>10</u>
Excise Tax	\$
PSFS	\$
Guaranty Fund	\$
Add'l per Fee	\$
Total Fees	\$
Sub- Total Paid	\$
Balance Due	\$ <u>0</u>

#1000 money order



HOWARD COUNTY DEPARTMENT OF PLANNING AND ZONING
3430 Courthouse Drive ■ Ellicott City, Maryland 21043 ■ 410-313-2350

Marsha S. McLaughlin, Director

www.howardcountymd.gov

FAX 410-313-3467

TDD 410-313-2323

March 19, 2007

David and Rose Eide-Altman
1140 Route 32
Sykesville, Maryland 21784

RE: "Parcel II", 2.291 Acre
Part of Tax Map 9, Grid 10, Parcel 96
(the "Property")

Dear David and Rose Eide-Altman:

I am writing in response to your email message dated March 5, 2007, regarding the Property referenced above. In your previous letter, you had asked whether the Property is a legal "buildable lot". You submitted several deeds and a plan as documentation for the creation of the Property.

This Division has evaluated the materials you submitted with your letter, and we have concluded that the Property was created on January 25, 1965 with the recording of a deed in Liber 430 Folio 784; a conveyance which was specifically authorized by the Howard County Planning Commission on January 13, 1965. Based on this conclusion, we consider the Property to be a valid lot for which this Division will grant authorization on a building permit for a single-family detached dwelling, but only if the dwelling fully complies with the current bulk regulations for the RC District, and that you comply with all other government requirements including providing legal access to the Property through the smaller portion of Parcel 96 that adjoins the MD 32 public right-of-way. Please contact the State Highway Administration regarding any access permit requirements.

Section 16.155.(a)(2)(ii) of the Subdivision and Land Development Regulations states that lots in recorded subdivisions created before February 7, 1976 are exempt from site development plan requirements unless more than 5,000 square feet of disturbance is proposed and the lots have not been reconfigured or merged through the recordation of a plat recorded on or after February 7, 1976.

The Property may still be subject to access or plan approval requirements before a building permit may be issued. A copy of this letter should be submitted with a building permit application for a single-family detached dwelling on the Property. If you have additional questions, please contact Bob Lalush at 410-313-4344.

Sincerely,

George L. Beisser, Chief
Division of Public Service
and Zoning Administration

GLB/JRL:jrl