

LAYOUT 11/29/06 INSP 4 \_\_\_\_\_  
INSP 2 11/29/06 INSP 5 \_\_\_\_\_  
INSP 3 \_\_\_\_\_ INSP 6 \_\_\_\_\_

ISSUE DATE: 11/21/06

APPROVAL DATE: \_\_\_\_\_

## PERMIT

P 525649

A 510694

TAX ID # \_\_\_\_\_

**ON-SITE SEWAGE DISPOSAL SYSTEM  
HOWARD COUNTY HEALTH DEPARTMENT  
BUREAU OF ENVIRONMENTAL HEALTH**

Fogle's Septic Clean Inc.

IS PERMITTED TO INSTALL ☒ ALTER ☐

ADDRESS: 580 Obrecht Rd.

PHONE NUMBER: 410-795-5670

SUBDIVISION: \_\_\_\_\_

LOT NUMBER: \_\_\_\_\_

ADDRESS: 14607 Riggs Meadow Drive

PROPERTY OWNER: Maura Cahill

SEPTIC TANK CAPACITY (GALLONS): 1000

OUTLET BAFFLE FILTER REQUIRED ☐

PUMP CHAMBER CAPACITY (GALLONS): \_\_\_\_\_

COMPARTMENTED TANK REQUIRED ☒

NUMBER OF BEDROOMS: \_\_\_\_\_

SQUARE FEET PER BEDROOM: \_\_\_\_\_

180

LINEAR FEET OF TRENCH REQUIRED: \_\_\_\_\_

112

TRENCHES:	Trench to be 3 feet wide. Inlet 3 feet below original grade. Bottom maximum depth 6 feet below original grade. Effective area begins at 4 feet below original grade. 3 feet of stone below distribution pipe.
LOCATION:	
NOTES:	Septic system is for a barn with one bathroom

PLANS APPROVED: SF

DATE: 8/06

NOTE: PERMIT VOID AFTER 2 YEARS

NOTE: CONTRACTOR RESPONSIBLE FOR SCHEDULING A PRE-CONSTRUCTION INSPECTION FOR ALL INSTALLATIONS

NOTE: WATERTIGHT SEPTIC TANKS REQUIRED

NOTE: ALL PARTS OF SEPTIC SYSTEM SHALL BE 100 FEET FROM ANY WATER WELL

NOTE: MANHOLE RISERS REQUIRED ON ALL SEPTIC TANKS AND PUMP CHAMBERS UNLESS SPECIFICALLY AUTHORIZED

**NEITHER THE HOWARD COUNTY COUNCIL NOR THE HEALTH DEPARTMENT IS  
RESPONSIBLE FOR THE SUCCESSFUL OPERATION OF ANY SYSTEM  
PERMITTEE RESPONSIBLE FOR OBTAINING FINAL APPROVAL ON THIS PERMIT  
CALL 410-313-1771 FOR INSPECTION OF SEPTIC SYSTEM**

NOT TO SCALE

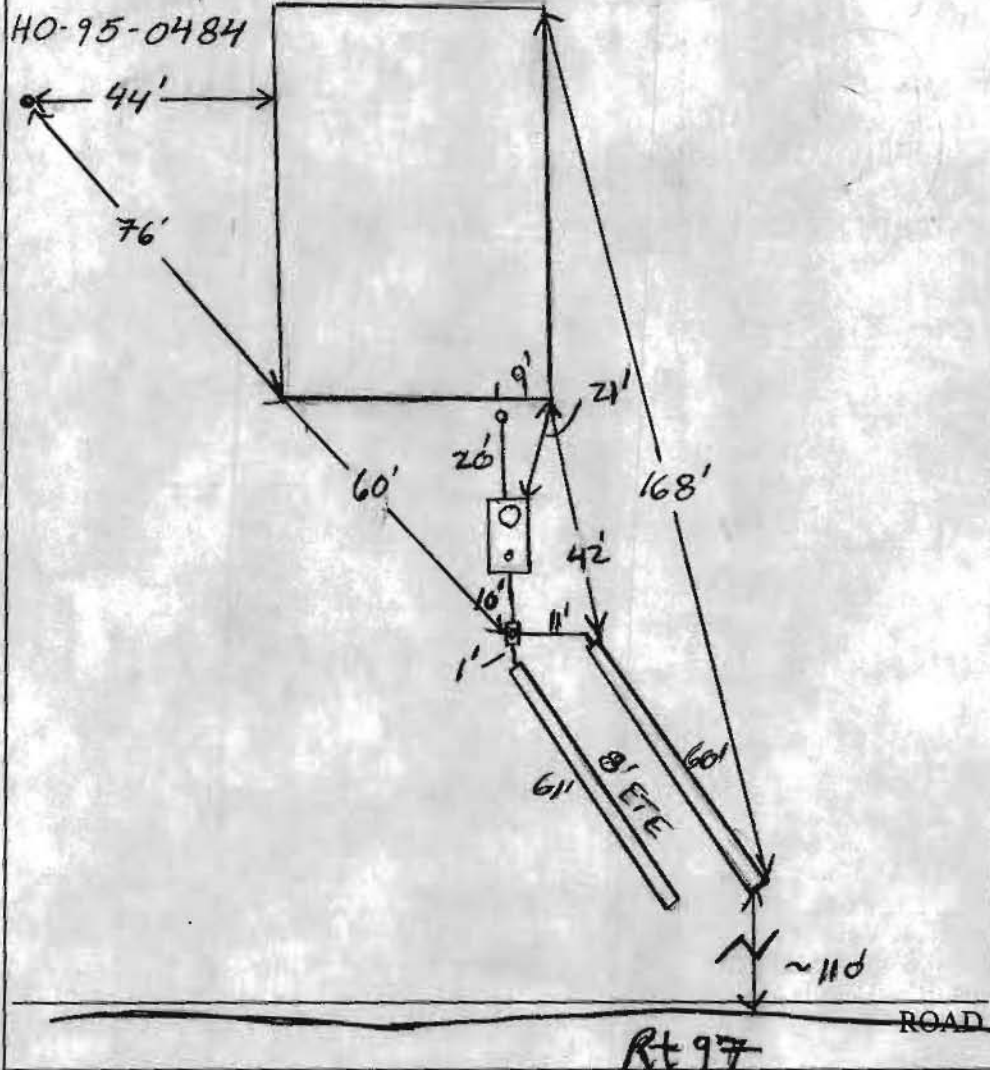

TRENCH/DRAINFIELD DATA		
WIDTH	INLET	BOTTOM
3'	3'	6'
NUMBER OF TRENCHES		2
TOTAL LENGTH		121'
ABSORPTION AREA		363 + SW
DISTRIBUTION BOX LEVEL		Yes (level)
DISTRIBUTION BOX BAFFLE		Yes
DISTRIBUTION BOX PORT		Yes

SEPTIC TANK DATA		
SEPTIC TANK 1 LEVEL		Level
CAPACITY		1500 GAL
SEAM LOC		Top
TANK LID DEPTH		1-1.5'
BAFFLES		Yes
BAFFLE FILTER		—
MANHOLE LOC		Front
6" PORT LOC		Rear
WATERTIGHT TEST		—
<del>SEPTIC TANK 2 LEVEL</del>		
<del>CAPACITY</del>		<del>— GAL</del>
<del>SEAM LOC</del>		<del>—</del>
<del>TANK LID DEPTH</del>		<del>—</del>
<del>BAFFLES</del>		<del>—</del>
<del>BAFFLE FILTER</del>		<del>—</del>
<del>MANHOLE LOC</del>		<del>—</del>
<del>6" PORT LOC</del>		<del>—</del>
<del>WATERTIGHT TEST</del>		<del>—</del>

PRE-CONSTRUCTION 11/29/06 Septic Area Not staked. OK w/ layout due to just being a barn w/ one bathroom. Set D box INSTALLATION top corner nearest to septic tank. Run at least 2 x 60' trenches. 11/29/06 ST set and D box set per installation. Plumbing from c/o @ house to D box installed. No house connection. First trench dug 60'. Rock was hit end of first trench. (KW) 11/29/06 System complete. Needs house connection. (KW)

FINAL INSPECTOR \_\_\_\_\_ DATE OF APPROVAL \_\_\_\_\_