



<b>B 1</b>	SEQUENCE NO. (MDE USE ONLY) <b>45947</b>	<b>STATE OF MARYLAND</b> <b>APPLICATION FOR PERMIT TO DRILL WELL</b> please type <b>W562318</b>	STATE PERMIT NUMBER <b>H0-17-0209</b> fill in this form completely
Date Received (APA) <b>11 01 17</b> 8 MM DD YY 13 <b>McIndoe</b> 15 Last Name <b>Darrell</b> 34 Owner First Name <b>15510 Foxpaw Trail</b> 36 Street or RFD <b>Woodbine MD 21797</b> 57 Town 70 State 72 Zip 76		<b>B 3</b> LOCATION OF WELL <b>Howard</b> 8 COUNTY 21 <b>Foxpaw</b> 23 SUBDIVISION 42 SECTION <b>44 46</b> LOT <b>18</b> <b>Woodbine</b> 52 NEAREST TOWN 71	
<b>DRILLER INFORMATION</b> <b>Edward Gross</b> Driller's Name 76 License No. 81 <b>MWD 580</b> <b>Long Green Drilling</b> Firm Name <b>12238 Long Green Pike Suite A Glen Burnie</b> Address <b>[Signature]</b> Signature Date <b>10/20/17</b>		<b>B 4</b> SOURCES OF DRILLING WATER 1. <b>Public</b> 2. 3. <b>15510 Foxpaw trail</b> 11 STREET ADDRESS 30 ON WHICH SIDE OF ROAD (CIRCLE APPROPRIATE BOX) NORTH WEST <input checked="" type="radio"/> EAST SOUTH 34 <b>310</b> 37 DISTANCE FROM ROAD ENTER FT OR MI 38 39 TAX MAP: <b>14</b> BLK: <b>3</b> PARCEL <b>233</b>	
<b>B 2</b> WELL INFORMATION 1 APPROX. PUMPING RATE (GAL. PER MIN.) 8 12 2 AVERAGE DAILY QUANTITY NEEDED (GAL. PER DAY) 14 20		<b>NOT TO BE FILLED IN BY DRILLER</b> <b>HEALTH DEPARTMENT APPROVAL</b> <b>HOWARD</b> COUNTY NAME STATE SIGNATURE DATE ISSUED <b>11/22/17</b> 43 MM DD YY 48 CO SIGNATURE <b>[Signature]</b> EXP. DATE <b>11/22/18</b> 41	
<b>USE FOR WATER</b> (CIRCLE APPROPRIATE BOX) [D] DOMESTIC POTABLE SUPPLY & RESIDENTIAL IRRIGATION [F] FARMING (LIVESTOCK WATERING & AGRICULTURAL IRRIGATION) 22 [I] INDUSTRIAL, COMMERCIAL, DEWATERING [P] PUBLIC WATER SUPPLY WELL [T] TEST, OBSERVATION, MONITORING [O] OPEN LOOP GEOTHERMAL [C] CLOSED LOOP GEOTHERMAL <b>6x Geothermal</b>		PROPOSED LOCATION OF WELL ON LOT SHOW PERMANENT STRUCTURES SUCH AS BUILDINGS, SEPTIC SYSTEM, ROADS AND/OR LANDMARKS AND INDICATE NOT LESS THAN TWO DISTANCE MEASUREMENTS TO WELL <b>Kelly</b> <b>20'</b> <b>Dunahue</b>	
APPROXIMATE DEPTH OF WELL <b>215</b> FEET 24 28 APPROXIMATE DIAMETER OF WELL <b>6</b> INCH NEAREST		METHOD OF DRILLING (circle one) BORED (or Augered) JETTED Jetted & DRIVEN 30 AIR-ROTARY AIR-PERCUSSION ROTARY (Hydraulic Rotary) 37 CABLE REVERSE-ROTARY DRIVE-POINT other	
<b>REPLACEMENT OR DEEPEMED WELLS</b> (CIRCLE APPROPRIATE BOX) [N] THIS WELL WILL NOT REPLACE AN EXISTING WELL [Y] THIS WELL WILL REPLACE A WELL THAT WILL BE ABANDONED AND SEALED 39 [S] THIS WELL WILL REPLACE A WELL THAT WILL BE USED AS A STANDBY-CONTACT LOCAL APPROVING AUTHORITY FOR POLICY ON STANDBY WELLS [D] THIS WELL WILL DEEPEMED AN EXISTING WELL PERMIT NUMBER OF WELL TO BE REPLACED OR DEEPEMED (IF AVAILABLE) 41 52		Pursuant to § 10-624 of the State Govt. Article of the Maryland Code, personal info requested on this form is used in processing this form pursuant to COMAR 26.04.04. Failure to provide the info may result in this form not being processed. You have the right to inspect, amend, or correct this form. The Maryland Department of the Environment is subject to the Maryland Public Information Act. This form may be made available on the Internet via MDE's website and is subject to inspection or copying, in whole or in part, by the public and other governmental agencies, if not protected by federal or State Law.	
Not to be filled in by driller (MDE OR COUNTY USE ONLY) APPROP. PERMIT NUMBER <b>G</b> PERMIT No. <b>H0-17-0209</b> 70 71 72 73 74 75 76 77 78 79		SPECIAL CONDITIONS NOTE: APPROVING AUTHORITIES SHOULD USE SEPARATE SHEET IF NEEDED	



## Bureau of Environmental Health

8930 Stanford Blvd, Columbia, MD 21045  
Main: 410-313-2640 | Fax: 410-313-2648  
TDD 410-313-2323 | Toll Free 1-866-313-6300  
[www.hchealth.org](http://www.hchealth.org)

Facebook: [www.facebook.com/hocohealth](https://www.facebook.com/hocohealth)  
Twitter: HowardCoHealthDep

**Dr. Maura J. Rossman, M.D., Health Officer**

---

### **NOTICE OF VIOLATION**

**SENT VIA CERTIFIED MAIL:  
RETURN RECEIPT REQUESTED  
7004 1160 0002 3409 5615**

February 6<sup>th</sup>, 2018

Edward Gross MWD 580  
Long Green Drilling  
12238 Long Green Pike  
Suite A  
Glen Arm, MD 21057

**RE: Failure to notify the Health Department of drilling activities**  
15510 Foxpaw Trail  
Woodbine, MD 21797  
Tax Map 0014, Grid 0003, Parcel 0233

Dear Edward Gross,

Please read the following timeline of the events regarding the cluster of geothermal bores at 15510 Foxpaw Trail:

On 11/21/2017, a site visit was made to the property to inspect the staking of the cluster wells. Stakes 2 and 3 were moved to meet 20' setback from building foundation. The Maryland Department of the Environment (MDE) well permit was approved and sent via mail to the driller.

On 01/25/2018, the completion report was received in the Howard County Environmental Health Office for the geothermal bores that were drilled.

During the time period from the release of the MDE well permit on 11/22/2017 to the accessioning of the MDE well completion report on 01/25/2018, the Howard County Health Department Well and Septic program was not notified of well drilling activities.

The *Code of Maryland Regulations (COMAR) 26.04.04.14B(2)* states:

*[Of] Nonpotable, monitoring, and Geothermal Wells, (2) The permittee shall notify the Approving Authority on the business day prior to commencing well drilling activities of geothermal wells.*

Mr. Gross is in violation of the above referenced section of *COMAR*.

On February 5<sup>th</sup>, 2018 I notified Mr. John Boris with the Maryland Department of the Environment Wastewater Permits Program of these actions. Mr. Boris stated that Mr. Gross is in violation of *COMAR* section 26.04.04.14B(2).

This Notice of Violation is issued based on the referenced section of *COMAR*. Given these findings, the next step will be a meeting between Mr. Gross, Mr. Boris and the Health Department. This meeting will discuss the situation in full detail including explanations and compliance. Please contact the Health Department with **15 days** of receipt of this notice to schedule a meeting.

If you have any questions regarding this letter, please contact me at the Bureau of Environmental Health at 410-313-1771.

Sincerely,

A large, stylized handwritten signature in dark ink, appearing to read 'Joseph Cabahug', is written over a large, loopy oval shape.

Joseph C. Cabahug - LEHS  
Environmental Health Specialist  
Howard County Health Department - Well & Septic Program  
Bureau of Environmental Health  
8930 Stanford Blvd.  
Columbia, MD 21045

Cc: Maryland Department of the Environment, John Boris  
Executive Director, Maryland Board of Well Drillers, Elaine Nolen  
Homeowner, Darrell McIndoe  
File



# FILE INQUIRY NOTES 15510 Fox Paw Trl

DATE	RESULTS OF REVIEW FOR FILE
1/31/2018	410 510 7216 - Google listing incorrect
	443 372 5759 - Website phone # out of service
	(10:15) - 2 call attempts
	- 12:00 Met in field @ 14671 V. burnum Dr
	Office is a mess. Has a secretary.
	Usually reaching out in person for
	potable drinking activities. Every
	inspector is different (1)
2/5/18	Called J. Boris. - Confirmed violation
	+ recommended Letter w/ <sup>(enforce)</sup> stat
	Letter notification or full Nov (10)
2/6/18	Nov Sent out Cert Mail # 7004 1160 0002 3409 5618 (1)
2/14/18	Call w/ Driller - First attempt 09:30 (1)
	<input type="checkbox"/> Confirm Policy
	<input type="checkbox"/> Completion Report Approved - Scanned w/ Nov
2/16/18	Call w/ Ed Gross w/ Long Green (1)
	<input checked="" type="checkbox"/> Confirm Policy
	<input checked="" type="checkbox"/> Completion Report Approved
2/20/18	Completion Report sent for scan w/ Nov (10)

SITE INSPECTION SHEET

OWNER: Darnell Melndoe PHONE #: ~~None~~ 410 409 2260  
ADDRESS: 15510 Fox Paw Trail CONTRACTOR: Long Green Drilling  
Woodbine, MD WELL TAG #: H0-17-0209  
SUBDIVISION: N/A LOT: N/A COUNTY #: XII  
PROPOSAL: Construct 6 Bore vertical geothermal loops.

LOCATION DIAGRAM

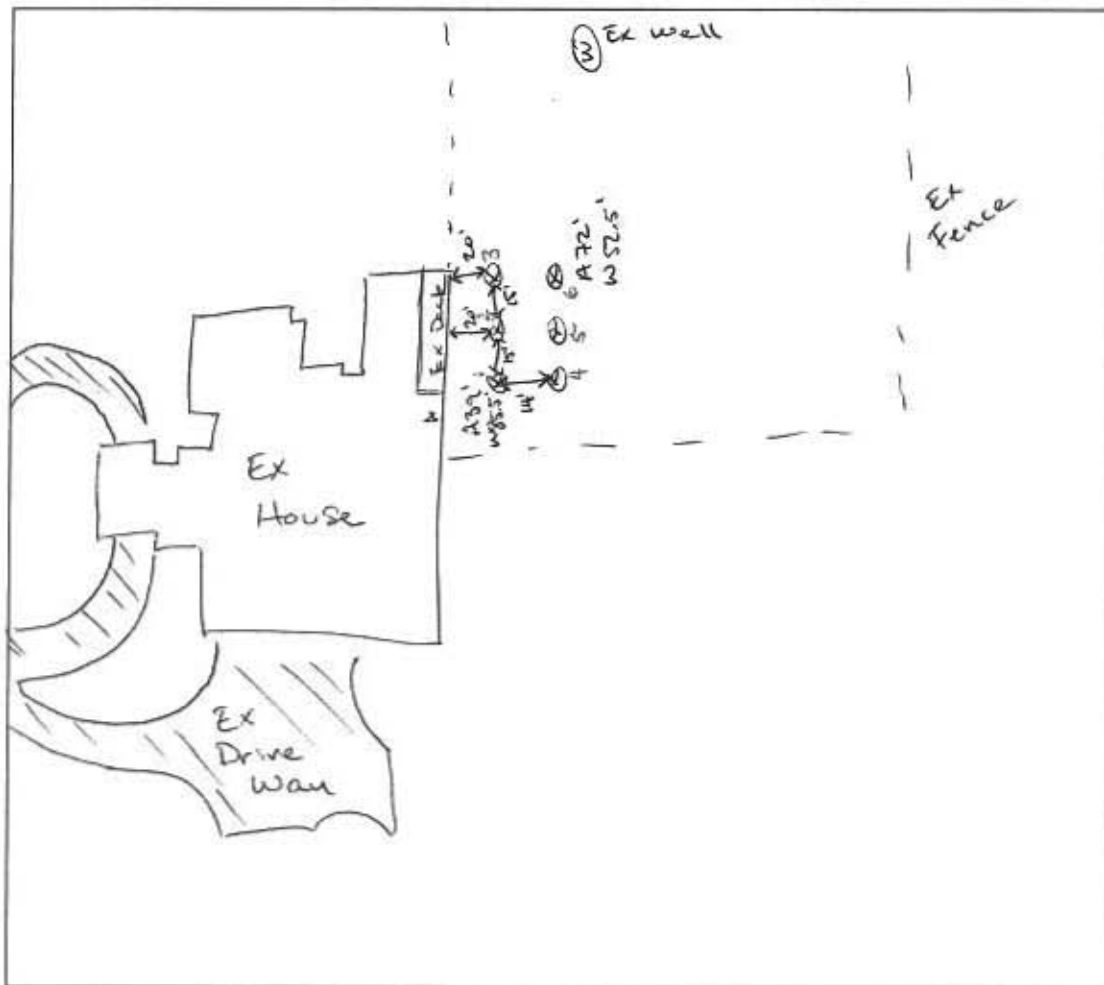

COMMENTS: 11/21/2017 Adjusted the well stakes 2 and 3  
to meet 20' from foundation setback.

DATE: 11/21/2017

INSPECTOR: *[Signature]*

FENCE  
LINE

EXISTING SEPTIC FIELD

EXISTING 1500 GALLON  
SEPTIC TANK

WELL

Geothermal  
Cells

MCINDOE  
RESIDENCE

15510 Foxglove Trail  
Woodbine, MD

50 scale

As-17-0209

Approved 11/22/2017

Staked by Driller

Checked by (se)

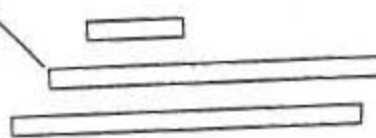
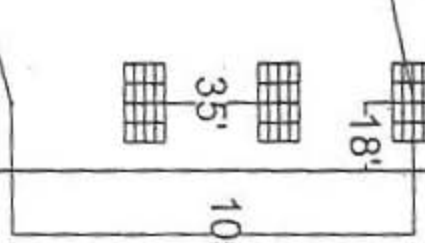
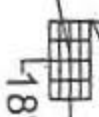
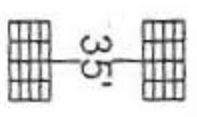
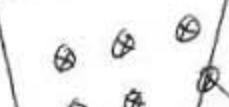
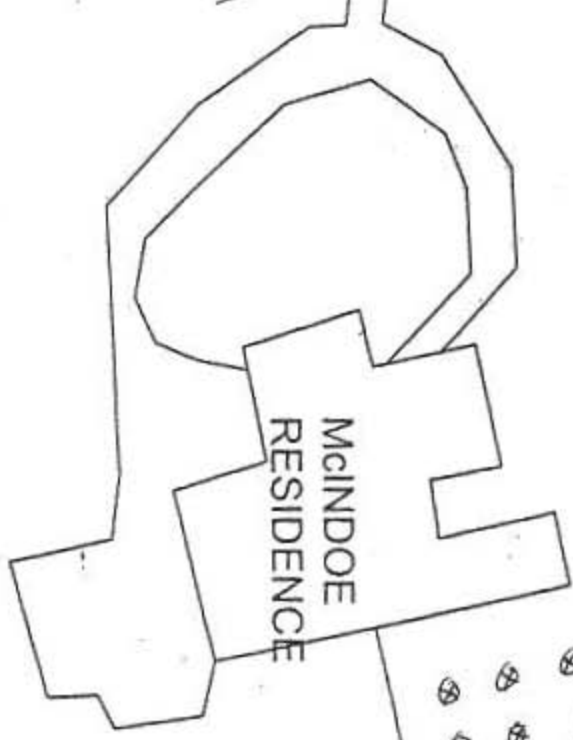
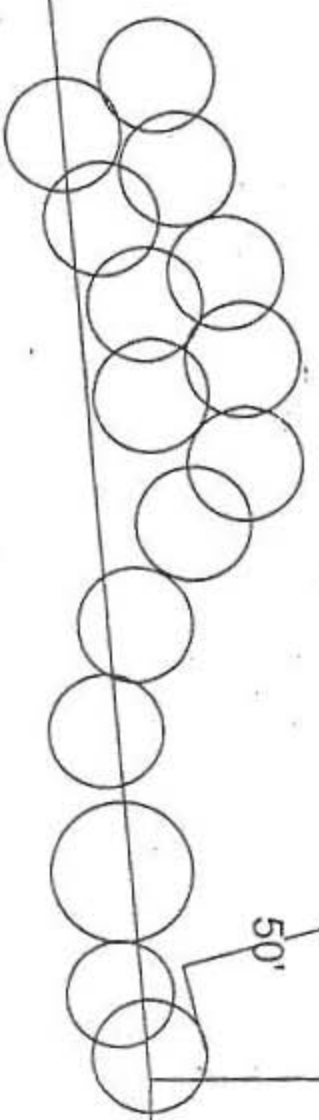

50'

100'

18'

35'

105'

386'

100'

100'

# Borehole Cross Section

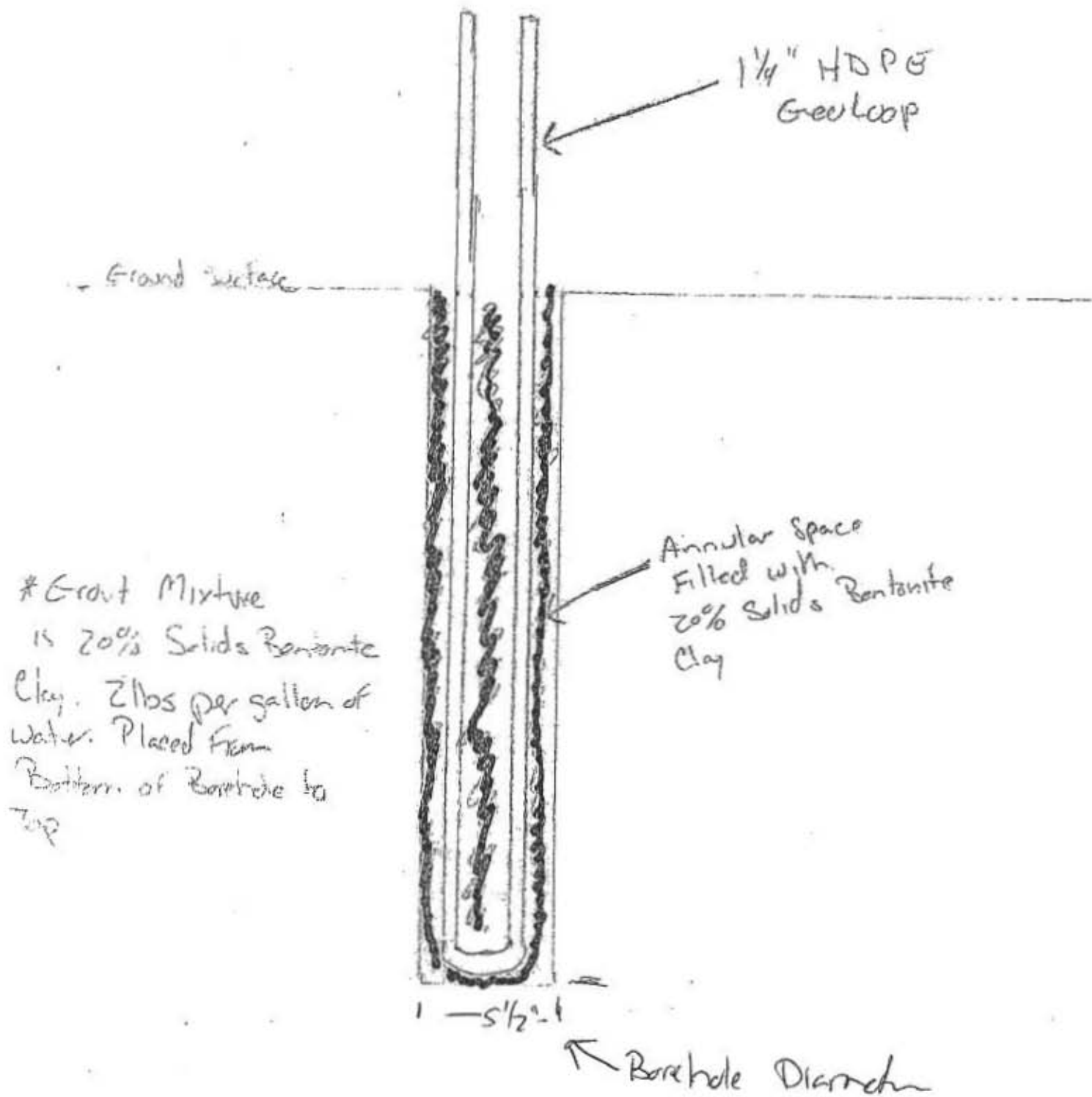



FENCE  
LINE

EXISTING SEPTIC FIELD

EXISTING 1500 GALLON  
SEPTIC TANK

Geothermal  
Wells

WELL

MCINDOE  
RESIDENCE

15510 Foxgaw Trail  
Woodbine, MD

50 scale

386'

100'

18'

105'

35'

50'

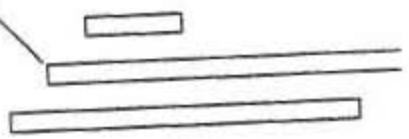
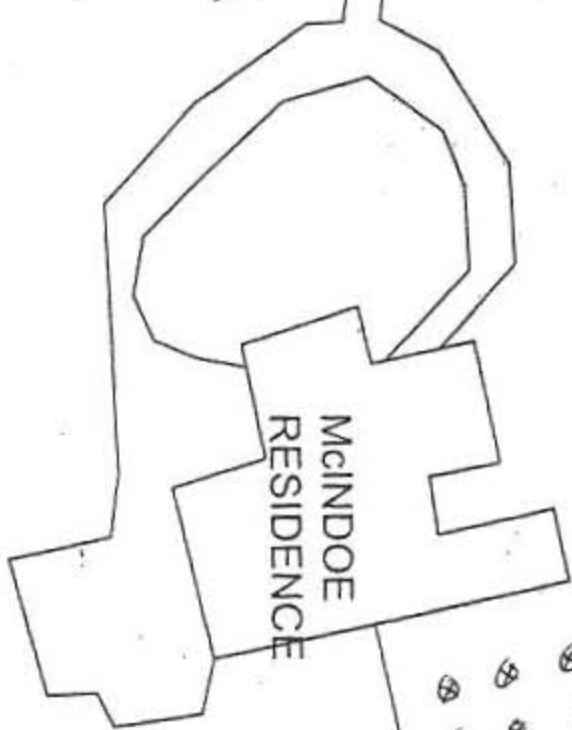
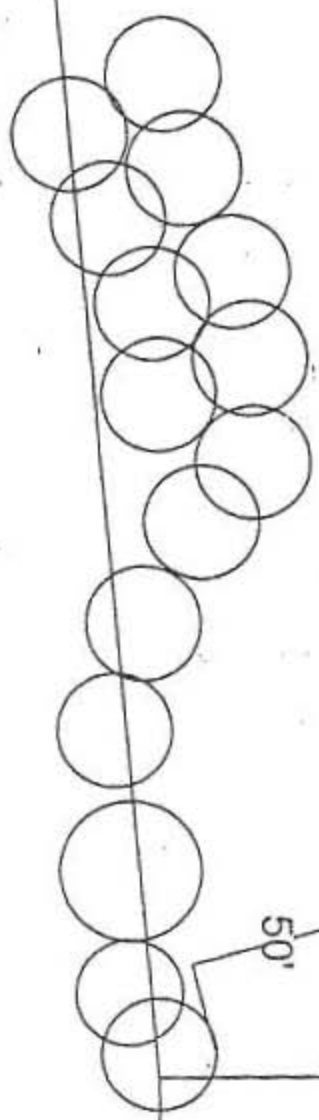



# HOWARD COUNTY HEALTH DEPARTMENT

62318

DATE 11/10/17

WS

Received From

Long Green

5, 16, 18

PHONE #

443-372-5759

For

WCC Permit/15510 Foxpaw Trail



CASH



CHECK

NO.

2258

One hundred sixty

Dollars

\$

160.00

Received By

King