

APPLICATION

FOR PERCOLATION TESTING AND SITE EVALUATION

TEST DATE(S) _____ TEST TIME _____

CAIP 536707

AGENCY REVIEW: _____

DATE 1-26-12

DO NOT WRITE ABOVE THIS LINE

I HEREBY APPLY FOR THE NECESSARY TESTING/EVALUATION PRIOR TO ISSUANCE OF SEWAGE DISPOSAL SYSTEM PERMIT(S) TO:

CHECK AS NEEDED:

- ☐ CONSTRUCT NEW SEPTIC SYSTEM(S)
☒ REPAIR/ADD TO AN EXISTING SEPTIC SYSTEM
☐ REPLACE AN EXISTING SEPTIC SYSTEM

CHECK AS NEEDED:

- ☐ NEW STRUCTURE(S)
☐ ADDITION TO AN EXISTING STRUCTURE
☐ REPLACE AN EXISTING STRUCTURE

CHECK ONE:

- ☐ CREATE NEW LOT(S)
☐ BUILD ON AN EXISTING LOT IN A SUBDIVISION
☐ BUILD ON AN EXISTING PARCEL OF RECORD

IS THE PROPERTY WITHIN 2500' OF ANY RESERVOIR?

- ☐ YES
☒ NO

THE TYPE OF STRUCTURE IS:

- ☒ RESIDENTIAL WITH 4 PROPOSED BEDROOMS IN THE COMPLETED STRUCTURE (NOTE **UNKNOWN** IF APPROPRIATE)
☐ COMMERCIAL (PROVIDE DETAIL OF NUMBERS AND TYPES OF EMPLOYEES/ CUSTOMERS ON ACCOMPANYING PLAN)
☐ INSTITUTIONAL/GOVERNMENT (PROVIDE DETAIL OF NUMBERS AND TYPES OF EMPLOYEES/USERS ON ACCOMPANYING PLAN)

PROPERTY OWNER(S) Mark Grimm

DAYTIME PHONE 443-852 2322 CELL _____

FAX _____

MAILING ADDRESS 14340 Tridelphia Mill Rd Dayton MD 21036
STREET CITY/TOWN STATE ZIP

APPLICANT Hatfield Equipment

DAYTIME PHONE 410 984-0042 CELL _____

FAX 301 490 5794

MAILING ADDRESS PO Box 519 Annapolis Junction MD
STREET CITY/TOWN STATE ZIP

APPLICANT'S ROLE: DEVELOPER septic contractor BUILDER BUYER RELATIVE/FRIEND REALTOR CONSULTANT

PROPERTY LOCATION

SUBDIVISION/PROPERTY NAME _____

LOT NO. _____

PROPERTY ADDRESS 14340 Tridelphia Mill Rd Dayton MD
STREET TOWN/POST OFFICE

TAX MAP PAGE(S) _____ GRID _____ PARCEL(S) _____ PROPOSED LOT SIZE _____

AS APPLICANT, I UNDERSTAND THE FOLLOWING: THE SYSTEM INSTALLED SUBSEQUENT TO THIS APPLICATION IS ACCEPTABLE ONLY UNTIL PUBLIC SEWERAGE IS AVAILABLE. THIS APPLICATION IS COMPLETE WHEN ALL APPLICABLE FEES AND A SUITABLE SITE PLAN HAVE BEEN RECEIVED. I ACCEPT THE RESPONSIBILITY FOR COMPLIANCE WITH ALL M.O.S.H.A. AND "MISS UTILITY" REQUIREMENTS. APPROVAL IS BASED UPON SATISFACTORY REVIEW OF A PERC CERTIFICATION PLAN.

TEST RESULTS WILL BE MAILED TO APPLICANT.

JFB Reitz
SIGNATURE OF APPLICANT

HOWARD COUNTY HEALTH DEPARTMENT, BUREAU OF ENVIRONMENTAL HEALTH, WELL AND SEPTIC PROGRAM
7178 COLUMBIA GATEWAY DRIVE COLUMBIA, MARYLAND 21046 (410) 313-2640 FAX (410) 313-2648
TDD (410) 313-2323 TOLL FREE 1-877-4MD-DHMH

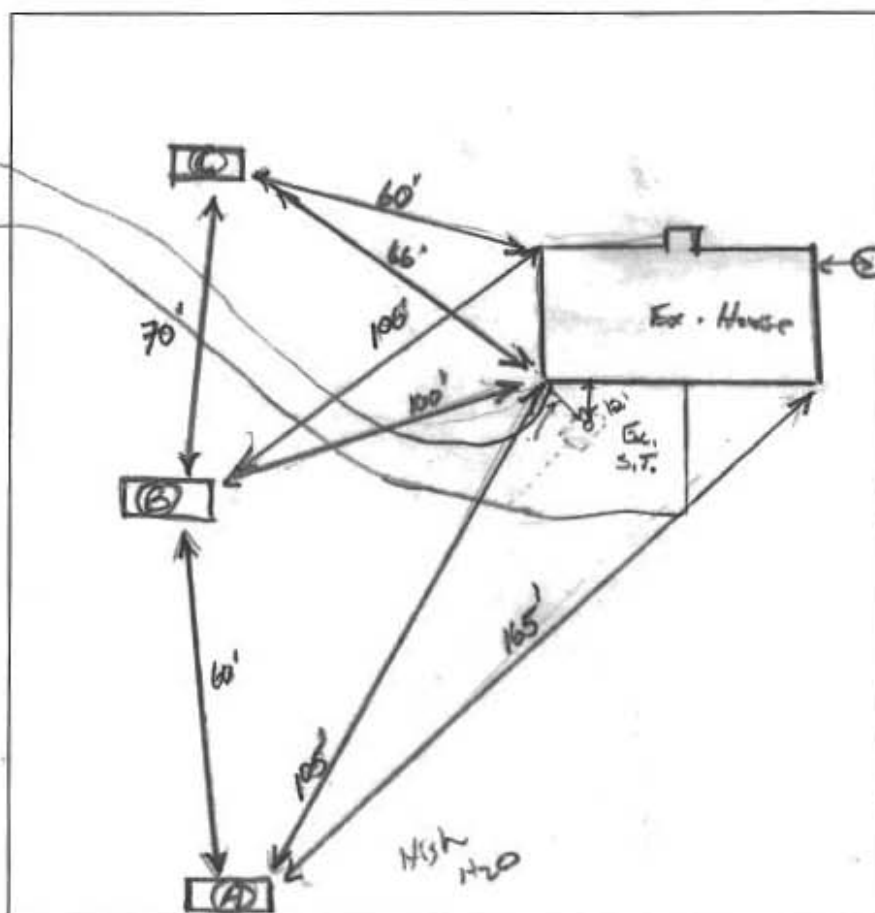

Ex. Well
Buried
(Apr. 1, Day up
by Homeowner)

④

msBX	3
Br/Red. ZSBX	
CL Frangible	14
slightly red	
Frangible, L	
miscous,	
silty soil	3
VFSH Frangible	

Dry,
conducive
many in ca
many roots

↓
H₂O

14.

[illegible]

H₂O poured in buffer hole (12:02) OK ✓

REMARKS: H_2 , H_2O , tables / H_2 (A) OK for shallow system Problem 5!

SANITARIAN K. Wolf BACKHOE Donna S. OTHERS Jeff

TEST HOLES USED IN SDA _____ AVG. PERC TIME _____ SQ. FT/BR _____

TRENCH WIDTH 3' INLET DEPTH 3' MAX. BOT DEPTH 6' EFFECTIVE S/W 4'

$$150(4) = \frac{600}{0.6} = 1000 \div 3 = 333(55) = 182 \text{ LF}$$

2x10'
Top - 3-6'
Bottom - 2-5'

(A)

on m.s.B.K.
s.s.B.K., Dried
Br, Yellow sil
many mica
slightly sticky

due beam
many roots
many mica
friable, wk blocky

↓
w sil

water seep
silica
slightly

(3)

msok Br.
rocks, dm
Br./Red CL
msok,
rocks, Forable
fine sil.
Highly calcareous,
many roots,
modest consistency
Slightly
sticky
pliable
↓
vf sil.
sticky
under
scrape

12ⁿ



HOWARD COUNTY HEALTH DEPARTMENT

36707

DATE

01/26/2002

A5

Received
FromHartfield Equipment
PO Box 519

PHONE #

(301) 554-4772

☐ CASH☒ CHECK

NO.

3037

For

Kymber Koro - 17340 Tuxedo
Mill Rd.

\$

105.00

Received By

Granita King

Dollars