

PERMIT

SEWAGE DISPOSAL SYSTEM

DEPARTMENT OF HEALTH AND MENTAL HYGIENE

P 57372

A 49019

DISTRICT _____

DATE 10/31/96

DATE SYSTEM APPROVED 4/24/98

INSPECTOR [Signature]

HOWARD COUNTY HEALTH DEPARTMENT

BUREAU OF ENVIRONMENTAL HEALTH

~~XXXX-XXXX~~

INDEXED

WTC III Plumbing & Heating, Inc.

IS PERMITTED TO INSTALL X ALTER _____

ADDRESS 1820 Gillis Falls Road, Woodbine, Maryland 21797 PHONE 489-4457

SUBDIVISION West Friendship Estates LOT 18 ROAD 3192 River Valley Chase

PROPERTY OWNER Dorsey Builders / Nash

ADDRESS _____

SEPTIC TANK CAPACITY 1250 GALLONS

***CALL FOR INSPECTION PRIOR TO BEGINNING
INSTALLATION***

NUMBER OF BEDROOMS 4

240 SQUARE FEET PER BEDROOM

LINEAR FEET OF TRENCH REQUIRED 320

$$\begin{array}{r} 240 \\ \times 4 \\ \hline 3120 \\ 25 \end{array}$$

TRENCHES - Trench to be 3 feet wide. Inlet 3 feet below original grade. Bottom maximum depth 5 feet below original grade. Effective area begins at 3 feet below original grade. 2 feet of stone below distribution pipe.

LOCATION - Beginning from the intersection of the 229.82' and 81.92' lot lines, place distribution box 195 feet up the 229.82' lot line and 20 feet off that same lot line as seen when facing the lot from River Valley Chase.

NOTES - No trench to exceed 100 feet in length. Provide 6" - 8" diameter cleanout and cap to grade or above on septic tank.

PLANS APPROVED BY Amy McMillen DATE 08/25/96

COVER NO WORK UNTIL INSPECTED AND APPROVED

NEITHER THE HOWARD COUNTY COUNCIL NOR THE HEALTH DEPARTMENT IS RESPONSIBLE FOR THE SUCCESSFUL OPERATION OF ANY SYSTEM

NOTE: CLEANOUT REQUIRED EVERY 70 FEET OF SEWER LINE AND/OR AT 90° SWEEPS IN LINES FROM HOUSE TO DRAIN FIELDS, 90° ELBOWS NOT ACCEPTABLE.

NOTE: ALL PARTS OF SEPTIC SYSTEMS (I.E. TANK, DISTRIBUTION BOX TRENCHES) TO BE 100 FEET FROM WELL (UNLESS OTHERWISE SPECIFICALLY AUTHORIZED)

NOTE: IF DEEP TRENCH(ES) ARE USED CALL FOR INSPECTION BEFORE AND AFTER PLACING GRAVEL IN TRENCH(ES)

NOTE: NO DRY WELL SHALL EXCEED 15 FOOT IN DIAMETER NO ABSORPTION TRENCH TO EXCEED 100 FEET IN LENGTH

NOTE: ALL PIPE FROM HOUSE TO SEPTIC TANK MUST BE CAST IRON OR SCHEDULE 35/40 PVC OR ABS

PERMIT VOID AFTER TWO YEARS

NOTE: INSTALL STAND PIPE ON SEPTIC TANK AND DRY WELL STAND PIPES MUST BE 6 INCHES IN DIAMETER CAST IRON, CONCRETE OR TERRA COTTA OR PVA OR ABS ACCEPTED. IF TOP OF SEPTIC TANK IS DEEPER THAN 3 FEET, MANHOLE TO GRADE REQUIRED.

NOTE: DISTRIBUTION BOXES MUST HAVE BAFFLES

*INSTALLER IS RESPONSIBLE FOR OBTAINING FINAL APPROVAL ON THIS PERMIT

HD-260(6-90)

*CALL 481-9933 FOR INSPECTION OF SEPTIC SYSTEM.

BLDG. PERMIT SIGNED

AND RETURNED 4-24-98

Serial # 810111242

2. final check

A 49019

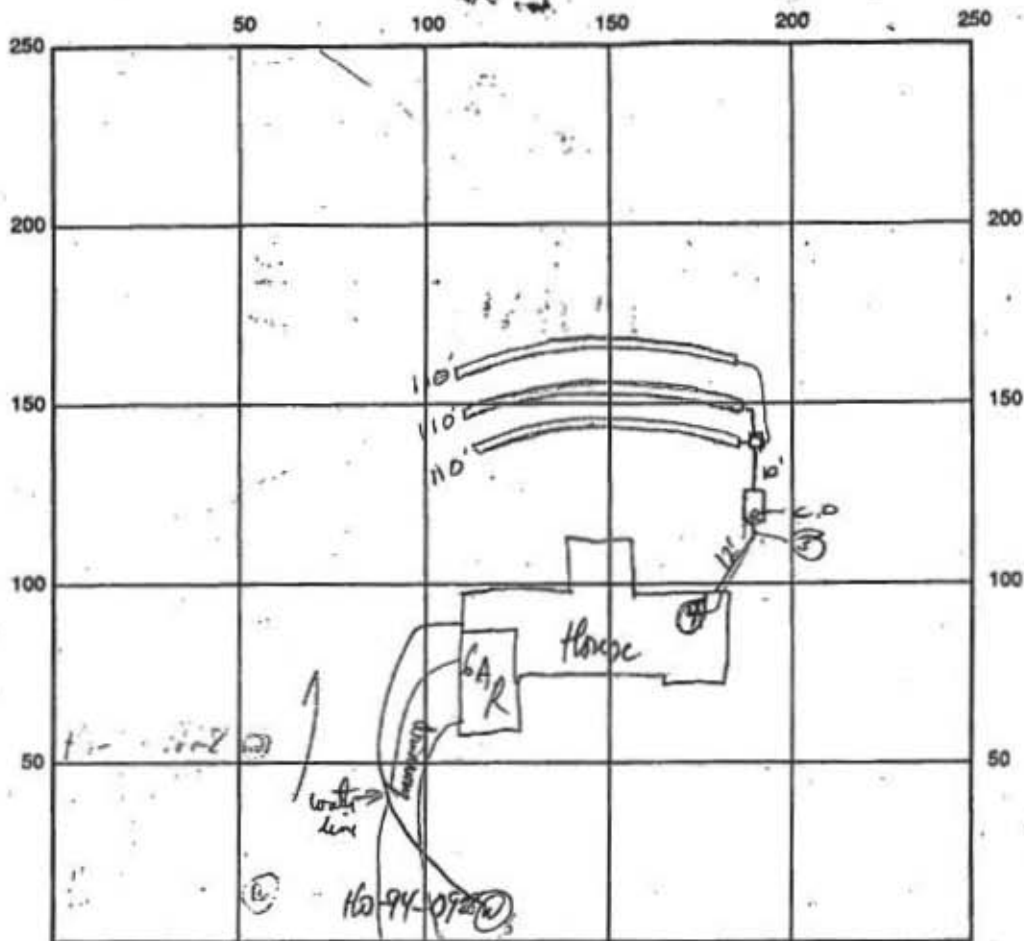

INDICATE NORTH - NAME ADJOINING ROADWAY AS BASE LINE

SEPTIC TANK LEVEL OK 1250 gal OK CLEANOUTS OK

DISTRIBUTION BOX LEVEL OK Daffin 15 in

DRAIN FIELD/TITLE DEPTH 5.0 FT. TRENCH WIDTH 3.0 FT. INLET DEPTH 3.0 FT.

EFFECTIVE GRAVEL DEPTH 2.0 FT. TOTAL LENGTH 330 FT.

NUMBER OF TRENCHES 3 ONE SIDEWALL/BOTTOM AREA 990 SQ. FT.

DRYWALL INSIDE DIAMETER FT. EFFECTIVE DEPTH BELOW INLET FT.

ABSORBENT AREA SQ. FT.

REMARKS: 11/1/96 Installer began 1st trench - reported no rock - I told him
to proceed ALM OK to cover all work - call for inspection
when house connection is made ALM 1/6/97 TRENCHES OPEN, EVIDENCE OF
SIGNIFICANT DRAINAGE INTO LOWEST TRENCH, 2" OF SILT IN PORTION OF TRENCH, ENTIRE LOT HAS BEEN COVERED
PRIOR TO SEPTIC INSTALLATION, EVIDENCE OF EROSION, CONDITION OF TOP 2 TRENCHES NOT KNOWN. 1/9/97
SYSTEM COVERED. 4/24/97 Home Construction OK 4/24/97
 DATE SYSTEM APPROVED 11/1/96 INSPECTOR Amy McMullen