



# HOWARD COUNTY HEALTH DEPARTMENT

62923

DATE  
3/21/18

Received  
From

Togles Septic Clean

PHONE #

795 5670

For

100116 / 11/18 Spring  
haul off

☐ CASH

☒ CHECK

NO.

100116

One hundred eighty-four

Dollars

\$

165.14

Received By

Thompson

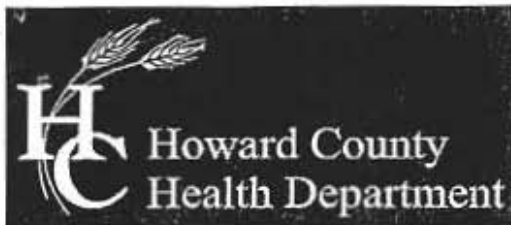

# Bureau of Environmental Health

8930 Stanford Boulevard, Columbia, MD 21045

Main: 410-313-2640 | Fax: 410-313-2648

TDD 410-313-2323 | Toll Free 1-866-313-6300

www.hchealth.org

Facebook: www.facebook.com/hocohealth

Twitter: HowardCoHealthDep

Maura J. Rossman, M.D., Health Officer

156923

## APPLICATION

### FOR PERCOLATION TESTING AND SITE EVALUATION

#### PROPERTY LOCATION

SUBDIVISION/PROPERTY NAME

PROPERTY ADDRESS 11718 Springhaven Ct Ellicott City, Md. 21042  
STREET TOWN ZIP

TAX ACCOUNT # TAX MAP 0023 GRID 0021 PARCEL 0126 LOT NO. 61 PROPOSED LOT SIZE (ACRES) 3.22

ZONING CATEGORY TIER

PROPERTY OWNER(S) Wayne Bohn

DAYTIME PHONE 479-381-0469 CELL EMAIL

MAILING ADDRESS 11718 Springhaven Ct. Ellicott City, Md. 21042  
STREET CITY, STATE ZIP

APPLICANT Fogle's Septics RELATIONSHIP TO OWNER:

DAYTIME PHONE 410-795-5670 CELL EMAIL

MAILING ADDRESS  
STREET CITY, STATE ZIP

I HEREBY APPLY FOR THE NECESSARY TESTING/EVALUATION PRIOR TO ISSUANCE OF SEWAGE DISPOSAL SYSTEM PERMIT(S):

#### PROPERTY:

- ☐ SUBDIVISION: NUMBER OF LOTS INCLUDING RESIDUE: SUBDIVISION CLASSIFICATION (PER DEPT. OF PLANNING AND ZONING) ☐ MAJOR ☐ MINOR
- ☐ CONSTRUCT NEW OSDS ON UNDEVELOPED LOT
- ☐ REPAIR OR REPLACE FAILING OSDS
- ☐ UPGRADE EXISTING OSDS

#### BUILDING:

- ☐ RESIDENTIAL WITH EXISTING OR PROPOSED BEDROOMS IN THE COMPLETED STRUCTURE
- ☐ COMMERCIAL (PROVIDE DETAIL OF TYPE OF USE AND NUMBERS OF EMPLOYEES/CUSTOMERS ON ACCOMPANYING PLAN)

IS THE PROPERTY WITHIN 2500 FEET OF ANY RESERVOIR?

- ☐ YES
- ☐ NO

AS APPLICANT, I UNDERSTAND THE FOLLOWING:

- THIS APPLICATION IS VALID FOR TWO(2) YEARS FROM DATE OF FEE PAYMENT AND APPROVAL IS BASED UPON HEALTH OFFICER SIGNATURE OF A PERC CERTIFICATION PLAN PRIOR TO EXPIRATION OF THIS PERMIT.
- THE APPLICATION FEE IS NON-REFUNDABLE
- THIS APPLICATION MUST BE ACCOMPANIED BY ALL APPLICABLE FEES AND A SUITABLE SITE PLAN IN ORDER TO BE PROCESSED
- THIS IS A PUBLIC DOCUMENT

I declare and affirm that to the best of my knowledge, the information contained herein is correct. I declare that I am the owner of the property or duly authorized to make this application on behalf of the owner. I agree to comply with all applicable state and county regulations.

By signature of this application, I hereby grant Howard County Health Department officials the right to enter onto the property for the purpose of inspecting the property as directly related to the requested permit/service.

[Signature]

SIGNATURE OF APPLICANT

3-12-18

DATE

23

(A)

14<sup>1</sup>

Ⓐ

Br 14 L,  
m250K.

2

Br - 11 Bq / Y L  
WF SBK,  
Friable,  
5% chert

4

Br/Y SL  
w/ pl.  
CW. m...

7

ARTY-like FSL  
WK PL, -protease  
59% channels  
Highly  
mucous.

14

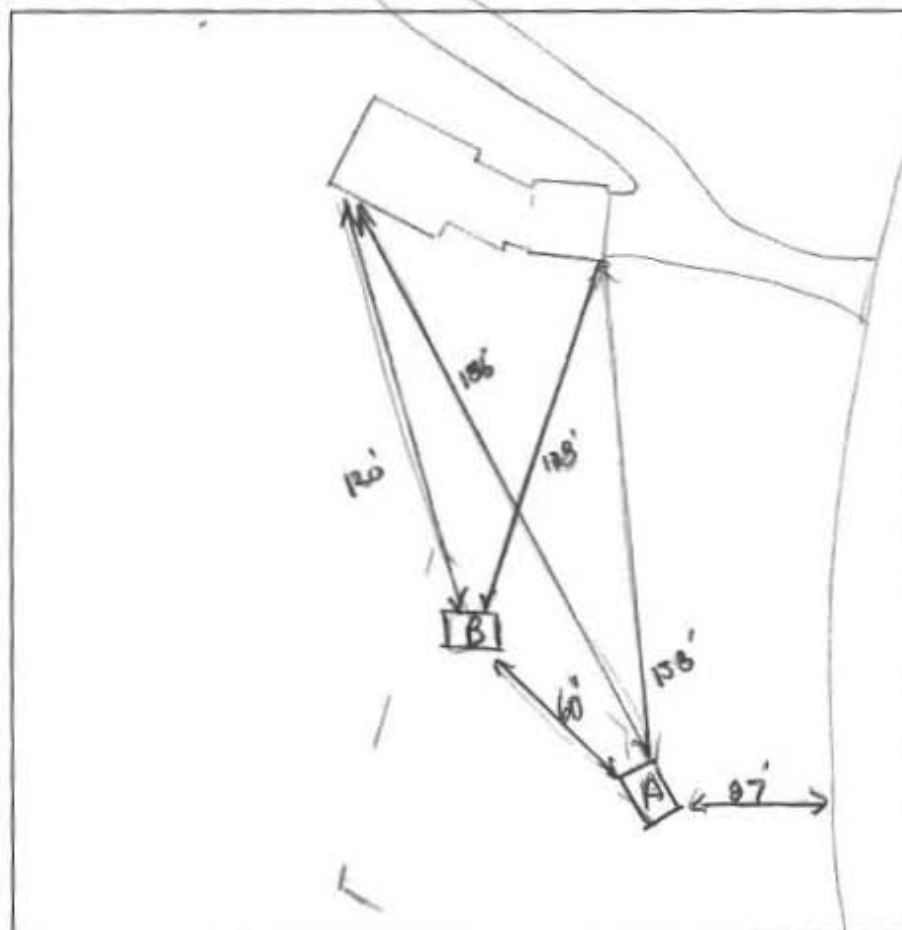
[illegible]REMARKS Ex. system exposed. Store dry no bleed. Tank #309 looks clean

SANITARIAN \_\_\_\_\_ BACKHOE \_\_\_\_\_ OTHERS \_\_\_\_\_ 12/10/1

TEST HOLES USED IN SDA \_\_\_\_\_ AVG. PERC TIME \_\_\_\_\_ SQ. FT/BR \_\_\_\_\_

TRENCH WIDTH                      INLET DEPTH                      MAX. BOT DEPTH                      EFFECTIVE SW

479 381 0469 - Wayne Bohn (over)

### FILE INQUIRY NOTES

11718 Spring Haven Co. N.H.

DATE	RESULTS OF REVIEW FOR FILE
3/23/18	<p>met w/ owner and contractor on site. Upon arrival, I was under the assumption along w/ contractor that was a repair. Permit was applied for as repair. Owner explained that he was finishing basement w/ total # of BR's @ 5. He also explained he came into our office and spoke w/ Hank Oswald which he mentioned we needed confirmation today to verify 4' treatment zone below bottom of existing foundation. As do not waste time from owner and contractor, I made decision to dig 2 obs. holes just below ex. foundation (see details on permit dated 3/23/18 for hole locations). Permit successful. Dug to 14' w/ no evidence of excessive rock or water. (see profile for soil description). Told owner to come in tomorrow and I will approve bldg for basement finishing as long as he supplies w/ existing floor plan <u>known</u>.</p>



