

8/2/87
8/4/87
ASAP

PERMIT

SEWAGE DISPOSAL SYSTEM

MARYLAND STATE DEPARTMENT OF HEALTH

HOWARD COUNTY
BUREAU OF ENVIRONMENTAL HEALTH
461-9933

03-8286789

P. 39779

A 28388

DISTRICT 3rd

DATE 7/30/87

DATE SYSTEM APPROVED 8/4/87

INSPECTOR *Ba*

INDEXED

Dale Fogle

IS PERMITTED TO INSTALL X ALTER

ADDRESS 6430 Woodbine Road, Woodbine, MD 21797 PHONE

SUBDIVISION ROAD 950 River Road LOT

PROPERTY OWNER John Harris
950 River Road

ADDRESS

IF GARBAGE GRINDER IS USED INCREASE SEPTIC TANK CAPACITY BY 50% AND ABSORPTION AREA BY 22%

GARBAGE GRINDER? YES NO X

SEPTIC TANK CAPACITY 1000 GALLONS NUMBER OF BEDROOMS 3

TRENCHES - 180 sq. ft. per bedroom. Trench to be 2 feet wide. Inlet 4 feet below original grade. Bottom maximum depth 8 feet below original grade. Effective area begins at 4 feet below original grade. 4 feet of stone below distribution pipe.

LOCATION - Place the distribution box at a point located 290 feet from the paved edge of River Road and 233 feet from the paved edge of Route 32. Run the trenches along contour towards Route 32

NOTE - No trench to exceed 100 feet in length. Provide 6" - 8" diameter cleanout and cap to grade or above on septic tank. *ok/cw*

PLANS APPROVED BY R. Hodges DATE 3/05/87

COVER NO WORK UNTIL INSPECTED AND APPROVED

NEITHER THE HOWARD COUNTY COUNCIL NOR THE HEALTH DEPARTMENT IS RESPONSIBLE FOR THE SUCCESSFUL OPERATION OF ANY SYSTEM

NOTE: CLEANOUT REQUIRED EVERY 70 FEET OF SEWER LINE AND/OR AT 90° SWEEPS IN LINES FROM HOUSE TO DRAIN FIELDS

NOTE: ALL PARTS OF SEPTIC SYSTEMS (I.E. TANK, DISTRIBUTION BOX, TRENCHES) TO BE 100 FEET FROM WELL (UNLESS OTHERWISE SPECIFICALLY AUTHORIZED)

NOTE: IF DEEP TRENCHES ARE USED CALL FOR INSPECTION BEFORE AND AFTER PLACING GRAVEL IN TRENCHES

NOTE: NO DRY WELL SHALL EXCEED 15 FOOT IN DIAMETER. NO ABSORPTION TRENCH TO EXCEED 100 FEET IN LENGTH

NOTE: ALL PIPE FROM HOUSE TO SEPTIC TANK MUST BE CAST IRON OR SCHEDULE 40 PVC OR ABS

PERMIT VOID AFTER TWO YEARS

NOTE: INSTALL STAND PIPE ON SEPTIC TANK AND DRY WELL. STAND PIPES MUST BE 6 INCHES IN DIAMETER. CAST IRON, CONCRETE OR TERRA COTTA OR PVC OR ABS ACCEPTED. IF TOP OF SEPTIC TANK IS DEEPER THAN 3 FEET, MANHOLE TO GRADE REQUIRED

NOTE: DISTRIBUTION BOXES MUST HAVE BAFFLES

*INSTALLER IS RESPONSIBLE FOR OBTAINING FINAL APROVAL ON THIS PERMIT

*CALL 461-9933 FOR INSPECTION OF SEPTIC SYSTEMS.

EH - 2-1186

A 28388

QTE 32

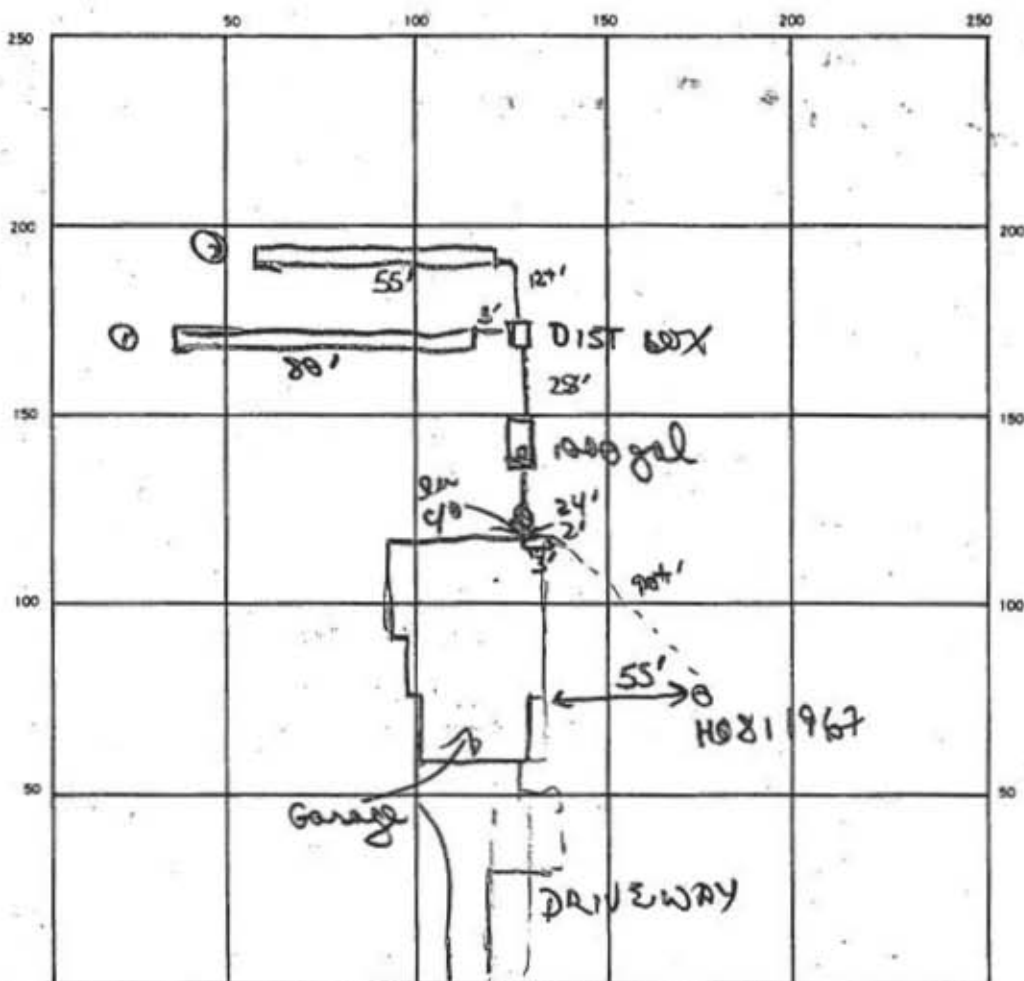

INDICATE NORTH — NAME ADJOINING ROADWAY AS BASE LINE

RIVER ROAD

SEPTIC TANK, LEVEL 1000 gal CLEANOUTS 1 ST. 1 in line
 DISTRIBUTION BOX, LEVEL ✓ w/ baffle
 DRAIN FIELD/TILE FIELD, DEPTH 8' 8' FT. TRENCH WIDTH 2 FT. INLET DEPTH 3 1/2 - 4 FT.
 EFFECTIVE GRAVEL DEPTH 4' 4' FT. TOTAL LENGTH 80 55 FT.
 NUMBER OF TRENCHES 2 ONE SIDEWALL BOTTOM AREA 320 + 220 SQ. FT.
 DRYWELL INSIDE DIAMETER 7 FT. EFFECTIVE DEPTH BELOW INLET — FT.
 ABSORBENT AREA 540 SQ. FT.

REMARKS 8/3/87 OK to add stone pipe paper to trenches
1+2, OK to partial backfill to get access to both
trenches. OK to finish piping other work.
8/4/87 OK to cover both trenches + all other work

DATE SYSTEM APPROVED 8/4/87 INSPECTOR B Nifon

(135)

$$\begin{array}{r} 4 \sqrt{540} \\ 4 \\ \underline{16} \\ 120 \\ \underline{120} \\ 0 \end{array}$$

$$\begin{array}{r} 200 \\ 3 \\ \sqrt{600} \\ 4 \sqrt{600} \\ 4 \\ \underline{16} \\ 20 \end{array}$$